

EUROPEAN PATENT APPLICATION

Application number: **82303794.0**

Int. Cl.³: **A 43 D 1/00, A 43 D 39/00**

Date of filing: **19.07.82**

Priority: **23.07.81 US 286244**
23.07.81 US 286245
22.02.82 EP 82300866

Applicant: **AMFIT INC., 233 Weddell Drive, Suite H, Sunnyvale California 94086 (US)**

Date of publication of application: **09.02.83**
Bulletin 83/6

Inventor: **Phillips, Edward H., P.O. Box 1042, Middletown California 95461 (US)**
Inventor: **Schwartz, Vern R., 488 Hill House Road, Boulder Creek California 95006 (US)**

Designated Contracting States: **AT BE CH DE FR GB IT LI NL SE**

Date of deferred publication of search report: **03.08.83 Bulletin 83/31**

Representative: **Oliver, Peter A., 8 Coombe Close, Frimley Surrey GU16 5DZ (GB)**

System and method for forming custom-made shoes and inserts therefor.

An automatic system for forming custom-made shoe inserts, or shoe soles, for a person's feet from a pair of blanks (24L and 24R) is provided with a foot impression mechanism (12) including a pair of pin arrays (22L, 22R) for simultaneously forming an impression of the contour of the undersurface of each of the person's feet and for releasably retaining each impression formed. Each of the pin arrays is arranged in orthogonal rows and columns with adjoining pins in each column having asymmetric contacting surfaces (57, 61). The system is also provided with a blank holding assembly (14) for holding the blanks in lateral alignment with the impressions, a blank shaping mechanism (16) for successively sensing each impression and for concomitantly successively cutting material away from each blank in conformance with the corresponding sensed impression, and a drive mechanism (18) for automatically driving the blank shaping mechanism both laterally and to-and-fro over the impressions and the blanks in response to a single drive motor (178) so as to form automatically the custom-made shoe inserts from the blanks in conformance with the impressions. A sensing and switching unit (250, 242, 254, 246) automatically stops the drive mechanism when the blank shaping mechanism is in both a desired lateral position and a desired to-and-fro position following formation of the custom-made shoe inserts.

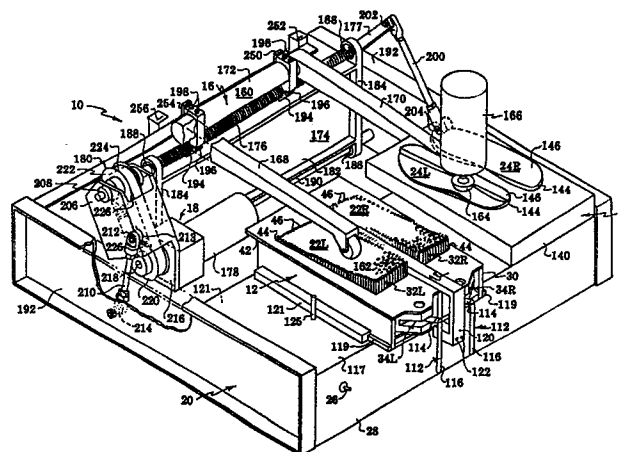



DOCUMENTS CONSIDERED TO BE RELEVANT			EP 82 30 3794												
Category	Citation of document with indication, where appropriate, of relevant passages	Relevant to claim	CLASSIFICATION OF THE APPLICATION (Int. Cl. 3)												
X, Y	US - A - 2 230 143 (HYLAND) * page 3, line 53 - page 4; page 5; figures 1,4 * --	1-21	A 43 D 1/00 39/00												
Y	METAALBEWERKING, no.20, March 31, 1966 MIDDELBURG (NL) "Spannen op kleefband" * page 426, lines 14-15 * --	13-17													
Y	US - A - 2 998 983 (DIGATE) * column 5, lines 54-60 * --	13-17													
X	US - A - 2 323 538 (HYLAND) * figures 2,7 * --	1-12, 18-21													
A	DE - A - 2 715 906 (LOVER) * page 1 * -----	13-17	TECHNICAL FIELDS SEARCHED (Int. Cl. 3) A 43 D 1/00 29/00 39/00 A 43 B 17/00 B 23 Q 3/00												
The present search report has been drawn up for all claims															
Place of search The Hague		Date of completion of the search 13-04-1983	Examiner LOKERE												
<table border="0"><tr><td>CATEGORY OF CITED DOCUMENTS</td><td>T : theory or principle underlying the invention</td></tr><tr><td>X : particularly relevant if taken alone</td><td>E : earlier patent document, but published on, or after the filing date</td></tr><tr><td>Y : particularly relevant if combined with another document of the same category</td><td>D : document cited in the application</td></tr><tr><td>A : technological background</td><td>L : document cited for other reasons</td></tr><tr><td>O : non-written disclosure</td><td>& : member of the same patent family, corresponding document</td></tr><tr><td>P : intermediate document</td><td></td></tr></table>				CATEGORY OF CITED DOCUMENTS	T : theory or principle underlying the invention	X : particularly relevant if taken alone	E : earlier patent document, but published on, or after the filing date	Y : particularly relevant if combined with another document of the same category	D : document cited in the application	A : technological background	L : document cited for other reasons	O : non-written disclosure	& : member of the same patent family, corresponding document	P : intermediate document	
CATEGORY OF CITED DOCUMENTS	T : theory or principle underlying the invention														
X : particularly relevant if taken alone	E : earlier patent document, but published on, or after the filing date														
Y : particularly relevant if combined with another document of the same category	D : document cited in the application														
A : technological background	L : document cited for other reasons														
O : non-written disclosure	& : member of the same patent family, corresponding document														
P : intermediate document															



CLAIMS INCURRING FEES

The present European patent application comprised at the time of filing more than ten claims.

- ☐ All claims fees have been paid within the prescribed time limit. The present European search report has been drawn up for all claims.
- ☐ Only part of the claims fees have been paid within the prescribed time limit. The present European search report has been drawn up for the first ten claims and for those claims for which claims fees have been paid, namely claims:
- ☐ No claims fees have been paid within the prescribed time limit. The present European search report has been drawn up for the first ten claims.

X LACK OF UNITY OF INVENTION

The Search Division considers that the present European patent application does not comply with the requirement of unity of invention and relates to several inventions or groups of inventions, namely:

1. claims 1-12, 18-21
2. claims 13-17

- ☒ All further search fees have been paid within the fixed time limit. The present European search report has been drawn up for all claims.
- ☐ Only part of the further search fees have been paid within the fixed time limit. The present European search report has been drawn up for those parts of the European patent application which relate to the inventions in respect of which search fees have been paid, namely claims:
- ☐ None of the further search fees has been paid within the fixed time limit. The present European search report has been drawn up for those parts of the European patent application which relate to the invention first mentioned in the claims, namely claims: