

12 **EUROPEAN PATENT APPLICATION**

21 Application number: 83303432.5

51 Int. Cl.⁴: **D 06 F 37/26**

22 Date of filing: 14.06.83

30 Priority: 16.06.82 GB 8217437

43 Date of publication of application:
04.01.84 Bulletin 84/1

88 Date of deferred publication of search report: 04.12.85

84 Designated Contracting States:
BE DE FR IT LU NL

71 Applicant: REED INTERNATIONAL P.L.C.
82, Piccadilly
London, W1A 1EJ(GB)

72 Inventor: Hancock, Frank John Thompson
Heath Lodge Elm Grove
Alderley Edge Cheshire(GB)

74 Representative: Rushton, Ronald et al,
SOMMERVILLE & RUSHTON 11 Holywell Hill
St. Albans Hertfordshire AL1 1EZ(GB)

54 **Wash tubs.**

57 Wash tubs for domestic front loading washing machines, where rigidity of the back plate supporting the rotatable drum is an essential requisite, are made more rigid, quicker, stronger and cheaper as solid mouldings than as structural foam mouldings, the latter being the accepted norm for maximising panel stiffness. Preferred materials are fibre reinforced thermoplastic compositions free from blowing agents. The back plates are moulded in a Greek Fan configuration comprising a plurality of sectors (2, 3) adjacent ones of which are relatively displaced axially of the wash tub and are joined at their radial edges by axially extending webs (4) the sectors preferably being thicker than the webs.

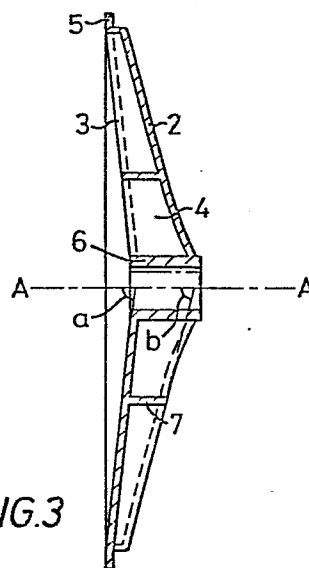



European Patent
Office

EUROPEAN SEARCH REPORT

0097483

Application number

EP 83 30 3432

DOCUMENTS CONSIDERED TO BE RELEVANT			
Category	Citation of document with indication, where appropriate, of relevant passages	Relevant to claim	CLASSIFICATION OF THE APPLICATION (Int. Cl. 3)
X	EP-A-0 043 429 (ZANUSSI) * Page 4, lines 8-15; page 5, lines 20-30; figures *	1,2	D 06 F 37/26
A	---	3-7	
A	GB-A-1 033 280 (SIEMENS) * Page 2, lines 19-48 *	10,11	
A	---	1	
A	DE-U-7 320 627 (CORDES) * Claim 3 *		
A	---	1,2	
A	DESIGN ENGINEERING, mid-May 1980, pages 47-50, London, GB; "Specialised plastics & fabrication methods in white goods manufacture"		TECHNICAL FIELDS SEARCHED (Int. Cl. 3)
A	---		D 06 F
A	FR-A-1 362 919 (VEREINIGTE DEUTSCHE METALLWERKE) -----		
The present search report has been drawn up for all claims			
Place of search THE HAGUE		Date of completion of the search 30-07-1985	Examiner D HULSTER E.W.F.
<p>CATEGORY OF CITED DOCUMENTS</p> <p>X : particularly relevant if taken alone Y : particularly relevant if combined with another document of the same category A : technological background O : non-written disclosure P : intermediate document</p> <p>T : theory or principle underlying the invention E : earlier patent document, but published on, or after the filing date D : document cited in the application L : document cited for other reasons & : member of the same patent family, corresponding document</p>			