

(12) **EUROPEAN PATENT APPLICATION**

(21) Application number: 83308035.1

(51) Int. Cl.<sup>3</sup>: **B 65 C 9/18**  
**B 65 C 9/42, B 65 C 9/36**

(22) Date of filing: 30.12.83

(30) Priority: 31.12.82 GB 8237015

(43) Date of publication of application:  
11.07.84 Bulletin 84/28

(88) Date of deferred publication of search report: 14.11.84

(84) Designated Contracting States:  
DE FR GB IT NL

(71) Applicant: **SINCLAIR INTERNATIONAL LIMITED**  
**22 Hellesden Hall Industrial Park**  
**Norwich, NR6 1DR(GB)**

(72) Inventor: **Briggs, Peter David Sinclair**  
**20 Taverham Road**  
**Taverham Norwich Norfolk(GB)**

(72) Inventor: **Constantine, Alan**  
**49 Rackham Road**  
**Norwich(GB)**

(72) Inventor: **Hirst, Richard John**  
**25 Smiths Lane**  
**Fakenham Norfolk(GB)**

(74) Representative: **Low, Peter John et al,**  
**WILSON, GUNN, ELLIS & CO. 41 Royal Exchange**  
**Manchester, M2 7BD(GB)**

(64) **Improvements in or relating to labelling apparatus.**

(57) A reciprocating labelling device is known but it is slow and expensive. High speed labelling devices can only handle paper labels and cannot be used with plastic labels. The invention provides a high speed compact labelling device particularly adapted for use with plastic labels comprising a rotary label applying means (120) having a plurality of bellows (124) arranged at intervals therearound. The label applying means is adapted to rotate between a label receiving position and a label applying position. A vacuum is applied to the bellows to retract them except at the label applying position and labels are held on the retracted bellows by suction. At the label applying position an overpressure is applied to the bellows causing the bellows to expand into contact with an object to be labelled. Objects of irregular size can thus be labelled.

The apparatus also includes a detachable cassette (12) for a supply (16) of labels (22), the cassette including means for transporting labels (30) to the label applying means and for separating labels (32) from the label carrier (20). The cassette can be loaded and threaded up when detached from the rest of the apparatus and when loaded can replace an exhausted cassette on the apparatus without stopping the apparatus.

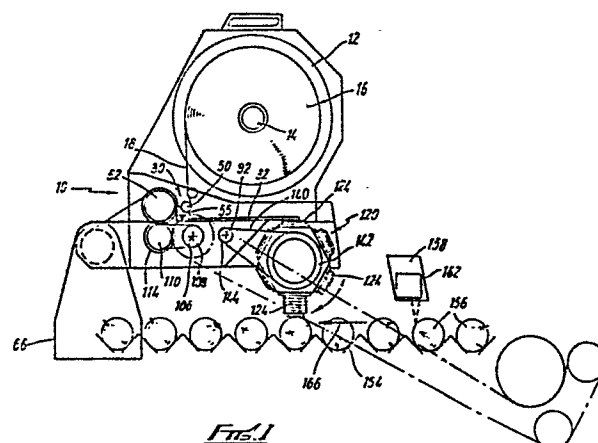

*FIG. 1*



European Patent  
Office

**PARTIAL EUROPEAN SEARCH REPORT**  
which under Rule 45 of the European Patent Convention  
shall be considered, for the purposes of subsequent  
proceedings, as the European search report

**0113256**

Application number

EP 83 30 8035

DOCUMENTS CONSIDERED TO BE RELEVANT			
Category	Citation of document with indication, where appropriate, of relevant passages	Relevant to claim	CLASSIFICATION OF THE APPLICATION (Int. Cl. 3)
X	FR - A - 2 291 096 (WOOD) * page 11, lines 12-32; page 12, lines 1-5; page 19, lines 1-35; page 20, lines 12-16; figure 1 *	1,3-7	B 65 C 9/18 B 65 C 9/42 B 65 C 9/36
Y	--	2	
Y,D	GB - A - 1 563 892 (LA MERS) * page 3, lines 12-52 *	2	
A	-- US - A - 4 253 902 (YADA) -----	1	
			TECHNICAL FIELDS SEARCHED (Int. Cl. 3)
			B 65 C
<b>INCOMPLETE SEARCH</b>			
<p>The Search Division considers that the present European patent application does not comply with the provisions of the European Patent Convention to such an extent that it is not possible to carry out a meaningful search into the state of the art on the basis of some of the claims.</p> <p>Claims searched completely: 1-7,17,18</p> <p>Claims searched incompletely:</p> <p>Claims not searched: 19</p> <p>Reason for the limitation of the search:</p> <p>Rule 29(6) of the European Patent Convention.</p>			
Place of search The Hague		Date of completion of the search 22-03-1984	Examiner GOETZ
<p><b>CATEGORY OF CITED DOCUMENTS</b></p> <p>X : particularly relevant if taken alone Y : particularly relevant if combined with another document of the same category A : technological background O : non-written disclosure P : intermediate document</p> <p>T : theory or principle underlying the invention E : earlier patent document, but published on, or after the filing date D : document cited in the application L : document cited for other reasons &amp; : member of the same patent family, corresponding document</p>			



## CLAIMS INCURRING FEES

The present European patent application comprised at the time of filing more than ten claims.

- ☐ All claims fees have been paid within the prescribed time limit. The present European search report has been drawn up for all claims.
- ☐ Only part of the claims fees have been paid within the prescribed time limit. The present European search report has been drawn up for the first ten claims and for those claims for which claims fees have been paid, namely claims:
- ☐ No claims fees have been paid within the prescribed time limit. The present European search report has been drawn up for the first ten claims.

## ☒ LACK OF UNITY OF INVENTION

The Search Division considers that the present European patent application does not comply with the requirement of unity of invention and relates to several inventions or groups of inventions, namely:

- 1) Claims 1-7,17,18: Rotating label applying means combined with a label supplying means delivering labels from a backing strip.
- 2) Claims 1,8-10: Apparatus as in claim 1, where the supply of labels is stored in a detachable housing.
- 3) Claims 1,11-16: Labelling apparatus as in claim 1 where bellows connected with high or low air pressure supply are used as label handling means.

- ☐ All further search fees have been paid within the fixed time limit. The present European search report has been drawn up for all claims.
- ☐ Only part of the further search fees have been paid within the fixed time limit. The present European search report has been drawn up for those parts of the European patent application which relate to the inventions in respect of which search fees have been paid, namely claims:
- ☒ None of the further search fees has been paid within the fixed time limit. The present European search report has been drawn up for those parts of the European patent application which relate to the invention first mentioned in the claims.

namely claims 1-7,17,18