

(12)

EUROPEAN PATENT APPLICATION

(21) Application number: **84105290.5**

(51) Int. Cl.⁴: **E 05 B 47/00**

(22) Date of filing: **10.05.84**

(30) Priority: **16.06.83 GB 8316418**

(43) Date of publication of application:
27.12.84 Bulletin 84/52

(88) Date of deferred publication of search report: **14.08.85**

(84) Designated Contracting States:
AT BE CH DE FR GB IT LI LU NL SE

(71) Applicant: **LOWE & FLETCHER LIMITED**
Fryers Road
Leamore, Walsall West Midlands(GB)

(72) Inventor: **Herriott, Leslie Victor**
31 Forton Close Compton Ridge
Walverhampton West Midlands(GB)

(74) Representative: **Lewis, Samuel Hewitt et al,**
FORRESTER & BOEHMERT Widenmayerstrasse 4/I
D-8000 München 22(DE)

(54) **Method of modifying a closure member equipped with a latch or a key-operated lock and unit for use in the method.**

(57) A lock (11) fitted to a door (10) is modified by inserting an appropriate key into the lock so that a handle (12) of the key protrudes from the lock (11) and applying a control unit (14) to the door (10) to cover and engage drivingly the handle (12) of the key. The control unit (14) is responsive to a magnetically coded key (24), by means of which the control unit (14) can be set in a condition in which torque is transmitted from a knob (18) to the handle (12) of the key.

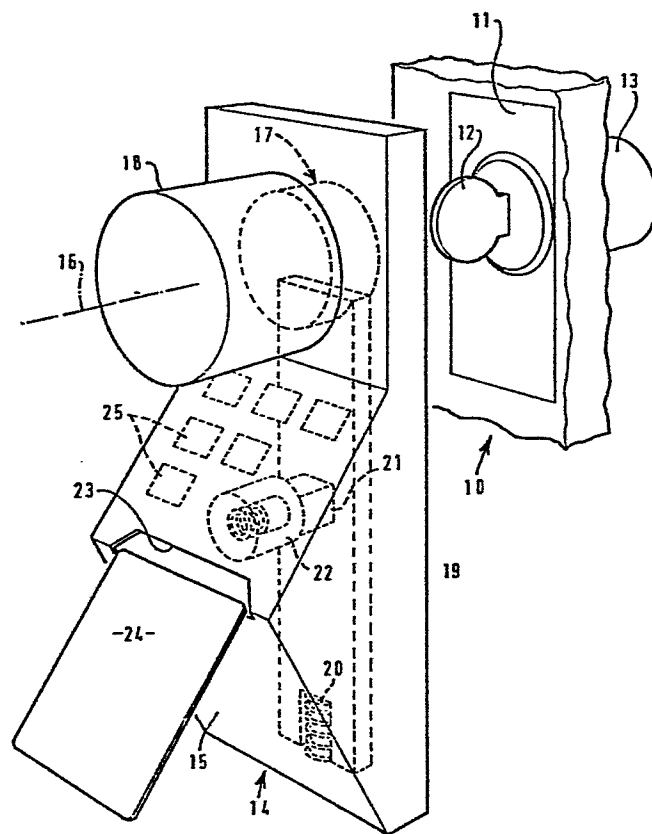



European Patent
Office

EUROPEAN SEARCH REPORT

0129042

Application number

EP 84 10 5290

DOCUMENTS CONSIDERED TO BE RELEVANT			
Category	Citation of document with indication, where appropriate, of relevant passages	Relevant to claim	CLASSIFICATION OF THE APPLICATION (Int. Cl. ³)
A	US-A-3 995 460 (B.S. SEDLEY) * Complete document *	1	E 05 B 47/00
X		2-4	
A	--- US-A-4 133 194 (B.S. SEDLEY et al.) * Complete document *	1	
X		2-4	
A	--- GB-A-2 022 678 (NEIMAN S.A.) * Complete document *	1	
A	--- DE-A-2 735 879 (ACCESS CONTROL SYSTEMS PTY. LTD.) * Complete document *	5, 6	TECHNICAL FIELDS SEARCHED (Int. Cl. ³) E 05 B 35/00 E 05 B 37/00 E 05 B 47/00 E 05 B 49/00
The present search report has been drawn up for all claims			
Place of search BERLIN		Date of completion of the search 30-04-1985	Examiner KRABEL A.W.G.
CATEGORY OF CITED DOCUMENTS X : particularly relevant if taken alone Y : particularly relevant if combined with another document of the same category A : technological background O : non-written disclosure P : intermediate document T : theory or principle underlying the invention E : earlier patent document, but published on, or after the filing date D : document cited in the application L : document cited for other reasons & : member of the same patent family, corresponding document			