

12

EUROPEAN PATENT APPLICATION

21 Application number: 84308315.5

51 Int. Cl.⁴: **E 05 B 15/02**
E 05 C 9/04

22 Date of filing: 30.11.84

30 Priority: 05.12.83 GB 8332392

43 Date of publication of application:
12.06.85 Bulletin 85/24

88 Date of deferred publication of search report: 11.06.86

84 Designated Contracting States:
AT BE CH DE FR GB IT LI LU NL SE

71 Applicant: **Regent Lock Co. Ltd.**
Bath Road Industrial Estate
Chippenham Wiltshire(GB)

72 Inventor: **Daley, Ernest Charles Regent Lock Company**
Limited
Bath Road Industrial Estate
Chippenham Wiltshire(GB)

74 Representative: **Johnson, Terence Leslie et al,**
Edward Evans & Co. Chancery House 53-64 Chancery
Lane
London WC2A 1SD(GB)

54 **Apparatus for locking a closure.**

57 Keepers (1) and (10) are mounted near a jamb of the door, in which jamb the leading edge of the door carrying handle/espagnolette gear is received to lock the door. Using the apparatus embodying the invention, the door can be locked in any one of three additional positions. This provides for the door to be locked open in different ventilating positions without having a sufficient gap between the leading edge of the door and the jamb to permit unauthorised entry. The door is merely slid to the required position and then the espagnolette rods are moved to engage in a desired one of the facing pairs (2, 11), depending on the ventilation gap required.

FIG. II.

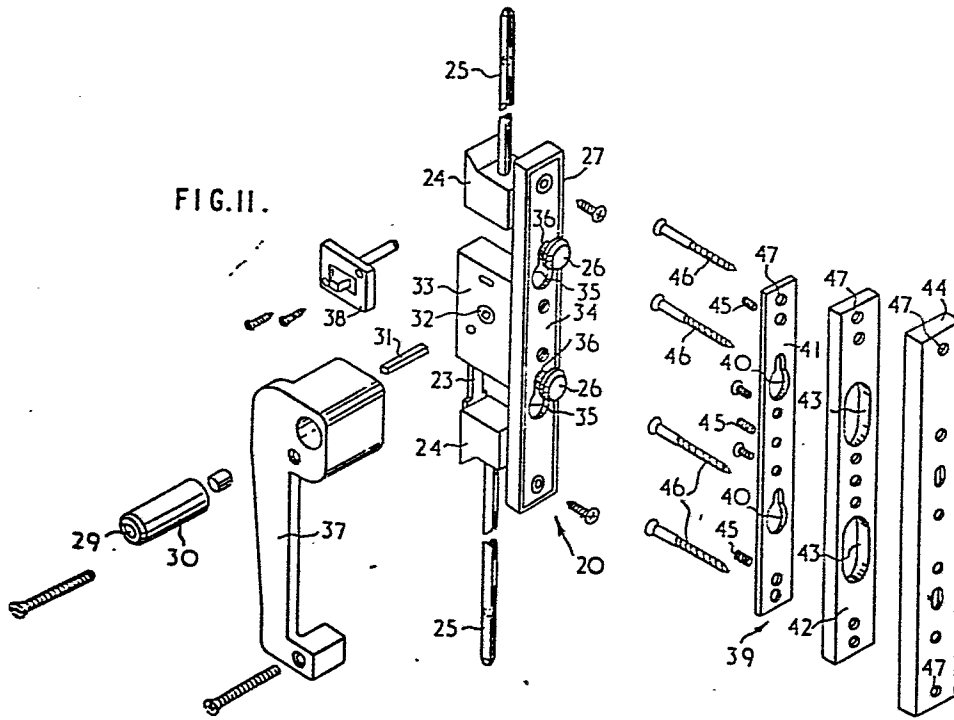



European Patent
Office

EUROPEAN SEARCH REPORT

0144221
Application number

EP 84 30 8315

DOCUMENTS CONSIDERED TO BE RELEVANT			
Category	Citation of document with indication, where appropriate, of relevant passages	Relevant to claim	CLASSIFICATION OF THE APPLICATION (Int. Cl. 4)
X	DE-A-2 455 479 (UHL) * Whole document *	1-5	E 05 C 9/04 E 05 B 65/08
Y		6-9	
Y	GB-A-2 118 611 (REGENT) * Whole document *	6-9	
			TECHNICAL FIELDS SEARCHED (Int. Cl. 4)
			E 05 B E 05 C
The present search report has been drawn up for all claims			
Place of search THE HAGUE		Date of completion of the search 11-03-1986	Examiner VAN BOGAERT J.A.M.M.
CATEGORY OF CITED DOCUMENTS			
X : particularly relevant if taken alone Y : particularly relevant if combined with another document of the same category A : technological background O : non-written disclosure P : intermediate document		T : theory or principle underlying the invention E : earlier patent document, but published on, or after the filing date D : document cited in the application L : document cited for other reasons & : member of the same patent family, corresponding document	