

(19)



Europäisches Patentamt
European Patent Office
Office européen des brevets



(11) Publication number:

0 169 061 B1

(12)

EUROPEAN PATENT SPECIFICATION

(45) Date of publication of patent specification: **11.09.91** (51) Int. Cl.⁵: **E04F 13/14, B44C 1/28**

(21) Application number: **85305094.6**

(22) Date of filing: **17.07.85**

(54) **Decorative panel comprising replaceable decorative sheets.**

(30) Priority: **17.07.84 JP 107831/84 U**
09.11.84 JP 170760/84 U
04.03.85 JP 30471/85 U

(43) Date of publication of application:
22.01.86 Bulletin 86/04

(45) Publication of the grant of the patent:
11.09.91 Bulletin 91/37

(84) Designated Contracting States:
DE FR IT

(56) References cited:

DE-A- 2 045 283	DE-A- 2 149 129
DE-A- 2 150 566	DE-A- 2 617 995
DE-A- 2 708 132	DE-A- 2 757 025
DE-A- 2 805 625	FR-A- 454 513
FR-A- 809 334	FR-A- 2 402 931

(73) Proprietor: **INAX CORPORATION**
6 Koiehonmachi 3-chome
Tokoname-Shi Aichi(JP)

Proprietor: **JAPAN ALPHA CORPORATION**
125-3, Aza Uchiageta Oaza Higashikata
Kuwana-Shi Mie(JP)

(72) Inventor: **Iesaka, Takashi**
No. 29 Seikaicho 2-chome
Tokoname-shi Aichi(JP)
Inventor: **Wada, Takaaki**
No. 58 Hakusancho 4-chome
Handa-shi Aichi(JP)
Inventor: **Ohta, Ikumi**
No. 2800-31, Oaza Nao Asahicho
Mie-gun Mie(JP)
Inventor: **Izumi, Masayuki**
No. 14-14, Ohara 1-chome
Setagaya-ku Tokyo(JP)

(74) Representative: **Boon, Graham Anthony et al**
Elkington and Fife Beacon House 113 King-
sway
London, WC2B 6PP(GB)

EP 0 169 061 B1

Note: Within nine months from the publication of the mention of the grant of the European patent, any person may give notice to the European Patent Office of opposition to the European patent granted. Notice of opposition shall be filed in a written reasoned statement. It shall not be deemed to have been filed until the opposition fee has been paid (Art. 99(1) European patent convention).

Description

This invention relates to a decorative panel comprising rigid decorative sheets replaceably installed on a structural support. Such decorative sheets can be readily installed or replaced to exhibit a variety of designs by the use of fixing means such as screws. Moreover, a variety of decorative accessories such as a picture frame can be further set on the decorative surfaces. Such readily replaceable decorative panels are very useful, for example, for display rooms, etc.

Up until now, most tile panels have been produced by bonding tile pieces onto a substrate with wet mortar. Such wet installation of tiles demands professional skills and long working hours, sometimes the freshly bonded tiles slip down, and the mortar often needs a long aging time. Moreover, a very large scale operation is required to replace the tile pieces when the panel is remodelled.

Installation of decorative sheets such as tiles with strong organic adhesives also presents difficulties in partly stripping the sheets and cleaning the adhesive when the panel is remodelled.

Some decorative sheets can be nailed onto a substrate. Such a nailing installation, however, necessitates the grouting of the nail heads. The grout and nails have to be removed when the decorative sheets are replaced.

Considerable work is also required in these dry installation systems when the panel is remodelled.

Some sheets or plates to be installed with screws are also known. DE-A-2 149 129 corresponding with the preamble of claim 1 discloses ceramic tile to be assembled and installed having cut-outs at the corners thereof and no depression hole at the centre as shown in FIG.5 thereof. It is noted that the heads of the fixing screws at the corners of the tile are higher than the tile surfaces. DE-A-2 805 625 discloses large brick plates having lattice-like square holes and having neither cut-outs nor depressions at the corners thereof, wherein the hole can have a cone-like centre hole to fix the brick plate to a substrate by means of a screw and washer as shown in FIG. 7 thereof.

Thus, it is an object of the present invention to provide a decorative panel comprising rigid decorative sheets having cut-outs and depressions at the corners thereof which are replaceably installed on a structural support by the use of fixing means, such as screw.

Another object of an embodiment of the present invention is to provide the above mentioned decorative panel on which a variety of decorative accessories or articles are readily set by utilizing the heads of the fixing means.

According to the invention there is provided a decorative panel comprising right-angled tetragonal

rigid decorative sheets replaceably installed on a structural support by the use of fixing means having flanges at the heads thereof; said decorative sheets having cut-outs at the corners thereof; each of the corners of four decorative sheets assembled together forming a cut-out hole; said structural support containing mating means for the fixing means; the cut-out holes of the assembled sheets being arranged on the mating means; the fixing means being fitted to the mating means through the cut-out holes:

characterised by said decorative sheets having depressions adjacent to the cut-outs; each depression being in the form of an inclined plane tapering down towards the cut-out; the inclined depressions of four assembled sheets forming an inclined depression plane around the cut-out hole, whereby the flanges at the heads of the fixing means are readily fitted in the inclined depressions to firmly support the decorative sheets; the heads of the fixing means recessed in the depressions being not higher than the level of the decorative surfaces of the decorative sheets; said structural support being a frame work consisting of substantially horizontal or vertical bars arranged at the spacing of the decorative sheets and at least two vertical or horizontal bars supporting the first-mentioned bars; and said mating means on the frame work being internal screw-thread holes or nut-containing holes set at the spacing of the decorative sheets.

Preferred embodiments of the invention are described in detail below, by example only, with reference to the accompanying drawings, wherein:

Fig. 1 is a perspective view illustrating the installation of decorative sheets;

Fig. 2 is a perspective view of the decorative panel;

Fig. 3 is a perspective view of a structural support;

Fig. 4 shows a combination of a bolt, a nut and accessories;

Fig. 5 is a cross-sectional partial view illustrating a picture frame set on the present decorative panel.

In Fig. 1 is shown a decorative panel 1 which comprises right-angled tetragonal rigid decorative sheets 2 replaceably installed on a structural support 9 such as frame works, substrate boards or walls by the use of removable fixing means such as screws 6; said decorative sheet 2 having cut-outs 3 at the corners thereof and depressions 4 adjacent to the cut-outs each of corners of four sheets 2 closely assembled together forming a cut-out hole 5 and a depression 4 around the hole; said structural support 9 containing mating fixing means such as internal screw-thread means 15; the cut-out holes 5 of the assembled sheets being arranged on the mating fixing means 15; the fixing

means 6 being fitted to the mating means 15 through the cut-out holes 5; the flanges 7 at the heads of the fixing means being sunk in the depressions 4 around the holes 5; whereby the decorative sheets 2 are replaceably fixed onto the structural support 9.

The decorative sheets are normally assembled without substantial gaps. It is generally preferred in view of appearance that the heads of the fixing means recessed on the depressions 4 are not higher than the level of the decorative surface. Incidentally, a covering frame 12 can be applied onto an edge or edges of the decorative panel 1. In this case, it is not always needed to secure such covered parts of the decorative sheets by the fixing means. Moreover, other decorative articles can be set on the decorative panel 1 by means of accessories or magnetic force. In the latter case, either one of some fixing means and decorative sheet(s) or the decoration article contains magnet pieces, and the other contains magnetizable pieces.

Incidentally, the decorative sheets are generally assembled and installed from the bottom row of the decorative sheets. The decorative sheets can be readily installed or partly replaced to provide a variety of the decorative panels by those unskilled in the art, when the decorative sheets, structural supports and other accessories are supplied. Also, the decorative panel itself can be readily set or replaced to remodel the decorative designs.

Decorative Sheets

The rigid decorative sheets to be used in the present decorative panel can be square or rectangular rigid sheets of plastics, plastic composites, glass, wood, ceramics, cement concrete, metal, mixtures thereof or the like. Heat-resistant sheets such as those of ceramics, concrete or metal can be glazed on the surfaces thereof. The dimensions of the decorative sheets are not especially restricted, but are normally in the range of about 10 cm to about 50 cm. The thickness of the sheet is such that sufficient strength is provided. The decorative sheet generally has cutouts 3 and depressions 4 at the four corners thereof. Thus, the cutouts and depression at the edges or corners of the panel 1 form semi- or quarter-circle configurations, where the fixing means can be inserted and recessed. As mentioned above, however, such cutouts and depressions are not always needed at the Corners or edges which are supported by the covering frame 12 of the decorative panel. The size of the cut-out 3 of the sheet is such that the shank of fixing means such as screws 6 can be passed through. The size of the depression 4 is such that the flange 7 at the head of the fixing means can be recessed thereon. Incidentally, the cut-outs 3 and

depressions 4 are normally designed to comprise quarter-round corners.

The depression 4 at the corners of the decorative sheet 2 is in the form of an inclined plane tapering towards the cut-out 3 (although this is not immediately apparent from the drawings). It has been unexpectedly found that an inclined depression tapering down from the decorative surface to the cut-out 3 is advantageous to ceramic tile and the like, because the mechanical strength if the tapered corner is ensured owing to gradual change in the degree of compaction and also glaze is uniformly applied onto such tapering depressions.

Embodiment I

The rigid decorative sheets 2 are replaceably installed on a structural support 9 such as a frame work containing mating fixing means by the use of removable fixing means such as screws 6 to provide the present decorative panel 1. The structural support 9 is exemplified by a frame work composed essentially of horizontal or vertical bars 10 arranged at an interval of the decorative sheet and at least two vertical or horizontal bars 11 are supporting the bars 10. The bars 10 have mating fixing means such as internal screw-thread holes 15 or holes 26 combined with nuts, at an interval of the decorative sheet to be installed thereon.

In a preferred embodiment, the bar 10 can be a metal bar 10 having U-shaped cross section. The U-shaped bars are composed to form a frame work or fixed onto a structural member with the openings thereof downward or upward or sideways. The U-shaped bars can have holes 26 at the both parallel sides thereof, as shown in FIG. 3. For example, nuts 13 having ring projections 14 at both ends thereof are set between pairs of the holes 26 of the U-shaped bar 10. Alternatively, the bars 10 can have internal screw-thread holes. The decorative sheets 2 can be readily screwed to the structural support 9 by means of bolts 6 and nuts 13 or screw-thread holes as illustrated in FIGS. 1 and 3, to provide a decorative panel such as decorative walls or self-standing screen walls (e.g. a screen with or without casters or a folding screen as shown in FIG. 2). By the use of U-shaped bars 10 and nuts 13 held thereby as shown in FIG. 3, the decorative sheets can be readily installed as necessary on both sides of the frame work 9; such structure is useful for screen walls.

The preferred combination of the bolt 6, nut 13 and other accessories is illustrated in FIG. 4. The fixing means such as a bolt 6 can have an inner hole (e.g. an inner screw-thread hole 16) for holding accessories and screwdriver grooves 17 at the head thereof. The inner hole 16 can hold a deco-

rative head cap 18 or the like. As shown in FIG. 2, the head cap can be of relatively soft materials such as wood or rubber for pinning cards 19 or other displays thereon. Also, the inner holes 16 can be equipped with hooks or hangers 20, magnet pieces, rods for supporting shelf boards 21 or trays, or the like, by means of screws or adhesives, etc. The washer 8 is to protect the corners of decorative sheets, which is normally of relatively resilient materials such as rubber or plastics. The nut 13 normally has polygonal outward surfaces, whereby rotation of the nut is prevented by the bottom of the U-shaped bar as shown in FIG. 3. The length of the polygonal body 13 is as long as the distance between the parallel sides of the U-shaped bar 10, and the size of the ring projection 14 is as large as the diameter of the hole 26 at the sides of the bar 10. Incidentally, the decorative panel having inverted U-shaped horizontal bars can also be readily anchored onto a structural member such as walls by hooking means.

Embodiment II

Other decoration articles e.g. picture frame 27 can be advantageously set on the surface of the present decorative panel 1 by means of magnetic force, as shown in FIG. 2.

When the decoration article such as decorative or displaying members are small and light, it can be set by a single magnet piece and a magnetizable piece. For example, the bolt 6 or cap 18 fixed to the bolt, as shown in FIGS. 1 and 4, can be a magnet piece and the decoration article can contain a magnetizable piece, and vice versa.

According to this embodiment, a picture frame containing magnetizable materials or magnet materials can be readily set and replaced without undecently exposed hanging means. When the picture frame is relatively light, it can be set on the decorative panel by means or plural magnet pieces. When the picture frame is relatively large and heavy, the frame 27 should have a hooking means 29 inside the upper portion thereof, as illustrated in FIG. 5. More specifically, the hook 29 (e.g. in the shape of inverted L or sideways U) at the upper portion of the frame 27 is anchored by the magnet cap 18 fixed to the decorative panel 1 to support the weight of the frame, and the magnetizable metal portions 28 of the frame are horizontally attracted by the magnet cap 18, whereby the picture frame 27 can be secured in both gravitational and horizontal directions. It is preferred that the magnetizable metal portion 28 with the hook 29 has some space 30 or allowance 30 with respect to the magnet cap 18 for easily mounting the frame 27.

Incidentally, the picture frame 27 can have

optional configurations and may cover or contain thin articles 31 such as drawings, photographs, posters and documents. The frame 27 itself can also provide three dimensional decoration effects without such decorative articles. In other words, the picture frame is used in a fashion either to cover the decorative article 31 attached onto the decorative panel or to hold the decorative article therein.

Claims

1. A decorative panel (1) comprising right-angled tetragonal rigid decorative sheets (2) replaceably installed on a structural support (9) by the use of fixing means (6) having flanges (7) at the heads thereof; said decorative sheets having cut-outs (3) at the corners thereof; each of the corners of four decorative sheets assembled together forming a cut-out hole (5); said structural support containing mating means (15) for the fixing means (6); the cut-out holes (5) of the assembled sheets being arranged on the mating means (15); the fixing means (6) being fitted to the mating means (15) through the cut-out holes:
characterised by said decorative sheets (1) having depressions (4) adjacent to the cut-outs (3); each depression (4) being in the form of an inclined plane tapering down towards the cut-out; the inclined depressions (4) of four assembled sheets (2) forming an inclined depression plane (4) around the cut-out hole (5), whereby the flanges (7) at the heads of the fixing means are readily fitted in the inclined depressions (4) to firmly support the decorative sheets; the heads of the fixing means recessed in the depressions (4) being not higher than the level of the decorative surfaces of the decorative sheets (2); said structural support (9) being a frame work consisting of substantially horizontal or vertical bars (10) arranged at the spacing of the decorative sheets and at least two vertical or horizontal bars (11) supporting the first-mentioned bars (10); and said mating means (15) on the frame work being internal screw-thread holes (15) or nut-containing holes (26) set at the spacing of the decorative sheets.
2. The decorative panel according to claim 1, in which the bars (10) have a U-shaped cross section.
3. The decorative panel according to claim 2, in which nuts having ring projections at the both ends thereof are held between pairs of holes set on both parallel sides of the U-shaped bar.
4. The decorative panel according to claim 1, 2

- or 3 in which the decorative sheet is a ceramic tile.
5. The decorative panel according to claim 1, 2, 3 or 4, in which the fixing means has an inner hole at the head thereof and holds therein a decorative cap, a soft cap for pinning, a hook, a hanger, a magnet piece, or a rod for supporting a shelf. 5
 6. The decorative panel according to claim 1, 2 or 3, in which the fixing means is a screw or bolt. 10
 7. The decorative panel according to any of claims 1 to 6, in which the decorative sheets are assembled without substantial gaps. 15
 8. The decorative panel according to any of claims 1 to 7, in which a covering frame is applied onto an edge or edges of the decorative panel. 20
 9. The decorative panel according to any of claims 1 to 8, in which the decorative panel is a self-standing screen. 25
 10. The decorative panel according to any of claims 1 to 9, in which the decorative sheets are installed on both sides of the structural support. 30
 11. The decorative panel according to any of claims 1 to 8, in which the decorative panel composes a decorative wall secured onto a structural member. 35
 12. The decorative panel according to claims 2 or 3, in which the decorative panel is anchored onto a structural member by means of an inverted U-shaped horizontal bar and hooking means. 40
 13. The decorative panel according to any of claims 1 to 12, in which a decoration article is set on the surface of the decorative panel by means of magnetic force. 45
 14. The decorative panel according to claim 13, in which the decoration article is a picture frame. 50
 15. The decorative panel according to claim 14, in which the picture frame has a hooking means inside the upper portion thereof. 55

Revendications

1. Panneau décoratif (1) comportant des plaques

décoratives rigides (2) en forme de quadrilatère à angles droits montées sur un support structural (9) avec la faculté d'être remplacées grâce à l'utilisation de moyens de fixation (6) possédant des collerettes (7) situées à la tête de ces derniers; lesdites plaques décoratives présentant des échancrures (3) situées au droit des coins de ces plaques; chacun des coins de quatre plaques décoratives assemblées l'une à l'autre constituant un trou d'échancrure (5); ledit support structural contenant des moyens d'accouplement (15) destinés aux moyens de fixation (6); les trous d'échancrure (5) des plaques assemblées étant disposés sur les moyens d'accouplement (15); les moyens de fixation (6) s'ajustant sur les moyens d'accouplement (15) à travers les trous d'échancrure: caractérisé par le fait que lesdites plaques décoratives (1) comportent des zones dénivelées (4) adjacentes aux échancrures (3); chaque zone dénivelée (4) ayant la configuration d'un plan incliné s'évasant vers le bas en direction de l'échancrure; les zones dénivelées inclinées (4) de quatre plaques (2) assemblées constituant une rampe inclinée formant zone dénivelée (4) autour du trou d'échancrure (5), de sorte que les collerettes (7) situées à la tête des moyens de fixation s'ajustent facilement dans les zones dénivelées inclinées (4) de façon à supporter fermement les plaques décoratives; les têtes des moyens de fixation nichées dans les zones dénivelées (4) n'étant pas plus hautes que le niveau des surfaces décoratives des plaques décoratives (2); ledit support structural (9) étant une ossature composée de barreaux sensiblement horizontaux ou verticaux (10) disposés à l'espacement des plaques décoratives et d'au moins deux barreaux verticaux ou horizontaux (11) supportant les barreaux (10) mentionnés en premier; et les dits moyens d'accouplement (15) situés sur l'ossature étant des trous (15) présentant un taraudage interne pour vis ou des trous (26) contenant des écrous installés à l'espacement des plaques décoratives.

2. Panneau décoratif selon la revendication 1, dans lequel les barreaux (10) ont une section droite en forme de U.
3. Panneau décoratif selon la revendication 2, dans lequel des écrous possédant des anneaux faisant saillie aux deux extrémités de ces écrous sont maintenus entre des paires de trous ménagés sur les deux côtés parallèles du barreau en forme de U.
4. Panneau décoratif selon la revendication 1, la

revendication 2 ou la revendication 3, dans lequel la plaque décorative est un carreau céramique de revêtement.

5. Panneau décoratif selon la revendication 1, la revendication 2, la revendication 3 ou la revendication 4, dans lequel le moyen de fixation présente un trou intérieur au droit de la tête de ce moyen et y maintient un capuchon décoratif, un capuchon tendre destiné à recevoir des punaises, un crochet, une patère, une pièce formant aimant, ou une barre destinée à supporter une tablette. 5
6. Panneau décoratif selon la revendication 1, la revendication 2 ou la revendication 3, dans lequel le moyen de fixation est une vis ou un boulon. 10
7. Panneau décoratif selon l'une quelconque des revendications 1 à 6, dans lequel les plaques décoratives sont montées sans interstices appréciables. 15
8. Panneau décoratif selon l'une quelconque des revendications 1 à 7, dans lequel un cadre de couverture est appliqué sur un bord ou sur des bords du panneau décoratif. 20
9. Panneau décoratif selon l'une quelconque des revendications 1 à 8, dans lequel le panneau décoratif est une cloison autostable. 25
10. Panneau décoratif selon l'une quelconque des revendications 1 à 9, dans lequel les plaques décoratives sont montées sur les deux côtés du support structural. 30
11. Panneau décoratif selon l'une quelconque des revendications 1 à 8, dans lequel le panneau décoratif constitue une paroi décorative assujettie à un organe structural. 35
12. Panneau décoratif selon la revendication 2 ou la revendication 3, dans lequel le panneau décoratif est ancré sur un organe structural à l'aide d'un barreau horizontal en forme de U renversé et de moyens d'accrochage. 40
13. Panneau décoratif selon l'une quelconque des revendications 1 à 12, dans lequel un article de décoration est installé sur la surface du panneau décoratif au moyen de forces magnétiques. 45
14. Panneau décoratif selon la revendication 13, dans lequel l'article de décoration est un cadre de tableau. 50

15. Panneau décoratif selon la revendication 14, dans lequel le cadre de tableau possède un moyen d'accrochage situé à l'intérieur de la partie supérieure de ce dernier. 55

Patentansprüche

1. Dekorative Tafel (1) mit rechtwinkligen tetragonalen starren dekorativen Platten (2), die unter Verwendung von Befestigungseinrichtungen (6), die an ihren Köpfen Flansche (7) aufweisen, auswechselbar an einer Tragstruktur (9) angebracht sind; die dekorativen Platten an den Ecken Ausschnitte (3) aufweisen; jede der Ecken von vier zusammengesetzten dekorativen Platten ein Ausschnittsloch (5) bilden; die Tragstruktur Paßeinrichtungen (15) für die Befestigungseinrichtungen (6) aufweist; die Ausschnittslöcher (5) der zusammengesetzten Platten auf den Paßeinrichtungen (15) angeordnet sind; die Befestigungseinrichtungen (6) durch die Ausschnittslöcher in die Paßeinrichtungen (15) eingesetzt werden;

dadurch gekennzeichnet, daß

die dekorativen Platten (2) nahe den Ausschnitten (3) Vertiefungen (4) aufweisen; jede Vertiefung (4) die Form einer sich zum Ausschnitt hin nach unten zulaufenden geneigten Ebene hat; die geneigten Vertiefungen (4) von vier zusammengesetzten Platten (2) eine geneigte Vertiefungsebene (4) um das Ausschnittsloch (5) bilden, wodurch die Flansche (7) an den Köpfen der Befestigungseinrichtungen zum festen Kalten der dekorativen Platten leicht in die geneigten Vertiefungen (4) einsetzbar sind; die Köpfe der in die Vertiefungen (4) eingelassenen Befestigungseinrichtungen nicht höher sind als die Oberfläche der dekorativen Oberseiten der dekorativen Platten (2); die Tragstruktur (9) ein Rahmen aus im wesentlichen horizontalen oder vertikalen Stäben (10), die im Abstand der dekorativen Platten angeordnet sind, und wenigstens zwei vertikalen oder horizontalen Stäben (11) ist, welche die erstgenannten Stäbe (10) stützen; und die Paßeinrichtungen (15) am Rahmen Innenschraubgewindelöcher (15) oder eine Mutter enthaltende Löcher (26) sind, die im Abstand der dekorativen Platten angeordnet sind.

2. Dekorative Tafel nach Anspruch 1, bei der die Stäbe (10) U-förmigen Querschnitt aufweisen.
3. Dekorative Tafel nach Anspruch 2, bei der Muttern, die an beiden Enden Ringvorsprünge aufweisen, zwischen zwei in beiden parallelen

Seiten des U-förmigen Stabes angebrachten Löchern gehalten sind.

eine Hakeneinrichtung aufweist.

4. Dekorative Tafel nach Anspruch 1, 2 oder 3, bei der die dekorative Platte eine Keramikfliese ist. 5
5. Dekorative Tafel nach Anspruch 1, 2, 3 oder 4, bei der die Befestigungseinrichtung in ihrem Kopf ein inneres Loch aufweist und darin eine dekorative Kappe, einer weichen Kappe zum Aufstecken, einen Haken, einen Aufhänger, ein Magnetteil oder eine Stange zum Stützen eines Regals enthält. 10
15
6. Dekorative Tafel nach Anspruch 1, 2 oder 3, bei der die Befestigungseinrichtung eine Schraube oder ein Bolzen ist. 15
7. Dekorative Tafel nach einem der Ansprüche 1 bis 6, bei der die dekorativen Platten ohne wesentliche Lücken zusammengesetzt werden. 20
8. Dekorative Tafel nach einem der Ansprüche 1 bis 7, bei der ein Abdeckrahmen auf eine Kante oder Kanten der dekorativen Tafel angebracht wird. 25
9. Dekorative Tafel nach einem der Ansprüche 1 bis 8, bei der die dekorative Tafel ein selbststehender Schirm ist. 30
10. Dekorative Tafel nach einem der Ansprüche 1 bis 9, bei der die dekorativen Platten auf beiden Seiten der Tragstruktur angebracht sind. 35
11. Dekorative Tafel nach einem der Ansprüche 1 bis 8, bei der die dekorative Tafel eine an einem Strukturteil befestigte dekorative Wand bildet. 40
12. Dekorative Tafel nach Anspruch 2 oder 3, bei der die dekorative Tafel mittels einer umgekehrt-U-förmigen horizontalen Stange und eines Hakenteils an dem Strukturteil verankert ist. 45
13. Dekorative Tafel nach einem der Ansprüche 1 bis 12, bei der ein Dekorationsgegenstand durch Magnetkraft auf die Oberfläche der dekorativen Tafel gesetzt ist. 50
14. Dekorative Tafel nach Anspruch 13, bei dem der Dekorationsgegenstand ein Bilderrahmen ist. 55
15. Dekorative Tafel nach Anspruch 14, bei dem der Bilderrahmen in seinem oberen Bereich

FIG. 1

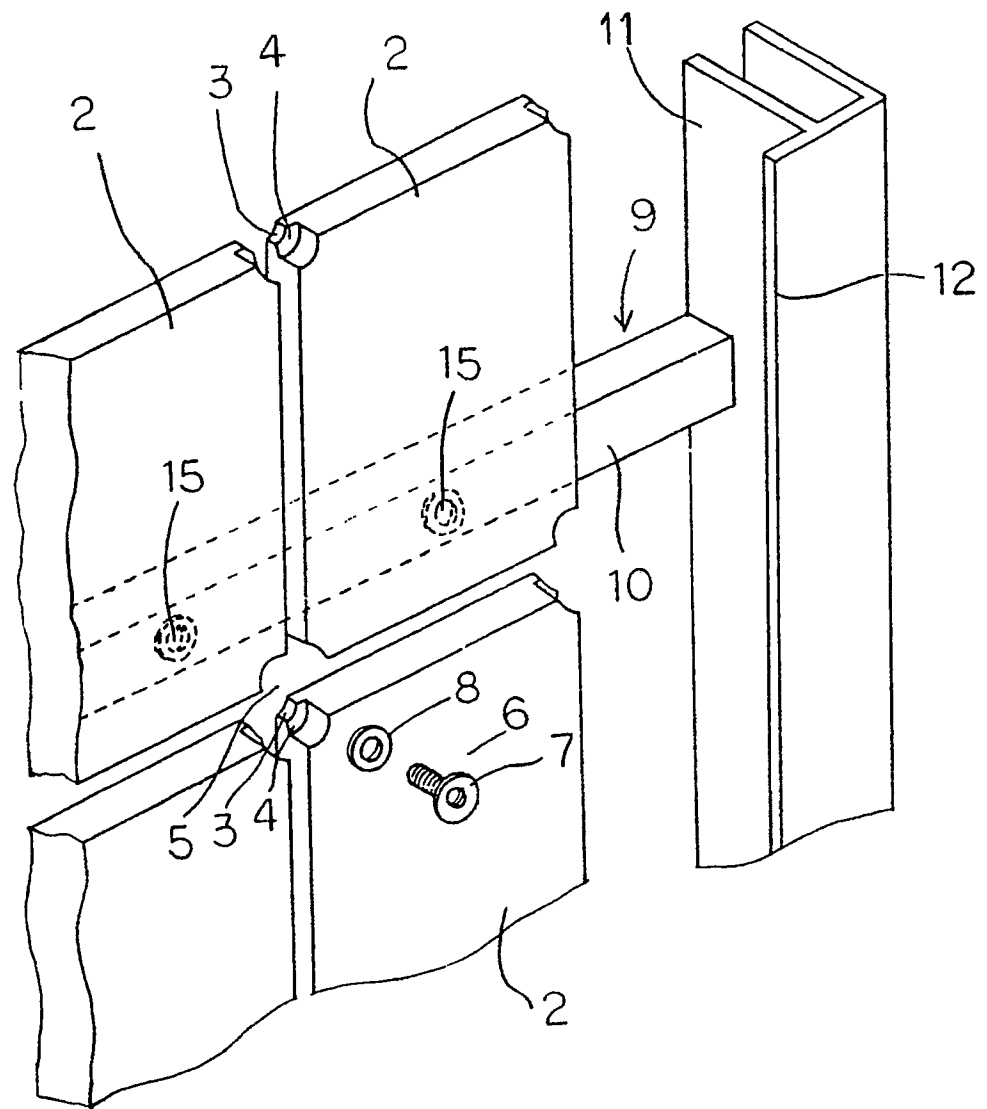

FIG. 2

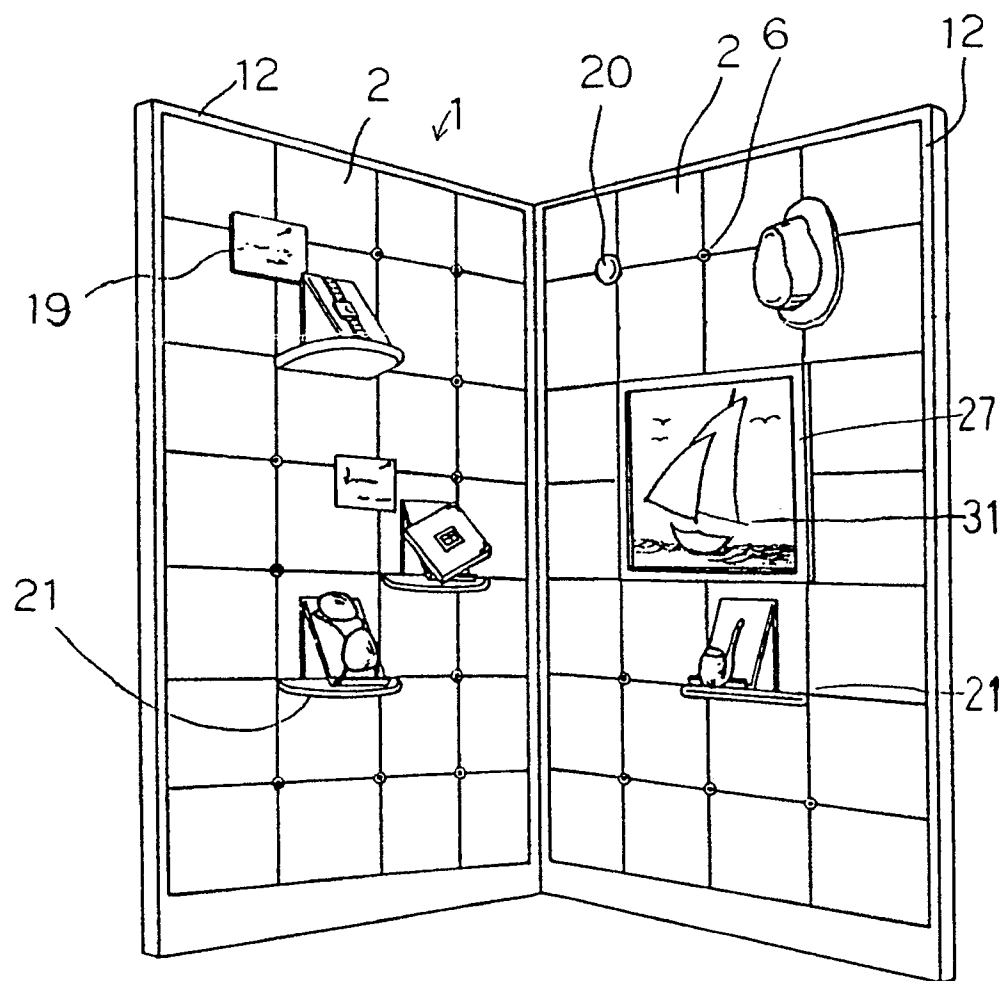

FIG.3

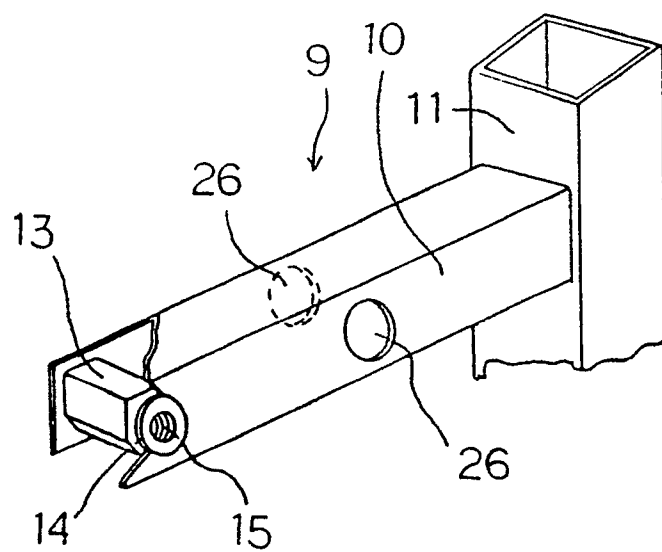

FIG.4

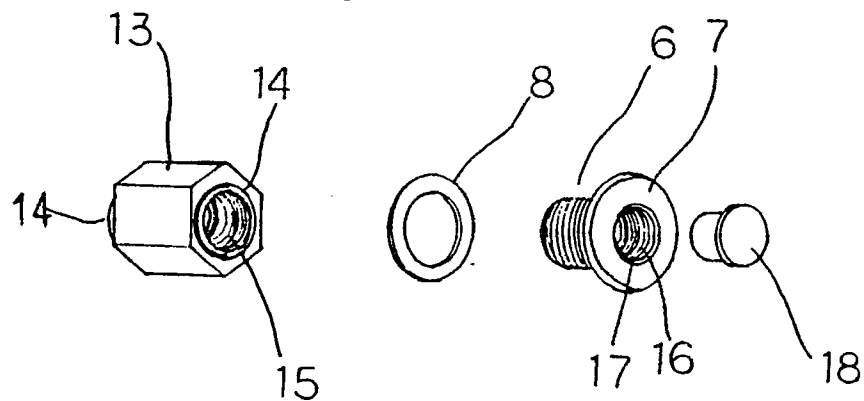

FIG.5

