

⑫

**EUROPEAN PATENT APPLICATION**

⑰ Application number: **85114249.7**

⑤① Int. Cl.<sup>3</sup>: **B 07 C 5/06**  
**B 07 C 5/14**

⑱ Date of filing: **08.11.85**

③① Priority: **20.02.85 ZA 851275**

④③ Date of publication of application:  
**27.08.86 Bulletin 86/35**

⑧⑧ Date of deferred publication of search report: **17.02.88**

⑧④ Designated Contracting States:  
**AT DE FR GB IT SE**

⑦① Applicant: **Friedenthal, Reginald**  
**2 Berwyn Road,**  
**Evans Park, Transvaal, Republic of South Africa(ZA)**

⑦① Applicant: **Robertson, Gordon MacDonald**  
**1 Field Way,**  
**Marondera, Zimbabwe(ZW)**

⑦② Inventor: **Friedenthal, Reginald**  
**2 Berwyn Road,**  
**Evans Park, Transvaal, Republic of South Africa(ZA)**

⑦② Inventor: **Robertson, Gordon MacDonald**  
**1 Field Way,**  
**Marondera, Zimbabwe(ZW)**

⑦④ Representative: **Patentanwälte Schaad, Balass & Partner**  
**Dufourstrasse 101 Postfach**  
**CH-8034 Zürich(CH)**

⑤④ **Method of and apparatus for sizing an object.**

⑤⑦ A method of, and apparatus for sorting timber logs. The logs are clamped between jaws (126,126), on a linkage mechanism (118,120), suspended from an overhead conveyor (114,202). The jaw spacing is dependent on the log diameter. The linkage mechanism is conveyed past a number of gauges (216) and, when the log diameter corresponds to a gauge setting, a cam (228) is displaced to a position at which it acts on the linkage mechanism to cause the jaws to open and release the log.

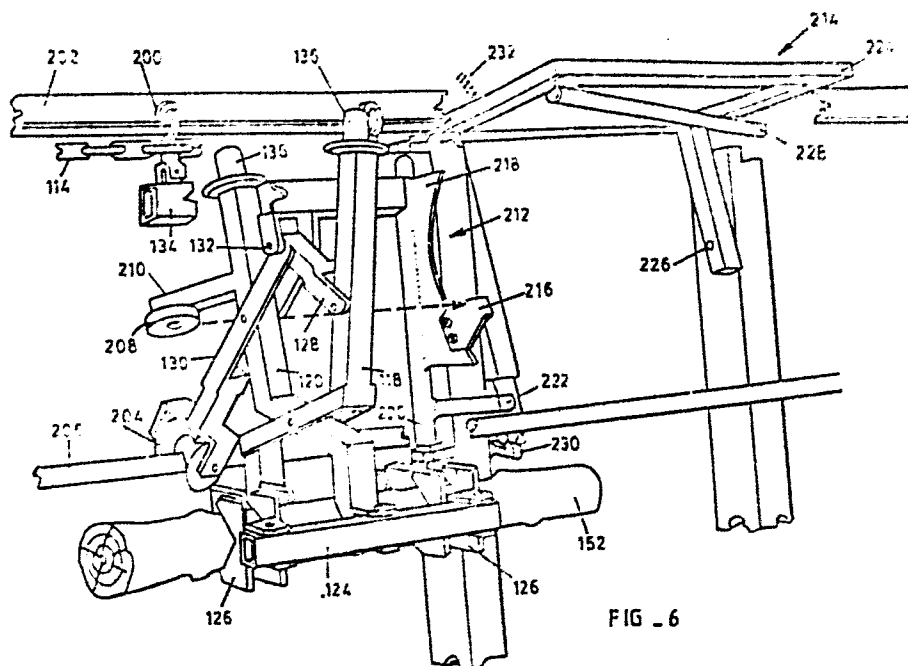

FIG. 6



DOCUMENTS CONSIDERED TO BE RELEVANT			
Category	Citation of document with indication, where appropriate, of relevant passages	Relevant to claim	CLASSIFICATION OF THE APPLICATION (Int. Cl. 4)
X	DE-C- 427 875 (JENAER GLASWERK SCHOTT & GEN.) * figure 1; page 2, line 66 - page 3, line 101 *	1-9	B 07 C 5/06 B 07 C 5/14
Y	---	10-12	
Y	US-A-3 017 850 (WHITTIER MOLDING CO.) * figures 4, 5 *	10-12	
A	--- US-A-3 815 738 (SWEET et al.) * figures 2, 4 *	1,5,6, 10	
X	--- US-A-4 474 283 (SOLAROLI) * figure 4; column 3, line 30 - column 4, line 28; column 6, lines 26-31 *	1	TECHNICAL FIELDS SEARCHED (Int. Cl. 4)
A	-----	2-12	B 07 C 5/06 B 07 C 5/07 B 07 C 5/14 B 07 C 5/36
The present search report has been drawn up for all claims			
Place of search BERLIN		Date of completion of the search 04-11-1987	Examiner BECKER
<p><b>CATEGORY OF CITED DOCUMENTS</b></p> <p>X : particularly relevant if taken alone Y : particularly relevant if combined with another document of the same category A : technological background O : non-written disclosure P : intermediate document</p> <p>T : theory or principle underlying the invention E : earlier patent document, but published on, or after the filing date D : document cited in the application L : document cited for other reasons &amp; : member of the same patent family, corresponding document</p>			