

12

EUROPEAN PATENT APPLICATION

21 Application number: **88830012.6**

51 Int. Cl.4: **B 41 F 9/10**

22 Date of filing: **12.01.88**

30 Priority: **20.02.87 IT 4001787**

43 Date of publication of application:
24.08.88 Bulletin 88/34

84 Designated Contracting States: **DE ES FR GB**

88 Date of deferred publication of search report:
03.01.90 Bulletin 90/01

71 Applicant: **SCHIAVI CESARE COSTRUZIONI**
MECCANICHE S.P.A.
Via G. Cantoni, 7
I-20144 Milano (IT)

72 Inventor: **Maggi, Luigi**
Via Boscarelli, 11
I-29100 Piacenza (IT)

74 Representative: **Lanzoni, Luciano**
c/o BUGNION S.p.A. Viale Trento Trieste, 25
I-41100 Modena (IT)

54 **A swivelling bladeholder for the wiper device of the print cylinder in a rotary printing machine.**

57 The invention falls within the art field of rotary printing machines using an intaglio print cylinder, and relates to a doctor (5) in which the wiper blade (21) is inserted in a cylindrical bar (20) held by a gripping mechanism which can be released and clamped manually so as to permit of swivelling the bar about its own longitudinal axis and varying the angle of the blade in relation to the external surface of the print cylinder.

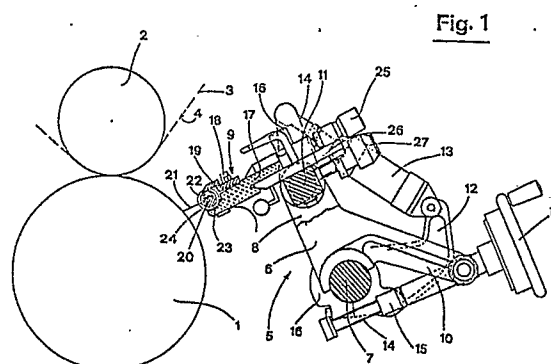



EP 88 83 0012

DOCUMENTS CONSIDERED TO BE RELEVANT			
Category	Citation of document with indication, where appropriate, of relevant passages	Relevant to claim	CLASSIFICATION OF THE APPLICATION (Int. Cl.4)
Y	US-A-2324298 (INTERCHEMICAL CORPORATION) * page 3, left-hand column, lines 4 - 39; figure 3 *	1-3	B41F9/10
Y	US-A-4122771 (GENERAL DYNAMICS) * column 3, line 4 - column 4, line 32; figures 1-5 *	1-3	
			TECHNICAL FIELDS SEARCHED (Int. Cl.4)
			B41F
The present search report has been drawn up for all claims			
Place of search THE HAGUE		Date of completion of the search 30 OCTOBER 1989	Examiner LONCKE J.W.
CATEGORY OF CITED DOCUMENTS X : particularly relevant if taken alone Y : particularly relevant if combined with another document of the same category A : technological background O : non-written disclosure P : intermediate document T : theory or principle underlying the invention E : earlier patent document, but published on, or after the filing date D : document cited in the application L : document cited for other reasons & : member of the same patent family, corresponding document			