

⑫

EUROPEAN PATENT APPLICATION

⑰ Application number: 88302335.0

⑤① Int. Cl.⁴: E 01 H 1/08

⑱ Date of filing: 17.03.88

③① Priority: 03.04.87 GB 8708048

④③ Date of publication of application:
05.10.88 Bulletin 88/40

⑥④ Designated Contracting States: DE FR NL SE

⑧⑧ Date of deferred publication of search report:
14.06.89 Bulletin 89/24

⑦① Applicant: **JOHNSTON ENGINEERING LIMITED**
Johnston House Hatchlands Road
Redhill RH1 1BG (GB)

⑦② Inventor: **Duthie, Anthony James**
4 St. Georges Gardens Kings Road
Horsham West Sussex (GB)

⑦④ Representative: **Alexander, Thomas Bruce et al**
Boulton, Wade & Tennant 27 Farnival Street
London EC4A 1PQ (GB)

⑤④ Improvements in road sweeping vehicles.

⑤⑦ A demountable suction type road sweeping vehicle (10) includes a self propelled chassis (11), road wheels (12), a subframe (14) which is supported by and removable from the chassis, an airtight container mounted on the subframe, means for generating a vacuum within the container and sweeping equipment. The sweeping equipment comprises at least one rotatable brush (18) which is movable upwardly clear of the road wheels to enable the chassis to be driven out from under the bodywork after it has been raised and supported on legs (38). This enables the chassis of vehicles which carry specialist equipment such as road sweepers, to be utilised with a range of "bodies".

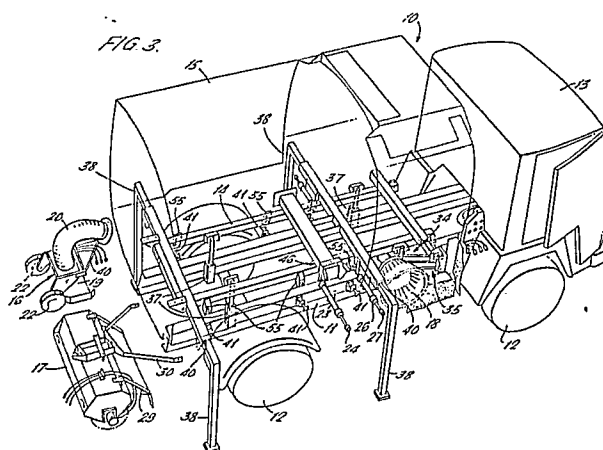



EP 88 30 2335

DOCUMENTS CONSIDERED TO BE RELEVANT			
Category	Citation of document with indication, where appropriate, of relevant passages	Relevant to claim	CLASSIFICATION OF THE APPLICATION (Int. Cl. 4)
A	EP-A-0 047 905 (A. SCHMIDT) * Whole document *	1,4,5	E 01 H 1/08

D,A	GB-A-1 592 778 (JOHNSTON BROTHERS ENGINEERING CO.) * Figures *	1	

			TECHNICAL FIELDS SEARCHED (Int. Cl. 4)
			E 01 H B 60 P
The present search report has been drawn up for all claims			
Place of search THE HAGUE		Date of completion of the search 16-03-1989	Examiner DIJKSTRA G.
CATEGORY OF CITED DOCUMENTS			
X : particularly relevant if taken alone Y : particularly relevant if combined with another document of the same category A : technological background O : non-written disclosure P : intermediate document			
T : theory or principle underlying the invention E : earlier patent document, but published on, or after the filing date D : document cited in the application L : document cited for other reasons & : member of the same patent family, corresponding document			