

12

EUROPEAN PATENT APPLICATION

21 Application number: **88500129.7**

51 Int. Cl.⁵: **B65F 1/16, B65D 21/02**

22 Date of filing: **29.12.88**

30 Priority: **05.02.88 ES 8800325 U**

43 Date of publication of application:
09.08.89 Bulletin 89/32

84 Designated Contracting States:
AT DE FR GB IT

88 Date of deferred publication of the search report:
13.06.90 Bulletin 90/24

71 Applicant: **CONTENUR S.A.**
Torneros, 3 Polig.Ind. Los Angeles
Getafe (Madrid)(ES)

72 Inventor: **Lafuente Leston, Ramón**
Santiago Bernabeu, 12
E-28036 Madrid(ES)

74 Representative: **Gonzalez Vacas, Eleuterio**
Calle Sagasta, 4
E-28004 Madrid(ES)

54 **Receptacle to contain disposable products.**

57 The invention comprises a container receptacle for disposable products, which is comprised of a receptacle (1) on which a covering lid (2) is fixed and this container has a mechanism to receive and hold this lid with which it establishes practically permanent, hermetic closure. Before it is fitted on definitively, this lid is held hinged onto the opening of the receptacle and can be placed at the completely open position, provisional closure and intermediate positions and finally in the permanently closed position. The receptacle has a radial protrusion (7) provided at both sides with each of two stubs (8) in which perforated flaps (9) are fitted which are integral with the lid (2) which also has a peripheral flap provided on the inside with a water-proof ledge (13) that fits into a saw-toothed staggered section (14) provided in the receptacle (1). The receptacle and the lid have been specifically designed to permit the stacking of loose lids and/or similar containers.

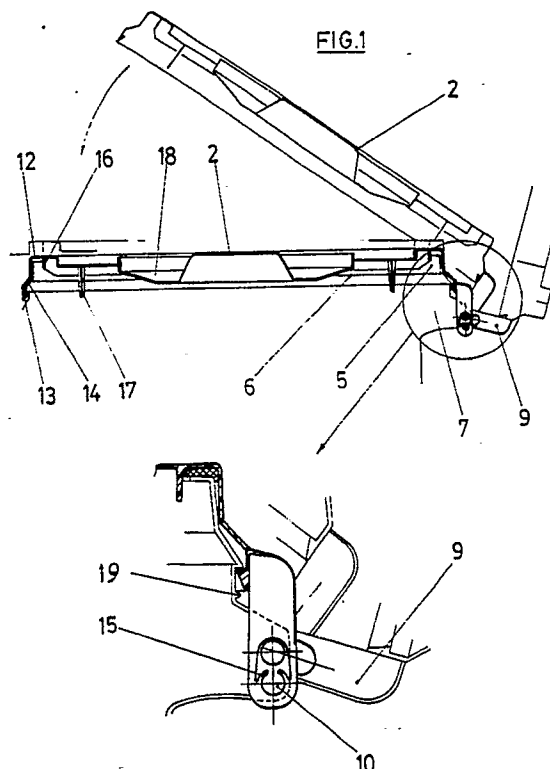

EP 0 326 779 A3



DOCUMENTS CONSIDERED TO BE RELEVANT															
Category	Citation of document with indication, where appropriate, of relevant passages	Relevant to claim	CLASSIFICATION OF THE APPLICATION (Int. Cl.4)												
Y	US-A-2 685 983 (KELLEY) * Figures 1,3; column 3, lines 18-48 * ---	1-5	B 65 F 1/16 B 65 D 21/02												
Y	US-A-4 558 799 (HAMMOND) * Figure 3; column 5, lines 50-57 * ---	1-5													
Y	DE-A-3 505 892 (GÖLDNER) * Figure 1; page 6, lines 11-25 * ---	3-5													
A	GB-A-2 130 638 (LAMBETH & MATTHEWS) * Figure 1; page 1, lines 99-108 * ---	2													
A	CH-A- 183 617 (FIAT) * Page 3; figures 1,2 * ---	2													
A	US-A-2 689 970 (PIRZ) -----														
			TECHNICAL FIELDS SEARCHED (Int. Cl.4)												
			B 65 F B 65 D E 05 D												
The present search report has been drawn up for all claims															
Place of search THE HAGUE		Date of completion of the search 02-03-1990	Examiner DEUTSCH J.P.M.												
<table border="0"><tr><td>CATEGORY OF CITED DOCUMENTS</td><td>T : theory or principle underlying the invention</td></tr><tr><td>X : particularly relevant if taken alone</td><td>E : earlier patent document, but published on, or after the filing date</td></tr><tr><td>Y : particularly relevant if combined with another document of the same category</td><td>D : document cited in the application</td></tr><tr><td>A : technological background</td><td>L : document cited for other reasons</td></tr><tr><td>O : non-written disclosure</td><td>.....</td></tr><tr><td>P : intermediate document</td><td>& : member of the same patent family, corresponding document</td></tr></table>				CATEGORY OF CITED DOCUMENTS	T : theory or principle underlying the invention	X : particularly relevant if taken alone	E : earlier patent document, but published on, or after the filing date	Y : particularly relevant if combined with another document of the same category	D : document cited in the application	A : technological background	L : document cited for other reasons	O : non-written disclosure	P : intermediate document	& : member of the same patent family, corresponding document
CATEGORY OF CITED DOCUMENTS	T : theory or principle underlying the invention														
X : particularly relevant if taken alone	E : earlier patent document, but published on, or after the filing date														
Y : particularly relevant if combined with another document of the same category	D : document cited in the application														
A : technological background	L : document cited for other reasons														
O : non-written disclosure														
P : intermediate document	& : member of the same patent family, corresponding document														