

Europäisches Patentamt
European Patent Office
Office européen des brevets



Publication number:

0 340 142 A3

(12)

EUROPEAN PATENT APPLICATION

(21) Application number: **89500042.0**

(51) Int. Cl.⁵: **H01H 43/10**

(22) Date of filing: **03.04.89**

(30) Priority: **25.04.88 ES 8801260**

(43) Date of publication of application:
02.11.89 Bulletin 89/44

(84) Designated Contracting States:
DE FR GB IT

(88) Date of deferred publication of the search report:
03.07.91 Bulletin 91/27

(71) Applicant: **COPRECI, S. COOP. LTDA.**
Avda. de Alava, 3
Arechavaleta Guipuzcoa(ES)

(72) Inventor: **Leibar Guridi, José Cruz**
Caserio Lore Toki Barrio San Agustin
Mondragon Guipuzcoa(ES)

(74) Representative: **Herrero Antolin, Julio**
HERRERO & ASOCIADOS, S.L. Alcalá, 21
E-28014 Madrid(ES)

(54) **Actuating and temporising system for devices with a timer control.**

(57) The system is applicable to devices with two cam rests, a slow cam rest and a fast cam rest, provided with a temporising element, and centres its characteristics in the fact that the said temporising element 12, assembled on an oscillating lever 24 moves from the inactive position 13 to the active position 14 by means of the intervention of a selection lever 17 and a clutch 21 which swings about an axis 22 stiffened to the lever 17, whereas the op-

posite movement, the return movement to the inactive position, is determined by the change in position of the selection lever 17 dragging clutch 21 and which in turn releases the oscillating lever 24, or only by changing the position of the clutch 21.

This system, applicable to the field of the household appliances, considerably increases programming capacity.

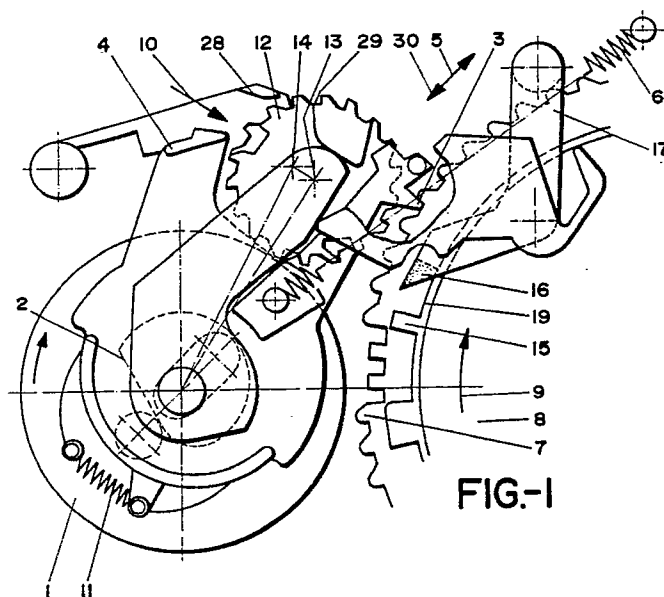

FIG.-I

EP 0 340 142 A3



European
Patent Office

EUROPEAN SEARCH REPORT

Application Number

EP 89 50 0042

DOCUMENTS CONSIDERED TO BE RELEVANT			
Category	Citation of document with indication, where appropriate, of relevant passages	Relevant to claim	CLASSIFICATION OF THE APPLICATION (Int. Cl.5)
A,D	FR-A-2 241 108 (COPRECI) * the whole document * - - -	1	H 01 H 43/10
A,D	FR-A-2 272 439 (COPRECI) * the whole document * - - -	1	
A	US-A-3 354 733 (CARTIER) * the whole document * - - - - -	1	
			TECHNICAL FIELDS SEARCHED (Int. Cl.5)
			H 01 H
The present search report has been drawn up for all claims			
Place of search The Hague		Date of completion of search 02 May 91	Examiner DESMET W.H.G.
<div>CATEGORY OF CITED DOCUMENTS</div> <div>X : particularly relevant if taken alone Y : particularly relevant if combined with another document of the same category A : technological background O : non-written disclosure P : intermediate document T : theory or principle underlying the invention</div> <div>E : earlier patent document, but published on, or after the filing date D : document cited in the application L : document cited for other reasons ----- & : member of the same patent family, corresponding document</div>			