

(19)



Europäisches Patentamt  
European Patent Office  
Office européen des brevets



(11) Publication number:

**0 436 955 A3**

(12)

**EUROPEAN PATENT APPLICATION**(21) Application number: **90125761.8**(51) Int. Cl.<sup>5</sup>: **G03G 15/20**(22) Date of filing: **28.12.90**(30) Priority: **09.01.90 JP 2317/90**(43) Date of publication of application:  
**17.07.91 Bulletin 91/29**(84) Designated Contracting States:  
**DE FR GB IT**(88) Date of deferred publication of the search report:  
**01.07.92 Bulletin 92/27**(71) Applicant: **CANON KABUSHIKI KAISHA**  
**30-2, 3-chome, Shimomaruko, Ohta-ku**  
**Tokyo(JP)**(72) Inventor: **Kimura, Shigeo, c/o Canon**  
**Kabushiki Kaisha**  
**3-30-2 Shimomaruko, Ohta-ku****Tokyo(JP)**Inventor: **Kusaka, Kensaku, c/o Canon****Kabushiki Kaisha****3-30-2 Shimomaruko, Ohta-ku****Tokyo(JP)**Inventor: **Hosoi, Atsushi, c/o Canon Kabushiki**  
**Kaisha****3-30-2 Shimomaruko, Ohta-ku****Tokyo(JP)**Inventor: **Yamamoto, Akira, c/o Canon****Kabushiki Kaisha****3-30-2 Shimomaruko, Ohta-ku****Tokyo(JP)**(74) Representative: **Tiedtke, Harro, Dipl.-Ing. et al**  
**Patentanwälte Tiedtke-Bühling- Kinne &**  
**Partner Bavariaring 4 POB 20 24 03**  
**W-8000 München 2(DE)**(54) **Set temperature changeable image fixing apparatus.**

(57) An image fixing apparatus (11) includes a heater (20) maintained at a controlled temperature; a film (25) contacted to the heater (20) and movable together with and in sliding contact with a recording material (P) carrying a visualized image, wherein the visualized image is heated by the heater (20) through the film (25); a temperature detecting element (31) for detecting a temperature of the film (25) or a member contacted to the film; and a controller (M) for changing a level of the controlled temperature on the basis of an output of the temperature detecting element (31) before start of an image fixing operation of the image fixing apparatus.

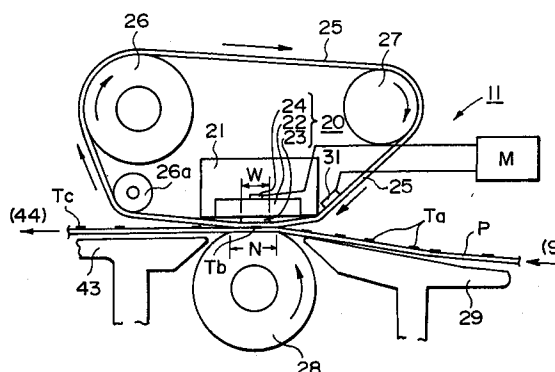
**FIG. 1****EP 0 436 955 A3**



European Patent  
Office

## EUROPEAN SEARCH REPORT

Application Number

EP 90 12 5761

DOCUMENTS CONSIDERED TO BE RELEVANT			
Category	Citation of document with indication, where appropriate, of relevant passages	Relevant to claim	CLASSIFICATION OF THE APPLICATION (Int. Cl.5)
A	EP-A-0 222 120 (IBM) * column 5, line 38 - column 6, line 32 * * column 8, line 41 - line 55; figures 3,8 * ---	1-3, 12	G03G15/20
A	EP-A-0 295 901 (CANON K. K.) * column 11, line 45 - column 12, line 17 * * column 13, line 36 - line 44; figure 4 * ---	1,6-12	
A	DE-A-2 653 486 (REINHOLD H. EPPING ET AL.) * page 9, paragraph 2 -paragraph 3; figure 2 * -----	1,12	
			TECHNICAL FIELDS SEARCHED (Int. Cl.5)
			G03G
The present search report has been drawn up for all claims			
Place of search THE HAGUE		Date of completion of the search 21 APRIL 1992	Examiner TREPP E. A.
<b>CATEGORY OF CITED DOCUMENTS</b> X : particularly relevant if taken alone Y : particularly relevant if combined with another document of the same category A : technological background O : non-written disclosure P : intermediate document T : theory or principle underlying the invention E : earlier patent document, but published on, or after the filing date D : document cited in the application L : document cited for other reasons ----- & : member of the same patent family, corresponding document			