

(19)



Europäisches Patentamt  
European Patent Office  
Office européen des brevets



(11) Publication number:

**0 441 387 A3**

(12)

**EUROPEAN PATENT APPLICATION**(21) Application number: **91101715.0**(51) Int. Cl.<sup>5</sup>: **H01J 61/70, H01J 61/36,  
H01J 61/78**(22) Date of filing: **07.02.91**(30) Priority: **08.02.90 JP 27073/90**(43) Date of publication of application:  
**14.08.91 Bulletin 91/33**(84) Designated Contracting States:  
**DE GB**(88) Date of deferred publication of the search report:  
**15.04.92 Bulletin 92/16**(71) Applicant: **TOSHIBA LIGHTING &  
TECHNOLOGY CORPORATION**  
**4-28, Mita 1-chome**  
**Minato-ku Tokyo(JP)**(72) Inventor: **Kikuchi, Kuniharu**  
**5-20-15-106, Arima**  
**Miyamae-ku, Kawasaki-shi(JP)**(74) Representative: **Henkel, Feiler, Hänzel &  
Partner**  
**Möhlstrasse 37**  
**W-8000 München 80(DE)**(54) **Low pressure gas discharge lamp.**

(57) The present invention provides a low pressure gas discharge lamp comprising a light-emitting bulb (1) having a pinch seal portion (2) formed in an end portion of said bulb, an exhaust tube (11) airtightly inserted into and arranged at said pinch seal portion, a lead wire (8) airtightly inserted into and arranged at said pinch seal portion, a pair of electrodes (4), (5)

generating discharge therebetween, one of which is positioned in the bulb and jointed to the one lead wire, wherein the tube and the one lead wire are located side by side so that a central axis of the bulb is positioned between the tube and the one lead wire.

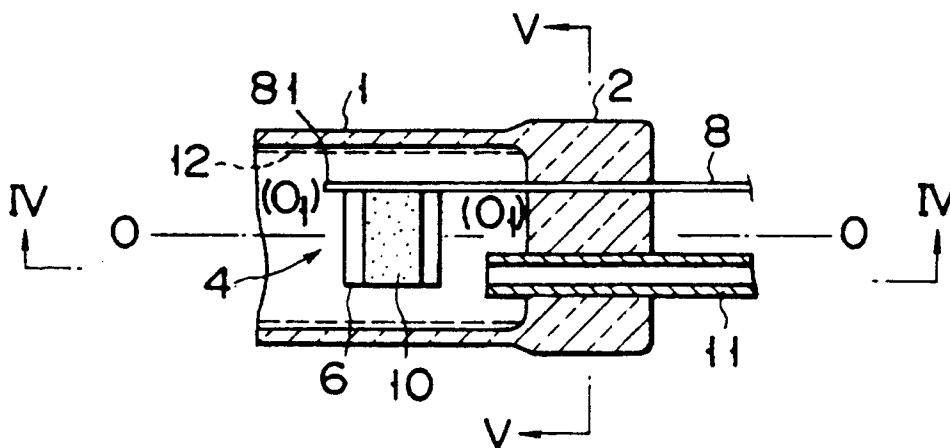
**FIG. 2****EP 0 441 387 A3**



European Patent  
Office

## EUROPEAN SEARCH REPORT

Application Number

EP 91 10 1715

| DOCUMENTS CONSIDERED TO BE RELEVANT   |   |  |   |
|---|---|--|---|
| Category  | Citation of document with indication, where appropriate, of relevant passages   | Relevant to claim                                    | CLASSIFICATION OF THE APPLICATION (Int. Cl.5) |
| A   | INFORMATION DISPLAY.<br>vol. 5, no. 11, November 1989, NEW YORK US<br>pages 8 - 13;<br>W. B. MERCER ET AL.: 'Fluorescent backlights for<br>LCDs'<br>* page 13, left column, line 15 - line 16;<br>figures 1,2 *<br>* Advertisement on page 13 * | 1,2,5,6,<br>8,9                                      | H01J61/70<br>H01J61/36<br>H01J61/78           |
| A   | US-A-2 056 665 (FRECH)<br>* page 1, right column, line 47 - line 50;<br>figure 1 *  | 1,2,5,6  |   |
| A   | PATENT ABSTRACTS OF JAPAN<br>vol. 13, no. 78 (E-718)(3426) 22 February 1989<br>& JP-A-63 259 958 ( TOSHIBA CORP ) 27 October<br>1988<br>* abstract *  | 1,3,5,6  |   |
| A   | US-A-2 153 009 (SCOTT)<br>* column 1, line 39 - line 43; claims; figure 1<br>*  | 3,7  | TECHNICAL FIELDS<br>SEARCHED (Int. Cl.5)      |
|   |   |  | H01J  |
| The present search report has been drawn up for all claims  |   |  |   |
| Place of search<br>THE HAGUE  |   | Date of completion of the search<br>04 FEBRUARY 1992 | Examiner<br>MARTIN Y VICENTE M.               |
| <b>CATEGORY OF CITED DOCUMENTS</b><br>X : particularly relevant if taken alone<br>Y : particularly relevant if combined with another<br>document of the same category<br>A : technological background<br>O : non-written disclosure<br>P : intermediate document<br>T : theory or principle underlying the invention<br>E : earlier patent document, but published on, or<br>after the filing date<br>D : document cited in the application<br>L : document cited for other reasons<br>.....<br>& : member of the same patent family, corresponding<br>document |   |  |   |