



Europäisches Patentamt
European Patent Office
Office européen des brevets



Publication number: **0 475 318 A3**

EUROPEAN PATENT APPLICATION

Application number: **91115200.7**

Int. Cl.⁵: **A42B 3/22**

Date of filing: **09.09.91**

Priority: **12.09.90 JP 240032/90**

Applicant: **DAINIPPON INK AND CHEMICALS, INC.**
35-58, Sakashita 3-chome
Itabashi-ku Tokyo(JP)

Date of publication of application:
18.03.92 Bulletin 92/12

Inventor: **Kurai, Naoki**
10-5, Shinmei 3-chome
Hino-shi, Tokyo(JP)

Designated Contracting States:
DE ES FR GB IT

Date of deferred publication of the search report:
15.04.92 Bulletin 92/16

Representative: **Patentanwälte Grünecker, Kinkeldey, Stockmair & Partner**
Maximilianstrasse 58
W-8000 München 22(DE)

Protective helmet used in driving vehicle.

A protective helmet which a driver wears in driving a vehicle which comprises a helmet body (30) having a front opening; a windshield plate (5) detachably coupled to the helmet body in such a manner as to close and open the front opening of the helmet; a pair of locking substrates (8) secured to the helmet body (30) at both sides thereof; a pair of windshield plate locking elements (12) provided on both sides and a pair of windshield plate cover members (19) provided on both sides. Each locking substrate (8) includes a first annular axis portion (2) and a second annular axis portion (4) provided outside the first annular axis portion (2) so that the second annular axis portion (4) is coaxial with the first annular axis portion (2), and elastic pawls (6 and 7) formed above and below the axis portions which are bendable to lock or unlock the windshield plate (5). Each windshield plate locking element (12) including an annular rotary axis portion (9) rotatably put on the first annular axis portion (2), a cut (10) formed in the outer periphery of the annular rotary axis portion (9), and a lever (11) extended from the outer periphery of the annular rotary axis portion (9). Each windshield plate cover member (19) is detachably engaged with the locking section of the windshield plate (5) and the windshield plate locking element (12) with the locking substrate (8) from

above.

FIG. 7

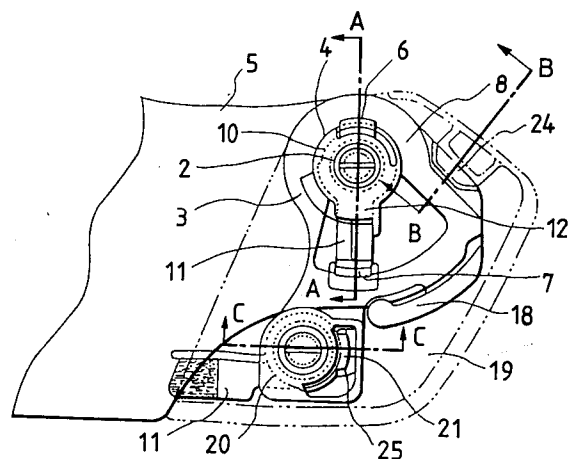

EP 0 475 318 A3



**EUROPEAN SEARCH
REPORT**

DOCUMENTS CONSIDERED TO BE RELEVANT

Category	Citation of document with indication, where appropriate, of relevant passages	Relevant to claim	CLASSIFICATION OF THE APPLICATION (Int. Cl.5)
A	EP-A-0 294 676 (M. ARAI) * column 4, line 14 - column 8, line 13 * * figures **	1,4	A 42 B 3/22
D	(& JP-A-63 309 612 (.....)) - - -		
P,A	PATENT ABSTRACTS OF JAPAN vol. 14, no. 548 (C-785)5 December 1990 & JP-A-02 234 906 (DAINIPPON INK & CHEM INC) 18 September 1990 * abstract **	1,4	
A	JP-U-64 010 035 (.....) * figures 2,6 **	1,2,6	
A	FR-A-2 518 375 (UVEX WINTER OPTIK GMBH) - - - - -		
The present search report has been drawn up for all claims			
Place of search			TECHNICAL FIELDS SEARCHED (Int. Cl.5)
The Hague			A 42 B
Date of completion of search			
13 February 92			
Examiner			
BOURSEAU A.M.			
CATEGORY OF CITED DOCUMENTS X : particularly relevant if taken alone Y : particularly relevant if combined with another document of the same category A : technological background O : non-written disclosure P : intermediate document T : theory or principle underlying the invention		E : earlier patent document, but published on, or after the filing date D : document cited in the application L : document cited for other reasons & : member of the same patent family, corresponding document	