



(11) Publication number : **0 490 643 A3**

(12)

EUROPEAN PATENT APPLICATION

(21) Application number : **91311480.7**

(51) Int. Cl.⁵ : **B41J 9/44, B41J 9/28**

(22) Date of filing : **10.12.91**

(30) Priority : **11.12.90 US 625569**

(43) Date of publication of application :
17.06.92 Bulletin 92/25

(84) Designated Contracting States :
DE FR GB

(88) Date of deferred publication of search report :
21.10.92 Bulletin 92/43

(71) Applicant : **XEROX CORPORATION**
Xerox Square
Rochester New York 14644 (US)

(72) Inventor : **Gottwald, Johannes F.**
1030 S. Chester Avenue
Park Ridge, IL, 60068 (US)
Inventor : **Gruber, Dennis W.**
1702 S. Fernandez
Arlington Heights, IL, 60005 (US)

(74) Representative : **Weatherald, Keith Baynes et al**
Rank Xerox Patent Department Albion House,
55 New Oxford Street
London WC1A 1BS (GB)

(54) **Impact printers.**

(57) An impact printer (10) includes a platen (18), a carriage (32) mounted for reciprocating movement generally parallel to the platen, a rotatable print element (50) having character imprinting portions disposed thereon, the characters being assigned a class designation according to their imprinting area, a print element selector for moving the print element to position a selected character portion at a printing position, a hammer (82) for driving the character portions to deform the platen, and means for driving the hammer toward and away from the platen. Different impact speeds are assigned to the hammer in accordance with the character portion class designations. The rate of hammer displacement is varied as it is moved from a home position to an impact position so that the hammer initially moves through a first region at an increasing speed and subsequently moves through a second region at a substantially-constant speed. A counter is incremented periodically in response to the hammer movement for determining the instantaneous location and speed of the hammer, and the counter is reset with a predetermined count, notwithstanding the actual count, at a location within the second region.

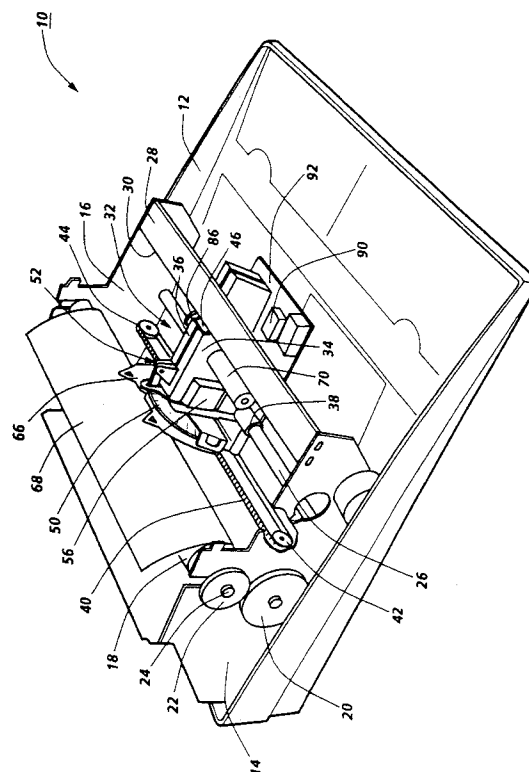

Fig. 1



European Patent
Office

EUROPEAN SEARCH REPORT

Application Number

EP 91 31 1480

DOCUMENTS CONSIDERED TO BE RELEVANT			
Category	Citation of document with indication, where appropriate, of relevant passages	Relevant to claim	CLASSIFICATION OF THE APPLICATION (Int. Cl.5)
A	PATENT ABSTRACTS OF JAPAN vol. 10, no. 336 (M-535)(2392) 14 November 1986 & JP-A-61 141 574 (HIROJI IWAI) 28 June 1986 * abstract * ---	1-10	B41J9/44 B41J9/28
A	FR-A-2 622 509 (TA TRIUMPH ADLER A.G.) * the whole document * ---	1,8	
A	GB-A-2 086 093 (XEROX CORPORATION) * the whole document * ---	1,8	
A	NL-A-7 604 474 (TEALTRONIC NEDERLAND B.V.) * the whole document * -----	1,8	
			TECHNICAL FIELDS SEARCHED (Int. Cl.5)
			B41J
The present search report has been drawn up for all claims			
Place of search THE HAGUE		Date of completion of the search 20 AUGUST 1992	Examiner VAN DEN MEERSCHAUT G
<p>CATEGORY OF CITED DOCUMENTS</p> <p>X : particularly relevant if taken alone Y : particularly relevant if combined with another document of the same category A : technological background O : non-written disclosure P : intermediate document</p> <p>T : theory or principle underlying the invention E : earlier patent document, but published on, or after the filing date D : document cited in the application L : document cited for other reasons & : member of the same patent family, corresponding document</p>			

EPO FORM 150 03.92 (P0601)