

(19)



Europäisches Patentamt
European Patent Office
Office européen des brevets



(11) Publication number:

0 499 009 A1

(12)

EUROPEAN PATENT APPLICATION(21) Application number: **91600008.6**(51) Int. Cl.⁵: **E04D 1/04**(22) Date of filing: **12.07.91**(30) Priority: **14.02.91 GR 91020029**(43) Date of publication of application:
19.08.92 Bulletin 92/34(84) Designated Contracting States:
AT BE CH DE DK ES FR GB IT LI LU NL SE(71) Applicant: **CHRISTODOULIDI BROTHERS & CO. LTD.**
18 Klm. Thessaloniki-Michaniona
GR-57019 N. Kerasia-Thessaloniki(GR)(72) Inventor: **Christodoulidis, Athanasios**
Vlassi Gavrilidi 23
GR-54655 Thessaloniki(GR)
Inventor: **Christodoulidis, Stelios**
N. Kerasia, Thessaloniki
GR-57019 Thessaloniki(GR)(54) **Tile of clay of trapezoid shape, placed in perpendicular rows.**

(57) Tile of clay, in different colours, with double trapezoid front side of dimensions 437 X 254 mm und height 91 mm, and dimensions of the trapezoid part 54 mm at the base and 90 mm at the above seat, where it bears two reinforcing prominences of length 350 to 370 mm for its straight lined placing and mainly for the fastening of the one on the other during the forming of the roof, which takes place by placing tiles in perpendicular rows. This tile has three water-exits and consequently a reduced absorption, even in its perpendicular setting, with result that it is more durable in unfavorable weather-conditions.

FIGURE.2

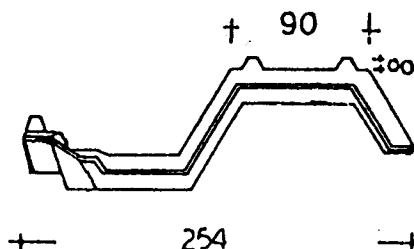
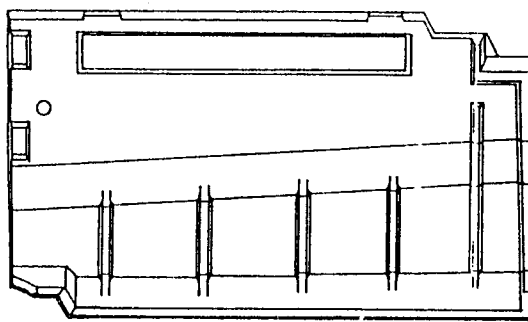

FIGURE.5

EP 0 499 009 A1

The invention is referred to a new type of tile for roofs, which is made by clay, which after having been elaborated, it is formed and burnt. The main characteristic of this tile is its shape (trapezoid) and the way according to which the roof is made (in perpendicular rows).

We had tiles by clay in the past too, but not of trapezoid shape neither with a possibility of their placing during the construction of the roof in perpendicular rows.

The shape of tile, which this invention concerns, has a front double trapezoid side with whole dimensions 437 X 254 mm, height 91 mm and dimensions of the trapezoid part 54 mm at the base and 90 mm at the above seat, where it bears two (2) sinewy prominences for its straight-lined placing and mainly for the fastening of the one tile on the other.

The prominences do not occupy the whole length of the tile and they have a length from 350 to 370 mm. They differ 10 mm in the different production-forms.

The tile in its final form, is taken at the colours of tile, brown, black, red and with a camouflageelaboration (staining) in all-colours.

Concerning the construction of the roof, it is formed with the placing of tiles in perpendicular rows.

The tile, with the form and shape according to this invention is made in three (3) sizes, with basic size the described and presented one at the designs and with declinations per 20% minimum and 20% maximum. The thickness at the three sizes remains the same, while the weight at the basic size is from 3,3 to 4 kilograms with proportionate declinations to the two (2) other sizes.

Finally with the proper admixture, the type with insulating qualities at temperature and sound is succeeded.

Advantages of this invention are the following:

The described tile has three (3) water-exits, with result that the flow of rain-water is facilitated and its absorption is reduced, which means a greater endurance in unfavorable conditions.

This tile can be placed in perpendicular rows, with the same results, concerning the free flow of water and its reduced absorption.

Finally, its esthetic sight on houses roofs is improved doubtlessly, because of its trapezoid shape and variety of colours, in which it can be made.

At the designs, which are shown, the different sides of the described tile are presented, in its basic size, that is to say the front, the above, the below and the back side and the trapezoid part of the base and above seat.

So, with the above presentation in combination with the designs too, it vecomes understood ab-

solutely the way of manufacture of this new type of tile, as well as the way of its placing on the roofs in perpendicular rows.

Claims

1. Its shape according to the design has the front side double, trapezoid with whole dimensions 437 X 254 mm, height 91 mm and dimensions of the trapezoid part 54 mm at the base and 90 mm at the above seat, which bears two neurosises, prominences for its straight lined placing and mainly for the fastening of the one on the other.
2. The prominences do not occupy the whole length of the tile and at the different production-forms, they differ per 10 mm and have a length from 350 mm to 370 mm.
3. It is made in three sizes with basic one, the found one at the design and with declinations minimum per 20% and maximum per 20%.
4. The thickness remains the same at the three sizes, while the weight is from 3,3 to 4 kilograms at the basic one, with the proportionate declinations to the two other sizes.

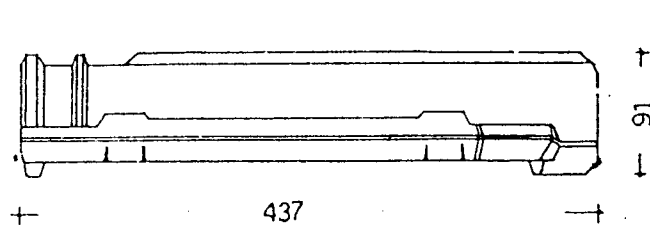

FIGURE.1

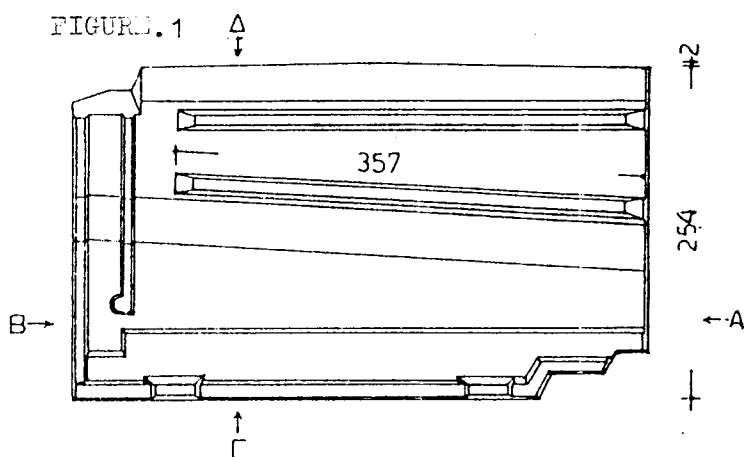

FIGURE.2

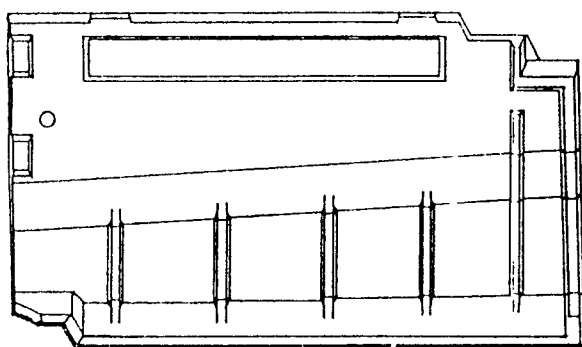

FIGURE.3

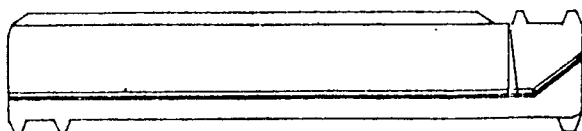

FIGURE.4

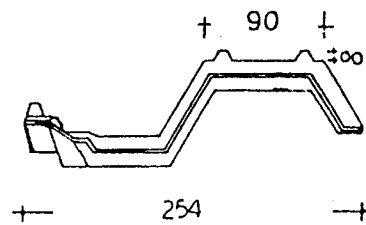

FIGURE.5

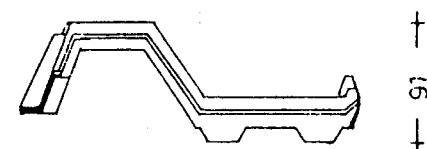

FIGURE.6

SCALE 1:5



European Patent
Office

EUROPEAN SEARCH REPORT

Application Number

EP 91 60 0008

Page 1

DOCUMENTS CONSIDERED TO BE RELEVANT

Category	Citation of document with indication, where appropriate, of relevant passages	Relevant to claim	CLASSIFICATION OF THE APPLICATION (Int. Cl.5)
X Y	FR-A-560 066 (GAMBERINI, MIRRI) * page 1, line 25 - page 1, line 56 * * page 2, line 33 - page 2, line 41 * * page 2, line 92 - page 3, line 37; figures 11,12 * Abstract ---	1,2 4	E04D1/04
Y	POLYTECHNISCH TIJDSCHRIFT B. BOUWKUNDE WATER- EN WEGENBOUW vol. 25, no. 7, 3 April 1970, STAM TIJDSCHRIFTEN BV. RIJSWIJK (NL) pages 281 - 284; SPEK: 'NIEUWS BIJ DE DAKPANNEN' * page 281, column 1 - page 282, column 1; figures 2A,12,13 * ---	4	
Y	CH-A-95 954 (HUZLI) * the whole document * ---	1,2	
Y	FR-A-2 122 937 (VARDANEGA) * claim 1; figures 1-7 * ---	1,2	TECHNICAL FIELDS SEARCHED (Int. Cl.5)
A	FR-A-1 242 153 (LE MATERIEL CERAMIQUE MODERNE) * page 2, column 1, paragraph 4; figure 5 * ---	1	E04D
A	CAHIERS DU CENTRE SCIENTIFIQUE ET TECHNIQUE DU B'TIMENT vol. 1898, no. 244, November 1983, PARIS (FR) pages 1 - 2; CHABREL: 'RHODANIENNE, Constat de traditionalité sur la tuile de terre cuite n° 5/40,21-18' Caractéristiques nominales, dimensionnelles * page 2; figures 1-4 * ---	1-4	
A	FR-A-1 159 786 (GRIMAL) --- -/--		
The present search report has been drawn up for all claims			
Place of search THE HAGUE		Date of completion of the search 23 APRIL 1992	Examiner HENDRICKX X.
CATEGORY OF CITED DOCUMENTS X : particularly relevant if taken alone Y : particularly relevant if combined with another document of the same category A : technological background O : non-written disclosure P : intermediate document T : theory or principle underlying the invention E : earlier patent document, but published on, or after the filing date D : document cited in the application L : document cited for other reasons & : member of the same patent family, corresponding document			



DOCUMENTS CONSIDERED TO BE RELEVANT			
Category	Citation of document with indication, where appropriate, of relevant passages	Relevant to claim	CLASSIFICATION OF THE APPLICATION (Int. Cl.5)
A	CAHIERS DU CENTRE SCIENTIFIQUE ET TECHNIQUE DU B ^Â TIMENT vol. 1739, no. 224, November 1981, PARIS (FR) pages 1 - 3; CHEMILLIER: 'V.J.P. Constat de traditionalité sur la tuile de terre cuite pour toitures à faible pente, n ^o 5/40.21-13' -----		
			TECHNICAL FIELDS SEARCHED (Int. Cl.5)
The present search report has been drawn up for all claims			
Place of search THE HAGUE		Date of completion of the search 23 APRIL 1992	Examiner HENDRICKX X.
CATEGORY OF CITED DOCUMENTS X : particularly relevant if taken alone Y : particularly relevant if combined with another document of the same category A : technological background O : non-written disclosure P : intermediate document T : theory or principle underlying the invention E : earlier patent document, but published on, or after the filing date D : document cited in the application L : document cited for other reasons & : member of the same patent family, corresponding document			