

(19)



Europäisches Patentamt
European Patent Office
Office européen des brevets



(11) Publication number:

0 513 585 A3

(12)

EUROPEAN PATENT APPLICATION(21) Application number: **92107192.4**(51) Int. Cl.⁵: **B41J 2/325**(22) Date of filing: **28.04.92**

(30) Priority: **14.05.91 JP 33244/91 U**
25.06.91 JP 152873/91

(43) Date of publication of application:
19.11.92 Bulletin 92/47

(84) Designated Contracting States:
DE FR GB

(86) Date of deferred publication of the search report:
26.05.93 Bulletin 93/21

(71) Applicant: **ROHM CO., LTD.**
21, Saiin Mizosaki-cho Ukyo-ku
Kyoto(JP)

(72) Inventor: **Tagashira, Fumiaki, c/o Rohm Co., Ltd.**
21, Saiin Mizosaki-cho
Ukyo-ku, Kyoto(JP)
Inventor: **Ooyama, Shingo, c/o Rohm Co., Ltd.**
21, Saiin Mizosaki-cho
Ukyo-ku, Kyoto(JP)
Inventor: **Ota, Shigeo, c/o Rohm Co., Ltd.**
21, Saiin Mizosaki-cho
Ukyo-ku, Kyoto(JP)
Inventor: **Kishimoto, Yoshinobu, c/o Rohm Co., Ltd.**
21, Saiin Mizosaki-cho
Ukyo-ku, Kyoto(JP)

(74) Representative: **Reinhard, Skuhra, Weise**
Friedrichstrasse 31
W- 8000 München 40 (DE)

(54) **Printing unit incorporating thermal head.**

(57) A printing unit comprises an elongate base member (1), a thermal head (2) mounted on the base member and carrying a line (3) of heating dots, a platen roller (4) arranged to contact the heating dot line, and a backup roller (5) arranged farther from the thermal head than the platen roller but held parallel to the platen roller in contact therewith. Printing paper (14) is transferred between the thermal head and the platen roller for thermal printing by the line of heating dots. The backup roller is located ahead of the platen roller with respect to the paper transfer direction to prevent the platen roller from bending in the paper transfer direction.

Fig. 1

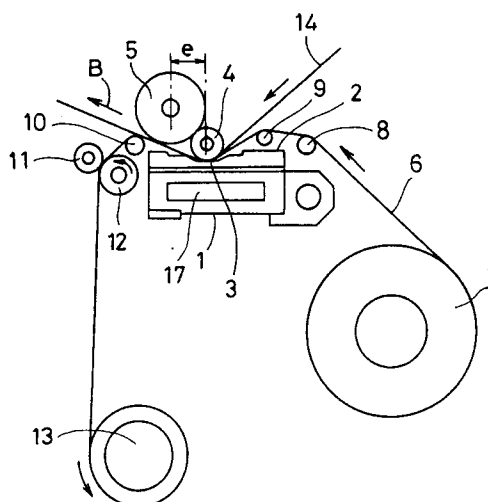
**EP 0 513 585 A3**



European Patent
Office

EUROPEAN SEARCH REPORT

Application Number

EP 92 10 7192

DOCUMENTS CONSIDERED TO BE RELEVANT			
Category	Citation of document with indication, where appropriate, of relevant passages	Relevant to claim	CLASSIFICATION OF THE APPLICATION (Int. Cl.5)
Y	PATENT ABSTRACTS OF JAPAN vol. 12, no. 149 (M-694)10 May 1988 & JP-A-62 268 677 (MITSUBISHI ELECTRIC CORP.) 21 November 1987	1	B41J2/325
A	* abstract *	2	

Y	EP-A-0 254 420 (CANON K. K.) * column 47, line 28 - line 35; figures 54-56 * * column 48, line 32 - line 42 *	1	

A	US-A-4 989 017 (G. ODA ET AL.) * column 6, line 14 - line 18; claims 5,6; figures 5,6 *	3	

A	US-A-4 819 011 (Y. YOKOTA) * column 2, line 55 - line 58 * * column 4, line 43 - line 59; figures 2,8-10 *	3,4	

			TECHNICAL FIELDS SEARCHED (Int. Cl.5)
			B41J
The present search report has been drawn up for all claims			
Place of search THE HAGUE		Date of completion of the search 19 MARCH 1993	Examiner FONTENAY P.H.
CATEGORY OF CITED DOCUMENTS X : particularly relevant if taken alone Y : particularly relevant if combined with another document of the same category A : technological background O : non-written disclosure P : intermediate document T : theory or principle underlying the invention E : earlier patent document, but published on, or after the filing date D : document cited in the application L : document cited for other reasons & : member of the same patent family, corresponding document			