



(11) Publication number : **0 529 810 A3**

(12) **EUROPEAN PATENT APPLICATION**

(21) Application number : **92306875.3**

(51) Int. Cl.⁵ : **B65H 39/14, B31B 1/90,
B65H 37/04**

(22) Date of filing : **28.07.92**

(30) Priority : **30.07.91 GB 9116496**
21.07.92 GB 9215489

(43) Date of publication of application :
03.03.93 Bulletin 93/09

(84) Designated Contracting States :
**AT BE CH DE DK ES FR GB GR IT LI LU NL PT
SE**

(88) Date of deferred publication of search report :
30.06.93 Bulletin 93/26

(71) Applicant : **Tetra Alfa Holdings S.A.**
70, Avenue Général-Guisan
CH-1009 Pully (CH)

(72) Inventor : **Mosse, Richard Wolfgang Emil**
28 Clifton Hill
GB-London NW8 0GQ (GB)

(74) Representative : **Smart, Peter John**
W.H. BECK, GREENER & CO 7 Stone Buildings
Lincoln's Inn
London WC2A 3SZ (GB)

(54) **Methods and apparatus for web handling and apparatus for heating spaced areas of a moving object.**

(57) A method and apparatus for heating separating and accelerating portions of a moving web of plastics film by leading a moving web (10) over the surface of a rotating web support member (18), which has a surface speed higher than the speed of the moving web such that the web slips on said member, periodically cutting lengths of web material from said web on said support member using a cutter (44), capturing said cut lengths on said support member by attraction of said cut lengths to the surface of said support member by vacuum applied through ports (28) via sliding valve manifolds (38, 42) and transporting said cut lengths thereon at the surface speed of the support member to be heat sealed to a second web (20) of paperboard to form pull tabs for use in opening cartons made therefrom.

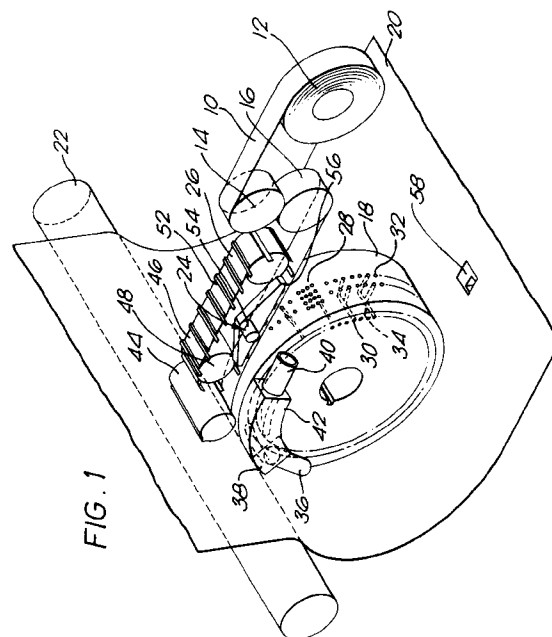



European Patent
Office

EUROPEAN SEARCH REPORT

Application Number

EP 92 30 6875

DOCUMENTS CONSIDERED TO BE RELEVANT			
Category	Citation of document with indication, where appropriate, of relevant passages	Relevant to claim	CLASSIFICATION OF THE APPLICATION (Int. Cl.5)
X	EP-A-0 355 292 (KIMBERLEY-CLARK CORPORATION) * column 2, line 40 - column 12, line 44; figures *	1-4,7-10	B 65 H 39/14 B 31 B 1/90 B 65 H 37/04
Y	---	5,11,12	
Y	GB-A-1 002 932 (A. B. TETRA) * the whole document *	5,11,12	
Y	PATENT ABSTRACTS OF JAPAN vol. 014, no. 177 (M-0960)9 April 1990 & JP-A-20 30 372 * abstract *	12	
A	US-A-4 443 211 (WOOLEY) * the whole document *	1-4,7-10	
A	DE-A-3 520 968 (PAPIERSACKFABRIK ALFRED ROCKENFELLER GMBH) * the whole document *	1,7	
A	US-A-3 226 282 (D. R. P. JACKSON) * the whole document *	1,7	TECHNICAL FIELDS SEARCHED (Int. Cl.5) B 65 H B 31 B
The present search report has been drawn up for all claims			
Place of search THE HAGUE		Date of completion of the search 08-12-1992	Examiner MEULEMANS J M B
<p>CATEGORY OF CITED DOCUMENTS</p> <p>X : particularly relevant if taken alone Y : particularly relevant if combined with another document of the same category A : technological background O : non-written disclosure P : intermediate document</p> <p>T : theory or principle underlying the invention E : earlier patent document, but published on, or after the filing date D : document cited in the application L : document cited for other reasons & : member of the same patent family, corresponding document</p>			

EPO FORM 1503 (3.82 (P0401))



European Patent
Office

CLAIMS INCURRING FEES

The present European patent application comprised at the time of filing more than ten claims.

- ☐ All claims fees have been paid within the prescribed time limit. The present European search report has been drawn up for all claims.
- ☐ Only part of the claims fees have been paid within the prescribed time limit. The present European search report has been drawn up for the first ten claims and for those claims for which claims fees have been paid, namely claims:
- ☐ No claims fees have been paid within the prescribed time limit. The present European search report has been drawn up for the first ten claims.

LACK OF UNITY OF INVENTION

The Search Division considers that the present European patent application does not comply with the requirement of unity of invention and relates to several inventions or groups of inventions,

namely:

See sheet -B-

- ☐ All further search fees have been paid within the fixed time limit. The present European search report has been drawn up for all claims.
- ☐ Only part of the further search fees have been paid within the fixed time limit. The present European search report has been drawn up for those parts of the European patent application which relate to the inventions in respect of which search fees have been paid, namely claims:
- ☒ None of the further search fees has been paid within the fixed time limit. The present European search report has been drawn up for those parts of the European patent application which relate to the invention first mentioned in the claims, namely claims: 1-5, 7-12



European Patent
Office

EP 92 30 6875 -B-

LACK OF UNITY OF INVENTION

The Search Division considers that the present European patent application does not comply with the requirement of unity of invention and relates to several inventions or groups of inventions, namely:

1. Claims 1-5,7-12 : Method and apparatus for separating and accelerating portions of a moving web.
2. Claims 6,3 : Method and apparatus for heating areas of a moving web.