



(11) Publication number : **0 617 943 A3**

(12) **EUROPEAN PATENT APPLICATION**

(21) Application number : **94302017.2**

(51) Int. Cl.⁵ : **A61G 5/04**

(22) Date of filing : **22.03.94**

(30) Priority : **22.03.93 GB 9305921**

(43) Date of publication of application :
05.10.94 Bulletin 94/40

(84) Designated Contracting States :
DE DK FR IT NL

(88) Date of deferred publication of search report :
21.12.94 Bulletin 94/51

(71) Applicant : **NESBIT EVANS HEALTHCARE LIMITED**
15 Cronin Courtyard,
Weldon South Industrial Estate
Corby, Northamptonshire NN18 8AG (GB)

(72) Inventor : **Charles, Derek Alan**
2, Connolly Drive,
Rothwell
Kettering, Northamptonshire, NN14 2JT (GB)
 Inventor : **Ruddick, Donald W.**
6, Southbrook
Corby, Northamptonshire, NN18 9BE (GB)

(74) Representative : **Goodenough, Nigel et al**
A.A. Thornton & Co.
Northumberland House
303-306 High Holborn
London WC1V 7LE (GB)

(54) **Wheelchair.**

(57) A wheelchair comprises a main frame (10) carrying front wheels (18), a battery pack (22), and a foot rest assembly (32, 34). The wheelchair is driven by means of a pair of rear wheel units each comprising a drive motor (24) and a rear wheel (20) mounted on a sub frame (42). Each rear wheel unit is removable, as a unit, by releasing fastenings (42,46) which secure the sub frame to rearwardly projecting extensions (66,68) of the wheelchair main frame. Preferably, kerb climbers are mounted on the foot rest assembly whereby the kerb climbers and foot rest assembly can be removed from the main frame as a unit. The kerb climbers are preferably pivotally mounted on the support members (34) and may be located either in a use configuration or in a storage configuration in which the kerb climbers do not extend forwardly beyond the pivotal connections with the support members (34).

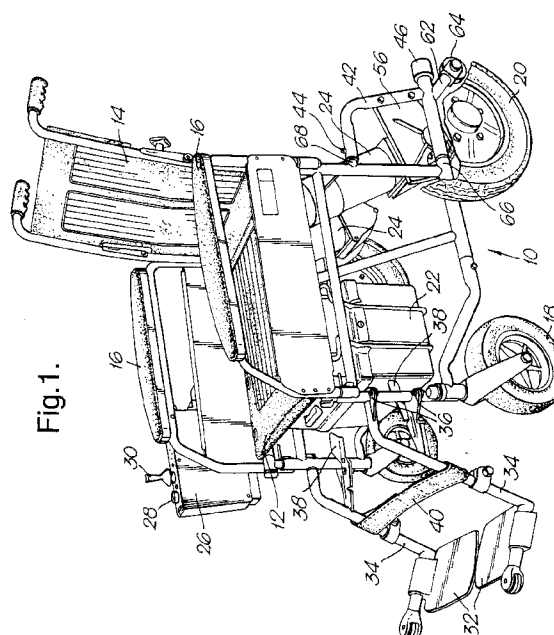

Fig. 1.



European Patent
Office

EUROPEAN SEARCH REPORT

Application Number
EP 94 30 2017

DOCUMENTS CONSIDERED TO BE RELEVANT			
Category	Citation of document with indication, where appropriate, of relevant passages	Relevant to claim	CLASSIFICATION OF THE APPLICATION (Int.Cl.5)
Y	US-A-4 067 409 (DIMATTEO ET AL.) * column 5, line 45 - line 50; figures * ---	1,2	A61G5/04
Y	DE-A-27 29 267 (WEREB) * page 10, line 34 - page 12, line 14; figures * ---	1,2	
A	GB-A-2 210 589 (THE SPASTICS SOCIETY) * figures * -----	1	
			TECHNICAL FIELDS SEARCHED (Int.Cl.5)
			A61G
The present search report has been drawn up for all claims			
Place of search THE HAGUE		Date of completion of the search 22 June 1994	Examiner GODOT, T
<p>CATEGORY OF CITED DOCUMENTS</p> <p>X : particularly relevant if taken alone Y : particularly relevant if combined with another document of the same category A : technological background O : non-written disclosure P : intermediate document</p> <p>T : theory or principle underlying the invention E : earlier patent document, but published on, or after the filing date D : document cited in the application L : document cited for other reasons ----- & : member of the same patent family, corresponding document</p>			

EPO FORM 1503 03.92 (P04.C01)



European Patent
Office

CLAIMS INCURRING FEES

The present European patent application comprised at the time of filing more than ten claims.

- ☐ All claims fees have been paid within the prescribed time limit. The present European search report has been drawn up for all claims.
- ☐ Only part of the claims fees have been paid within the prescribed time limit. The present European search report has been drawn up for the first ten claims and for those claims for which claims fees have been paid, namely claims:
- ☐ No claims fees have been paid within the prescribed time limit. The present European search report has been drawn up for the first ten claims.

LACK OF UNITY OF INVENTION

The Search Division considers that the present European patent application does not comply with the requirement of unity of invention and relates to several inventions or groups of inventions, namely:

See sheet -B-

- ☐ All further search fees have been paid within the fixed time limit. The present European search report has been drawn up for all claims.
- ☐ Only part of the further search fees have been paid within the fixed time limit. The present European search report has been drawn up for those parts of the European patent application which relate to the inventions in respect of which search fees have been paid, namely claims:
- ☒ None of the further search fees has been paid within the fixed time limit. The present European search report has been drawn up for those parts of the European patent application which relate to the invention first mentioned in the claims.

namely claims: 1-5



European Patent
Office

EP 94 30 2017 -B-

LACK OF UNITY OF INVENTION

The Search Division considers that the present European patent application does not comply with the requirement of unity of invention and relates to several inventions or groups of inventions, namely:

1. Claims 1-5: Wheelchair with two rear wheel units removable from the frame
2. Claims 6-10: Wheelchair with two swinging kerb climbers