

(19)



Europäisches Patentamt

European Patent Office

Office européen des brevets



(11)

EP 0 656 233 A3

(12)

EUROPEAN PATENT APPLICATION

(88) Date of publication A3:
06.03.1996 Bulletin 1996/10

(51) Int. Cl.⁶: B07C 5/34

(43) Date of publication A2:
07.06.1995 Bulletin 1995/23

(21) Application number: 94203500.7

(22) Date of filing: 01.12.1994

(84) Designated Contracting States:
AT BE CH DE DK FR GB LI LU NL SE

(30) Priority: 01.12.1993 NL 9302090

(71) Applicant: De Beer, Maximinus Anthonius
Josephus Maria
NL-3781 NB Voorthuizen (NL)

(72) Inventor: De Beer, Maximinus Anthonius
Josephus Maria
NL-3781 NB Voorthuizen (NL)

(74) Representative: Land, Addick Adrianus Gosling
Arnold & Siedsma,
Advocaten en Octrooigemachtigden,
Sweelinckplein 1
NL-2517 GK Den Haag (NL)

(54) Return system and package consisting of an outer package and an inner package with identification means

(57) The present invention provides a return system for processing returned packagings, comprising:

- one or more packagings provided with identification means; and
- recognition means for recognizing the identification means on the packagings.

In the case the packaging has environmentally contaminating contents such as paint or glue, the return system also comprises an inner packaging so that the (outer) packaging is returned clean. The inner packaging can then preferably comprise a tapering portion so that when the inner packaging is disposed of as waste as little material as possible with an environmental impact remains behind therein.

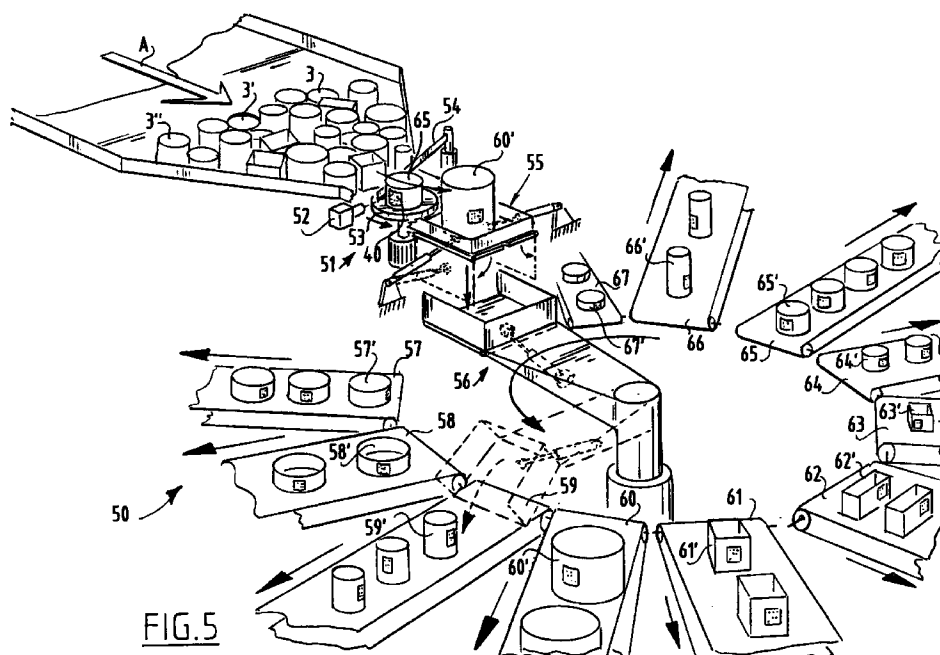

FIG. 5

EP 0 656 233 A3



European Patent
Office

EUROPEAN SEARCH REPORT

Application Number
EP 94 20 3500

DOCUMENTS CONSIDERED TO BE RELEVANT			
Category	Citation of document with indication, where appropriate, of relevant passages	Relevant to claim	CLASSIFICATION OF THE APPLICATION (Int.Cl.6)
X	US-A-4 622 875 (EMERY ET AL)	1,2	B07C5/34
Y	* the whole document *	3,4,7	

X	WO-A-85 00763 (ALEXANDER SCHOELLER & CO)	1,2	
	* abstract; figures 1-3 *		

X	WO-A-93 12017 (CHLEAN PLANTS & ENGINEERING ESTABLISHMENT)	1,2	
	* abstract; figure 1 *		

X	EP-A-0 255 861 (SCHMALBACH-LUBECA)	1,5	
	* abstract; figure 1 *		
	* column 6, line 31 - line 33; figure 6 *		

X	DE-A-38 37 657 (CONTO CONTROL HERBERT HEIDEN)	1,6	
	* the whole document *		

Y	EP-A-0 561 698 (DIFFUSION INTERNATIONALE DE MATERIEL)	3,4,7	
	* abstract; figures 1,2 *		
	* column 4, line 6 - line 11 *		

The present search report has been drawn up for all claims			TECHNICAL FIELDS SEARCHED (Int.Cl.6)
			B07C B65D
Place of search		Date of completion of the search	Examiner
THE HAGUE		11 January 1996	Forlen, G
CATEGORY OF CITED DOCUMENTS X : particularly relevant if taken alone Y : particularly relevant if combined with another document of the same category A : technological background O : non-written disclosure P : intermediate document T : theory or principle underlying the invention E : earlier patent document, but published on, or after the filing date D : document cited in the application L : document cited for other reasons ----- & : member of the same patent family, corresponding document			

EPO FORM 1503 03.82 (P04C01)