

19



Europäisches Patentamt
European Patent Office
Office européen des brevets



11 Publication number:

0 664 143 A1

12

EUROPEAN PATENT APPLICATION

21 Application number: **94118540.7**

51 Int. Cl.⁶: **A63F 7/06**

22 Date of filing: **25.11.94**

30 Priority: **19.01.94 IT MI940036 U**

43 Date of publication of application:
26.07.95 Bulletin 95/30

84 Designated Contracting States:
**AT BE CH DE DK ES FR GB GR IE LI LU MC
NL PT SE**

71 Applicant: **GRAZIOLI S.p.A.**
Via Trieste, 435
I-46010 Mosio di Acquanegra (Mantova) (IT)

72 Inventor: **Grazioli, Vittorio**
Via Beffa Negrini, 12
I-46041 Asola (Mantova) (IT)

74 Representative: **Rapisardi, Mariacristina**
Brevetti S.r.l.,
Largo V Alpini 15
I-20145 Milano (IT)

54 **Football table.**

57 The foosball table includes four legs (2) for supporting a frame (3) having a sheetlike base (4), depicting a game field, and having player supporting rods (5) which are rotatable inside bushes (7) associated with said frame. Two resilient members (8) are provided at the opposite ends of each of said bushes, said resilient members and said bushes forming a one piece body of self-lubricating plastic material provided with a connection member (9) for being associated with said frame. An edge cover (10) is provided at the bushes, also the edge cover is provided with a connection member for its association with the frame.

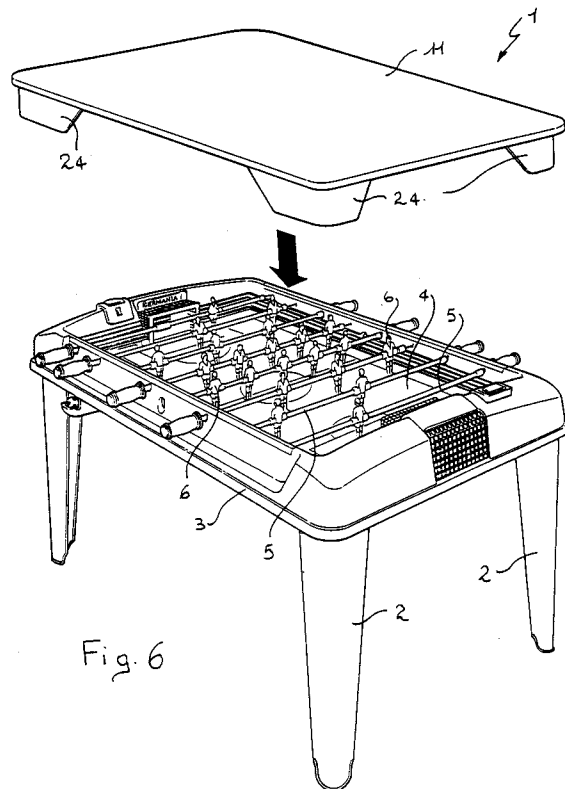

EP 0 664 143 A1

The present invention relates to a foosball table.

As known, conventional tables for playing table football, or "foosball", comprise a quadrangular frame, usually made of wood, having a base representing a miniature football field.

The frame, which is usually assembled by means of screws and/or bolts and glue, supports player bearing metallic rods, sliding in adapted bushes, fixed in respective seats formed in the frame, for example by means of an edge cover screwed on it.

On each rod, at the opposite side of the bush, there are two metallic springs adapted to prevent the grips and the end players from violently hitting the frame.

Conventional foosballs therefore have a certainly not easy assembly, because of their several connection members: screws, bolts, bushes, springs, etc., and are also bulky because, even when not in use, they occupy a great space causing problems in small rooms.

This problem is enhanced by the fact that conventional foosballs are made of materials (wood and metal) which are easily spoiled by the weather elements and the conventional foosball tables should always be kept indoors after use.

The aim of the present invention is to eliminate the above described inconveniences of the prior art.

Within this aim, an important object of the invention is to provide a foosball table that can be assembled in a short time and in an extremely easy manner, thanks to the fact that it is provided in a small number of components.

A further object of the invention is to provide a foosball table that, when not used, can be transformed into a comfortable working table so that it does not uselessly occupy space in the room.

A further object of the invention is to provide a foosball table that can be made of plastics, and without metallic materials, in order to be resistant to the weather even if left outdoors.

Still a further object of the invention is to provide a foosball table which can be assembled by snap together connection of the components. Therefore, the main components, such as the field and the players layout, can be varied in order to change type of game.

The above aim and objects are achieved by a foosball table comprising four legs for supporting a frame having a sheetlike base, depicting a game field, and comprising player supporting rods which are rotatable inside bushes associated with said frame, characterized in that two resilient members are provided at the opposite ends of each of said bushes, said resilient members and said bushes forming a one piece body of self-lubricating plastic

material provided with connection means for being associated with said frame, an edge cover being provided in said bushes, also said edge cover being provided with connection means for its association with said frame.

Further characteristics and advantages of the invention will be more apparent by the description of a preferred but not exclusive embodiment of a foosball table according to the invention, illustrated, by way of indicative but not exclusive example in the enclosed drawings wherein:

Fig. 1 is a perspective view of the foosball table according to the invention;

Fig. 2 is a perspective exploded view of the sliding bushes for the rods, with the respective edge cover of the foosball table shown in Fig. 1; Fig. 3 is a view of the extension means of the foosball legs, shown in Fig. 1 according to the invention;

Fig. 4 is a perspective exploded view of a different embodiment of the connection means of the edge cover and of the bushes to the foosball structure, according to the invention shown in Fig. 1;

Fig. 5 is a perspective exploded view of the sheetlike base which can be associated with the foosball frame, according to the invention;

Fig. 6 shows how the foosball table is transformed into a working table.

With reference to the figures, the foosball table according to the invention, generally designated by the reference numeral 1, comprises four legs, each designated by the numeral 2, for supporting a frame 3 having a sheetlike base 4, depicting a game field.

The frame 3 also has rods 5, bearing players 6, and being rotatable inside bushes 7 associated with the frame 3.

Two resilient members 8 are provided at the opposite ends of each bush 7 and, during the sliding of the rods, have the function of damping possible shocks of the grip or of the end player against the frame 3.

Advantageously, the resilient members 8 are molded with the bush 7 and, with the same bush, form a one piece body made of self-lubricating plastic material having associating means for its association with the frame 3.

In particular, in the case of snap together connection means, the connection means are generally designated by the numeral 9 and can be formed by two resilient teeth 20 which are snapped inside and adapted seat 21 formed on the frame 3.

According to a different embodiment, the connection means comprises screws 22 which can be rapidly inserted by a 90° rotation.

These solutions provide a first important advantage.

In fact, by inserting a bush on the rod, the two resilient members 8 are also automatically inserted and work as a spring.

Then, when the two bushes 7, and the respective resilient members 8, are inserted on a rod, the rod can be applied and fastened to the frame 3, in a very easy and rapid manner, by inserting associating means 9 inside the respective seats provided at the frame 3.

The second important advantage derived from this solution is that, during the game, the resilient members 8, working as springs, will always be associated with the bush 7, without annoyingly sliding along the rod 5 as in the conventional foosball tables.

It is also to be noted that, since the resilient members 8 are made of self-lubricating plastic material, as the bush 7, they are not deteriorated after a certain time as it happens with the metallic springs of conventional foosball tables.

Once the bushes 7 have been associated with the frame 3, an edge cover 10 is associated with the frame 3, above the bushes 7. Also the edge cover 10 is provided with connection means 9 defined by resilient teeth 20 or by fast insert screws 22, as described above.

It is apparent, from the above description, that by an extremely easy and rapid operation it is possible to disassemble the edge cover 10 and the bushes 7 from the frame 3, in order to vary the position of the players 6 in the field as desired.

In the same manner, in a preferred embodiment of the invention the sheetlike base 4 is provided in one piece with the frame 3, however, the base could also be removably associated with the frame 3 by snap connection means adapted to engage respective apertures 23 on the frame 3, in order to change the game field in a very short time, depending on the type of game to be played.

Furthermore, conveniently, the foosball table according to the invention comprises a cover member 11 removably associated with the frame 3 for covering the game field 4, the rods 5 and the players 6.

The cover member 11 has at least one raised portion and four corner members 24 adapted to rest on the frame 3, for levelling the cover member 11 on the foosball table.

On the opposite side, with respect of the corner members 24, the cover member has a surface defining a working table which conveniently has a transverse size substantially equal to the length of the rods in order to completely cover them preventing the rods from being of annoyance during the use of the working table.

For a more comfortable use of the foosball table when playing, or when used as a working table when the covering member 11 is applied, the

legs 2 may be easily extended by extension means defined, for example, by an extension 13.

The extension 13 may in fact be applied to the end of each leg 2, by introducing the male element 14 in a respective seat, or female element, 15, provided at the end of the legs 2.

Advantageously, the extension 13 is fixed to the leg 2 by a fixing member which may be constituted by a resilient tooth 30 which snaps inside a seat 31.

By this extremely easy and rapid application, the foosball table may be raised or lowered according to the height of the playing users, either adults or children, and when used as a working table.

It is also to be noted that the foosball table is provided with different uniforms that can be put on the players 6 for varying the playing teams.

It has been seen in practice that the foosball table according to the invention has the particular advantage of not having metallic connection elements and is therefore resistant to the weather elements and can be left outdoors.

Furthermore, the foosball table may be raised or lowered according to the need and can be covered by a working table in order to be useful even when it is not used for the foosball game.

The materials employed, as well as the dimensions, may be any according to the specific needs and the state of the art.

Where technical features mentioned in any claim are followed by reference signs, those reference signs have been included for the sole purpose of increasing the intelligibility of the claims and accordingly, such reference signs do not have any limiting effect on the scope of each element identified by way of example by such reference signs.

Claims

1. Foosball table comprising four legs (2) for supporting a frame (3) having a sheetlike base (4), depicting a game field, and having player supporting rods (5) which are rotatable inside bushes (7) associated with said frame, characterized in that two resilient members (8) are provided at the opposite ends of each of said bushes, said resilient members and said bushes forming a one piece body of self-lubricating plastic material provided with connection means (9) for being associated with said frame, an edge cover (10) being provided in said bushes, also said edge cover being provided with connection means for its association with said frame.
2. Foosball table, according to claim 1, characterized in that said connection means (9) are

adapted to rapidly fasten and unfasten said bushes (7) and said edge cover (10) to and from said frame for varying the position of said rods (5) on said frame.

- 5
3. Foosball table, according to claim 1, characterized in that it comprises a cover member (11) removably associated with said frame for covering said field (4) and said rods (5) bearing said players (6). 10
4. Foosball table, according to claim 3, characterized in that said cover member (11) has at least a raised portion (24) adapted to engage said frame and, at the opposite side, a surface defining a working table, said working table having a longitudinal size substantially equal to said frame and having a transverse size substantially equal to the length of said rods (5). 15
- 20
5. Foosball table, according to claim 1, characterized in that it comprises extension means (13) of said legs for varying the height of said frame with respect of the floor. 25
6. Foosball table, according to claim 5, characterized in that said extension means (13) comprises an extension (13) having at least one male element (14) adapted to be inserted into at least one female element (15) provided at the end of said legs, a snap fixing member (30) being also provided for fixing said extension to each of said legs. 30
7. Foosball table, according to claim 1, characterized in that said sheetlike base (4) is removably associated with said frame by connection means (9) for being replaced according to the games to be played. 35
- 40
8. Foosball table, according to claim 1, characterized in that it comprises uniforms of different teams that can be exchanged on said players. 45
- 50
- 55

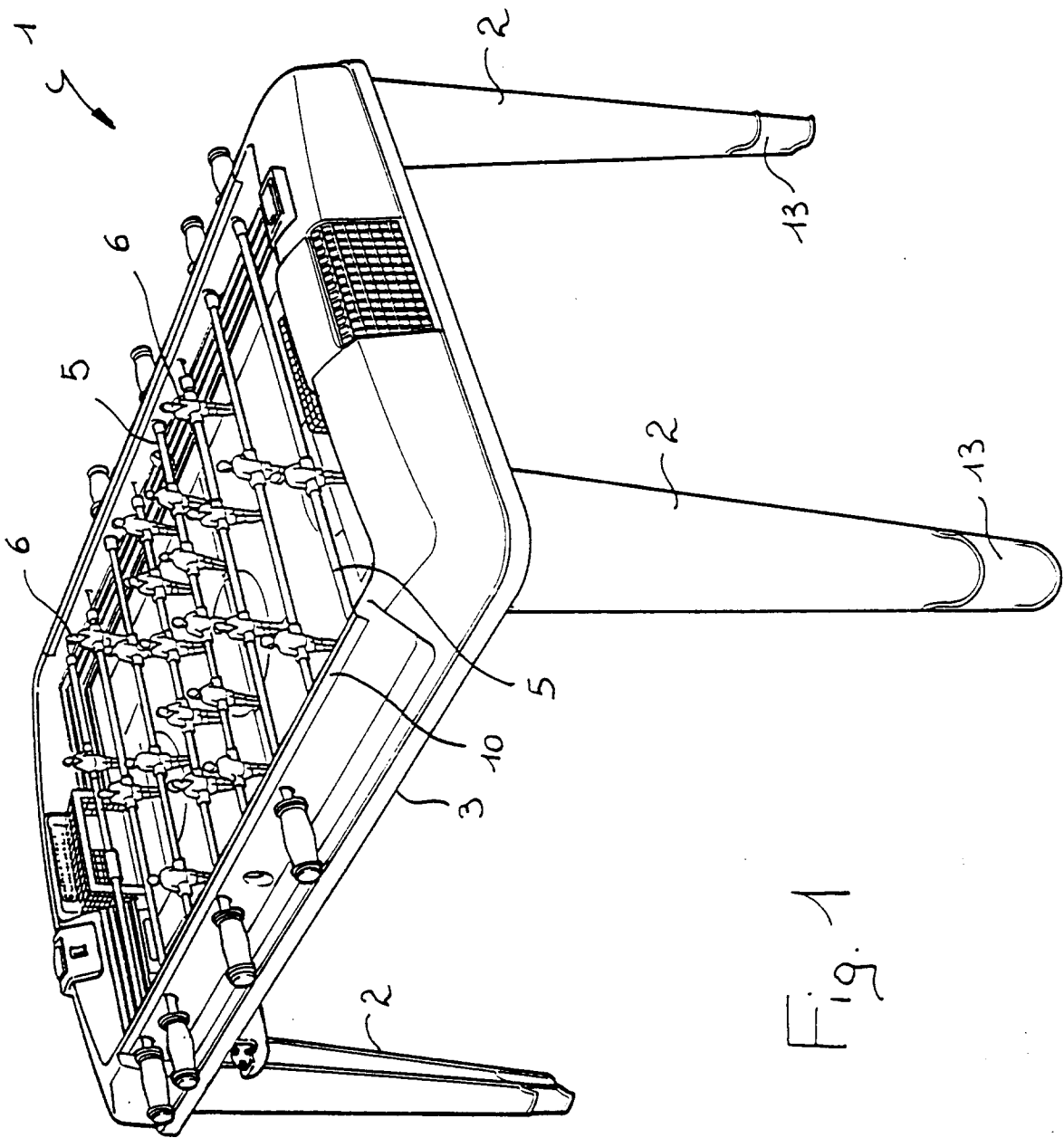
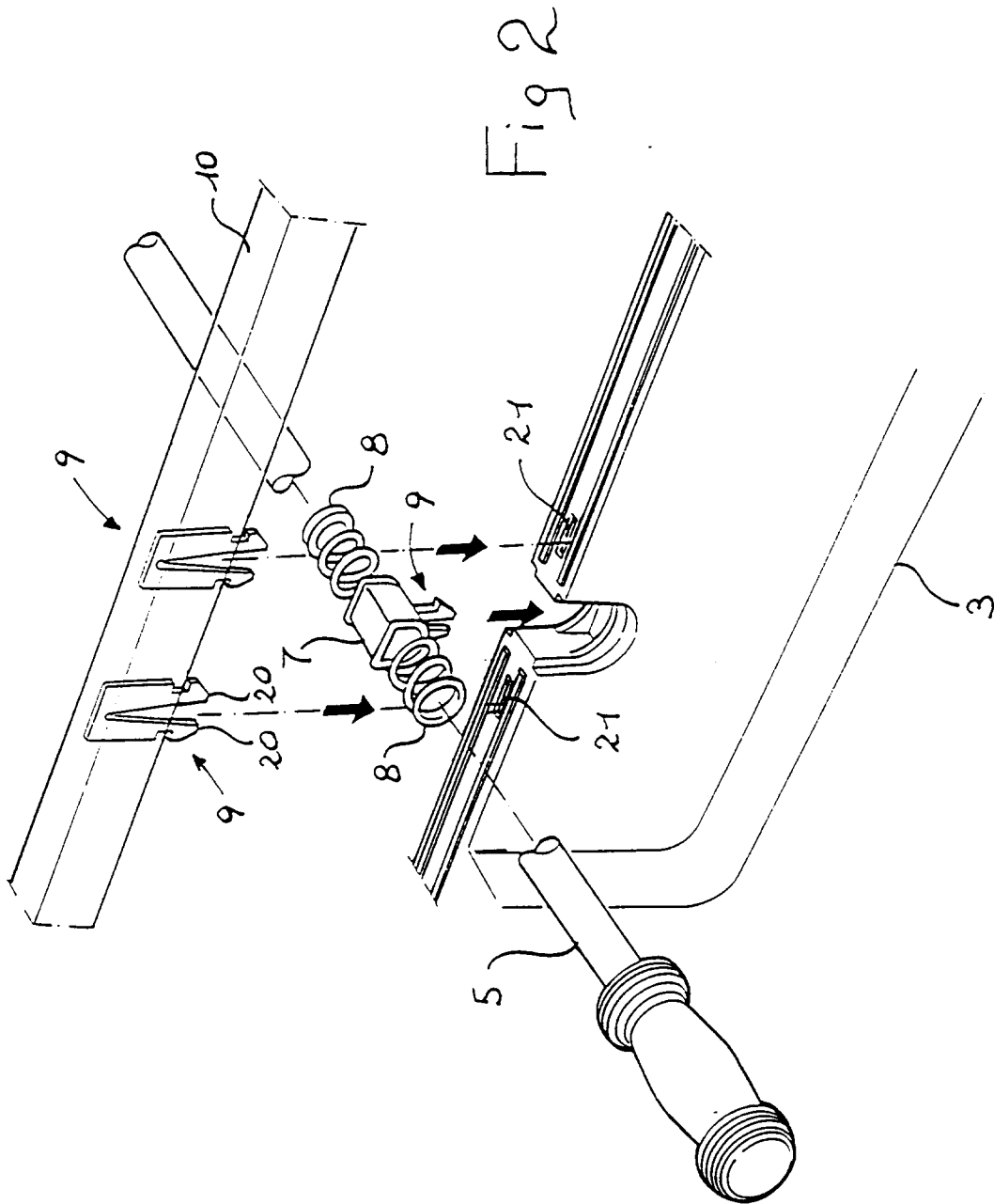
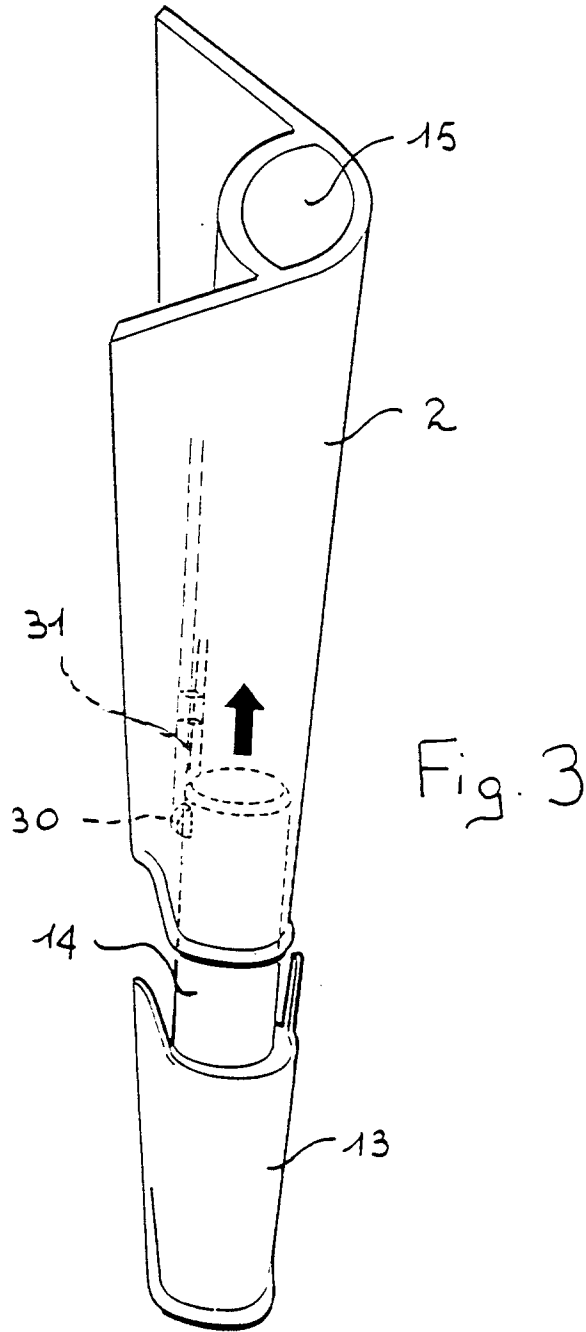
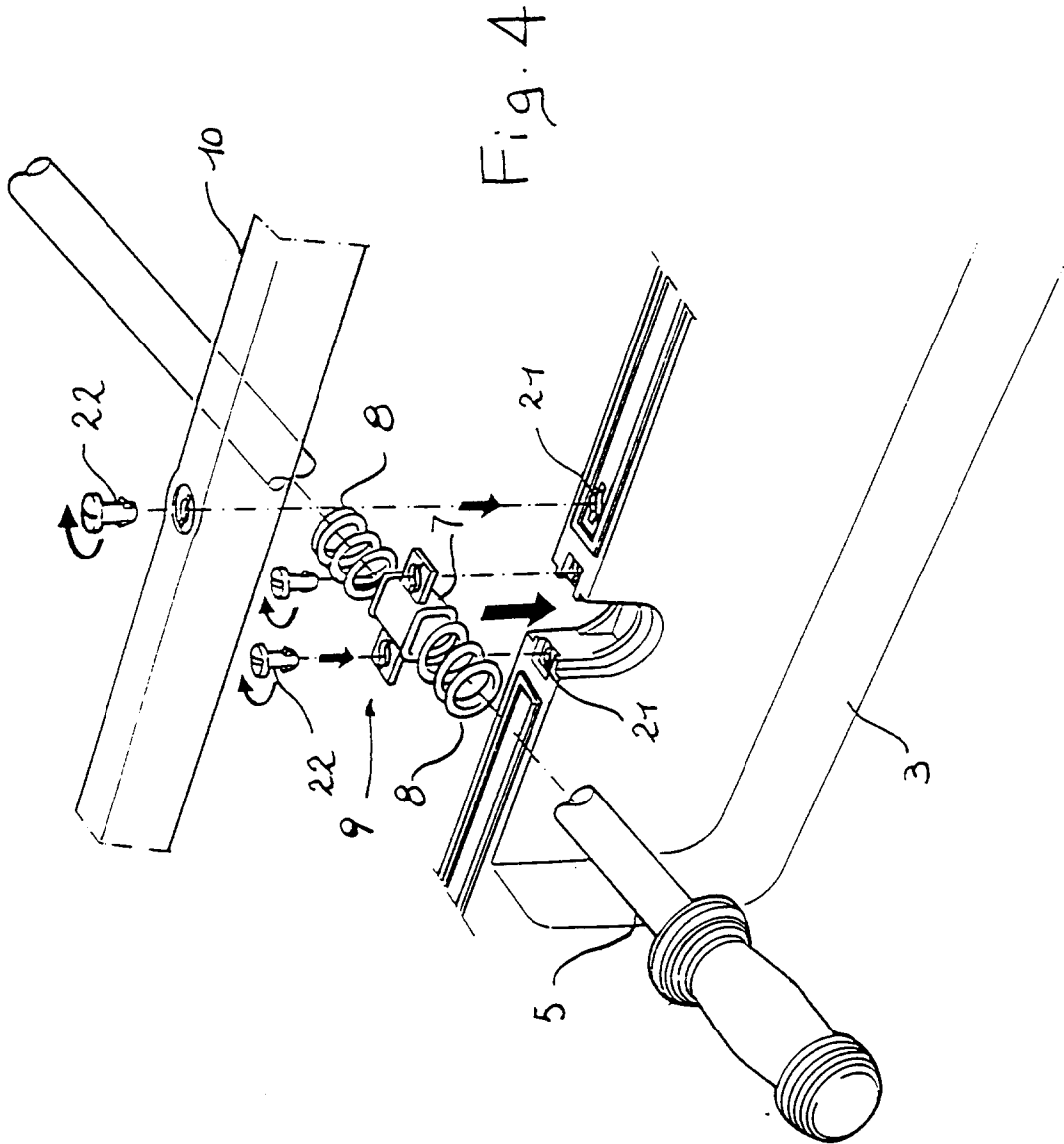

Fig. 1







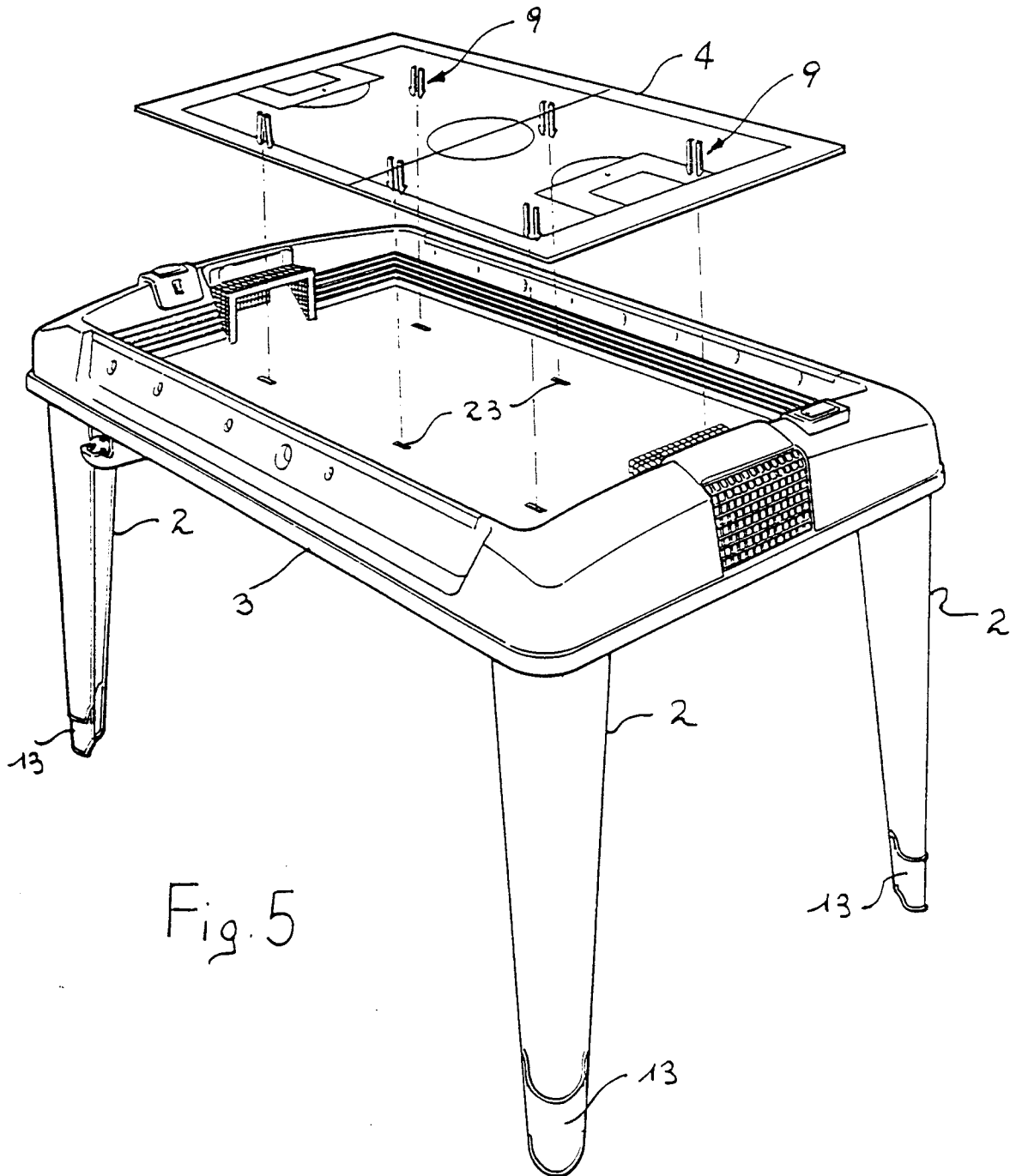

Fig. 5

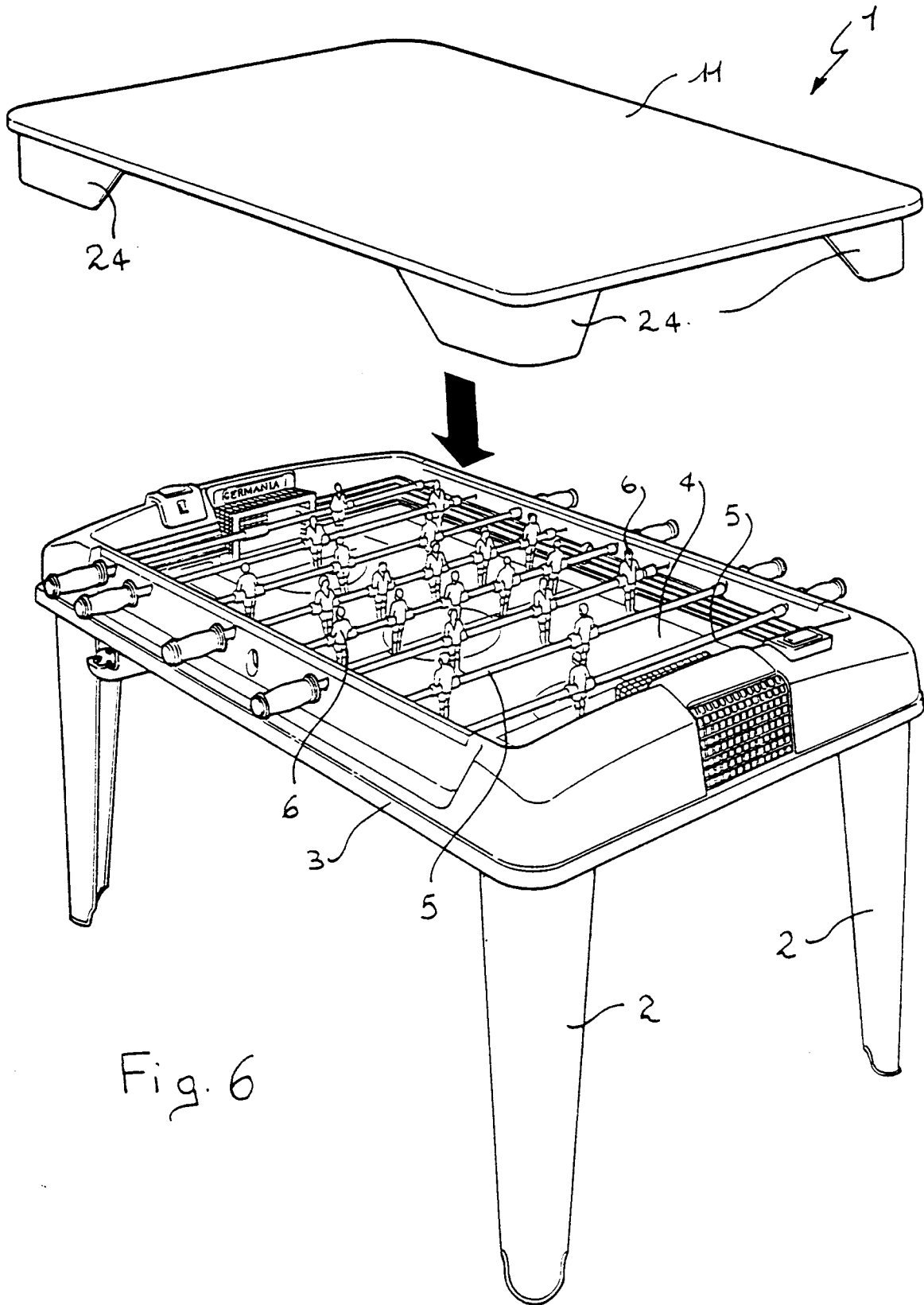

Fig. 6



DOCUMENTS CONSIDERED TO BE RELEVANT			
Category	Citation of document with indication, where appropriate, of relevant passages	Relevant to claim	CLASSIFICATION OF THE APPLICATION (Int.Cl.6)
A	FR-A-2 090 497 (WAGRET) * figures 1,2 *	1,2	A63F7/06
A	EP-A-0 316 989 (CECHETTI) * column 2, line 54 - column 3, line 5 *	1	
A	US-A-4 382 598 (MAC CLOUD) * column 5, line 26 - column 5, line 32; figure 5 *	1	
A	CH-A-494 579 (HALDIMANN) * figure 2 *	1	
A	BE-A-631 677 (ROTTIER ET AL.) * figure 4 *	3	
A	US-A-4 065 125 (CHAN) * figure 3 *	5,6	
A	US-A-4 063 728 (ZEMANEK) * column 1, line 56 - line 60 *	7	
A	FR-A-2 072 774 (WAGRET) * page 1, line 27 - line 32 *	8	TECHNICAL FIELDS SEARCHED (Int.Cl.6) A63F
The present search report has been drawn up for all claims			
Place of search THE HAGUE		Date of completion of the search 26 April 1995	Examiner Papa, E
CATEGORY OF CITED DOCUMENTS X : particularly relevant if taken alone Y : particularly relevant if combined with another document of the same category A : technological background O : non-written disclosure P : intermediate document		T : theory or principle underlying the invention E : earlier patent document, but published on, or after the filing date D : document cited in the application L : document cited for other reasons & : member of the same patent family, corresponding document	

EPO FORM 1503 03/82 (P/AC01)