

(19)



Europäisches Patentamt

European Patent Office

Office européen des brevets



(11)

EP 0 688 066 A3

(12)

EUROPEAN PATENT APPLICATION

(88) Date of publication A3:
05.06.1996 Bulletin 1996/23

(51) Int Cl.⁶: **H01R 13/629, H01R 13/436**

(43) Date of publication A2:
20.12.1995 Bulletin 1995/51

(21) Application number: **95304125.8**

(22) Date of filing: **15.06.1995**

(84) Designated Contracting States:
DE FR GB IT

• **Tartari, Claudio**
I-1-154 Torino (TO) (IT)

(30) Priority: **16.06.1994 GB 9412074**

(74) Representative: **Warren, Keith Stanley et al**
BARON & WARREN
18 South End
Kensington
London W8 5BU (GB)

(72) Inventors:
 • **Costa, Alberto**
I-10074 Lanzo Torinese (TO) (IT)

(54) **Electrical connector having secondary locking member**

(57) An electrical connector (2) comprises a connector body (4) having an array (86) of terminal receiving ports (18), an electrical terminal (20) within each terminal receiving port (18), and a secondary locking member (6) mountable to the connector body (4) and having a locked position for assuring retention of the electrical terminals (20). The secondary locking member (6) has two outer arms (100a, 100b) with an inner locking arm (102) therebetween, each arm having a free end (110, 170) and being interconnected opposite therefrom to the adjacent ends (110, 170) by a web (104a, 104b). The web (104a, 104b) is flexible enabling the secondary locking element to be opened to receive wires (25) extending from the terminals (20). In addition, a cover (8) is provided for use with connectors incorporating a secondary locking member (6), that interferes with the locking member (6) unless the locking member (6) is fully seated, thereby preventing full assembly of the connector (2) without the secondary lock (6) being fully seated.

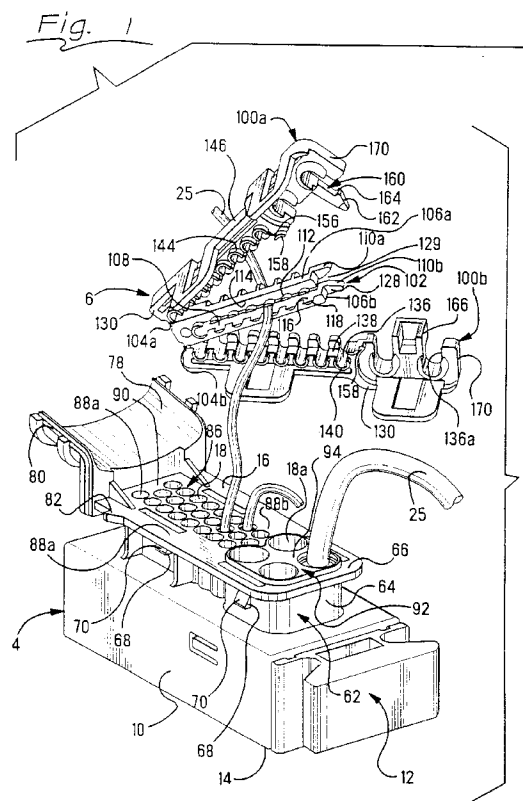

EP 0 688 066 A3

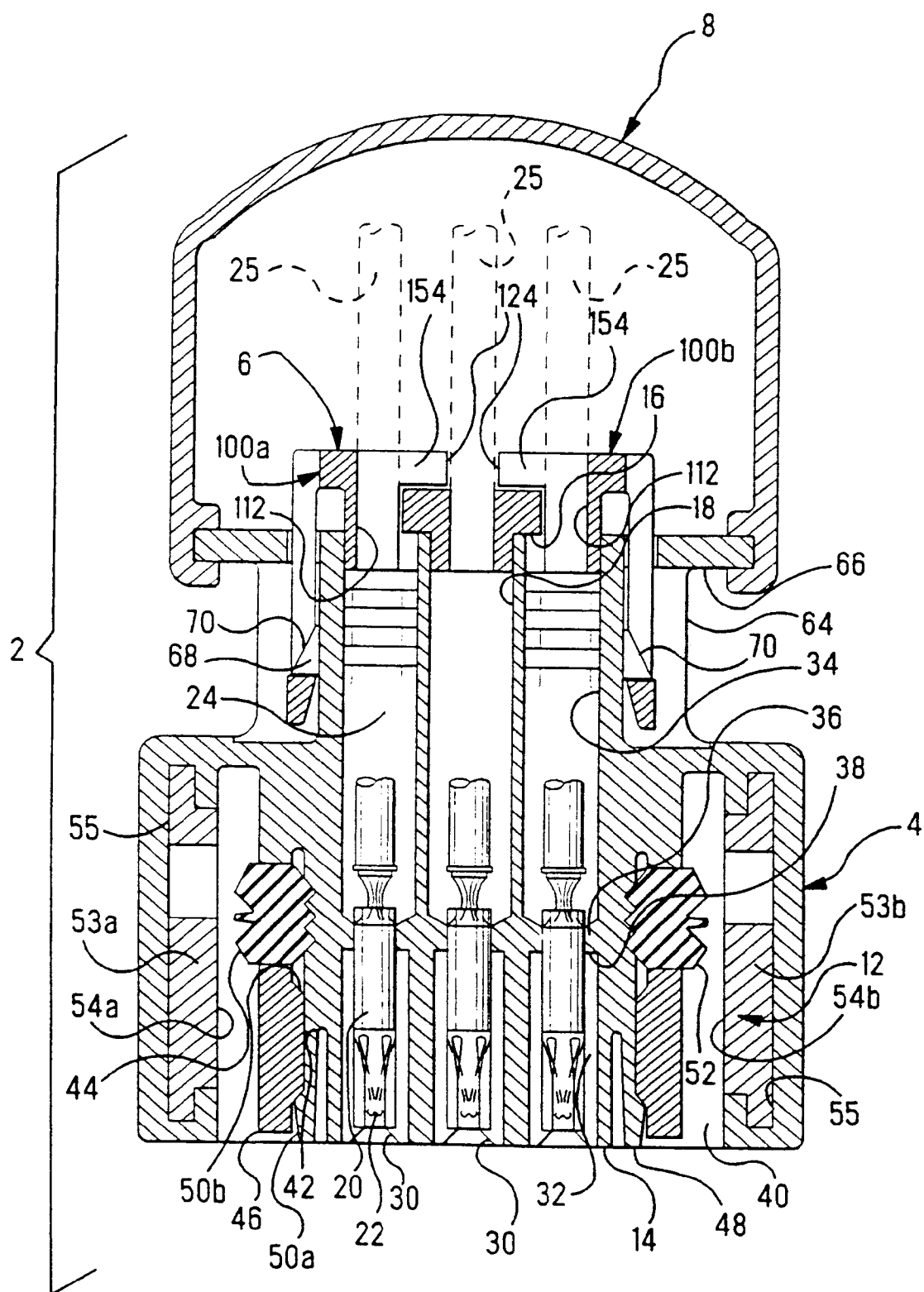

Fig. 6



European Patent
Office

EUROPEAN SEARCH REPORT

Application Number
EP 95 30 4125

DOCUMENTS CONSIDERED TO BE RELEVANT			
Category	Citation of document with indication, where appropriate, of relevant passages	Relevant to claim	CLASSIFICATION OF THE APPLICATION (Int.Cl.6)
D,A	US-A-5 199 902 (L.D.KAHLE ET AL) * column 5, line 66 - column 6, line 29; figures 2,8A,8B *	1,2,5,6, 9	H01R13/629 H01R13/436
A	FR-A-2 584 539 (AMP) * page 7, line 19 - page 8, line 10; figures 1,3,4 *	1,5,6	
A	EP-A-0 448 476 (NISSAN) * column 4, line 24 - line 43 * * column 5, line 57 - column 6, line 37; figures 1-6 *	1	
			TECHNICAL FIELDS SEARCHED (Int.Cl.6)
			H01R
The present search report has been drawn up for all claims			
Place of search BERLIN		Date of completion of the search 1 April 1996	Examiner Alexatos, G
<p>CATEGORY OF CITED DOCUMENTS</p> <p>X : particularly relevant if taken alone Y : particularly relevant if combined with another document of the same category A : technological background O : non-written disclosure P : intermediate document</p> <p>T : theory or principle underlying the invention E : earlier patent document, but published on, or after the filing date D : document cited in the application L : document cited for other reasons & : member of the same patent family, corresponding document</p>			

EPO FORM 1503 03/82 (P04C01)