



(88) Date of publication A3:
08.05.1996 Bulletin 1996/19

(51) Int. Cl.⁶: **H01H 13/20**, H01H 13/02

(43) Date of publication A2:
24.04.1996 Bulletin 1996/17

(21) Application number: 95116128.0

(22) Date of filing: 12.10.1995

(84) Designated Contracting States:
DE FR GB

(30) Priority: 18.10.1994 JP 251911/94

(71) Applicant: **MATSUSHITA ELECTRIC INDUSTRIAL
CO., LTD.**
Kadoma-shi, Osaka 571 (JP)

(72) Inventors:

- **Aimi, Mitsuo**
Hirakata City, 573 (JP)
- **Takeda, Hiroshi**
Obama City, 917-02 (JP)

**(74) Representative: Dr. Elisabeth Jung
Dr. Jürgen Schirdewahn
Dipl.-Ing. Claus Gernhardt
Postfach 40 14 68
D-80714 München (DE)**

(54) **Switch**

(57) A fixed terminal (12) having a fixed contact (20A) and a L-shaped moving member terminal (13) are mounted through oblong openings of a bottom plate of a switch case (11) at each one end. A moving switch-plate (16) having a moving contact (20B) at one end part is suspended on the other end part of the L-shaped moving member terminal (13) with a change-over member and a U-shaped leaf spring (15) so that the longitudinal direction of the moving switch-plate (16) is substantially parallel to the bottom plate of the switch case (11), and that the other end of the moving switch-plate (16) is moved by a slide member (17) to operate the switch.

FIG. 1

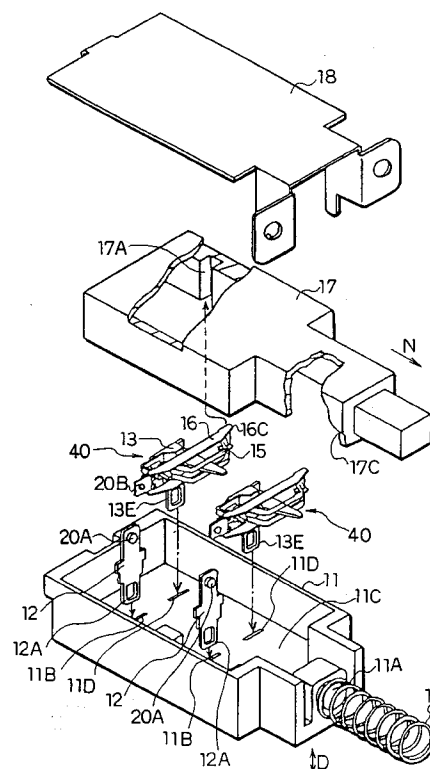



European Patent
Office

EUROPEAN SEARCH REPORT

Application Number
EP 95 11 6128

DOCUMENTS CONSIDERED TO BE RELEVANT			
Category	Citation of document with indication, where appropriate, of relevant passages	Relevant to claim	CLASSIFICATION OF THE APPLICATION (Int.Cl.6)
A	DE-B-24 09 604 (RUDOLF SCHADOW GMBH) * column 4, line 26 - column 5, line 39; figures *	1	H01H13/20 H01H13/02
A	DE-U-78 01 399 (BSG SCHALTTECHNIK GMBH & CO KG) * figures *		
			TECHNICAL FIELDS SEARCHED (Int.Cl.6)
			H01H
The present search report has been drawn up for all claims			
Place of search BERLIN		Date of completion of the search 4 March 1996	Examiner Ruppert, W
<p>CATEGORY OF CITED DOCUMENTS</p> <p>X : particularly relevant if taken alone Y : particularly relevant if combined with another document of the same category A : technological background O : non-written disclosure P : intermediate document</p> <p>T : theory or principle underlying the invention E : earlier patent document, but published on, or after the filing date D : document cited in the application L : document cited for other reasons & : member of the same patent family, corresponding document</p>			

EPO FORM 1503 03.82 (POMC01)