

(19)



Europäisches Patentamt

European Patent Office

Office européen des brevets



(11)

EP 0 838 183 A3

(12)

EUROPEAN PATENT APPLICATION

(88) Date of publication A3:
26.08.1998 Bulletin 1998/35

(51) Int Cl.⁶: **A47G 19/22, B65D 47/20**

(43) Date of publication A2:
29.04.1998 Bulletin 1998/18

(21) Application number: **97122664.2**

(22) Date of filing: **29.04.1994**

(84) Designated Contracting States:
AT BE CH DE DK ES FR GB GR IE IT LI LU MC NL PT SE

(72) Inventor: **Lin, Bang H.**
Taipei . (TW)

(62) Document number(s) of the earlier application(s) in
accordance with Art. 76 EPC:
94106781.1 / 0 680 719

(74) Representative: **Grünecker, Kinkeldey,**
Stockmair & Schwanhäusser Anwaltssozietät
Maximilianstrasse 58
80538 München (DE)

(71) Applicant: **SHING HONG INDUSTRIAL CO., LTD.**
Tainan (TW)

(54) Combination of a cap and a straw for a beverage container

(57) A beverage container with a rotatable cover and an automatically extendable drinking straw. The container comprises an open ended body closed by a removable cap, straw means inserted through a conduit on the cap, a cover member rotatably fitted on the cap for rotation movement relative to the cap between a first position allowing the straw to extend through a slot of the cover member and a second position folding the straw means and closing the slot. A groove formed on the cap engages a raised spot formed on the inner edge of the cover member for indicating when the cover member is rotated to either the first or second position. The straw means comprises a first straw made of elastomeric material and a second straw made of rigid material and sized so that the first straw is held between the conduit and the second straw in a coaxial relation without the use of fastening elements.

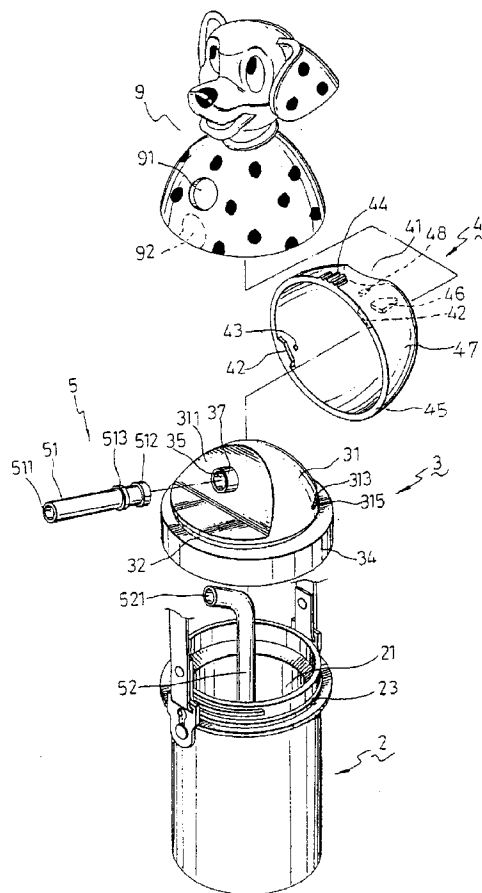

FIG. 3

EP 0 838 183 A3



European Patent
Office

EUROPEAN SEARCH REPORT

Application Number
EP 97 12 2664

DOCUMENTS CONSIDERED TO BE RELEVANT			
Category	Citation of document with indication, where appropriate, of relevant passages	Relevant to claim	CLASSIFICATION OF THE APPLICATION (Int.Cl.6)
A	US 5 150 815 A (SAKLAD) 29 September 1992 * column 2, line 4 - column 3, line 32; figures *	1	A47G19/22 B65D47/20
A	US 4 852 762 A (CHOU-SHENG) 1 August 1989		
A	US 5 265 815 A (HUA-TE WU) 30 November 1993		
A	US 5 085 335 A (CARBAUGH) 4 February 1992		
			TECHNICAL FIELDS SEARCHED (Int.Cl.6)
			A47G B65D A45F
The present search report has been drawn up for all claims			
Place of search THE HAGUE		Date of completion of the search 3 July 1998	Examiner Vistisen, L
<p>CATEGORY OF CITED DOCUMENTS</p> <p>X : particularly relevant if taken alone Y : particularly relevant if combined with another document of the same category A : technological background O : non-written disclosure P : intermediate document</p> <p>T : theory or principle underlying the invention E : earlier patent document, but published on, or after the filing date D : document cited in the application L : document cited for other reasons & : member of the same patent family, corresponding document</p>			

EPO FORM 1503 03/82 (P04C01)