



Europäisches Patentamt
European Patent Office
Office européen des brevets



(11) **EP 0 878 598 A3**

(12) **EUROPEAN PATENT APPLICATION**

(88) Date of publication A3:
20.09.2000 Bulletin 2000/38

(51) Int Cl.7: **E05B 17/20**, E05B 65/10,
E05C 1/02, E05D 3/02,
E05D 7/12, E06B 3/92

(43) Date of publication A2:
18.11.1998 Bulletin 1998/47

(21) Application number: **98303822.5**

(22) Date of filing: **14.05.1998**

(84) Designated Contracting States:
**AT BE CH CY DE DK ES FI FR GB GR IE IT LI LU
MC NL PT SE**
Designated Extension States:
AL LT LV MK RO SI

(72) Inventor: **Kilborn, Hilary Mark Howl
Lee, London SE12 9LA (GB)**

(74) Representative: **Watkins, David et al
Urquhart-Dykes & Lord,
91 Wimpole Street
London W1M 8AH (GB)**

(30) Priority: **14.05.1997 GB 9709793**

(71) Applicant: **Sitex Security Products Limited
Uxbridge UB8 2XW (GB)**

(54) **Security door and frame assembly**

(57) A security door and frame assembly comprises door 10 pivotally mounted in frame 20. Door 10 has interior and exterior surfaces and frame 20 has a slot 23 to receive bolt 30 mounted on the interior of door 10. Bolt 30 is operable between a first position in which it engages with frame 20 to secure door 10 in a closed condition, and a second position in which it is withdrawn from frame 20, allowing door 10 to pivot open. Lock 50

mounted on the interior of door 10 is operable between a locking condition in which it locks bolt 30 in said first position, and a release condition in which it allows bolt 30 to be released. Means accessible from both sides of door 10 are provided for moving bolt 30 between said first and second positions when lock 50 is in said release condition. Lock 50 is pivotable out of the plane of door 10 to release bolt 30 even when lock 50 is in its locking condition.

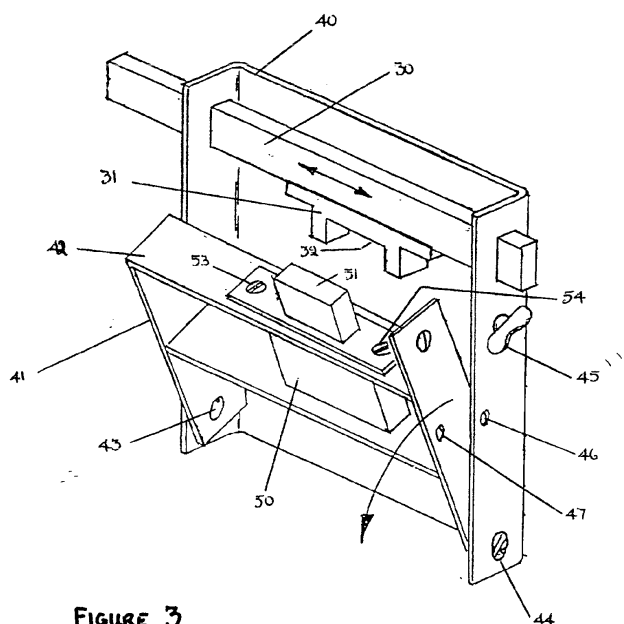

FIGURE 3

EP 0 878 598 A3



European Patent
Office

EUROPEAN SEARCH REPORT

Application Number
EP 98 30 3822

DOCUMENTS CONSIDERED TO BE RELEVANT			
Category	Citation of document with indication, where appropriate, of relevant passages	Relevant to claim	CLASSIFICATION OF THE APPLICATION (Int.Cl.6)
A	FR 1 173 746 A (CHARLES-SIMON DUFOUR) 2 March 1959 (1959-03-02) * the whole document *	1	E05B17/20 E05B65/10 E05C1/02 E05D3/02
A	GB 2 254 365 A (MURTON CLIVE ALFRED GEORGE) 7 October 1992 (1992-10-07) * page 7, line 16 - page 8, line 5; figure 2 *	1	E05D7/12 E06B3/92
A	DE 22 05 245 A (FUHR C FA) 9 August 1973 (1973-08-09) * page 14, line 1 - page 15, line 2; figures 2,3 *	1	
A	DE 22 13 790 A (FUHR C FA) 27 September 1973 (1973-09-27) * page 12, line 4 - line 20; figure *	1	
A	FR 1 560 253 A (FRANCIS VAUSE) 21 March 1969 (1969-03-21) * page 2, line 35 - line 47; figures 1-3 *	1,2	
			TECHNICAL FIELDS SEARCHED (Int.Cl.6)
			E05B E05C E05D E06B
-The present search report has been drawn up for all claims			
Place of search		Date of completion of the search	Examiner
THE HAGUE		3 May 2000	Pieracci, A
CATEGORY OF CITED DOCUMENTS			
X : particularly relevant if taken alone Y : particularly relevant if combined with another document of the same category A : technological background O : non-written disclosure P : intermediate document		T : theory or principle underlying the invention E : earlier patent document, but published on, or after the filing date D : document cited in the application L : document cited for other reasons & : member of the same patent family, corresponding document	

EPO FORM 1503 03 82 (P04C01)



European Patent
Office

Application Number

EP 98 30 3822

CLAIMS INCURRING FEES

The present European patent application comprised at the time of filing more than ten claims.

☐ Only part of the claims have been paid within the prescribed time limit. The present European search report has been drawn up for the first ten claims and for those claims for which claims fees have been paid, namely claim(s):

☐ No claims fees have been paid within the prescribed time limit. The present European search report has been drawn up for the first ten claims.

LACK OF UNITY OF INVENTION

The Search Division considers that the present European patent application does not comply with the requirements of unity of invention and relates to several inventions or groups of inventions, namely:

see sheet B

☐ All further search fees have been paid within the fixed time limit. The present European search report has been drawn up for all claims.

☐ As all searchable claims could be searched without effort justifying an additional fee, the Search Division did not invite payment of any additional fee.

☐ Only part of the further search fees have been paid within the fixed time limit. The present European search report has been drawn up for those parts of the European patent application which relate to the inventions in respect of which search fees have been paid, namely claims:

☒ None of the further search fees have been paid within the fixed time limit. The present European search report has been drawn up for those parts of the European patent application which relate to the invention first mentioned in the claims, namely claims:

1 - 7



European Patent
Office

LACK OF UNITY OF INVENTION
SHEET B

Application Number
EP 98 30 3822

The Search Division considers that the present European patent application does not comply with the requirements of unity of invention and relates to several inventions or groups of inventions, namely:

1. Claims: 1-7

A security door and frame assembly with releasable fastening means which are secured through a separate lock unit which can be disengaged from locking the releasable fastening means by pivoting the unit out of the plane of the door, i.e. the door can be opened even if locked in emergency situations.

2. Claims: 8-12, 17, 19

A security door and frame assembly with retractable hinge pins making it possible to engage one hinge at a time, i.e. facilitating installation of heavy doors on their hinges.

3. Claims: 13-16, 18, 20

A security door and frame assembly with an adjustable end panel disposed parallel to the surface of the door to eliminate significant gaps between the door and the frame, i.e. the entrance is secured against ingress of small mammals and birds

**ANNEX TO THE EUROPEAN SEARCH REPORT
ON EUROPEAN PATENT APPLICATION NO.**

EP 98 30 3822

This annex lists the patent family members relating to the patent documents cited in the above-mentioned European search report.
The members are as contained in the European Patent Office EDP file on
The European Patent Office is in no way liable for these particulars which are merely given for the purpose of information.

03-05-2000

Patent document cited in search report		Publication date	Patent family member(s)	Publication date
FR 1173746	A	02-03-1959	NONE	
GB 2254365	A	07-10-1992	NONE	
DE 2205245	A	09-08-1973	NONE	
DE 2213790	A	27-09-1973	BE 796185 A NL 7301215 A	02-07-1973 25-09-1973
FR 1560253	A	21-03-1969	NONE	

EPO FORM P0459

For more details about this annex : see Official Journal of the European Patent Office, No. 12/82