



(12) **EUROPEAN PATENT APPLICATION**

(88) Date of publication A3:  
**23.02.2000 Bulletin 2000/08**

(51) Int Cl.7: **B08B 9/04**

(43) Date of publication A2:  
**09.06.1999 Bulletin 1999/23**

(21) Application number: **98309951.6**

(22) Date of filing: **04.12.1998**

(84) Designated Contracting States:  
**AT BE CH CY DE DK ES FI FR GB GR IE IT LI LU  
MC NL PT SE**  
Designated Extension States:  
**AL LT LV MK RO SI**

(72) Inventor: **Dainton, Leslie John**  
**Southwood, Farnborough,**  
**Hants, GU14 1QQ (GB)**

(74) Representative: **Hillier, Peter et al**  
**Reginald W. Barker & Co.,**  
**Cliffords Inn**  
**Fetter Lane**  
**London EC4A 1BY (GB)**

(30) Priority: **08.12.1997 GB 9725948**

(71) Applicant: **Heathrow Hydrant Operating  
Company Ltd.**  
**Heathrow Airport, Middlesex, TW6 3SH (GB)**

(54) **Cleaning apparatus**

(57) A cleaning apparatus adapted for use in fuel hydrant pipelines and the like when that pipeline is full of product, comprises a sledge (10) carrying magnets (3) carried below a deck (1) of the sledge for removing magnetically susceptible particles and a suction foot (4) attached to a hose (7) via a swivel connection (5). The other end of the hose is connected to vacuum generat-

ing means so that a reduced pressure area is generated below the suction foot (4). The sledge (10) is adapted to enter the pipeline via features thereof, such as risers, which are of a smaller diameter than the main pipeline. The sledge (10) is movable through the pipeline, for example, by using draw wires attached to (holes) 6 in the deck (1).

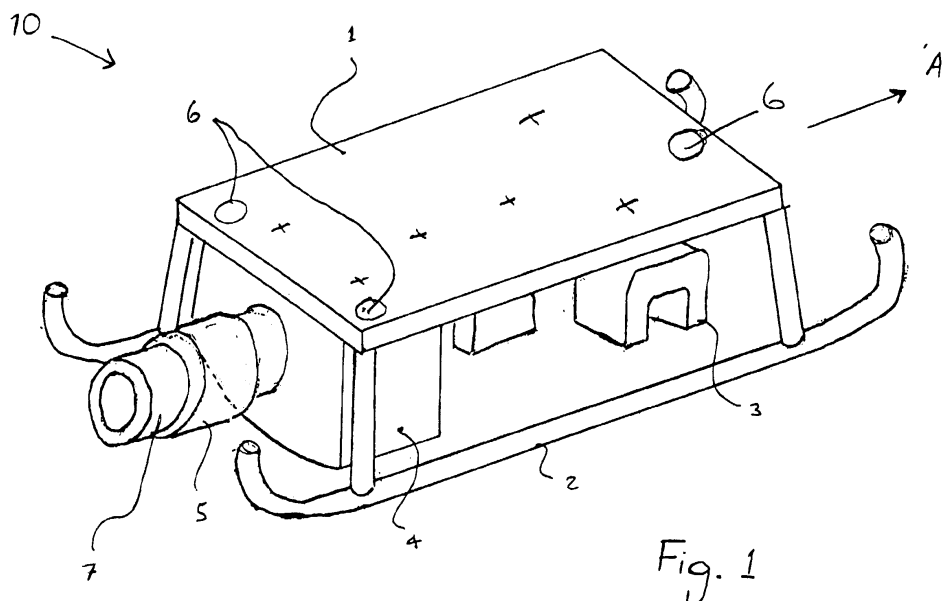

Fig. 1



European Patent  
Office

## EUROPEAN SEARCH REPORT

Application Number  
EP 98 30 9951

DOCUMENTS CONSIDERED TO BE RELEVANT					
Category	Citation of document with indication, where appropriate, of relevant passages	Relevant to claim	CLASSIFICATION OF THE APPLICATION (Int.Cl.6)		
X	PATENT ABSTRACTS OF JAPAN vol. 016, no. 366 (M-1291), 7 August 1992 (1992-08-07) -& JP 04 115039 A (TOKYO ELECTRIC POWER CO INC:THE;OTHERS: 02), 15 April 1992 (1992-04-15) * abstract; figures 1,3 *	1,2,5,9, 10	B08B9/04		
A	---	4			
X	DE 34 40 432 A (BLUM ALBERT) 7 May 1986 (1986-05-07) * abstract; figures 1-3 * * page 5, paragraph 1 * * page 9, paragraph 2 - page 10, paragraph 1 *	1,3			
A	---	4			
A	US 5 461 746 A (BANI K NIRANJAN ET AL) 31 October 1995 (1995-10-31) * abstract; figures 1,2 * * column 1, line 7 - line 9 * * column 1, line 28 - line 32 * * column 3, line 18 - line 36 * -----	6	<table border="1"> <thead> <tr> <th>TECHNICAL FIELDS SEARCHED (Int.Cl.6)</th> </tr> </thead> <tbody> <tr> <td>B08B E03F</td> </tr> </tbody> </table>	TECHNICAL FIELDS SEARCHED (Int.Cl.6)	B08B E03F
TECHNICAL FIELDS SEARCHED (Int.Cl.6)					
B08B E03F					
The present search report has been drawn up for all claims					
Place of search <b>THE HAGUE</b>		Date of completion of the search <b>22 December 1999</b>	Examiner <b>Plontz, N</b>		
<table border="0"> <tr> <td style="vertical-align: top;"> <b>CATEGORY OF CITED DOCUMENTS</b>  X : particularly relevant if taken alone  Y : particularly relevant if combined with another  document of the same category  A : technological background  O : non-written disclosure  P : intermediate document </td> <td style="vertical-align: top;"> T : theory or principle underlying the invention  E : earlier patent document, but published on, or  after the filing date  D : document cited in the application  L : document cited for other reasons  -----  &amp; : member of the same patent family, corresponding  document </td> </tr> </table>				<b>CATEGORY OF CITED DOCUMENTS</b> X : particularly relevant if taken alone Y : particularly relevant if combined with another document of the same category A : technological background O : non-written disclosure P : intermediate document	T : theory or principle underlying the invention E : earlier patent document, but published on, or after the filing date D : document cited in the application L : document cited for other reasons ----- & : member of the same patent family, corresponding document
<b>CATEGORY OF CITED DOCUMENTS</b> X : particularly relevant if taken alone Y : particularly relevant if combined with another document of the same category A : technological background O : non-written disclosure P : intermediate document	T : theory or principle underlying the invention E : earlier patent document, but published on, or after the filing date D : document cited in the application L : document cited for other reasons ----- & : member of the same patent family, corresponding document				

EPO FORM 1503 03.82 (P04C01)

**ANNEX TO THE EUROPEAN SEARCH REPORT  
ON EUROPEAN PATENT APPLICATION NO.**

EP 98 30 9951

This annex lists the patent family members relating to the patent documents cited in the above-mentioned European search report.  
The members are as contained in the European Patent Office EDP file on  
The European Patent Office is in no way liable for these particulars which are merely given for the purpose of information.

22-12-1999

Patent document cited in search report	Publication date	Patent family member(s)	Publication date
JP 04115039 A	15-04-1992	JP 8014124 B	14-02-1996
DE 3440432 A	07-05-1986	NONE	
US 5461746 A	31-10-1995	CA 2156677 A	18-07-1996
		WO 9622165 A	25-07-1996