



(12) **EUROPEAN PATENT APPLICATION**

(43) Date of publication:  
16.06.1999 Bulletin 1999/24

(51) Int. Cl.<sup>6</sup>: **B26D 7/00**, B26D 7/06

(21) Application number: **98830681.7**

(22) Date of filing: **11.11.1998**

(84) Designated Contracting States:  
**AT BE CH CY DE DK ES FI FR GB GR IE IT LI LU  
MC NL PT SE**  
Designated Extension States:  
**AL LT LV MK RO SI**

(71) Applicant:  
**Pada Engineering - S.r.l.**  
**61030 Saltara (PS) (IT)**

(72) Inventor: **Franchini, Fabio**  
**Fano (PS) (IT)**

(30) Priority: **12.11.1997 IT AN970052 U**

(74) Representative: **Baldi, Claudio**  
**Piazza Ghislieri, 3**  
**60035 Jesi (Ancona) (IT)**

(54) **Electrical slicing machine**

(57) This invention relates to an electrical slicing machine for domestic use, comprising a base (1) and a casing (6) for the motor (5) obtained by cutting an extruded aluminum profile. The slicing machine is also

provided with an overturning dish (3b) that supports the product to be sliced and a plastic transparent dish (8) used to collect the slices, provided with a lamp.

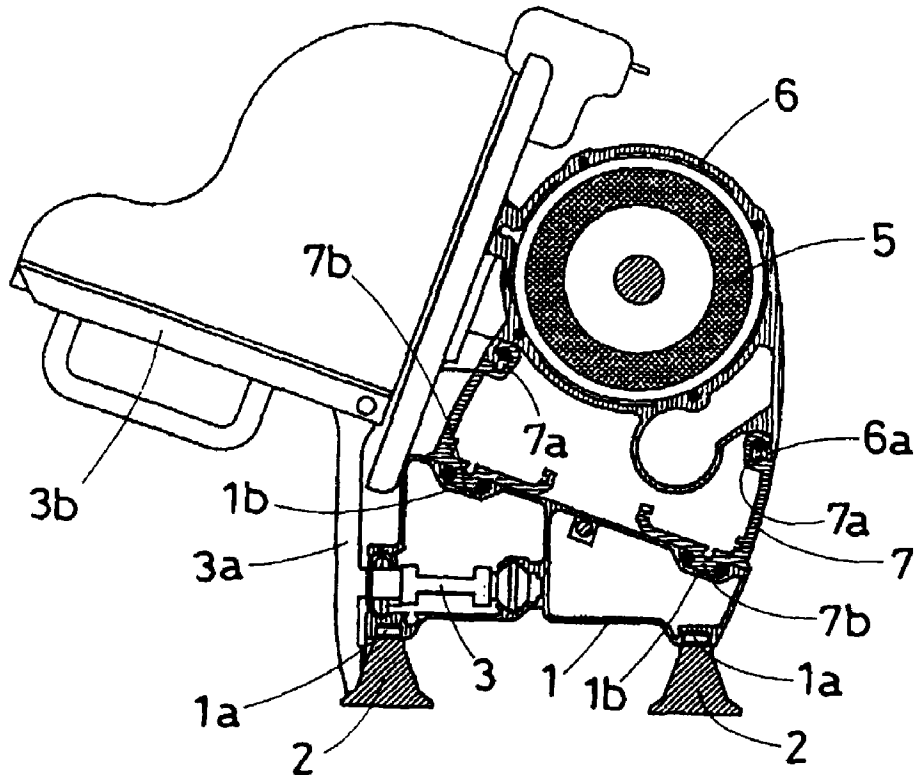

**FIG. 3**

## Description

[0001] This invention relates to an electrical slicing machine for domestic use that is extremely compact in size, convenient in terms of construction costs, functional and reliable.

[0002] This model of slicing machine for family use has been devised with the intention of realizing a machine with limited volume that can be easily stored inside the modular furniture for kitchen, whose cabinets usually feature a standard depth of 60 cm.

[0003] It appears obvious that such a compact slicing machine is not only advantageous for the final user, who needs to find a proper place for the machine when it is not used, but also for the retailer, who will be able to stock a higher number of machines in his warehouse.

[0004] Another objective of this invention is to develop and use new construction solutions in order to reduce the production costs of the slicing machines that are currently on the market.

[0005] Last but not least, another purpose of the invention is to obtain a practical and functional slicing machine able to give the maximum protection against domestic injuries.

[0006] The first objective - that is the maximum reduction possible of the machine volume - has been reached by using a support dish (for the product to be sliced) that can be overturned upwards and lifted from the working position with sub-horizontal direction to the resting position in which it is placed against the "sail".

[0007] It must be specified that the word "sail" indicates the sub-vertical wall in front of the blade on which the transversal section of the product to be sliced is placed and slides.

[0008] When the support dish is overturned in the resting position, the transversal volume of the machine according to this invention is reduced by approximately 50% and is represented by the maximum width of the base, since the support dish in lifted position does not project out of the base (either in the back or in the front).

[0009] As regards the economical viewpoint, the reduction of the production costs of the machine is obtained by using an extruded aluminum base that is a total innovation with respect to all the known models of slicing machines featuring a die-cast metal base.

[0010] This means that in order to produce the current slicing machines the manufacturer must have a specific base mold for each size of the blade, whose length proportionally increases according to the diameter of the blade used on the machine.

[0011] The use of an extruded aluminum profile for the machine base makes it possible to produce bases of any length at very low cost, since it is only necessary to cut the aluminum profile in the desired dimension.

[0012] In this way the expensive series of molds with different sizes for the die-cast base is no longer necessary.

[0013] According to this invention, an extruded alumi-

num profile is also used to make the casing that houses the motor. This allows creating any size of casing to house the motor used in the machine, whose length usually varies according to its power.

5 [0014] Another characteristic of the slicing machine according to this invention is the use of a plastic transparent dish to collect the slices, under which a lamp is placed to light the surface on which the slices fall. The idea of providing specific lighting on this surface is due to the fact that for space reasons the slicing machines are often kept in segregated positions in the kitchen that do not have enough light to carry out the slicing operation in safe conditions.

10 [0015] For clearer explication, the description of the model of slicing machine according to this invention continues with reference to the enclosed drawings, which only have an explanatory, not restrictive purpose, where:

- 20 - Fig. 1 shows the slicing machine from the side on which the overturning dish is located;
- Fig. 2 is the cross-section of Fig. 1 with plane II-II of Fig. 1;
- Fig. 3 is the cross-section of Fig. 1 with plane III-III of Fig. 1;
- 25 - Fig. 4 is a side view of the slicing machine with the overturning dish lifted in the resting position.

30 [0016] With reference to the above mentioned figures the electrical slicing machine according to this invention comprises a base (1) obtained by cutting an extruded aluminum profile whose bottom features two longitudinal grooves (1a) in which the support feet (2) of the machine are inserted and fixed, with the possibility of been positioned and blocked in place anywhere along the said grooves.

35 [0017] The base (1) houses a carriage (3) to which a vertical bracket (3a) is fixed to hold the support dish (3b) of the product to be sliced, that is hinged to the upper edge of the bracket (3a) with respect to the horizontal axis in order to be overturned from the working position with sub-horizontal direction (see Fig. 2) to the resting position with vertical direction against the "sail" of the machine (see Fig. 4).

40 [0018] The electrical motor (5) is housed inside a casing (6) obtained by cutting an extruded aluminum profile, whose bottom features two longitudinal ribs (6a) that match two corresponding longitudinal grooves (7a) located on the supports (7) of the casing (6), made of two extruded aluminum profiles, whose bottom part features two beads (7b) that are housed and fixed inside longitudinal grooves (1b) located on the upper part of the base (1).

45 [0019] The slice-collecting dish (8) is made of molded semi-transparent plastic material and lit by a lamp (9) housed in a compartment located under the dish (8).

## Claims

1. Electrical slicing machine for domestic use comprising:
  - a base (1) obtained by cutting an extruded aluminum profile that features two longitudinal grooves (1a) in which the support feet (2) are located and fixed; 5
  - a casing (6) that houses the motor (5) obtained by cutting an extruded aluminum profile. 10
  
2. Electrical slicing machine for domestic use according to claim (1), characterized in that the support dish (3b) of the product to be sliced is hinged to the support bracket (3a) with respect to the horizontal axis in order to be overturned from the working position with sub-horizontal direction to the resting position with vertical direction against the "sail" of the machine. 15  
20
  
3. Electrical slicing machine for domestic use according to claim (1), characterized in that the electrical motor (5) is housed in a casing (6) obtained by cutting an extruded aluminum profile, whose bottom features two longitudinal ribs (6a) that match two longitudinal grooves (7a) located on the supports (7) of the casing (6), made of two extruded aluminum profiles, whose bottom part features two beads (7b) that are housed and fixed inside longitudinal grooves (1b) located on the upper part of the base (1). 25  
30
  
4. Electrical slicing machine for domestic use according to claim (1), characterized in that the slice-collecting dish (8) is made of molded transparent plastic material and lit by a lamp (9) housed in a compartment located under the dish (8). 35  
40  
45  
50  
55

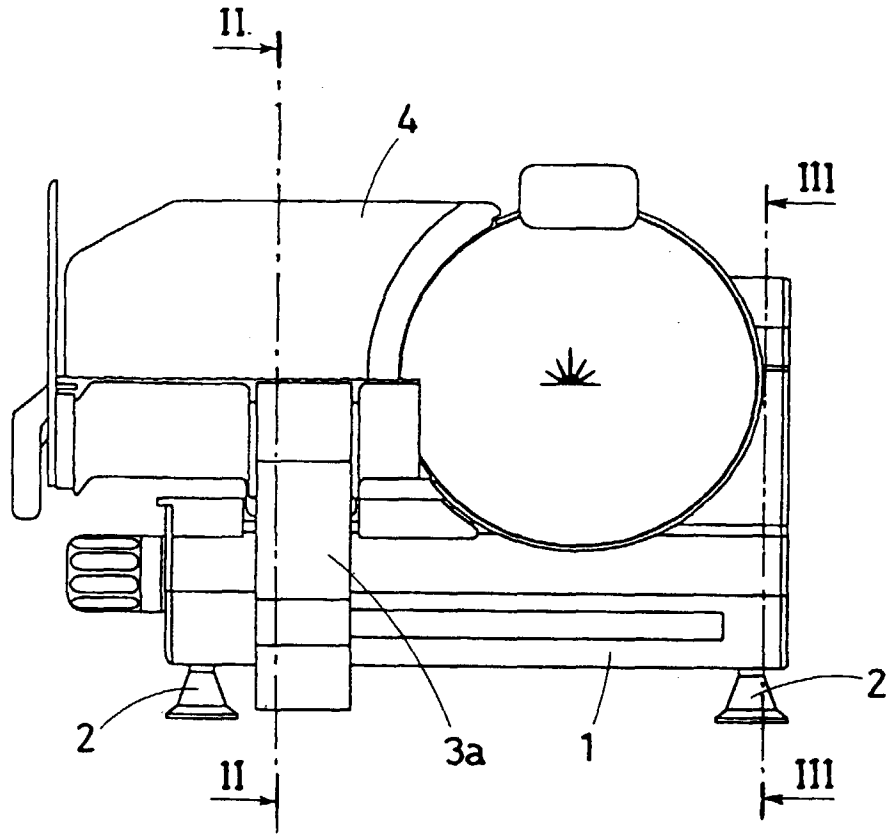

FIG. 1

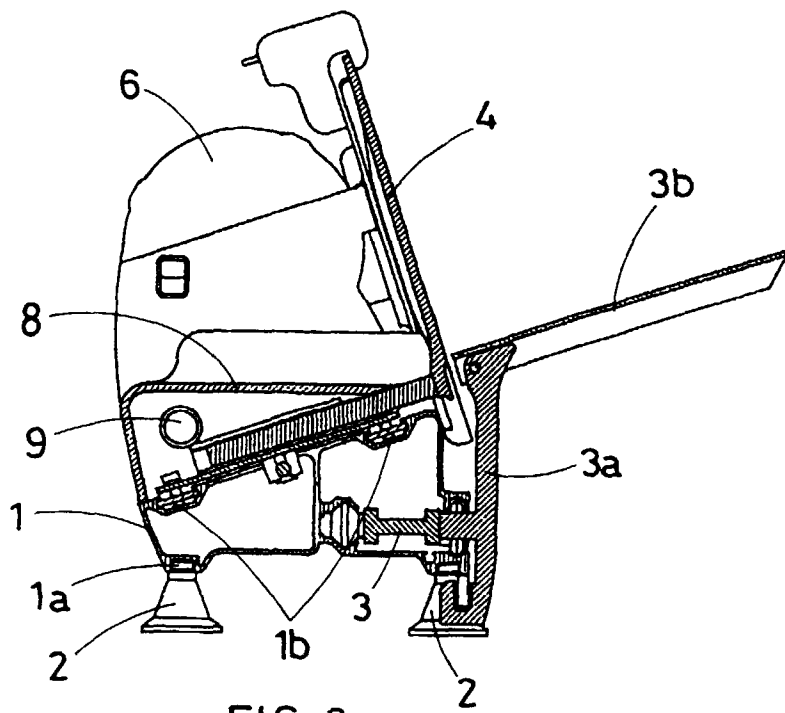

FIG. 2

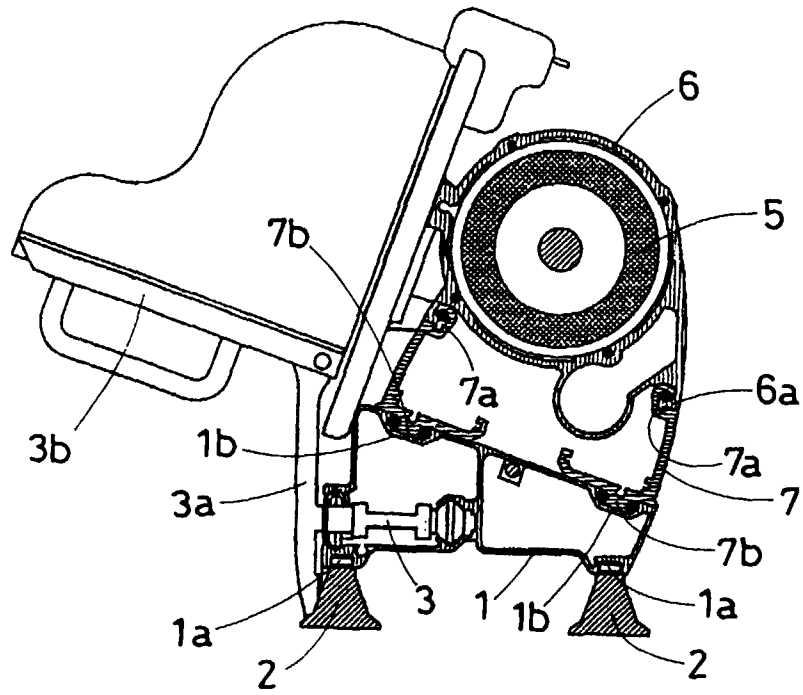

FIG. 3

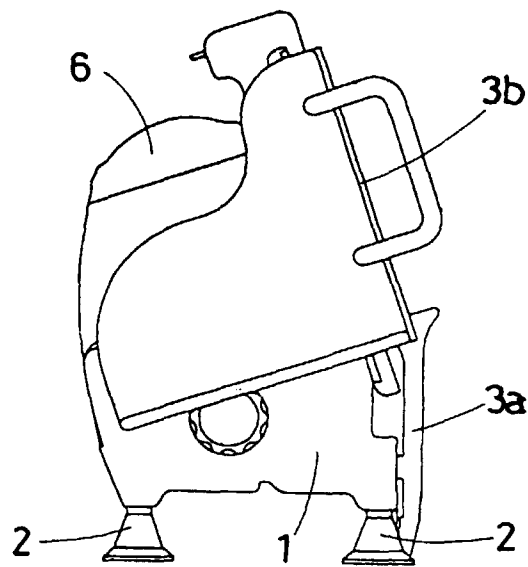

FIG. 4