



Europäisches Patentamt
European Patent Office
Office européen des brevets



(11) **EP 0 939 009 A3**

(12) **EUROPEAN PATENT APPLICATION**

(88) Date of publication A3:
07.05.2003 Bulletin 2003/19

(51) Int Cl.7: **B60R 16/00, B60Q 1/14**

(43) Date of publication A2:
01.09.1999 Bulletin 1999/35

(21) Application number: **98124855.2**

(22) Date of filing: **31.12.1998**

(84) Designated Contracting States:
**AT BE CH CY DE DK ES FI FR GB GR IE IT LI LU
MC NL PT SE**
Designated Extension States:
AL LT LV MK RO SI

(72) Inventor: **Matsumoto, Tsuyoshi,**
c/o Niles Parts Co., Ltd.
Tokyo 143-0015 (JP)

(30) Priority: **27.02.1998 JP 6415898**

(74) Representative:
Luderschmidt, Schüler & Partner GbR
Patentanwälte,
John-F.-Kennedy-Strasse 4
65189 Wiesbaden (DE)

(71) Applicant: **Niles Parts Co., Ltd.**
Tokyo 143-0015 (JP)

(54) **Lever switch for vehicles**

(57) Problem: To present a lever switch used for vehicles in which the structure of the lever provided with two levers capable of swingable operation is made compact and its formation is made slim.

Solving Means: The lever switch is composed of the first lever 6, the second lever 7, and the third lever 5. The first lever 6 is provided with the first operation rod

9 for operating the first movable member 18 disposed on the pole board 22. The second lever 7 is provided with the second operation rod 7f for operating the second movable member 19 disposed on the pole board 22. The third lever 5 is provided with the third operation rod 5a for operating the third movable member 17 disposed on the pole board 22.

FIG. 2

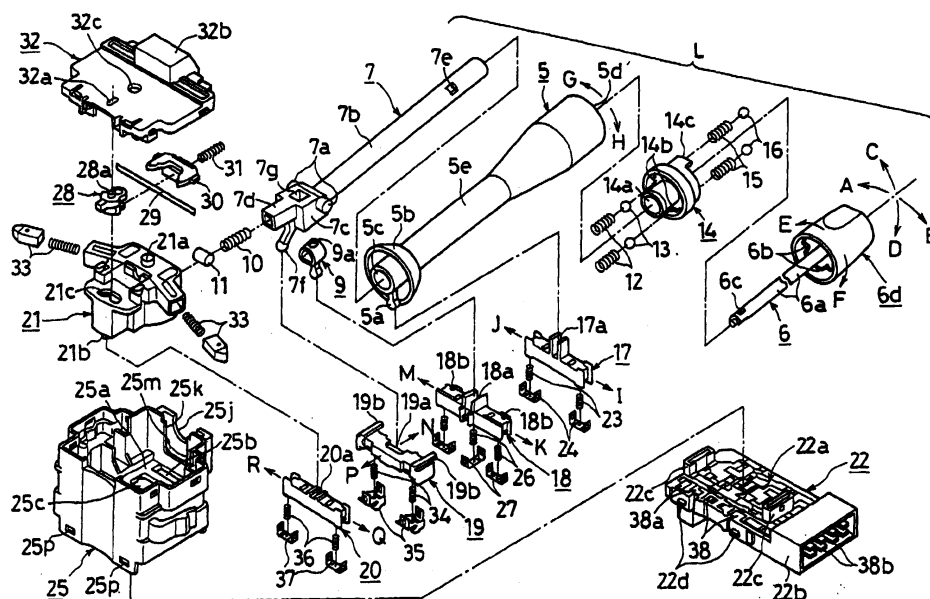

EP 0 939 009 A3



European Patent
Office

EUROPEAN SEARCH REPORT

Application Number
EP 98 12 4855

DOCUMENTS CONSIDERED TO BE RELEVANT			
Category	Citation of document with indication, where appropriate, of relevant passages	Relevant to claim	CLASSIFICATION OF THE APPLICATION (Int.CI.6)
A	US 5 661 276 A (SHIBATA) 26 August 1997 (1997-08-26) * abstract; figure 1 * ----	1	B60R16/00 B60Q1/14
A	US 5 708 242 A (UCHIYAMA) 13 January 1998 (1998-01-13) * abstract; figure 1 * ----	1	
E	US 5 859 396 A (YOKOYAMA) 12 January 1999 (1999-01-12) * abstract; figure 2 * ----	1	
E	US 5 900 601 A (UCHIYAMA) 4 May 1999 (1999-05-04) * abstract; figure 2 * -----	1	
The present search report has been drawn up for all claims			TECHNICAL FIELDS SEARCHED (Int.CI.6)
			B60Q
Place of search	Date of completion of the search	Examiner	
THE HAGUE	17 March 2003	Onillon, C	
<p>CATEGORY OF CITED DOCUMENTS</p> <p>X : particularly relevant if taken alone Y : particularly relevant if combined with another document of the same category A : technological background O : non-written disclosure P : intermediate document</p> <p>T : theory or principle underlying the invention E : earlier patent document, but published on, or after the filing date D : document cited in the application L : document cited for other reasons & : member of the same patent family, corresponding document</p>			

EPO FORM 1503 03/82 (P04/C01)

**ANNEX TO THE EUROPEAN SEARCH REPORT
ON EUROPEAN PATENT APPLICATION NO.**

EP 98 12 4855

This annex lists the patent family members relating to the patent documents cited in the above-mentioned European search report. The members are as contained in the European Patent Office EDP file on
The European Patent Office is in no way liable for these particulars which are merely given for the purpose of information.

17-03-2003

Patent document cited in search report		Publication date		Patent family member(s)	Publication date
US 5661276	A	26-08-1997	JP	3217234 B2	09-10-2001
			JP	8287780 A	01-11-1996
			KR	253490 B1	15-04-2000

US 5708242	A	13-01-1998	JP	9022641 A	21-01-1997

US 5859396	A	12-01-1999	JP	10106399 A	24-04-1998
			GB	2317748 A , B	01-04-1998

US 5900601	A	04-05-1999	JP	10172388 A	26-06-1998
			GB	2320366 A , B	17-06-1998

EPC FORM P0459

For more details about this annex : see Official Journal of the European Patent Office, No. 12/82