

(19)



Europäisches Patentamt

European Patent Office

Office européen des brevets



(11)

EP 0 972 461 B1

(12)

EUROPEAN PATENT SPECIFICATION

(45) Date of publication and mention
of the grant of the patent:

01.10.2003 Bulletin 2003/40

(51) Int Cl.7: **A42B 3/32**

(21) Application number: **99113729.0**

(22) Date of filing: **13.07.1999**

(54) **Helmet**

Helm

Casque

(84) Designated Contracting States:
DE FR IT

(30) Priority: **16.07.1998 JP 21853398**
30.04.1999 JP 12450299

(43) Date of publication of application:
19.01.2000 Bulletin 2000/03

(73) Proprietor: **Shoei Co., Ltd.**
Taito-ku, Tokyo (JP)

(72) Inventor: **Tanaka, Haruo**
Ichikawa-shi, Chiba-ken (JP)

(74) Representative: **Müller - Hoffmann & Partner**
Patentanwälte,
Innere Wiener Strasse 17
81667 München (DE)

(56) References cited:
EP-A- 0 518 178 **DE-A- 4 040 172**
FR-A- 2 593 035

EP 0 972 461 B1

Note: Within nine months from the publication of the mention of the grant of the European patent, any person may give notice to the European Patent Office of opposition to the European patent granted. Notice of opposition shall be filed in a written reasoned statement. It shall not be deemed to have been filed until the opposition fee has been paid. (Art. 99(1) European Patent Convention).

Description

Technical Field

[0001] The present invention relates to a helmet which has a cap-shaped head protecting body, worn by the helmet wearer such as the rider of a motor cycle to protect his/her head, and having a cap-shaped main cap portion and a subsidiary cap portion attached to the main cap portion to be substantially vertically movable so as to selectively cover the chin of the helmet wearer.

Background of the Invention

[0002] As vehicle helmets worn by the rider of a motor cycle or the like, a full-face-type helmet and a jet-type helmet are conventionally known. In the full-face-type helmet, a chin cover for covering the chin of the helmet wearer is integrally formed with the head protecting body. In the jet-type helmet, no chin cover is formed on the head protecting body so as to expose the face of the helmet wearer almost entirely. Another full-face-type helmet (to be referred to as a "full-face-type helmet serving also as a jet-type helmet" hereinafter) is also conventionally known. In this full-face-type helmet, the head protecting body is formed of a main cap portion having almost the same shape as that of the head protecting body of a jet-type helmet, and a subsidiary cap portion attached to the main cap portion to be substantially vertically pivotal so as to selectively cover the chin of the helmet wearer, so that the helmet can have the functions of both a full-face-type helmet and a jet-type helmet.

[0003] In the conventional full-face-type helmet serving also as the jet-type helmet, when the subsidiary cap portion is at the lower position, it serves as a chin covering means. When the subsidiary cap portion is at the upper position, a large window formed in the main cap portion is opened, and the head protecting body accordingly has no chin covering means, in the same manner as in the jet-type helmet. When the wearer wearing the full-face-type helmet serving also as the jet-type helmet is driving a motor cycle at high speed, the helmet is worn with its subsidiary cap portion being lowered to the lower position, in order to prevent a large wind pressure from acting on the wearer's chin and its vicinity. The helmet is provided with a subsidiary cap portion locking mechanism for locking the subsidiary cap portion at the lower position with respect to the main cap portion, so that the subsidiary cap portion does not undesirably move upward by a large impact or wind pressure during high-speed driving. The subsidiary cap portion is provided with an unlocking means or member in order to unlock the subsidiary cap portion locked at the lower position by the subsidiary cap portion locking mechanism.

[0004] Such a conventional full-face-type helmet serving also as the jet-type helmet is disclosed in European Patent No. 518,178 as well. In the helmet disclosed in this reference (to be referred to as "the first

known helmet" hereinafter), when a release lever serving as the unlocking member is pressed for unlocking, a force which moves the subsidiary cap portion from the lower position to the upper position automatically acts on the subsidiary cap portion. In other words, when the release lever is pressed upward, the subsidiary cap portion locked at the lower position is unlocked. Therefore, when the release lever is pressed upward to unlock the locked subsidiary cap portion, the subsidiary cap portion locked by the locking mechanism is unlocked. Also, the subsidiary cap portion can be started to move from the lower position to the upper position by only successively pressing the release lever. Hence, the wearer can unlock the locked subsidiary cap portion and move the unlocked subsidiary cap portion upward quickly and continuously by only pressing the release lever.

[0005] In the first known helmet as described above, assume that, while the wearer drives the motor cycle at high speed, for example, he erroneously presses the release lever upward so as to slightly move a shield plate (attached to the subsidiary cap portion to be able to open/close the window opening formed in the front surface of the head protecting body of the helmet), so that the window opening closed by the shield plate may be slightly opened. Alternatively, assume that a foreign matter accidentally abuts against the release lever from below. Then, the subsidiary cap portion locked at the lower position is unlocked, and undesirably moves upward from the lower position for a certain degree. A large wind pressure then can directly act on the wearer's chin, causing inconveniences for the wearer in driving the motor cycle.

[0006] In the first known helmet as described above, when an operation lever connected to the release lever through a wire causes a movable locking member made of a spring member to move forward against the spring force, the locking mechanism is unlocked. In spite that the structure of the mechanism for unlocking the subsidiary cap portion locked by the locking mechanism is not very simple, the subsidiary cap portion might not be unlocked or inversely locked by the locking mechanism quickly and smoothly.

[0007] The conventional full-face-type helmet serving also as the jet-type helmet, as described above, is disclosed in German Patent Laid-Open No. 19,612,724 as well. In the helmet (to be referred to as "the second known helmet" hereinafter) disclosed in this reference, when the release tap serving as the unlocking means is pressed for unlocking, a force opposite to a force that moves the subsidiary cap portion from the lower position to the upper position acts on the subsidiary cap portion. In other words, when the release tap is pressed downward, the subsidiary cap portion locked at the lower position is unlocked. Even when the release tap is continuously pressed, it is not sufficient to move the subsidiary cap portion from the lower position to the upper position. Therefore, when the wearer is driving the motor cycle at high speed, the subsidiary cap portion does not move

upward from the lower position erroneously or accidentally, and accordingly large wind pressure will not substantially, directly act on the helmet wearer's chin.

[0008] In the second known helmet as described above, the movable locking member is constituted by an arcuated operation lever formed with the release tap at its central portion. The operation lever is pivotally, axially supported on the auxiliary cap portion at the right and left portions. Also, a pair of right and left engaging recesses are formed in the right and left end portions of the operation lever. When a pair of right and left lock pins provided to the main cap portion relatively engage with these engaging recesses, the subsidiary cap portion is locked on the main cap portion. When the helmet wearer holds the release tap with his fingers and moves it downward, the operation lever pivots forward to disengage the lock pins relatively from the engaging recesses, thereby unlocking the locked subsidiary cap portion. Therefore, in the second known helmet as well, in spite that the structure of the mechanism for unlocking the subsidiary cap portion locked by the locking mechanism is not very simple, the subsidiary cap portion might not be unlocked or inversely locked by the locking mechanism quickly and smoothly. DE 40 40 172 AI discloses a helmet according to the preamble of claim 1.

Summary of the Invention

[0009] The present invention is directed to correcting the drawbacks described above of the conventional full-face-type helmet serving also as the jet-type helmet with a very simple arrangement very effectively.

[0010] It is, therefore, the main object of the present invention to provide a helmet in which, in spite that the mechanism for unlocking the subsidiary cap portion locked on the main cap portion with the locking mechanism is comparatively simple, the unlocking operation and the opposite locking operation can be performed quickly and smoothly.

[0011] It is another object of the present invention to provide a helmet with which when the wearer is driving a motor cycle at high speed, the subsidiary cap portion will not move upward from the lower position erroneously or accidentally, and large wind pressure will not substantially, directly act on the helmet wearer's chin.

[0012] Therefore, the present invention relates to a helmet including a cap-shaped head protecting body to be worn by a helmet wearer on his/her head, the head protecting body having a main cap portion and a subsidiary cap portion attached to the main cap portion to be substantially vertically movable so as to selectively cover a chin of the helmet wearer, the head protecting body being provided with first and second locking mechanisms for respectively locking left and right sides of the subsidiary cap portion with respect to the main cap portion when the subsidiary cap portion is at a lower position to cover the chin, and the head protecting body being also provided with a common unlocking member

which moves operatively in a forward moving direction being inwardly of a downward moving direction of said subsidiary cap portion to commonly unlock said subsidiary cap portion locked by said first and second locking mechanisms, wherein said helmet is provided with a common tractive flexible wire for commonly transmitting the forward movement of said unlocking member to said first and second movable locking members of said first and second locking mechanisms. One end portion of said wire is connected to said first movable locking member and the other end portion of said wire is connected to said second movable locking member. said unlocking member is provided with a wire engaging portion, and an intermediate portion of said wire is engaged by said wire engaging portion, wherein said wire attaching member is attached to said unlocking member, so that when said wire attaching member is slid with respect to said unlocking member, a position where said wire attaching member is attached on said unlocking member is adjusted, thereby removing a slack of said wire.

[0013] Other particular embodiments of the invention are set out in claims 2-21.

[0014] The above and other objects, features and advantages of this invention will become readily apparent from the following detailed description thereof which is to be read in connection with the accompanying drawings.

Brief Description of the Drawings

[0015]

Fig. 1 is a perspective view of the entire portion of a helmet in an ordinary worn state in the first embodiment in which the present invention is applied to a full-face-type helmet serving also as a jet-type helmet;

Fig. 2 is a right side view of the entire portion of the helmet shown in Fig. 1 in an ordinary worn state;

Fig. 3 is a right side view of the entire portion of the helmet shown in Fig. 1 with the subsidiary cap portion raised;

Fig. 4 is a longitudinal sectional partial view, taken along the center, of the helmet shown in Fig. 2, which explains the subsidiary cap portion locking mechanism and from which the backing member and rim member for the subsidiary cap portion are omitted;

Fig. 5 is a view similar to Fig. 4, showing a state the release button is depressed;

Fig. 6 is a view similar to Fig. 4, showing a state wherein the subsidiary cap portion is slightly raised from the state shown in Fig. 5;

Fig. 7 is a perspective view of the release button and a holding mechanism for it shown in Fig. 4;

Fig. 8 is an exploded perspective view of the release button and the holding mechanism for it shown in

Fig. 7;

Fig. 9 is a longitudinal sectional view, taken along the center, of the release button and the holding mechanism for it shown in Fig. 7;

Fig. 10 is a perspective view of the entire portion of a helmet in an ordinary worn state in the second embodiment in which the present invention is applied to a full-face-type helmet serving also as a jet-type helmet;

Fig. 11 is a right side view of the entire portion of the helmet shown in Fig. 10 in an ordinary worn state;

Fig. 12 is a right side view of the entire portion of the helmet shown in Fig. 10 with the subsidiary cap portion raised;

Fig. 13 is a longitudinal sectional partial view, taken along the center, of the helmet shown in Fig. 11, which explains the subsidiary cap portion locking mechanism and from which the backing member and rim member for the subsidiary cap portion are omitted;

Fig. 14 is a view similar to Fig. 13, showing a state wherein the release button is depressed;

Fig. 15 is a view similar to Fig. 13, showing a state wherein the subsidiary cap portion is slightly raised from the state shown in Fig. 14;

Fig. 16 is a sectional view taken along a line XVI - XVI in Fig. 13;

Fig. 17 is a perspective exploded view of the main part of the right subsidiary cap portion locking mechanism shown in Fig. 13;

Fig. 18 is a perspective view of the release button and a holding mechanism for it shown in Fig. 13;

Fig. 19 is an exploded perspective view of the release button and the holding mechanism for it shown in Fig. 18;

Fig. 20 is a longitudinal sectional view, taken along the center, of the release button and the holding mechanism for it shown in Fig. 18;

Fig. 21 is a sectional view taken along a line XXI - XXI in Fig. 11; and

Fig. 22 is a sectional view taken along a line XXII - XXII in Fig. 12.

Detailed Description of the Invention

[0016] The preferred embodiments in which the present invention is applied to a full-face-type helmet serving also as a jet-type helmet will be described with reference to the accompanying drawings.

First Embodiment

[0017] The first embodiment in which the present invention is applied to a full-face-type helmet serving also as a jet-type helmet will be described first with reference to Figs. 1 to 9.

[0018] As shown in Figs. 1 to 3, a full-face-type helmet

1 serving also as a jet-type helmet is made up of a full-face-type cap-shaped head protecting body 2, a shield plate 4, and a pair of right and left chin straps (not shown). Note that the full-face-type cap-shaped head protecting body 2 is to be worn on the head of a helmet wearer, e.g., the rider of a motor cycle, and serves as a jet-type head protecting body as well. The shield plate 4 can open/close a window opening 3 formed in the front surface of the full-face-type head protecting body 2 to oppose the portion between the forehead and chin of the wearer (i.e., almost the central portion of the face). The chin straps are attached to the inner surface portions of the full-face-type head protecting body 2.

[0019] As is conventionally known, the head protecting body 2 has a main cap portion 5 and a subsidiary cap portion 6. The main cap portion 5 can have almost the same shape as that of the cap portion of a jet-type helmet. The subsidiary cap portion 6 is attached to the main cap portion 5 on the right and left sides with a pair of right and left attaching screws 7 serving as axial support means, so as to be reciprocally pivotal. Accordingly, a large window 8 is formed in the main cap portion 5 to be defined by a large notch extending upward from the lower end of the front surface of the main cap portion 5. As is conventionally known, the subsidiary cap portion 6 has a chin cover 6a and a pair of right and left ears 6b. The chin cover 6a is arcuated to expand forward. The ears 6b extend from the right and left ends of the chin cover 6a and are axially supported on the right and left sides of the main cap portion 5 with a pair of right and left attaching screws 7 to be reciprocally movable. The subsidiary cap portion 6 is formed with a large window 15 defined by a large notch extending downward from the upper end of its front surface. When the subsidiary cap portion 6 pivots downward with respect to the main cap portion 5 to be located at the lower position (the state shown in Figs. 1 and 2), it serves as a chin covering means for covering the wearer's chin to close the lower portion of the window 8. Hence, the upper portion of the window 8 defines the window opening 3. The window opening 3 is formed of a region surrounded by the rim of the window 8 of the main cap portion 5 and the rim of the window 15 of the subsidiary cap portion 6.

[0020] As is conventionally known, the shield plate 4 can be made of a transparent or translucent hard material such as polycarbonate or another type of hard synthetic resin. The shield plate 4 is reciprocally pivotally attached to the subsidiary cap portion 6 at the right and left sides with a pair of right and left attaching screws 9 serving as axial support means. When the subsidiary cap portion 6 is at the lower position to serve as the chin covering means (the state shown in Figs. 1 and 2), the shield plate 4 closes the window opening 3 at the backward position (i.e., the lower position); and opens the window opening 3 at the forward position (i.e., the upper position).

[0021] As is conventionally known, the main cap portion 5 can be made up of a jet-type outer shell 11, a rim

member 12 having a substantially U-shaped section, and a backing member (not shown) for the main cap portion. The outer shell 11 forms the outer wall of the main cap portion 5. Note that the rim member 12 has a substantially E-shaped section at the upper end portion of the window 8. The rim member 12 has a substantially U-shaped section at the reminding portion of the window 8 except the upper end portion and is fixed to the outer shell 11 throughout the end portion of the outer shell 11 with an adhesive or the like. The backing member is brought into contact with the outer shell 11 to be fixed to it in contact with the inner surface of the outer shell 11 with an adhesive or the like. As is conventionally known, the outer shell 11 can be made of a composite material. More specifically, the outer shell 11 can be formed by lining the inner surface of a strong shell body made of a hard synthetic resin, e.g., FRP, with a flexible sheet such as an unwoven fabric. As is conventionally known, a portion of the rim member 12 having the substantially U-shaped section can be made of a soft synthetic resin such as foamed vinyl chloride or synthetic rubber. A portion of the rim member 12 having the substantially E-shaped section can be made of an elastic material with high flexibility such as synthetic rubber.

[0022] As is conventionally known, the backing member for the main cap portion can be constituted by an impact absorbing liner for the main cap portion, attached to the inner surface of the outer shell 11 for the main cap portion with an adhesive or the like, and a blockish inside pad for the main cap portion and a backing cover for the main cap portion which are sequentially attached to cover substantially the inner surface of the impact absorbing liner. The impact absorbing liner for the main cap portion can be made of a material with appropriate rigidity and plasticity such as foamed polystyrene or another synthetic resin. The blockish inside pad for the main cap portion can be made of one or a plurality of elastic materials with high flexibility such as urethane foam or another synthetic resin, and a porous unwoven fabric covering the inner and outer surfaces of the elastic material (s) to form a bag. The backing cover for the main cap portion can be made of a porous unwoven fabric formed by laminating layers, consisting of an elastic material with high flexibility such as urethane foam or another synthetic resin, on the surface opposing the impact absorbing liner for the main cap portion.

[0023] As is conventionally known, the subsidiary cap portion 6 can be made up of an outer shell 14, a rim member 16 having a substantially E-shaped section, and a backing member (not shown) for the subsidiary cap portion. The outer shell 14 forms the outer wall of the subsidiary cap portion 6. The rim member 16 is fixed to part (i.e., the end portion of the window 15) of the end portion of the outer shell 14 with an adhesive or the like. The backing member for the subsidiary cap portion is brought into contact with the outer shell 14 to be fixed to it in contact with the inner surface of the outer shell 14 with an adhesive or the like. As is conventionally

known, the outer shell 14 and the rim member 16 having the substantially E-shaped section can be made of the same materials as those described above concerning the outer shell 11 for the main cap portion and the rim member 12 having substantially the E-shaped section. A pair of right and left cover members 17 for externally covering the pair of right and left attaching screws 7 are attached to the outer shell 14 to be reciprocally pivotal about their front edge portions as the fulcrums. When the cover members 17 are outwardly pivoted forward through about 90°, the heads of the attaching screws 7 are exposed. Inversely, when the cover members 17 are pivoted backward, the heads of the attaching screws 7 are covered by the cover members 17, as shown in Figs. 1 to 3.

[0024] As is conventionally known, the backing member for the subsidiary cap portion can be constituted by an impact absorbing liner for the subsidiary cap portion, and a backing cover for the subsidiary cap portion, attached to the inner surface of the impact absorbing liner to substantially cover it. The impact absorbing liner for the subsidiary cap portion is attached to the inner surface of the outer shell 14 for the subsidiary cap portion with an adhesive or the like, and can be made of a material with appropriate rigidity and plasticity such as foamed polyurethane rubber or another synthetic resin. The backing cover for the subsidiary cap portion can be made of synthetic leather or another cloth made of a synthetic resin such as vinyl chloride resin, or another fabric.

[0025] A pair of right and left subsidiary cap portion locking mechanisms 21 are incorporated in the head protecting body 2. Each of the pair of subsidiary cap portion locking mechanisms 21 has a function of locking the subsidiary cap portion 6 at the lower position with the head protecting body 2, as is clearly shown in Fig. 4. The pair of subsidiary cap portion locking mechanisms 21 are unlocked by a common release button 22 serving as an unlocking means or member.

[0026] As shown in Figs. 7 to 9, the release button 22 is held by a button holding mechanism 20 serving as an unlocking member holding mechanism at substantially the central portion of the subsidiary cap portion 6 (i.e., a portion opposing the distal end of the wearer's chin) to be linearly, reciprocally slidable. The button holding mechanism 20 is constituted by the outer shell 14 for the subsidiary cap portion, and a button holding member 23. The button holding member 23 is made of an appropriate material such as a synthetic resin, e.g., polyacetal resin or ABS resin. The button holding member 23 has a member main body 25. The member main body 25 has an elongated hole 24 extending at substantially the central portion of its upper surface in the back-and-forth direction, and forms a substantially box-like lid. A pair of left and right substantially V-shaped attached pieces 26a and 26b are formed on the left and right sides of the member main body 25 by, e.g., monolithic molding. The attached pieces 26a and 26b respectively have screw

engaging holes 27. A guide 30 is formed near the front end of the upper surface of the member main body 25 by, e.g., monolithic molding. The guide 30 has a pair of left and right arcuated pieces 29a and 29b extending outwardly to the left and right, respectively. A pair of left and right subsidiary guide plates 31a and 31b are formed on the front end face of the member main body 25 by, e.g., monolithic molding. A pair of left and right attaching bosses 33a and 33b for attaching the button holding member 23 are formed at substantially the central portion of the outer shell 14 for the subsidiary cap portion (i.e., a portion opposing the distal end of the wearer's chin) by, e.g., monolithic molding. A finger-inserting aperture 34 is formed between the pair of attaching bosses 33a and 33b.

[0027] As shown in Figs. 7 and 8, the release button 22 is formed of an appropriate material such as a synthetic resin, e.g., nylon 6 or ABS resin, to have a substantially blockish shape. A finger-inserting notched portion 28 is formed in one half of the lower surface of the release button 22. The notched portion 28 forms, in the release button 22, a press surface 28a (i.e., a surface substantially perpendicularly intersecting the aperture 34) used for pressing the release button 22 with a finger. A columnar portion 35 having a screw hole 36 is formed on substantially the central portion of the upper surface of the release button 22 by, e.g., monolithic molding. A pair of left and right substantially L-shaped arms 37a and 37b, and a protrusion 38, all of which extend from the columnar portion 35, are formed on the upper surface of the release button 22 by, e.g., monolithic molding.

[0028] As shown in Figs. 7 and 8, a wire attaching member 39 serving as a wire body attaching member attached and fixed to the release button 22 is formed of an appropriate material such as a synthetic resin, e.g., nylon 6 or ABS resin, to have a substantially platelike shape. An elongated hole 40 extending in the back-and-forth direction is formed at substantially the central portion of the attaching member 39. A substantially semi-circular wire engaging portion 71 is formed on a surface of the attaching member 39 opposite to the outer shell 14 by, e.g., monolithic molding, to be near the rear end of the elongated hole 40. A pair of left and right projecting ridges 72a and 72b are formed on the left and right sides of the wire engaging portion 71 by, e.g., monolithic molding.

[0029] The release button 22 is accommodated in the button holding mechanism 20, constituted by the outer shell 14 for the subsidiary cap portion and the button holding member 23, to be linearly reciprocally slidable. To accommodate the release button 22, first, the release button 22 is fitted in the button holding member 23 to be linearly reciprocally slidable. When fitting the release button 22, the columnar portion 35, the pair of left and right arms 37a and 37b, and the protrusion 38 of the release button 22 are inserted in the elongated hole 24 of the button holding member 23. In this case, the pair

of arms 37a and 37b are held to be linearly reciprocally slidable along the left and right rims of the elongated hole 24. The right and left side surfaces and upper surface of the release button 22 are also held to be linearly reciprocally slidable along the left and right inner surfaces and lower surface of the member main body 25 of the button holding member 23.

[0030] Subsequently, the button holding member 23 fitted with the release button 22 is attached and fixed to the outer shell 14 for the subsidiary cap portion. A pair of left and right attaching screws 73a and 73b inserted in the screw engaging holes 27 of the attached pieces 26a and 26b are screwed and fixed in the pair of left and right attaching bosses 33a and 33b of the outer shell 14 for the subsidiary cap portion, attaching and fixing the member 23. Accordingly, the release button 22 is reciprocally slidable with respect to the button holding member 23 in directions indicated by arrows A and B in Figs. 4 and 7.

[0031] The wire attaching member 39 is attached and fixed to the release button 22. An attaching screw 75 is inserted in a washer 74 and the elongated hole 40 of the wire attaching member 39, and the attaching screw 75 is then screwed and fixed in the screw hole 36 of the columnar portion 35 of the release button 22, thereby attaching and fixing the member 39. In this case, the washer 74 is placed on the wire engaging portion 71 and the pair of left and right projecting ridges 72a and 72b of the wire attaching member 39. The wire attaching member 39 is placed on the pair of left and right arms 37a and 37b and the protrusion 38 of the release button 22.

[0032] When the attaching screw 75 is slightly screwed into the screw hole 36, an intermediate portion (in this case, substantially the central portion) 32c of a tractive wire 32, serving as a tractive flexible wire and made of a metal or the like, is hooked on the substantially arcuated portion of the wire engaging portion 71 of the wire attaching member 39 to form substantially a U-letter shape, and thereafter the attaching screw 75 is screwed into the screw hole 36 to fix the wire attaching member 39. In this case, before screwing and fixing, the wire attaching member 39 is linearly moved back and forth by utilizing the elongated hole 40, so that the attaching position in the back-and-forth direction of the wire attaching member 39 with respect to the release button 22 can be adjusted. This adjusts the tautness of the tractive wire 32 to remove the unnecessary slack of the tractive wire 32. The left and right portions of the tractive wire 32 that are directly continuous to the substantially U-shaped intermediate portion 32c are wound on the pair of left and right arcuated pieces 29a and 29b. The tractive wire 32 is used commonly by the pair of right and left subsidiary cap portion locking mechanisms 21. More specifically, the tractive wire 32 has a pair of left and right wire portions 32a and 32b continuous to the two ends of the U-shaped intermediate portion 32c. The wire portion 32a (to be referred to as the "tractive

wire 32a" hereinafter) on the right side (i.e., on right side of the front surface of the helmet 1; this applies to the following description) is used by the right subsidiary cap portion locking mechanism 21. The wire portion 32b (to be referred to as the "tractive wire 32b" hereinafter) on the left side (i.e., on left side of the front surface of the helmet 1; this applies to the following description) is used by the left subsidiary cap portion locking mechanism 21. Since the right and left subsidiary cap portion locking mechanisms 21 are symmetric, a description will be made concerning the right subsidiary cap portion locking mechanism 21 hereinafter with reference to Figs. 4 to 6, and a description on the left subsidiary cap portion locking mechanism 21 will be omitted.

[0033] Referring to Figs. 4 to 6, an attaching base 41 made of an appropriate material such as a metal like stainless steel, or a synthetic resin like ABS resin, is attached and fixed to the inner surface of the right ear 6b of the subsidiary cap portion 6 with an attaching screw 42. A lock lever 43 serving as a movable locking means or member is axially supported on the attaching base 41 with an attaching screw 44 to be reciprocally pivotal. A stopped portion 45 made of a flat-plate-like upright portion is integrally formed on one end portion of the lock lever 43. A wire attached portion 46 formed of an L-shaped upright portion is integrally formed on the other end portion of the lock lever 43. Since the stopped portion 45 is inserted in an incision 47 formed in the attaching base 41, the forward and backward pivot positions of the lock lever 43 are regulated by the attaching base 41. The wire attached portion 46 fixes the distal end portion of an attaching rod 48, the proximal end portion of which extends from the lock lever 43. The free end portion of the tractive wire 32a is fixed to the attaching rod 48.

[0034] A spring retainer 49 which can have a substantially cup-like shape is formed on the attaching base 41 by monolithic molding or with an adhesive. The tractive wire 32a is inserted in a wire inserting hole 50 of the spring retainer 49. The tractive wire 32a extends through a flexible tube 52 made of an appropriate elastic material such as synthetic rubber. One end portion of the tube 52 is held in position by the arcuated piece 29a and subsidiary guide plate 31a of the button holding member 23, and abuts against a front end face 63 of the member main body 25. The other end portion of the tube 52 abuts against the spring retainer 49. One end portion of a tube 52 identical to the above tube 52 and used by the left subsidiary cap portion locking mechanism 21 is also held in position by the arcuated piece 29b and subsidiary guide plate 31b of the button holding member 23, and abuts against the front end face 63 of the member main body 25.

[0035] A compression coil spring 51 through which the tractive wire 32a extends is interposed between the spring retainer 49 and the wire attached portion 46 of the lock lever 43. For this reason, the lock lever 43 is biased by the coil spring 51 to pivot counterclockwise in

Fig. 4 about the attaching screw 44 as the center. Since the lock lever 43 is biased to pivot counterclockwise in Fig. 4, the release button 22 is tractively biased by the tractive wire 32a to move backward in the direction indicated by the arrow B in Figs. 4 and 7.

[0036] The release button 22 can move forward in the direction indicated by the arrow A in Figs. 4 and 7 against the tractive biasing force of the tractive wire 32a. The forward moving direction A of the release button 22 forms an acute angle θ with respect to a downward moving direction (i.e., a backward pivot direction about the attaching screws 7 as the fulcrum) C of the subsidiary cap portion 6, as shown in Fig. 4. In the embodiment shown in Fig. 4, the acute angle θ is about 25° . However, from the viewpoint of practicability, this angle is preferably 0° to 60° , and more preferably 0° to 45° . The forward moving direction A of the release button 22 is inward (i.e., backward in Fig. 4) of the downward moving direction C of the subsidiary cap portion 6. However, this direction A need not be inward but can be outward. In order to operate the release button 22 forward and move the subsidiary cap portion 6 upward very smoothly, the forward moving direction A of the release button 22 is preferably inward of the downward moving direction C of the subsidiary cap portion 6. In this case, the acute angle θ is particularly preferably 5° to 45° .

[0037] A pair of right and left lock pins 54 serving as a stationary locking means or member project near the lower end of the outer surface of the outer shell 11 of the main cap portion 5. The lock levers 43 of the right and left subsidiary cap portion locking mechanisms 21 selectively engage with the lock pins 54 depending on their pivot positions. Each lock lever 43 is formed with an abutting portion 43a against which the corresponding lock pin 54 abuts. A locking recess 62 to engage with the lock pin 54 is formed adjacent to the abutting portion 43a.

[0038] The respective portions (i.e., the attaching bases 41, coil springs 51, lock levers 43, attaching rods 48, attaching screws 42 and 44, and the like) of the locking mechanisms 21, the release button 22, the button holding mechanism 20 (i.e., the button holding member 23, attaching bosses 33a and 33b, and the like), the wire attaching member 39, the washer 74, the attaching screws 73a, 73b, and 75, the tubes 52, the tractive wires 32a and 32b, and the like are arranged along the inner surface of the outer shell 14 for the subsidiary cap portion. Hence, recesses and ridge grooves for accommodating these portions are formed in the surface of the impact absorbing liner for the subsidiary cap portion that opposes the outer shell 14.

[0039] As shown in Figs. 1 to 3, a ventilation aperture forming member 55 for the forehead is attached to the outer surface of the forehead portion of the main cap portion 5. A stopper 56 for regulating the backward position of the shield plate 4 is provided to the right portion of the outer surface of the subsidiary cap portion 6. Various types of ventilation apertures 57, 58, and 59 are

formed in the chin cover 6a of the subsidiary cap portion 6. As shown in Figs. 4 to 6, an air guide plate 60 is attached to the inner surface of the chin cover 6a with attaching screws 61 so as to oppose the ventilation apertures 57. Therefore, air flowing into the head protecting body 2 through the ventilation apertures 57 is guided by the front surface of the air guide plate 60 to move upward in the head protecting body 2 along the inner surface of the shield plate 4.

[0040] How to use the full-face-type helmet serving also as the jet-type helmet having the above arrangement will be described.

[0041] Assume that the wearer wishes to use the helmet 1 as a full-face-type helmet. If the subsidiary cap portion 6 is at the upper position, as shown in Fig. 3, the wearer pivots it downward about the attaching screws 7 as the center, thereby bringing it to the lower position shown in Figs. 1 and 2.

[0042] In this case, the abutting portions 43a of the lock levers 43 provided to the subsidiary cap portion 6 as shown in Fig. 6 abut against the lock pins 54. The lock levers 43 are accordingly pressed by the lock pins 54, and pivot slightly forward clockwise in Fig. 6 about the attaching screws 44 as the fulcrum against the biasing force of the coil springs 51. The lock pins 54 thus ride over the abutting portions 43a of the lock levers 43, as shown in Fig. 4, to engage with the corresponding locking recesses 62. The subsidiary cap portion 6 is securely locked by the main cap portion 5 with the pair of right and left subsidiary cap portion locking mechanisms 21, so that the head protecting body 2 serves as the full-face-type.

[0043] Assume that the wearer wishes to use the helmet 1 shown in Figs. 1 and 2, currently serving as the full-face-type helmet, as a jet-type helmet shown in Fig. 3. In the state shown in Fig. 4, the wearer inserts his finger (e.g., index finger and/or middle finger) in the notched portion 28 of the release button 22 through the aperture 34 located at substantially the central portion of the outer surface of the chin cover 6a of the subsidiary cap portion 6. The wearer presses the press surface 28a of the release button 22 with this finger downward in the forward direction, indicated by the arrow A in Fig. 4, against the biasing force of the coil springs 51. In this case, since the press surface 28a substantially perpendicularly intersects the forward direction A of the release button 22, the direction of the force applied by the finger onto the release button 22 substantially coincides with this forward direction A.

[0044] Since the release button 22 moves forward in the direction indicated by the arrow A against the biasing force of the coil springs 51, the tractive wire 32a is pulled by the release button 22 to slide along the arcuated piece 29a of the button holding member 23. Therefore, the lock levers 43 in the state shown in Fig. 4 pivot forward clockwise about the attaching screws 44 as the fulcrum to be set in the state shown in Fig. 5. This unlocks the subsidiary cap portion 6 locked on the main

cap portion 5 by the subsidiary cap portion locking mechanisms 21. Accordingly, if the wearer simultaneously places his finger (e.g., the thumb) on substantially the central portion of the lower end of the subsidiary cap portion 6 (e.g., grabs the subsidiary cap portion 6 from the upper and lower sides with his index finger and/or middle finger inserted in the notched portion 28 and his thumb placed on substantially the central portion of the lower end of the subsidiary cap portion 6), and raises the subsidiary cap portion 6, the subsidiary cap portion 6 pivots upward about the attaching screws 7 as the fulcrum. The subsidiary cap portion 6 is set in the state shown in Fig. 3 through the state shown in Fig. 6. Thus, the head protecting body 2 serves as the jet-type.

[0045] In the first embodiment, the tractive wires 32a and 32b are inserted in the tubes 52. The tractive wires 32a and 32b can be easily set not to come into substantial contact with any foreign matter other than the tubes 52. As a result, the tractive wires 32a and 32b can always move comparatively smoothly. These tubes 52 can be omitted if necessary. If the tubes 52 are omitted, the tractive wires 32a and 32b are preferably selected to have such a length that they extend substantially linearly between the arcuated pieces 29a and 29b of the guide plate 30 of the button holding member 23 and the spring retainers 49 of the attaching bases 41.

Second Embodiment

[0046] The second embodiment in which the present invention is applied to a full-face-type helmet serving also as a jet-type helmet will be described with reference to Figs. 10 to 22.

[0047] The helmet of the second embodiment shown in Figs. 10 to 22 has substantially the same arrangement, function, and effect as those of the helmet according to the first embodiment described above shown in Figs. 1 to 9, except for the differences and respects concerning them described in the following items (1) to (7). Accordingly, in the following description, only the differences and respects concerning them described in these items (1) to (7) will be described. Portions that are common between the helmet according to the second embodiment shown in Figs. 10 and 22 and the helmet according to the first embodiment described above shown in Figs. 1 to 9 are denoted by the same reference numerals, and a description other than the differences and respects concerning them will be omitted.

(1) A pair of right and left support plates 81 for supporting a subsidiary cap portion 6 onto a main cap portion 5 are provided to the main cap portion 5.

(2) Cover members corresponding to the cover members 17 for covering attaching screws 7 used to attach the subsidiary cap portion 6 to the main cap portion 5 are omitted.

(3) A finger putting plate 83 serving as a finger putting portion is provided to a button holding mem-

ber 23 of a button holding mechanism 20.

(4) A subsidiary attaching base 82 is provided to an attaching base 41 of each subsidiary cap portion locking mechanism 21.

(5) A pair of left and right flexible tubes, corresponding to the tubes 52 through which a pair of left and right tractive wires 32a and 32b are inserted, are omitted.

(6) A wire attaching member 39 of the button holding mechanism 20 is arranged upside down.

(7) The arrangement of ventilation apertures 59 formed in a chin cover 6a of the subsidiary cap portion 6 is altered.

Items (1) and (2)

[0048] Each of the pair of right and left support plates 81 is an elongated platelike member extending in substantially the back-and-forth direction, as shown in Figs. 11 and 12, and can be made of a material similar to that described above concerning the button holding member 23. The support plates 81 are fixed to an outer shell 11 for a main cap portion with attaching screws 84 at their portions near the front end portions. The portions of the support plates 81 near the rear end portions are also fixed, together with ears 6b of the subsidiary cap portion 6, to the outer shell 11 for the main cap portion with attaching screws (i.e., axial support means) 7. The cover members 17 provided in the first embodiment for the attaching screws 7 are omitted in the second embodiment.

[0049] As shown in Figs. 21 and 22, a projection 86 to fit in a coil portion 85a provided at the central portion of a spring 85 serving as a biasing means is formed on each support plate 81 by monolithic molding or the like. The spring 85 serves as a torsion coil spring, and further has first and second wire portions 85b and 85c extending from the coil portion 85a in substantially the opposite directions. The support plate 81 is formed with a pair of spring catching projections 87 and 88 by monolithic molding or the like to engage with the first coil portion 85b. The first wire portion 85b is inserted between the pair of projections 87 and 88.

[0050] As shown in Figs. 21 and 22, a pair of right and left projections 89 serving as positioning means project from the inner surface of an outer shell 14 at each of the pair of right and left ears 6b of the subsidiary cap portion 6. The second wire portion 85c of the spring 85 is bent almost arcuately. When the subsidiary cap portion 6 is at the lower position, as shown in Figs. 11 and 21, the positioning projection 89 serving also as the spring hook means presses against the arcuated second wire portion 85c.

[0051] The support plates 81 are formed with a pair of right and left recesses 90 serving as positioning means. When the subsidiary cap portion 6 is at the lower position, as shown in Fig. 11, the positioning projections 89 lightly engage or fit with the recesses 90, as shown in Fig. 21, to prohibit the subsidiary cap portion 6 from

moving with a comparatively small action force. When the projections 89 engage or fit with the recesses 90, the upward biasing force for the subsidiary cap portion 6 generated by the springs 85 can be entirely or partially reduced by this engagement or fitting. The subsidiary cap portion 6 located at the lower position is not only locked at the lower position by the pair of right and left subsidiary cap portion locking mechanisms 21, but is lightly held in position at the lower position by the recess-projection engagement of the positioning means 89 and 90, so that its forward movement is prohibited by a comparatively small action force. The springs 85 bias the subsidiary cap portion 6 upward (i.e., in the forward direction) through the positioning projections 89, so that the subsidiary cap portion 6 is raised smoothly when the recess-projection engagement is canceled. Furthermore, since the springs 85 bias the subsidiary cap portion 6 clockwise in Figs. 11 and 13 with respect to the main cap portion 5 about the attaching screws (i.e., axial support means) 7 as the fulcrum, they prevent lock pins 54 from removing accidentally from locking recesses 62 of lock levers 43 upon vibration or the like of the helmet 1.

[0052] Each support plate 81 is formed with a substantially semicylindrical stopper projection 91 by monolithic molding or the like. When the subsidiary cap portion 6 is at the upper position, as shown in Fig. 12, the positioning projection 89 engages with the stopper projection 91, as shown in Fig. 22. The support plate 81 is also formed with a stopper projection 92, having an inclined surface, adjacent to the stopper projection 91 by monolithic molding or the like. While the subsidiary cap portion 6 moves from the lower position to immediately before the upper position, the positioning projection 89 gradually rides over the inclined surface of the stopper projection 92. Accordingly, while the subsidiary cap portion 6 moves from the lower position to immediately before the upper position, the positioning projection 89 rides over the inclined surface of the stopper projection 92 and thereafter passes it. As a result, as shown in Fig. 22, the positioning projection 89 (and also the subsidiary cap portion 6) is completely prohibited by the stopper projection 91 from moving further forward and by the stopper projection 92 from moving backward, with a comparatively small action force.

Item (3)

[0053] The finger putting plate 83 having a substantially vertical finger putting surface 83a is formed on the rear end face of a member main body 25 of the button holding member 23 of the button holding mechanism 20 by monolithic molding or the like. The finger putting surface 83a has projecting ridges 93a, 93b, and 94 at its left and right side end portions and lower end portion, respectively. The projecting ridges 93a, 93b, and 94 form a substantially U-letter shape as a whole. Accordingly, when raising the subsidiary cap portion 6, if the

wearer places his finger (e.g., thumb) on the finger putting surface 83a of the finger putting plate 83, in place of placing his finger at substantially the central portion of the lower end of the subsidiary cap portion 6 as in the first embodiment, and thereafter raises the subsidiary cap portion 6 upward, this raising operation can be performed smoothly.

[0054] The outer shell 14 is formed with an expansion 95 at substantially the central portion of the lower end of the chin cover 6a of the subsidiary cap portion 6 to slightly expand forward to conform to the shape of the finger putting plate 83.

Item (4)

[0055] In the second embodiment, the attaching base 41 corresponding to the attaching base 41 of the first embodiment is constituted by the main attaching base 41 and the subsidiary attaching base 82, as shown in Figs. 13 and 17. In this case, the subsidiary attaching base 82 may be made of the same material as that described above concerning the attaching base 41. Note that the main attaching base 41 is preferably made of a metal and the subsidiary attaching base 82 is preferably made of a synthetic resin.

[0056] As shown in Fig. 17, the main attaching base 41 can have a flat platelike shape. The main attaching base 41 is formed with a pair of boss inserting holes 101a and 101b, a rivet inserting hole 102, a boss inserting hole 103, and a screw inserting hole 104. In the first embodiment, the spring retainer 49 is formed on the attaching base 41. In the second embodiment, a spring retainer 49 is formed on the subsidiary attaching base 82 by monolithic molding or the like. The subsidiary attaching base 82 has a step 82a at substantially its central portion, and a front plate 82b and a rear plate 82c on the two sides of the step 82a. The rear plate 82c is formed with a pair of screw inserting bosses 105a and 105b and the spring retainer 49 by monolithic molding or the like.

[0057] Spherical bodies 106 made of a metal or the like are fixed to the free ends of the pair of right and left tractive wires 32a and 32b, as shown in Figs. 13 and 17. A substantially semicircular engaging notch 107 is formed on the free end of a wire attached portion 46 of each lock lever 43. A substantially circular engaging aperture 108 is formed in a lever main body 109 of the lock lever 43, on a side of the engaging notch 107 opposite to the outer shell 14. Portions near the free ends of the tractive wires 32a and 32b are inserted between the lever main bodies 109 of the lock levers 43 and the wire attached portions 46 from above, and the spherical bodies 106 are fitted in the engaging notches 107 and engaging apertures 108, thereby fixing the free ends of the tractive wires 32a and 32b to the lock levers 43.

[0058] On the inner surface of the outer shell 14, a pair of upper and lower projecting ridges 111a and 111b extending substantially horizontally are formed on each of the left and right sides of the chin cover 6a of the sub-

sidary cap portion 6, as shown in Figs. 13 and 17, by monolithic molding or the like. On the inner surface of the outer shell 14, a pair of upper and lower screwing bosses 112a and 112b, a positioning boss 113, and a screwing boss 114 are formed on each of the left and right sides of the chin cover 6a of the subsidiary cap portion 6 by monolithic molding or the like, to be adjacent to the projecting ridges 111a and 111b. The substantially intermediate portion of each of the tractive wires 32a and 32b is interposed between the corresponding pair of projecting ridges 111a and 111b so that it is positioned to a certain degree. A rivet 116 inserted in a rivet engaging hole 115, formed in the lever main body 109 of the lock lever 43, and the rivet engaging hole 102 in the main attaching base 41 pivotally fixes the lock lever 43 to the attaching base 41. The positioning boss 113 is fitted in the boss inserting hole 103 of the attaching base 41, and the front surface of the attaching base 41 is abutted against the distal end face of the screwing boss 114. After that, a screw 117 is inserted in the screw inserting hole 104 of the attaching base 41 and screwed into the screwing boss 114, thereby fixing the attaching base 41 to the inner surface of the outer shell 14.

[0059] As shown in Figs. 13 and 17, the pair of screwing bosses 112a and 112b are inserted in the boss inserting holes 101a and 101b of the attaching base 41. The distal end faces of the bosses 112a and 112b abut against a surface, on the outer shell 14 side, of the front plate 82b of the subsidiary attaching base 82. A pair of upper and lower screws 118a and 118b are inserted in the screw inserting bosses 105a and 105b, and screwed into the screwing bosses 112a and 112b, thereby fixing the subsidiary attaching base 82 and main attaching base 41 to the inner surface of the outer shell 14.

[0060] According to the above arrangement, as shown in Fig. 16, a gap 121 is defined by the main attaching base 41, the lock lever 43, and the rear plate 82c of the subsidiary attaching base 82. Accordingly, the subsidiary attaching base 82 serves as a gap defining member as well. When the subsidiary cap portion 6 is at the lower position shown in Figs. 13 and 14 and at the intermediate position shown in Fig. 15 which is slightly above the lower position, portions of the outer shell 11 of the main cap portion 5 near its lower end are inserted in the corresponding gaps 121. Therefore, portions of the outer shell 11 near its lower end (also the lock pins 54) and the lock levers 43 of the subsidiary cap portion 6 are positioned relative to each other to a certain degree in the direction of thickness of the outer shell 11. This can prevent the lock pins 54 from accidentally, relatively removing from the locking recesses 62 of the lock levers 43, or from abutting portions 43a of the lock levers 43, to a certain degree. A cover member (not shown) for covering the outer surface and, if necessary, the inner surface as well, of a portion of the outer shell 11 near its lower end may be provided, and the lock pins 54 may be fixed to the cover member. This cover member can be made of the same material as that described

above concerning the button holding member 23.

[0061] As shown in Fig. 16, on the inner surface of the outer shell 14, the pair of right and left subsidiary attaching bases 82 are formed on the right and left sides of the chin cover 6a of the subsidiary cap portion 6. Accordingly, the gap 121 is formed on each of the right and left sides to form a pair. A pair of right and left portions of the outer shell 11, near the lower end, of the main cap portion 5 are inserted in the pair of right and left gaps 121, respectively. This insertion amount is the maximum when the subsidiary cap portion 6 is at the lower position shown in Figs. 13 and 14, and decreases gradually as the subsidiary cap portion 6 moves forward from the lower position shown in Figs. 13 and 14 to the intermediate position shown in Fig. 15 which is slightly above the lower position. When the subsidiary cap portion 6 further moves upward from the intermediate position shown in Fig. 15, the pair of right and left portions of the outer shell 11 near its lower end completely disengage from the pair of right and left gaps 121. When the subsidiary cap portion 6 moves downward, an operation precisely opposite to that described above is performed.

Item (5)

[0062] In the first embodiment, the pair of left and right tubes 52 are provided to extend the pair of left and right tractive wires 32a and 32b therethrough. In the second embodiment, such tubes 52 are omitted. Therefore, the tractive wires 32a and 32b extend substantially linearly between arcuated pieces 29a and 29b of a guide 30 of the button holding member 23 and the spring retainers 49 of the subsidiary attaching bases 41.

Item (6)

[0063] In the second embodiment, the wire attaching member 39 of the button holding mechanism 20 is arranged upside down from the state of the first embodiment, as shown in Figs. 18 and 19. Accordingly, a wire engaging portion 71 and a pair of left and right projecting ridges 72a and 72b are formed on the surface of the wire attaching member 39 on the outer shell 14 side.

[0064] In the post-assembly state shown in Figs. 18 and 20, a pair of left and right arms 37a and 37b of a release button (i.e., unlocking member) 22 are fitted between the pair of left and right projecting ridges 72a and 72b of the wire attaching member 39. In other words, a projection formed by the pair of left and right arms 37a and 37b (the intermediate portion of this projection, i.e., the portion between the pair of arms 37a and 37b, forms a notch) is fitted in a recess formed between the pair of left and right projecting ridges 72a and 72b through recess-projection fitting, to be linearly, reciprocally slidable.

[0065] The wire engaging portion 71 of the wire attaching member 39 is inserted between the pair of left and right arms 37a and 37b. A U-shaped intermediate

portion 32c of the tractive wire 32 is hooked on the wire engaging portion 71, and abuts against the right and left sides of a columnar portion 35 of the release button 22. Accordingly, the intermediate portion 32c is securely sandwiched from the two sides by the proximal end portions of the pair of left and right arms 37a and 37b of the release button 22 and a surface of the wire attaching member 39 on the outer shell 14 side.

[0066] In the first embodiment, the pair of arms 37a and 37b of the release button 22 linearly, reciprocally slide along the rim of the elongated hole 24 of the button holding member 23. In contrast to this, in the second embodiment, the pair of projecting ridges 72a and 72b of the wire attaching member 39 linearly, reciprocally slide along the rim of an elongated hole 24 corresponding to their counterpart of the first embodiment.

Item (7)

[0067] In the first embodiment, the chin cover 6a of the subsidiary cap portion 6 is formed with the pair of right and left comparatively large ventilation apertures 59. In contrast to this, in the second embodiment, the right and left ventilation aperture pairs 59, each consisting of comparatively small two, front and rear ventilation apertures, are formed.

[0068] Having described two specific preferred embodiments of this invention with reference to the accompanying drawings, it is to be understood that the invention is not limited to that precise embodiments, and that various changes and modifications may be effected therein by one skilled in the art without departing from the scope or spirit of the invention as defined in the appended claims.

[0069] For example, in the first and second embodiments, the direction perpendicularly intersecting the press surface 28a of the release button 22 substantially coincides with the forward moving direction A of the release button 22. However, if these two directions more or less do not coincide with each other, no problem arises. In this case as well, an acute angle θ' formed by the direction perpendicularly intersecting the press surface 28a of the release button 22 with respect to the downward moving direction C of the subsidiary cap portion 6 may have the same angular range as that described concerning the acute angle θ .

Claims

1. A helmet including a cap-shaped head protecting body (2) to be worn by a helmet wearer on his/her head, said head protecting body (2) having a main cap portion (5) and a subsidiary cap portion (6) attached to said main cap portion (5) to be substantially vertically movable so as to selectively cover a chin of the helmet wearer,
said head protecting body (2) being provided

with first and second locking mechanisms (21) for respectively locking left and right sides of said subsidiary cap portion (6) with respect to said main cap portion (5) when said subsidiary cap portion (6) is at a lower position to cover the chin, and

said head protecting body (2) being also provided with a common unlocking member (22) which is operatable to commonly unlock said subsidiary cap portion (6) locked by said first and second locking mechanisms (21),

wherein said helmet is provided with a common tractive flexible wire (32) for commonly transmitting a movement of said unlocking member (22) to first and second movable locking members (43) of said first and second locking mechanism (21),

one end portion of said wire (32) is connected to said first movable locking member (43) and the other end portion of said wire (32) is connected to said second movable locking member (43),

said unlocking member (22) is provided with a wire engaging portion (71), and

an intermediate portion (32c) of said wire (32) is engaged by said wire engaging portion (71),

characterized in that

- said unlocking member (22) moves operatively in a forward moving direction (A) being inwardly of a downward moving direction (C) of said subsidiary cap portion (6), and
- said wire attaching member (39) is attached to said unlocking member (22) so that when said wire attaching member (39) is slid with respect to said unlocking member (22), a position where said wire attaching member (39) is attached on said unlocking member (22) is adjusted, thereby removing a slack of said wire (32).

2. A helmet according to claim 1, characterized in that

said wire engaging portion (71) is formed substantially semicircularly on a wire attaching member (39) attached to said unlocking member (22), and

said intermediate portion (32c) of said wire (32) is hooked and engaged by a substantially arcuated portion of said substantially semicircular wire engaging portion (71) to form substantially a U-letter shape.

3. A helmet according to claim 1 or 2, characterized in that

said helmet comprises a projection (37a, 37b) formed in one of said unlocking member (22) and said wire attaching member (39), and a recess formed in the other one of said unlocking member (22) and said wire attaching member (39), and

said projection (37a, 37b) is fitted in said recess to be linearly reciprocal relative to said recess,

so that said wire attaching member (39) is slidable with respect to said unlocking member (22).

4. A helmet according to any one of claims 1 to 3, characterized in that

said helmet is provided with an unlocking member holding mechanism (20) for accommodating and reciprocally holding said unlocking member (22), and

said unlocking member holding mechanism (20) is constituted by an outer shell (11) of said subsidiary cap portion (6) and a holding member (23) attached to an inner surface of said outer shell (11).

5. A helmet according to claim 4, characterized in that

said holding member (23) has a finger putting surface (83a) against which a finger is to be abutted when moving said unlocking member (22) in the forward direction (A).

6. A helmet according to claim 4 or 5, characterized in that

said holding member (23) has a pair of left and right arcuated pieces (29a, 29b) extending widely to the left and right, respectively, and

left and right side portions of said wire (32) that are directly continuous to said substantially U-shaped intermediate portion (32c) are wound on said pair of left and right arcuated pieces (29a, 29b).

7. A helmet according to any of claims 1 to 6, characterized in that

a pair of left and right wire portions (32a, 32b) of said wire (32), that are respectively continuous to said intermediate portion (32c) are inserted in a pair of left and right flexible tubes (52).

8. A helmet according to any one of claims 1 to 7, characterized in that

a set of plurality of projecting ridges (111a, 111b) are provided to each of left and right sides of an inner surface of said outer shell (11) of said subsidiary cap portion (6), said projecting ridges (111b) extending substantially parallel to each other to interpose, therebetween, a pair of left and right wire portions (32a, 32b) of said wire (32) that are respectively continuous to said intermediate portion (32c), for the purpose of positioning.

9. A helmet according to any one of claims 1 to 8, characterized in that

said subsidiary cap portion (6) is formed with first and second gap defining members (82) on left and right sides thereof, and

when said subsidiary cap portion (6) is at least at the lower position, left and right portions of said head protecting body (2) near a lower end thereof

are respectively inserted in first and second gaps (121) defined between said left and right sides of said subsidiary cap portion (6) and said first and second gap defining members (82).

10. A helmet according to any one of claims 1 to 9, characterized in that

each one of said first and second locking mechanisms (21) has first and second attaching bases (41, 81) respectively attached with said first and second movable locking members (43),

said first and second attaching bases (41, 81) are respectively constituted by a metal main attaching base (41) pivotally, axially supporting a corresponding one of said first and second movable locking members (43), and a synthetic-resin subsidiary attaching base (82) attached to said main attaching base (41), and

said subsidiary attaching base (82) is integrally molded with a retainer portion (49) for holding one end of biasing means (51) which biases said movable locking member (43) in a backward moving direction (B).

11. A helmet according to claim 10, characterized in that

said subsidiary attaching base (82) also serves as said gap defining member.

12. A helmet according to any one of claims 1 to 11, characterized in that

spherical bodies (106) are respectively fixed to one and the other end portions of said wire (32),

substantially L-shaped upright portions (46) are formed on member main bodies (109) of said first and second locking members (43) of said first and second locking mechanisms (21), respectively, said member main bodies (109) are respectively formed with substantially circular holes (108), and substantially semicircular notches (107) are formed in free end portions of said upright portions (46), and

said spherical bodies (106) are fitted in said holes (108) and said notches (107), so that said one and the other end portions of said wire (32) are connected to said first and second movable locking members (43) through said spherical bodies (106).

13. A helmet according to any one of claims 1 to 12, characterized in that

said helmet is provided with second biasing means (85) for biasing said subsidiary cap portion (6) at the lower position upward with respect to said main cap portion (5) in order to prevent said subsidiary cap portion (6) locked by said first and second locking mechanisms (21) from being unnecessarily unlocked.

14. A helmet according to claim 13, characterized in that said second biasing means is a torsion coil spring (85).

15. A helmet according to claim 14, characterized in that

said torsion coil spring (85) is attached to a subsidiary cap portion support plate (81),

said subsidiary cap portion support plate (81) is attached to said main cap portion (5), and

said subsidiary cap portion (6) is attached to said subsidiary cap portion support plate (81) through said axial support means (7) to be substantially vertically pivotal with respect to said main cap portion (5).

16. A helmet according to any one of claims 1 to 12, characterized in that

a positioning mechanism (89, 90) is provided separately of said unlocking mechanisms (21) to prohibit, with a comparatively small action force, said subsidiary cap portion (6) from moving upward with respect to said main cap portion (5) when said subsidiary cap portion (6) is at the lower position,

said positioning mechanism is constituted by first positioning means (90) provided to said main cap portion (5), and second positioning means (89) provided to said subsidiary cap portion (6) to fit with said first positioning means (90) through recess-projection fitting,

second biasing means (85) is further provided to bias said subsidiary cap portion (6) upward with respect to said main cap portion (5) when said subsidiary cap portion (6) is at the lower position, and

said biasing means (85) has a biasing force with such a strength that cannot disengage said positioning mechanism (89, 90) fitted by recess-projection fitting.

17. A helmet according to claim 16, characterized in that said second biasing means is a torsion coil spring (85).

18. A helmet according to any one of claims 1 to 17, characterized in that

said unlocking member (22) moves in the forward moving direction (A) to form an acute angle (θ) with respect to a downward moving direction of said subsidiary cap portion (6).

19. A helmet according to claim 18, characterized in that the acute angle (θ) falls within a range of 0° to 60° .

20. A helmet according to claim 18, characterized in that the acute angle (θ) falls within a range of 0° to 45° .

21. A helmet according to claim 18. characterized in that

the forward moving direction of said unlocking member (22) is inward the downward moving direction (A) of said subsidiary cap portion (6), and
the acute angle (θ) falls within a range of 0° to 45° .

Patentansprüche

1. Helm mit einem kappenförmigen Kopfschutzkörper (2), der von einem Helmträger auf dem Kopf zu tragen ist und der einen Haupt-Kappenteil (5) und einen Zusatz-Kappenteil (6) aufweist, der am Haupt-Kappenteil (5) im Wesentlichen vertikal beweglich befestigt ist, um das Kinn des Helmträgers selektiv zu bedecken;

- wobei der Kopfschutzkörper (2) mit einem ersten und einem zweiten Verriegelungsmechanismus (21) zum jeweiligen Verriegeln der linken und der rechten Seite des Zusatz-Kappenteils (6) in Bezug auf den Haupt-Kappenteil (5) versehen ist, wenn sich der Zusatz-Kappenteil (6) in seiner unteren Stellung befindet, um das Kinn zu bedecken; und
- der Kopfschutzkörper (2) auch mit einem gemeinsamen Entriegelungselement (22) versehen ist, das so bedienbar ist, dass es den durch den ersten und den zweiten Verriegelungsmechanismus (21) verriegelten Zusatz-Kappenteil (6) gemeinsam entriegelt;
- wobei der Helm mit einem gemeinsamen, flexiblen Zugdraht (32) zum gemeinsamen Übertragen der Bewegung des Entriegelungselements (22) auf ein erstes und ein zweites verstellbares Verriegelungselement (43) des ersten und zweiten Verriegelungsmechanismus (21) versehen ist;
- wobei ein Endabschnitt des Drahts (32) mit dem ersten beweglichen Verriegelungselement (43) verbunden ist und der andere Endabschnitt des Drahts (42) mit dem zweiten beweglichen Verriegelungselement (43) verbunden ist;
- wobei das Entriegelungselement (22) mit einem Drahteingriffsabschnitt (71) versehen ist; und
- wobei ein mittlerer Abschnitt (32c) des Drahts (32) mit dem Drahteingriffsabschnitt (71) in Eingriff steht;

dadurch gekennzeichnet, dass

- sich das Entriegelungselement (22) im Betrieb in einer Vorwärtsbewegungsrichtung (A) bewegt, die einwärts in Bezug auf eine Abwärts-

bewegungsrichtung (C) des Zusatz-Kappenteils (6) liegt; und

- das Drahtbefestigungselement (39) so am Entriegelungselement (22) befestigt ist, dass dann, wenn es in Bezug auf das Entriegelungselement (22) gleitet, die Position eingestellt wird, an der das Drahtbefestigungselement (39) am Entriegelungselement (22) befestigt ist, um dadurch ein Durchhängen des Drahts (32) zu beseitigen.

2. Helm nach Anspruch 1, **dadurch gekennzeichnet, dass**

- der Drahteingriffsabschnitt (71) im Wesentlichen halbkreisförmig an einem am Entriegelungselement (22) befestigten Drahtbefestigungselement (39) ausgebildet ist; und
- der mittlere Abschnitt (32c) des Drahts (32) an einem im Wesentlichen bogenförmigen Abschnitt des im Wesentlichen halbkreisförmigen Drahteingriffsabschnitts (71) eingehängt ist und mit diesem in Eingriff steht, um im Wesentlichen eine U-Form zu bilden.

3. Helm nach Anspruch 1 oder 2, **dadurch gekennzeichnet, dass**

- er einen Vorsprung (37a, 37b) aufweist, der im Entriegelungselement (22) oder im Drahtbefestigungselement (32) ausgebildet ist, und eine Aussparung aufweist, die im anderen dieser Elemente ausgebildet ist; und
- der Vorsprung (37a, 37b) so in die Aussparung eingesetzt ist, dass er relativ zu dieser linear hin- und herbewegbar ist, so dass das Drahtbefestigungselement (39) in Bezug auf das Entriegelungselement (22) verschiebbar ist.

4. Helm nach einem der Ansprüche 1 bis 3, **dadurch gekennzeichnet, dass**

- er mit einem Entriegelungselement-Haltemechanismus (20) zum Aufnehmen und hin- und herbeweglichen Halten des Entriegelungselements (22) versehen ist; und
- der Entriegelungselement-Haltemechanismus (20) aus einer Außenschale (11) des Zusatz-Kappenteils (6) und einem an der Innenseite der Außenschale (11) befestigten Halteelement (23) besteht.

5. Helm nach Anspruch 4, **dadurch gekennzeichnet, dass** das Halteelement (23) über eine Fingerauflagefläche (83a) verfügt, auf die ein Finger aufzulegen ist, wenn das Verriegelungselement (22) in der Vorwärtsrichtung (A) bewegt wird.

6. Helm nach Anspruch 4 oder 5, **dadurch gekennzeichnet, dass**

- das Halteelement (23) über ein Paar eines linken und eines rechten bogenförmigen Stücks (29a, 29b) verfügt, die sich jeweils weit nach links und rechts erstrecken; und 5
- ein linker und ein rechter Seitenabschnitt des Drahts (32), die direkt an den im Wesentlichen U-förmigen mittleren Abschnitt (32c) anschließen, auf das Paar des linken und rechten bogenförmigen Stücks (29a, 29b) aufgewickelt sind. 10

7. Helm nach einem der Ansprüche 1 bis 6, **dadurch gekennzeichnet, dass** ein Paar eines linken und eines rechten Drahtabschnitts (32a, 32b) des Drahts (32), die jeweils an den mittleren Abschnitt (32c) anschließen, in ein Paar einer linken und einer rechten flexiblen Röhre (52) eingeführt sind. 15 20

8. Helm nach einem der Ansprüche 1 bis 7, **dadurch gekennzeichnet, dass** an jeder der linken und der rechten Seite der Innenfläche der Außenschale (11) des Zusatz-Kappenteils (6) ein Satz mehrerer Vorsprungsrippen (111a, 111b) vorhanden sind, die sich im Wesentlichen parallel zueinander erstrecken, um zwischen sich ein Paar des linken und des rechten Drahtabschnitts (32a, 32b) des Drahts (32) einzuschließen, die jeweils an den mittleren Abschnitt (32c) anschließen, um ihn zu positionieren. 25 30

9. Helm nach einem der Ansprüche 1 bis 8, **dadurch gekennzeichnet, dass** 35

- der Zusatz-Kappenteil (6) mit einem ersten und einem zweiten einen Zwischenraum bildenden Element (82) an seiner linken und rechten Seite versehen ist; und
- wenn sich der Zusatz-Kappenteil (6) zumindest in der unteren Stellung befindet, der linke und der rechte Abschnitt des Kopfschutzkörpers (2) nahe seinem unteren Ende jeweils in den ersten und den zweiten Zwischenraum (121) eingefügt sind, die zwischen der linken und der rechten Seite des Zusatz-Kappenteils (6) und dem ersten und dem zweiten einen Zwischenraum bildenden Element (82) ausgebildet sind. 40 45

10. Helm nach einem der Ansprüche 1 bis 9, **dadurch gekennzeichnet, dass** 50

- sowohl der erste als auch der zweite Verriegelungsmechanismus (21) einen ersten und einen zweiten Befestigungsträger (41, 81) aufweisen, die am ersten bzw. zweiten beweglichen Verriegelungselement (43) befestigt sind; 55
- der erste und der zweite Befestigungsträger

(41, 81) jeweils aus einem metallischen Haupt-Befestigungsträger (41), der ein entsprechendes des ersten und zweiten beweglichen Verriegelungselements (43) verschwenkbar axial hält, und einem Zusatz-Befestigungsträger (82) aus Kunstharz, der am Haupt-Befestigungsträger (41) befestigt ist, bestehen; und

- der Zusatz-Befestigungsträger (82) einstückig mit einem Halteabschnitt (49) zum Halten eines Endes einer Vorspanneinrichtung (51) geformt ist, die das bewegliche Verriegelungselement (43) in einer Rückwärtsbewegungsrichtung (B) vorspannt.

11. Helm nach Anspruch 10, **dadurch gekennzeichnet, dass** der Zusatz-Befestigungsträger (82) als auch den Zwischenraum bildendes Element dient.

12. Helm nach einem der Ansprüche 1 bis 11, **dadurch gekennzeichnet, dass** am einen und anderen Endabschnitt des Drahts (32) jeweils ein kugelförmiger Körper (106) befestigt ist;

- im Wesentlichen L-förmige hochstehende Abschnitte (46) an Elementhauptkörpern (109) des ersten und des zweiten Verriegelungselements (43) des ersten bzw. zweiten Verriegelungsmechanismus (21) ausgebildet sind;
- die Elementhauptkörper (109) jeweils mit im Wesentlichen kreisförmigen Löchern (108) versehen sind und im Wesentlichen halbkreisförmige Aussparungen (107) in den freien Endabschnitten der hochstehenden Abschnitte (46) ausgebildet sind; und
- die kugelförmigen Körper (106) in die Löcher (108) und die Aussparungen (107) eingesetzt sind, so dass der eine und der andere Endabschnitt des Drahts (32) über die kugelförmigen Körper (106) mit dem ersten und dem zweiten beweglichen Verriegelungselement (43) verbunden sind.

13. Helm nach einem der Ansprüche 1 bis 12, **dadurch gekennzeichnet, dass** er mit einer zweiten Vorspanneinrichtung (85) zum Vorspannen des Zusatz-Kappenteils (6) in der unteren Stellung nach oben in Bezug auf den Haupt-Kappenteil (5) versehen ist, um zu verhindern, dass der durch den ersten und den zweiten Verriegelungsmechanismus (21) verriegelte Zusatz-Kappenteil (6) unnötig entriegelt wird.

14. Helm nach Anspruch 13, **dadurch gekennzeichnet, dass** die zweite Vorspanneinrichtung eine Torsionsschraubenfeder (85) ist.

15. Helm nach Anspruch 14, **dadurch gekennzeichnet, dass**

- die Torsionsschraubenfeder (85) an einer Halteplatte (81) für den Zusatz-Kappenteil befestigt ist;
- die Halteplatte (81) für den Zusatz-Kappenteil am Haupt-Kappenteil (5) befestigt ist; und
- der Zusatz-Kappenteil (6) mittels einer axialen Halteeinrichtung (7) so an der Halteplatte (81) für den Zusatz-Kappenteil befestigt ist, dass er im Wesentlichen vertikal in Bezug auf den Haupt-Kappenteil (5) verschwenkt.

16. Helm nach einem der Ansprüche 1 bis 12, dadurch gekennzeichnet, dass

- ein Positionierungsmechanismus (89, 90) getrennt von den Entriegelungsmechanismen (21) vorhanden ist, um zu verhindern, dass sich der Zusatz-Kappenteil (6) bei einer vergleichsweise kleinen einwirkenden Kraft nach oben in Bezug auf den Haupt-Kappenteil (5) bewegt, wenn er sich in der unteren Stellung befindet;
- der Positionierungsmechanismus mit einer am Haupt-Kappenteil (5) bestehenden ersten Positionierungseinrichtung (90) und einer am Zusatz-Kappenteil (6) vorhandenen zweiten Positionierungseinrichtung (89), die durch Aussparungs-Vorsprungs-Passung zur ersten Positionierungseinrichtung (90) passt, versehen ist;
- ferner eine zweite Vorspanneinrichtung (85) vorhanden ist, um den Zusatz-Kappenteil (6) in Bezug auf den Haupt-Kappenteil (5) nach oben vorzuspannen, wenn er sich in der unteren Stellung befindet; und
- die Vorspanneinrichtung (85) eine Vorspannkraft solcher Stärke aufweist, dass der mit der Aussparungs-Vorsprungs-Passung versehene Positionierungsmechanismus (89, 90) nicht außer Eingriff gelangen kann.

17. Helm nach Anspruch 16, dadurch gekennzeichnet, dass die zweite Vorspanneinrichtung eine Torsionsschraubenfeder (85) ist.

18. Helm nach einem der Ansprüche 1 bis 17, dadurch gekennzeichnet, dass sich das Entriegelungselement (22) in der Vorwärtsbewegungsrichtung (A) bewegt, um einen spitzen Winkel (θ) in Bezug auf die Abwärtsbewegungsrichtung des Zusatz-Kappenteils (6) zu bilden.

19. Helm nach Anspruch 18, dadurch gekennzeichnet, dass der spitze Winkel (θ) in den Bereich von 0° bis 60° fällt.

20. Helm nach Anspruch 18, dadurch gekennzeichnet, dass der spitze Winkel (θ) in den Bereich von 0° bis 45° fällt.

21. Helm nach Anspruch 18, dadurch gekennzeichnet, dass

- die Vorwärtsbewegungsrichtung des Entriegelungselements (22) nach innen in Bezug auf die Abwärtsbewegungsrichtung (A) des Zusatz-Kappenteils (6) zeigt und
- der spitze Winkel (θ) in den Bereich von 0° bis 45° fällt.

Revendications

1. Casque comprenant un corps de protection de tête en forme de coque (2) à porter sur la tête par un utilisateur du casque, le dit corps de protection de tête (2) comportant une partie de coque principale (5) et une partie de coque secondaire (6) attachée à la dite partie de coque principale (5) de façon à être déplaçable sensiblement verticalement pour couvrir sélectivement un menton du porteur du casque,

le dit corps de protection de tête (2) étant pourvu d'un premier et un deuxième mécanismes de verrouillage (21) pour bloquer respectivement les côtés gauche et droit de la dite partie de coque secondaire (6) par rapport à la dite partie de coque principale (5) lorsque la dite partie de coque secondaire (6) est à une position abaissée de couverture du menton, et

le dit corps de protection de tête (2) étant également pourvu d'un élément de déverrouillage commun (22) qui est actionnable pour déverrouiller en commun la dite partie de coque secondaire (6) bloquée par les dits premier et deuxième mécanismes de verrouillage (21),

dans lequel le dit casque comporte un câble de traction souple commun (32) pour transmettre en commun un mouvement du dit élément de déverrouillage (22) à des premier et deuxième éléments de verrouillage mobiles (43) des dits premier et deuxième mécanismes de verrouillage (21),

une partie d'extrémité du dit câble (32) est connectée au dit premier élément de verrouillage mobile (43) et l'autre partie d'extrémité du dit câble (32) est connectée au dit deuxième élément de verrouillage mobile (43),

le dit élément de déverrouillage (22) comporte une partie d'attaque de câble (71), et

une partie intermédiaire (32c) du dit câble (32) est en contact avec la dite partie d'attaque de câble (71),

caractérisé en ce que

le dit élément de déverrouillage (22) se déplace fonctionnellement dans une direction de mouvement vers l'avant (A) qui est vers l'intérieur d'une direction de mouvement vers le bas (C) de la dite partie de coque secondaire (6), et

le dit élément d'attache de câble (39) est fixé au dit élément de déverrouillage (22) de sorte que, lorsqu'on fait glisser le dit élément d'attache de câble (39) par rapport au dit élément de déverrouillage (22), on ajuste une position où le dit élément d'attache de câble (39) est fixé au dit élément de déverrouillage (22), ce qui élimine un relâchement du dit câble (32).

2. Casque selon la revendication 1, caractérisé en ce que

la dite partie d'attaque de câble (71) est formée sensiblement de façon semi-circulaire sur un élément d'attache de câble (39) fixé au dit élément de déverrouillage (22), et

la dite partie intermédiaire (32c) du dit câble (32) est accrochée à une partie sensiblement courbe de la dite partie d'attaque de câble sensiblement semi-circulaire (71) et est en contact avec cette dernière de manière à prendre sensiblement une forme en U.

3. Casque selon la revendication 1 ou 2, caractérisé en ce que

le dit casque comprend une saillie (37a, 37b) formée dans l'un du dit élément de déverrouillage (22) et du dit élément d'attache de câble (39), et un évidement formé dans l'autre du dit élément de déverrouillage (22) et du dit élément d'attache de câble (39), et

la dite saillie (37a, 37b) s'ajuste dans le dit évidement de manière à pouvoir se déplacer linéairement en va-et-vient par rapport au dit évidement, de sorte que le dit élément d'attache de câble (39) peut coulisser par rapport au dit élément de déverrouillage (22).

4. Casque selon une quelconque des revendications 1 à 3,

caractérisé en ce que

le dit casque comporte un mécanisme de maintien d'élément de déverrouillage (20) pour recevoir et maintenir en va-et-vient le dit élément de déverrouillage (22), et

le dit mécanisme de maintien d'élément de déverrouillage (20) est constitué par une coquille extérieure (11) de la dite partie de coque secondaire (6) et par un élément de maintien (23) fixé à une surface intérieure de la dite coquille extérieure (11).

5. Casque selon la revendication 4, caractérisé en ce que

le dit élément de maintien (23) présente une surface d'application de doigt (83a) contre laquelle un doigt peut venir en butée lors du déplacement du dit élément de déverrouillage (22) dans la direction vers l'avant (A).

6. Casque selon la revendication 4 ou 5, caractérisé en ce que

le dit élément de maintien (23) comprend deux pièces courbes gauche et droite (29a, 29b) s'étendant largement vers la gauche et la droite, respectivement, et

des parties de gauche et de droite du dit câble (32) qui sont directement en continuité de la dite partie intermédiaire sensiblement en forme de U (32c) sont enroulées sur les dites deux pièces courbes gauche et droite (29a, 29b).

7. Casque selon une quelconque des revendications 1 à 6,

caractérisé en ce que

deux parties de câble gauche et droite (32a, 32b) du dit câble (32), qui sont respectivement en continuité de la dite partie intermédiaire (32c), sont insérées dans deux tubes souples gauche et droit (52).

8. Casque selon une quelconque des revendications 1 à 7,

caractérisé en ce que

une pluralité de nervures en saillie (111 a, 111 b) sont prévues sur chacun des côtés gauche et droit d'une surface intérieure de la dite coquille extérieure (11) de la dite partie de coque secondaire (6), les dites nervures en saillie (111a, 111b) s'étendant sensiblement parallèlement l'une à l'autre pour interposer, entre elles, deux parties de câble gauche et droite (32a, 32b) du dit câble (32) qui sont respectivement en continuité de la dite partie intermédiaire (32c), dans un but de positionnement.

9. Casque selon une quelconque des revendications 1 à 8,

caractérisé en ce que

la dite partie de coque secondaire (6) comporte un premier et un deuxième éléments de définition d'intervalle (82) sur ses côtés gauche et droit, et

lorsque la dite partie de coque secondaire (6) est au moins à la position abaissée, les parties gauche et droite du dit corps de protection de tête (2) près de son extrémité inférieure sont respectivement insérées dans des premier et deuxième intervalles (121) définis entre les dits côtés gauche et droit de la dite partie de coque secondaire (6) et les dits premier et deuxième éléments de définition d'intervalle (82).

10. Casque selon une quelconque des revendications 1 à 9, caractérisé en ce que

chacun des dits premier et deuxième mécanismes de verrouillage (21) comprend une première et une deuxième bases d'attache (41, 81) respectivement fixées aux dits premier et deuxième éléments de verrouillage mobiles (43),

les dites première et deuxième bases d'attache (41, 81) sont respectivement constituées par une base d'attache principale en métal (41) supportant axialement de façon pivotante un élément correspondant des dits premier et deuxième éléments de verrouillage mobiles (43), et une base d'attache secondaire en résine synthétique (82) fixée à la dite base d'attache principale (41), et

la dite base d'attache secondaire (82) est moulée solidairement avec une partie de retenue (49) pour retenir une extrémité d'un moyen de sollicitation (51) qui sollicite le dit élément de verrouillage mobile (43) dans une direction de mouvement vers l'arrière (B).

11. Casque selon la revendication 10, caractérisé en ce que

la dite base d'attache secondaire (82) sert également de dit élément de définition d'intervalle.

12. Casque selon une quelconque des revendications 1 à 11, caractérisé en ce que

des pièces sphériques (106) sont respectivement fixées à l'une et à l'autre parties d'extrémité du dit câble (32),

des parties verticales sensiblement en forme de L (46) sont formées sur les corps principaux d'éléments de maintien (109) des dits premier et deuxième éléments de verrouillage (43) des dits premier et deuxième mécanismes de verrouillage (21), respectivement,

les dits corps principaux d'élément de maintien (109) comportent respectivement des trous sensiblement circulaires (109), et des encoches sensiblement semi-circulaires (107) sont formées dans les parties d'extrémité libre des dites parties verticales (46), et

les dites pièces sphériques (106) sont logées dans les dits trous (108) et les dites encoches (107) de sorte que les dites l'une et l'autre parties d'extrémité du dit câble (32) sont connectées aux dits premier et deuxième éléments de verrouillage mobiles (43) par l'intermédiaire des dites pièces sphériques (106)

13. Casque selon une quelconque des revendications 1 à 12, caractérisé en ce que

le dit casque, comprend des deuxième moyens de sollicitation (85) pour rappeler la dite partie de coque secondaire (6), qui se trouve à la position abaissée, vers le haut par rapport à la dite partie de coque principale (5), afin d'éviter un déverrouillage inutile de la dite partie de coque secondaire (6) bloquée par les dits premier et deuxième mécanismes de verrouillage (21).

14. Casque selon la revendication 13, caractérisé en ce que le dit deuxième moyen de sollicitation est

un ressort hélicoïdal de torsion (85).

15. Casque selon la revendication 14, caractérisé en ce que

le dit ressort hélicoïdal de torsion (85) est attaché à une plaque de support de partie de coque secondaire (81),

la dite plaque de support de partie de coque secondaire (81) est attachée à la dite partie de coque principale (5), et

la dite partie de coque secondaire (6) est attachée à la dite plaque de support de partie de coque secondaire (81) par l'intermédiaire du dit moyen de support axial (7) de façon à pouvoir pivoter sensiblement verticalement par rapport à la dite partie de coque principale (5).

16. Casque selon une quelconque des revendications 1 à 12, caractérisé en ce que

un mécanisme de positionnement (89, 90) est prévu séparément des dits mécanismes de déverrouillage (21) pour empêcher, avec une force d'action relativement petite, la dite partie de coque secondaire (6) de se déplacer vers le haut par rapport à la dite partie de coque principale (5) lorsque la dite partie de coque secondaire (6) est à la position abaissée,

le dit mécanisme de positionnement est constitué par un premier moyen de positionnement (90), prévu sur la dite partie de coque principale (5), et par un deuxième moyen de positionnement (89) prévu sur la dite partie de coque secondaire (6) de manière à s'enclencher avec le dit premier moyen de positionnement (90) par accouplement à évidement - saillie,

un deuxième moyen de sollicitation (85) est en outre prévu pour solliciter la dite partie de coque secondaire (6) vers le haut par rapport à la dite partie de coque principale (5) lorsque la dite partie de coque secondaire (6) est à la position abaissée, et

le dit moyen de sollicitation (85) a une force de sollicitation d'une grandeur telle qu'elle ne peut pas dissocier le dit mécanisme de positionnement (89, 90) enclenché par accouplement à évidement - saillie.

17. Casque selon la revendication 16, caractérisé en ce que le dit deuxième moyen de sollicitation est un ressort hélicoïdal de torsion (85).

18. Casque selon une quelconque des revendications 1 à 17, caractérisé en ce que

le dit élément de déverrouillage (22) se déplace dans la direction de mouvement vers l'avant (A) de manière à former un angle aigu (θ) par rapport à une direction de mouvement vers le bas de la dite partie de coque secondaire (6).

19. Casque selon la revendication 18, **caractérisé en ce que** l'angle aigu (θ) est compris dans une plage de 0 degré à 60 degrés.
20. Casque selon la revendication 18, **caractérisé en ce que** l'angle aigu (θ) est dans une plage de 0 degré à 45 degrés. 5
21. Casque selon la revendication 18, **caractérisé en ce que** 10
la direction de mouvement vers l'avant du dit élément de déverrouillage (22) est vers l'intérieur de la direction de mouvement vers le bas (A) de la dite partie de coque secondaire (6), et
l'angle aigu (θ) est dans une plage de 0 degré 15
à 45 degrés.

20

25

30

35

40

45

50

55

FIG.1

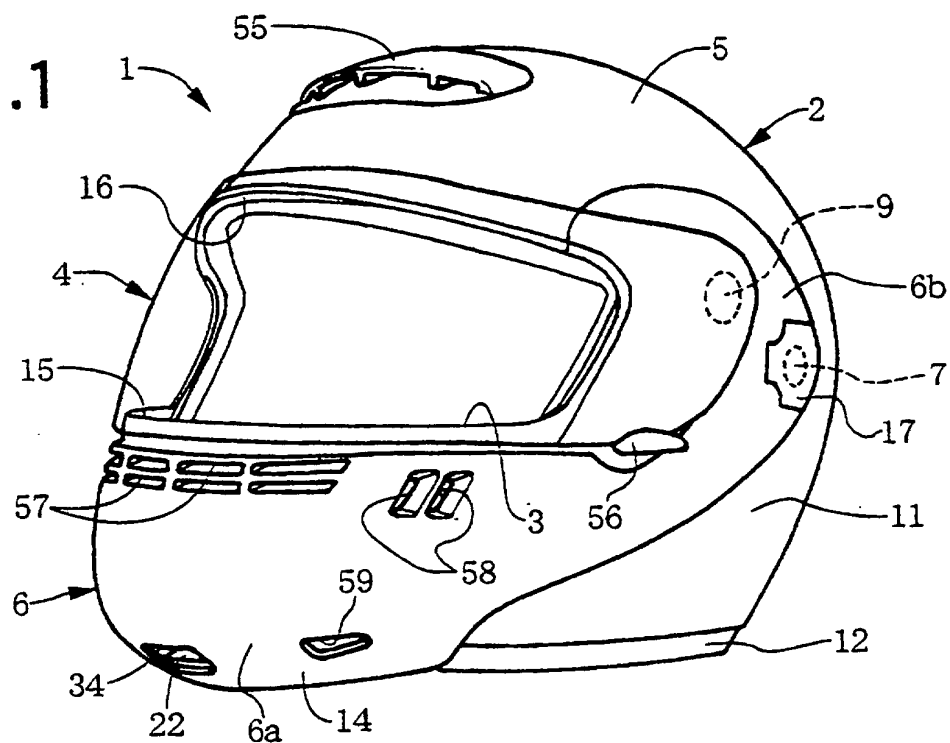
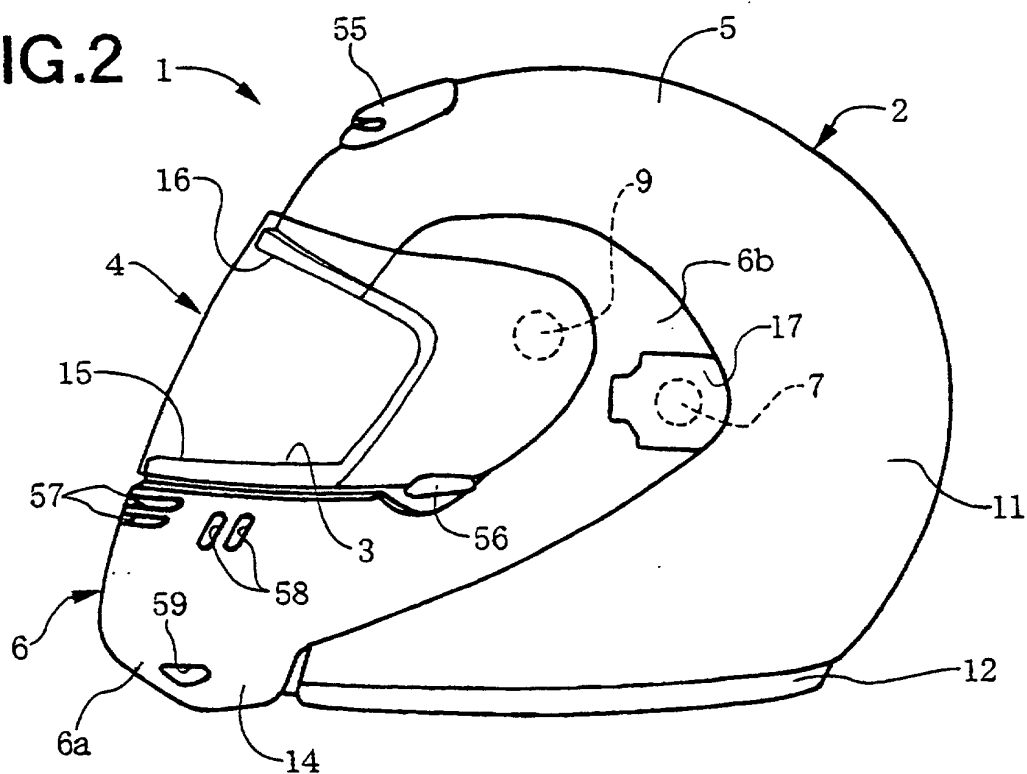

FIG.2



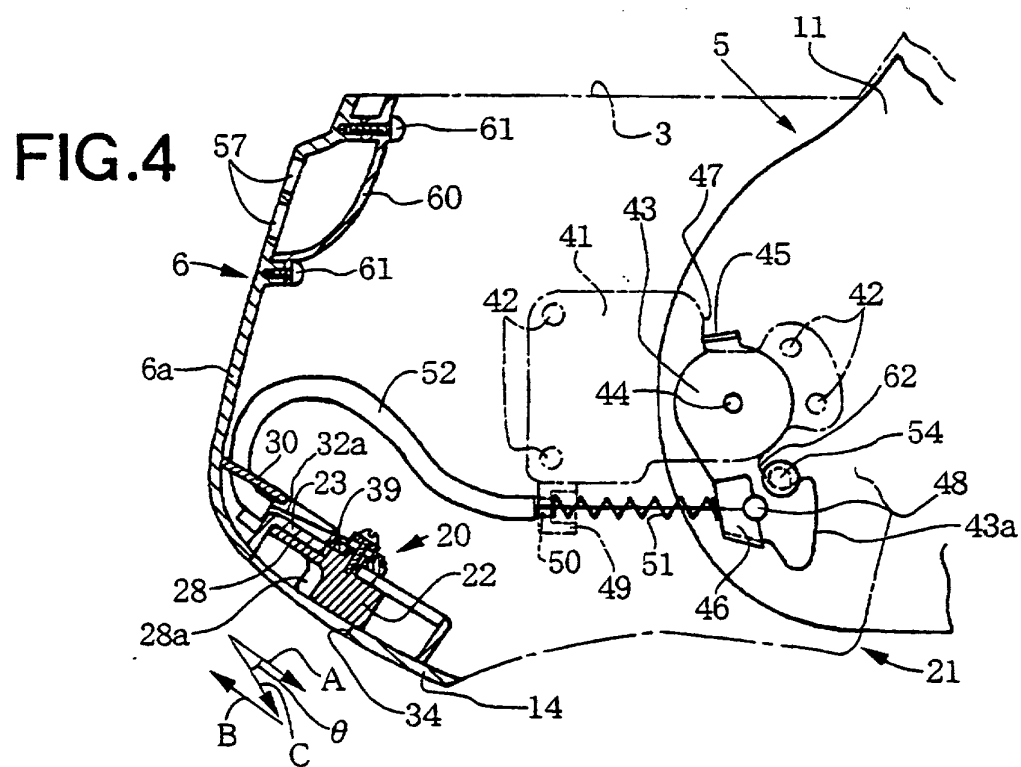
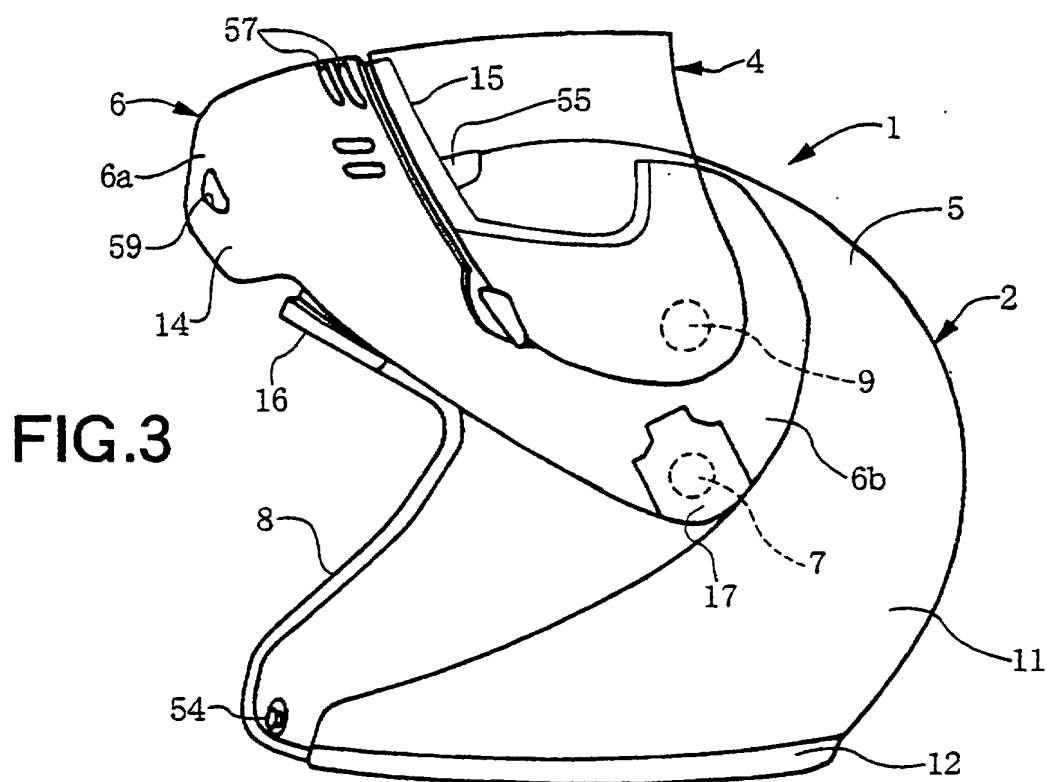

FIG.5

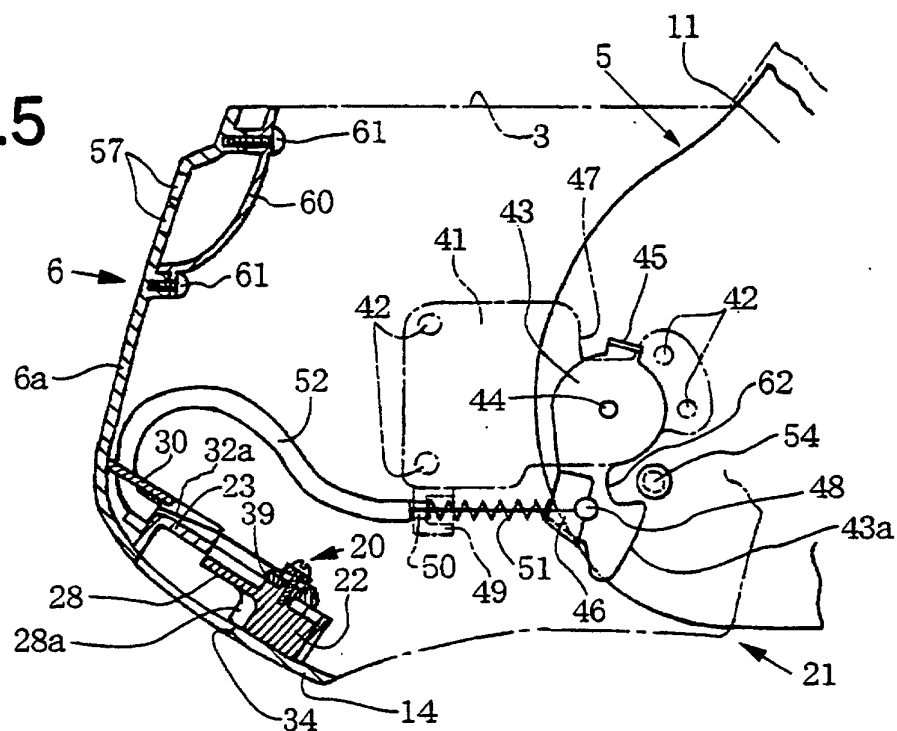

FIG.6

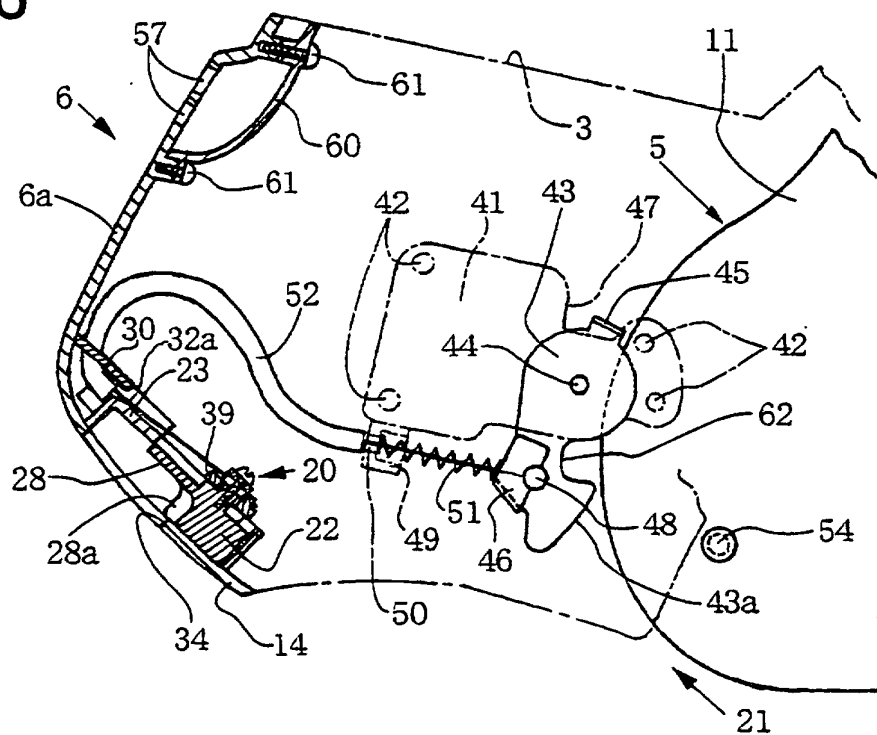

FIG.7

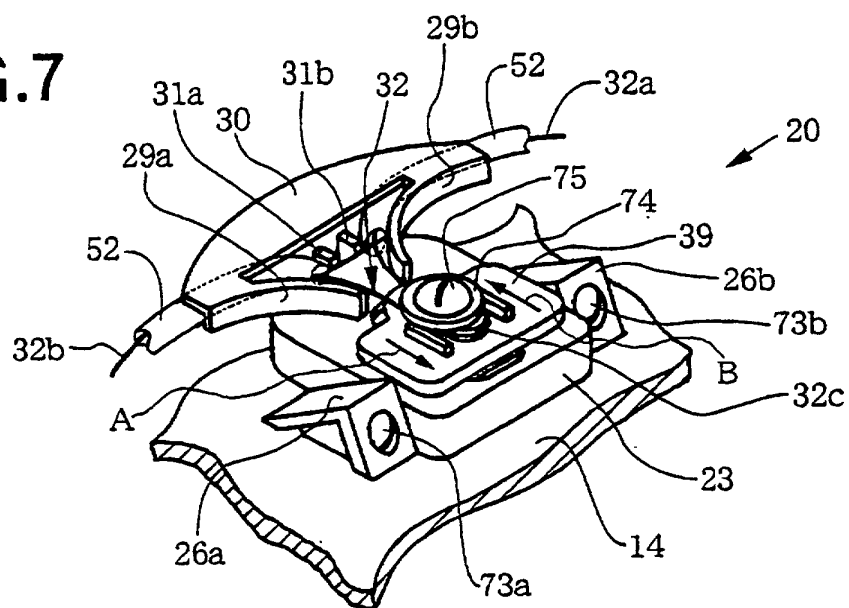

FIG.9

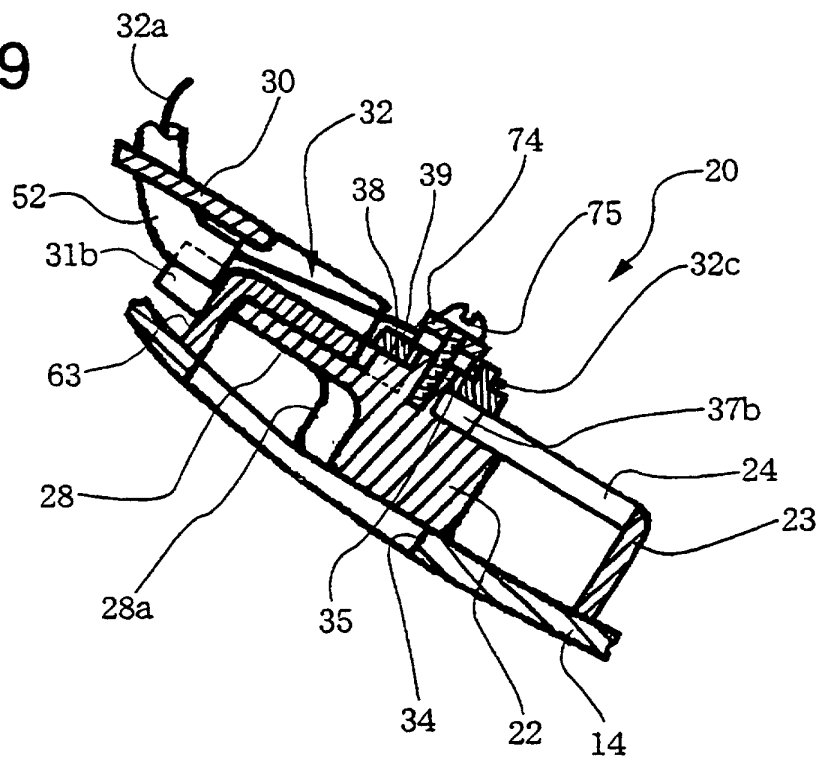

FIG.8

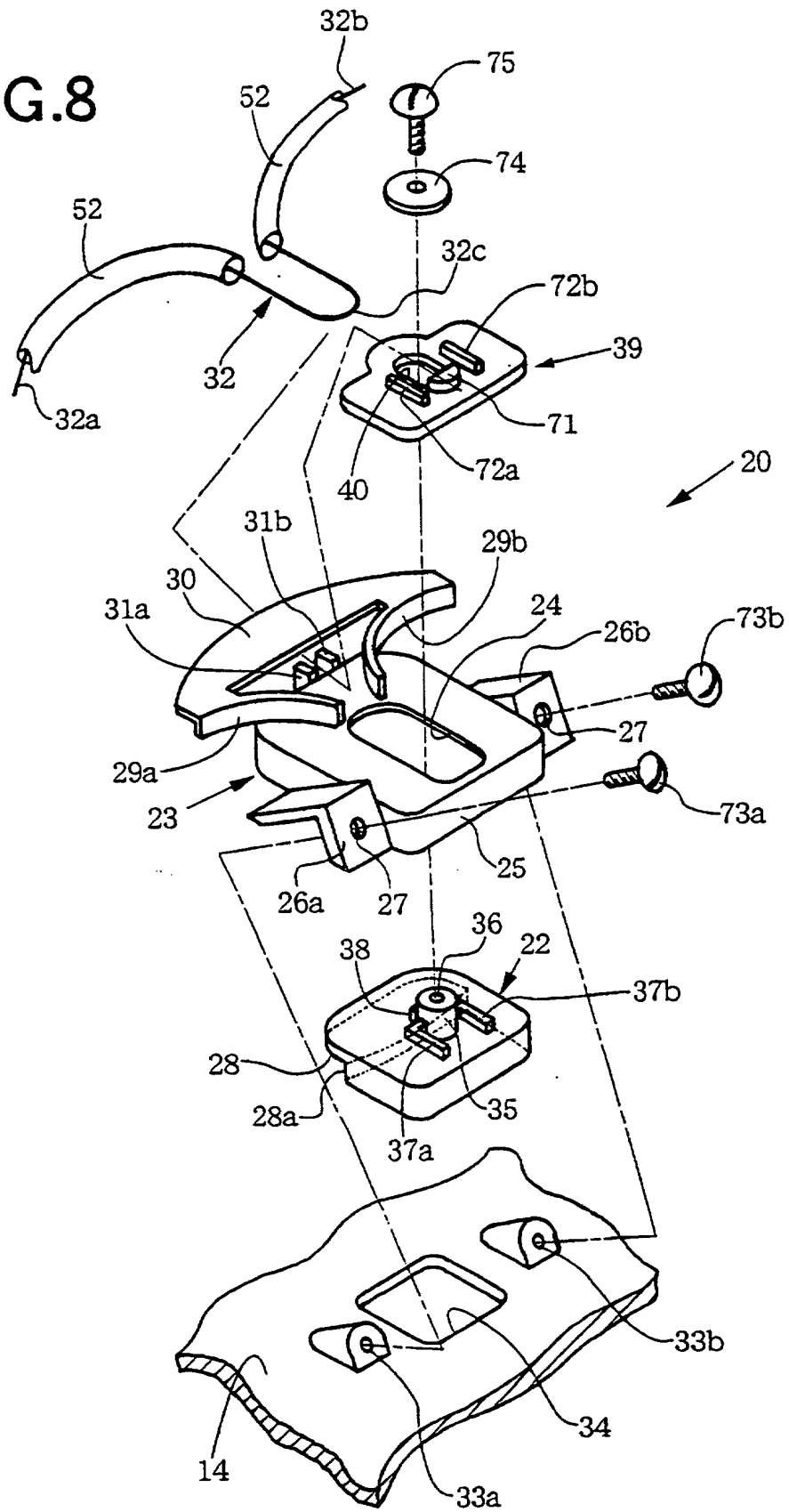

FIG.10

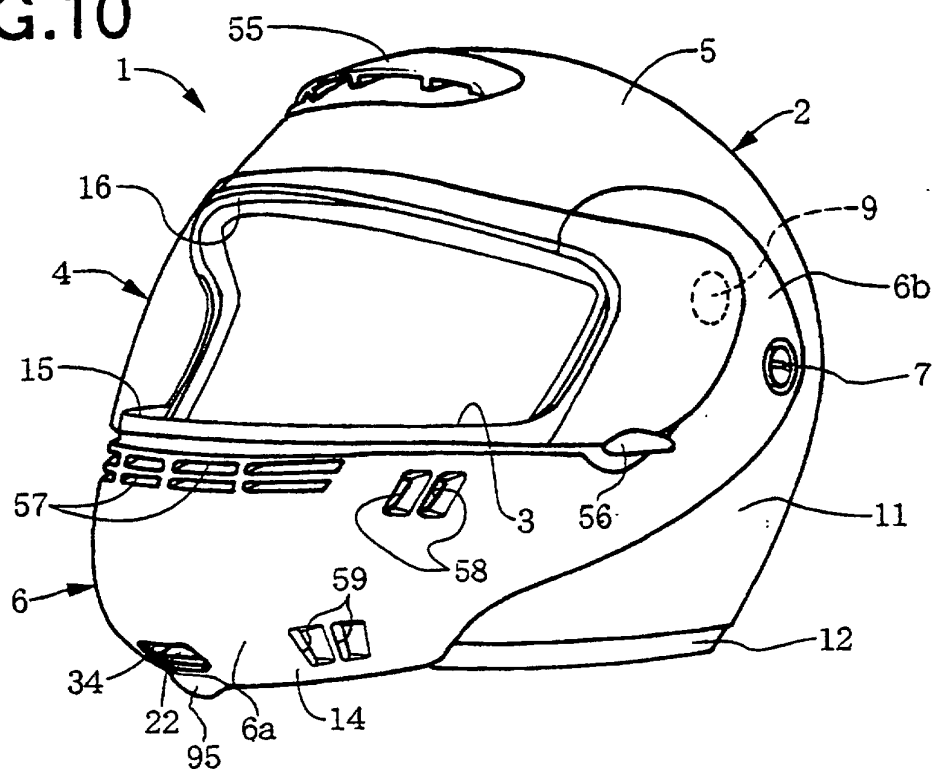

FIG.11

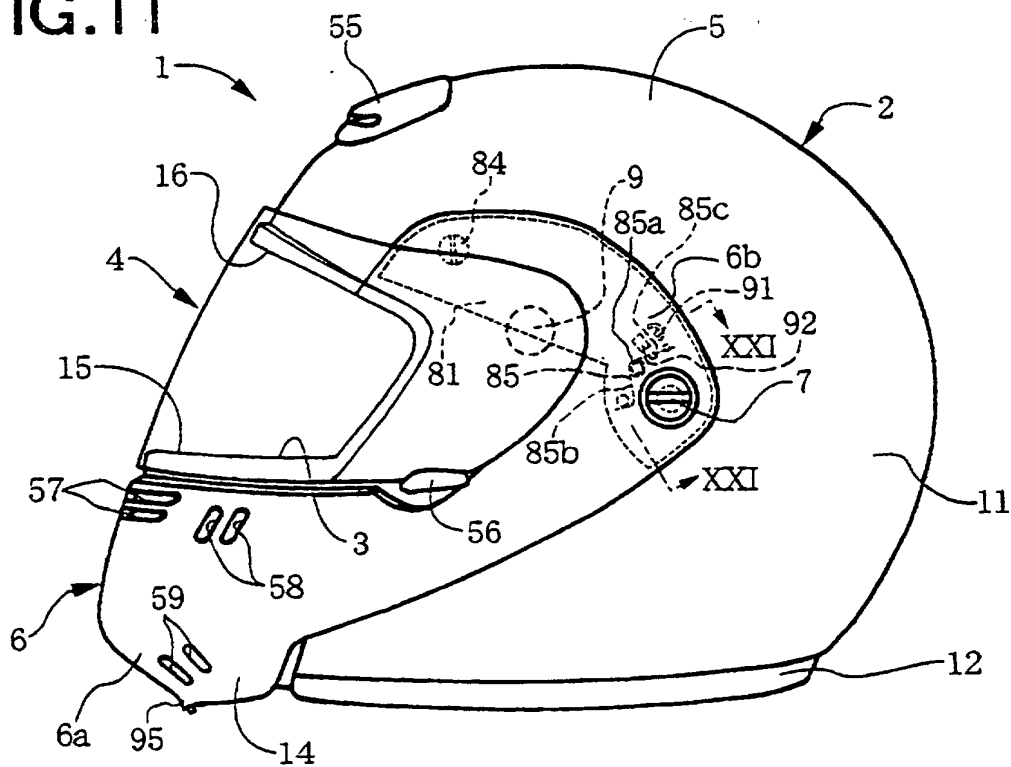

FIG.12

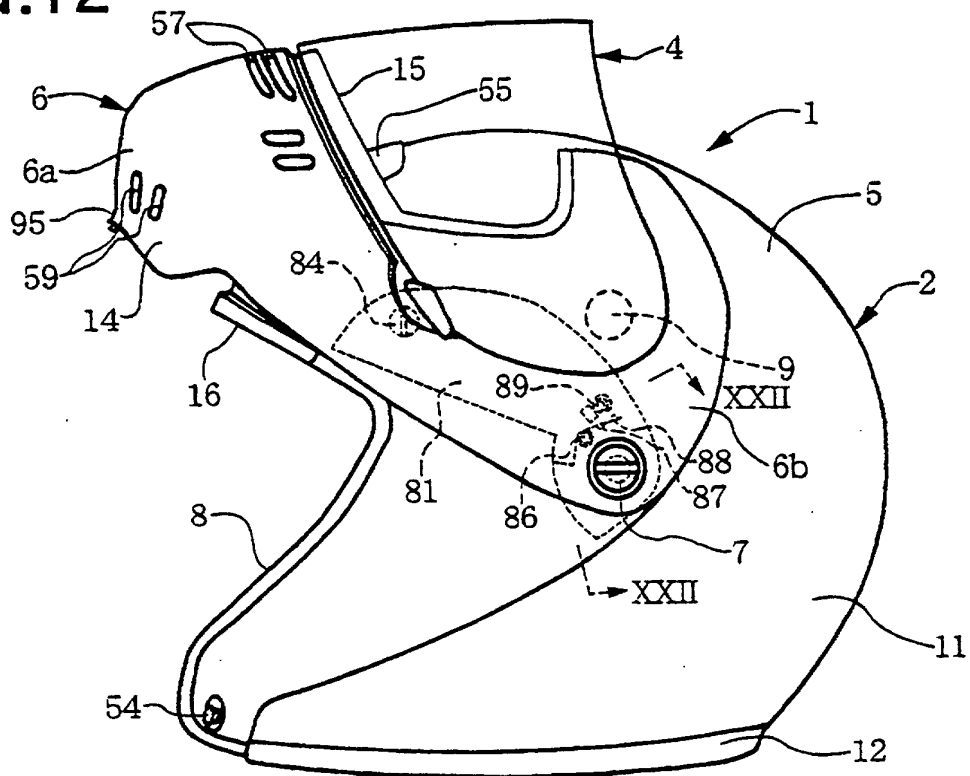

FIG.13

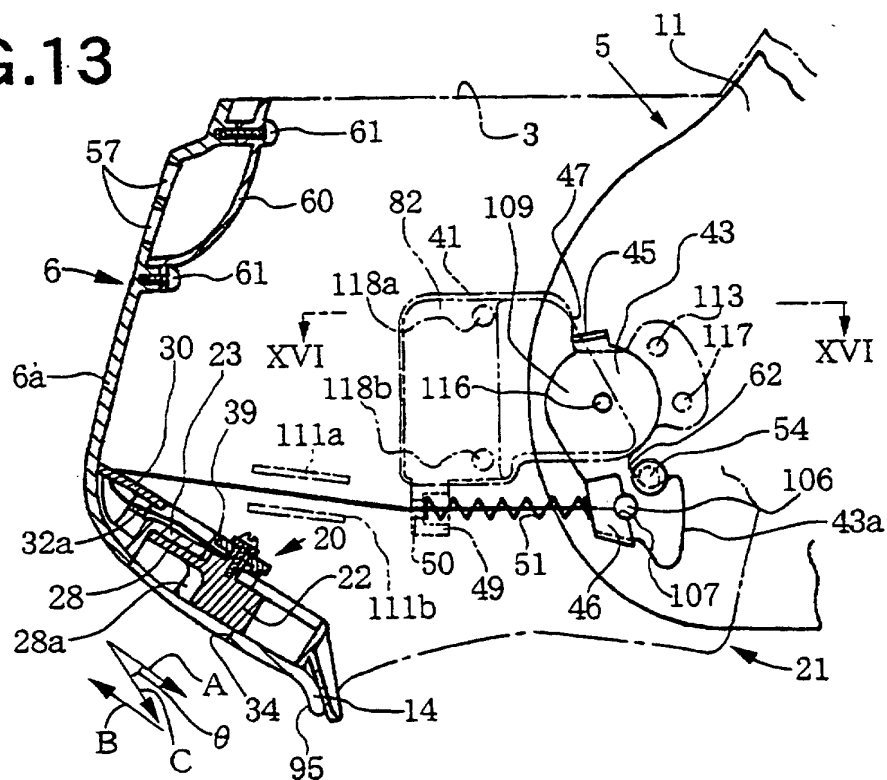

FIG.14

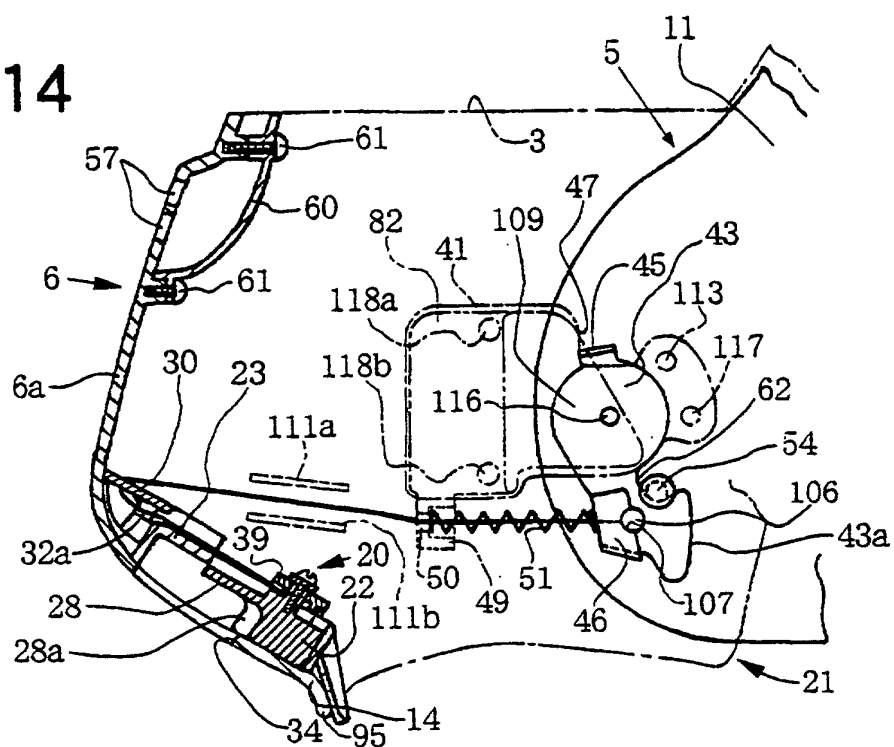

FIG.15

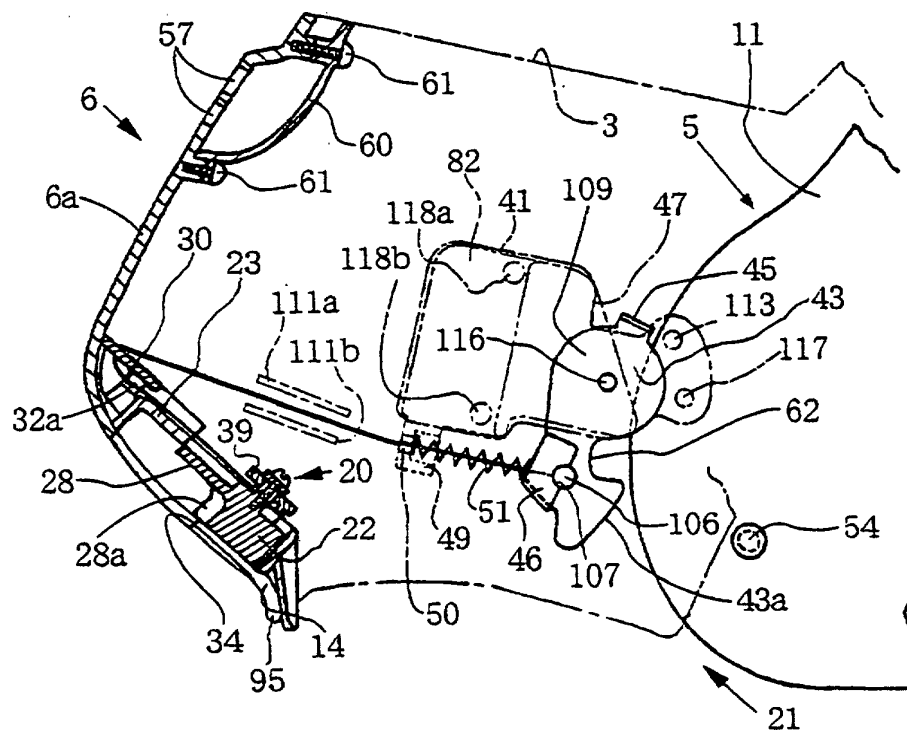

FIG.16

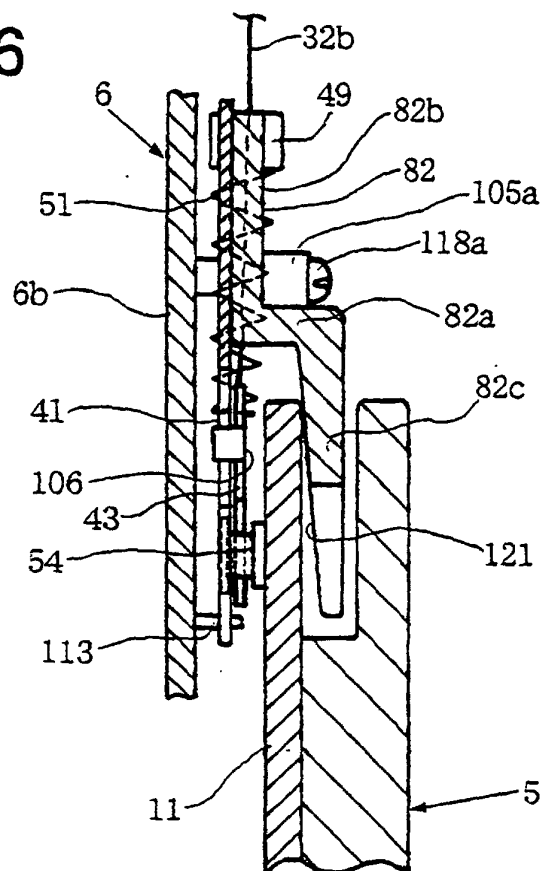

FIG.18

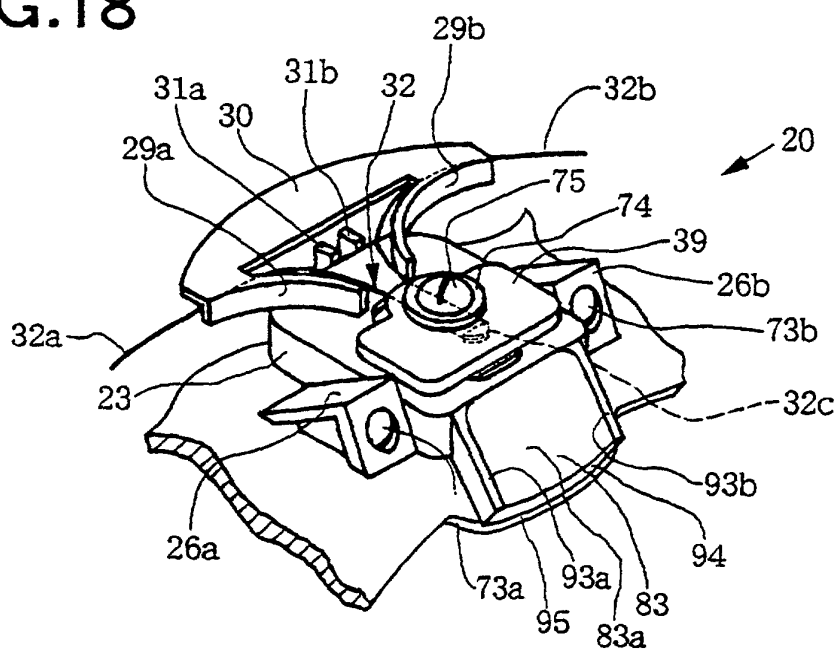

FIG.17

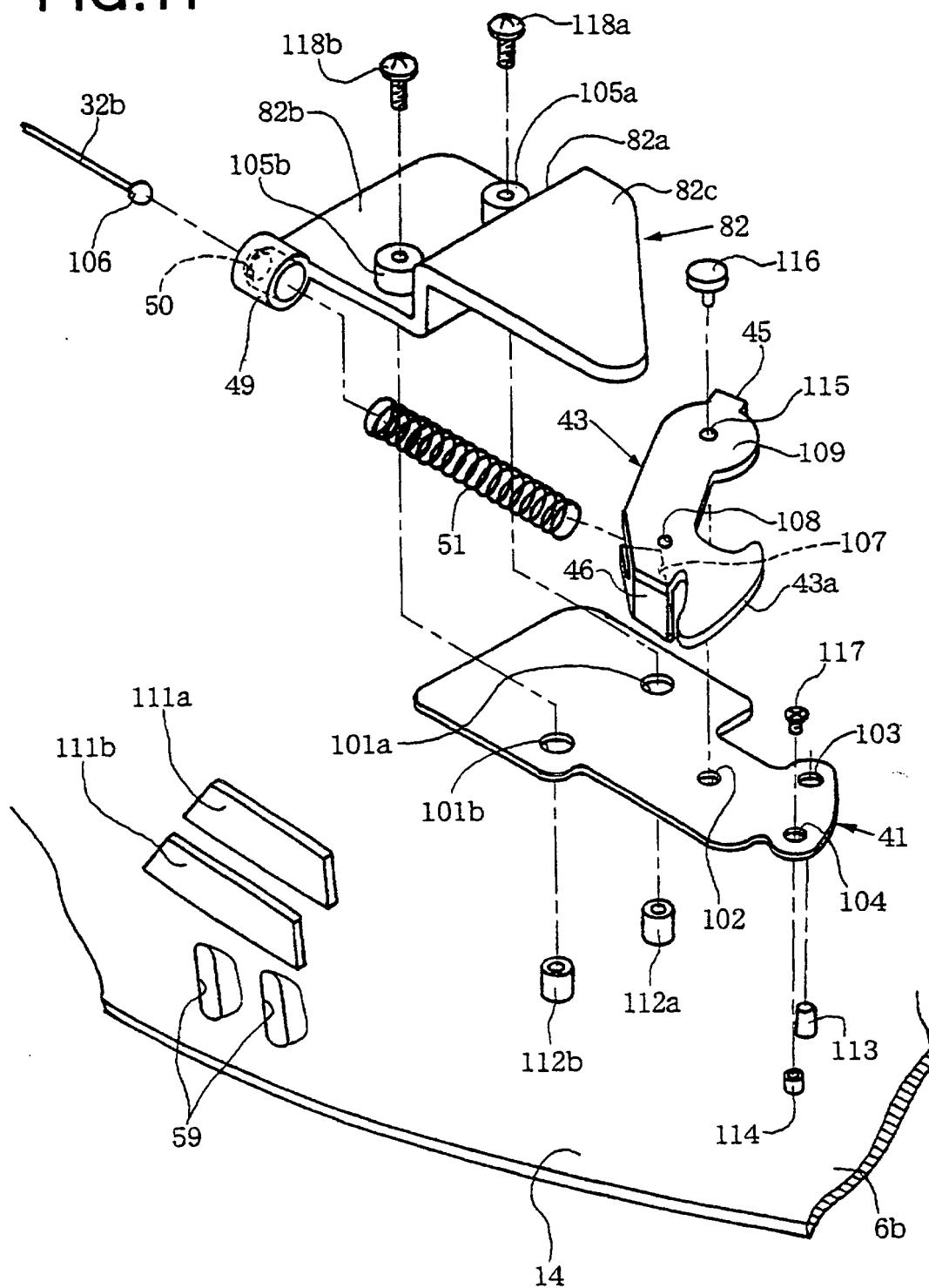

FIG.19

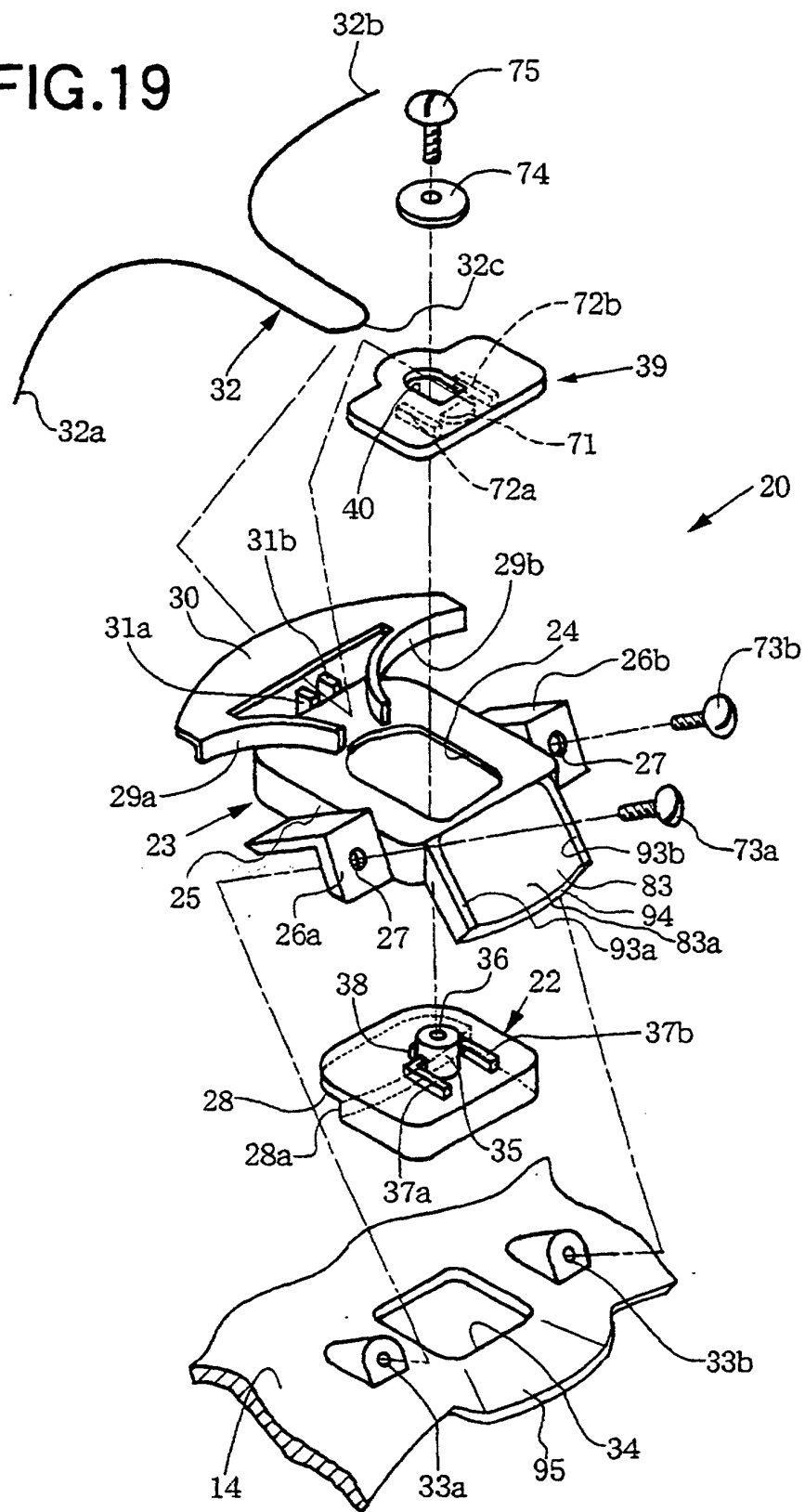

FIG.20

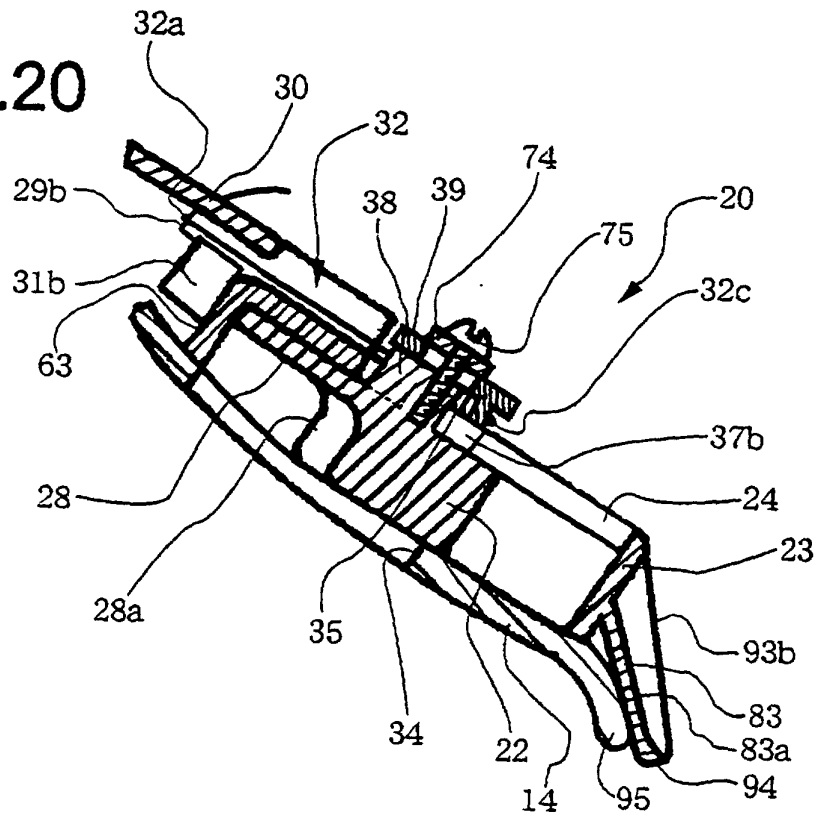

FIG.21

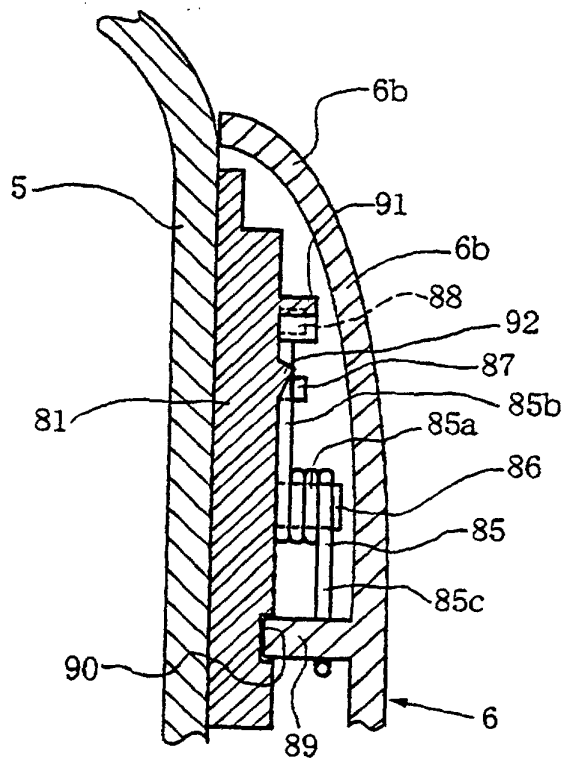

FIG.22

