

(19)



Europäisches Patentamt
European Patent Office
Office européen des brevets



(11)

EP 1 017 079 B1

(12)

EUROPEAN PATENT SPECIFICATION

(45) Date of publication and mention
of the grant of the patent:
22.02.2006 Bulletin 2006/08

(51) Int Cl.:
H01H 83/12 ^(2006.01)

(21) Application number: **99204054.3**

(22) Date of filing: **01.12.1999**

(54) **Auxiliary device for circuit breakers**

Hilfseinrichtung für Leistungsschalter

Dispositif auxiliaire pour disjoncteurs

(84) Designated Contracting States:
**AT BE CH CY DE DK ES FI FR GB GR IE IT LI LU
MC NL PT SE**

(30) Priority: **29.12.1998 IT MI982847**

(43) Date of publication of application:
05.07.2000 Bulletin 2000/27

(73) Proprietor: **ABB Service S.r.l
20124 Milano (IT)**

(72) Inventors:
• **Jacovino, Elio
20052 Monza (MI) (IT)**
• **Redaelli, Claudio
20063 Seveso (MI) (IT)**

(74) Representative: **Giavarini, Francesco et al
ZANOLI & GIAVARINI S.r.l.
Viale Bianca Maria, 35
20122 Milano (IT)**

(56) References cited:
DE-U- 8 703 360

EP 1 017 079 B1

Note: Within nine months from the publication of the mention of the grant of the European patent, any person may give notice to the European Patent Office of opposition to the European patent granted. Notice of opposition shall be filed in a written reasoned statement. It shall not be deemed to have been filed until the opposition fee has been paid. (Art. 99(1) European Patent Convention).

Description

[0001] The present invention relates to an auxiliary actuation device for opening a circuit breaker associated therewith if the supply voltage drops below a preset threshold. More particularly, the present invention relates to an auxiliary device, known in the art as undervoltage relay, which has improved shape and characteristics.

[0002] It is known that magnetothermal or residual-current circuit breakers for low-voltage electrical applications are generally coupled to suitable auxiliary devices. These devices are conventionally of two kinds, respectively an actuating type and an actuated type, depending on whether they act on the circuit breaker and actuate an action thereof or perform an action as a consequence of an actuation received from said circuit breaker.

[0003] A typical example of an actuating auxiliary device is constituted by an undervoltage relay, whose main function is to allow to protect loads which are connected to a power supply line, such as for example electric motors, against supply conditions which are not optimum for their operation. The undervoltage relay is in fact supplied by a voltage which is correlated to the voltage of the line to which the load to be protected is connected. If the value of the line supply voltage drops below a threshold, the relay trips, causing the circuit breaker associated therewith to open and therefore interrupting the supply of power to the load. If this did not occur, the load would operate in non-optimum conditions which might cause malfunctions and even damage to said load.

[0004] As a consequence of the opening determined by the relay, the circuit breaker actuates, by means of appropriate lever systems, a kinematic mechanism inside a device for signaling the state of the circuit breaker associated therewith, which accordingly constitutes an actuated device. In turn, the actuated device provides operators with a signal which corresponds to the current state of the circuit breaker.

[0005] As regards the coupling between the circuit breaker and the auxiliary devices, one of the solutions generally used entails placing all the auxiliary devices on a same side of the circuit breaker relative to a front view of said circuit breaker. In this case, the mechanical connection between the circuit breaker and the auxiliary devices is achieved by using a shaft which is shaped so as to have multiple protrusions and transmits the movements among the various components, according to a solution which is particularly disadvantageous from the point of view of production as well as from the point of view of functionality. The shaft that is used in fact requires accurate machining in order to form the protrusions and the dimensions required to take into account the different stress levels and the considerable clearances involved. This leads to an increase in production costs and possibly to a reduction in the precision and overall reliability of the assembly constituted by the circuit breakers and the auxiliary devices.

[0006] Another solution that is used for coupling the

circuit breaker and the auxiliary devices is to distribute the devices on both sides of the circuit breaker; in particular, relative to a front view of the circuit breaker, the actuating auxiliary devices according to the present invention are always fitted on the same side of the circuit breaker, for example on the left, while the actuated ones are fitted on the other side, on the right.

[0007] This coupling solution is particularly advantageous with respect to the one described earlier both because it considerably facilitates users in practical applications and because it allows to use a shaft with a smaller number of protrusions, which is accordingly simpler and cheaper to machine; moreover, the mechanical stresses that occur are more balanced and clearance is reduced.

[0008] However the drawback of this solution lies in the fact that magnetothermal and residual-current low-voltage circuit breakers have moving contacts which are mechanically mutually different and can be arranged differently inside the circuit breakers according to specific applications and/or to the applicable national standards. For example, with specific reference to a magnetothermal circuit breaker of the two-pole type, the moving contacts comprise phase contacts and neutral contacts which are mechanically different from each other and can be located either on the right side or on the left side of said circuit breaker relative to a front view thereof. Accordingly, since the undervoltage relay is an actuating auxiliary device, it is generally always fitted on the same side of the circuit breaker, for example on the left; in the current state of the art, this leads to the need to produce a plurality of separate series of actuation devices according to the constructive structure of the circuit breaker to which they will be coupled, increasing constructive complexity and production costs. Further, when an actuating auxiliary device is coupled to a circuit breaker, the kinematic mechanisms for opening the contacts of the circuit breaker can be affected negatively by the corresponding kinematic systems of said auxiliary device; in particular, the opening speed of the circuit breaker might be reduced, accordingly leading to malfunctions or even to breakage of said circuit breaker.

[0009] A further drawback is the fact that if the circuit breaker opens, for example due to a drop in the supply voltage below a threshold, in the current state of the art conventional actuating auxiliary devices are not provided with means for local visual indication means which protrude outside the device and allow easy and immediate identification of the tripped circuit breaker; this furthermore prevents resetting the auxiliary device without directly acting on the open circuit breaker.

[0010] The aim of the present invention is to provide an auxiliary device for opening a circuit breaker associated therewith if the supply voltage is lower than a threshold in which the coupling to the residual-current or magnetothermal circuit breaker occurs fully independently of the arrangement of the contacts inside it, with a considerable benefit from the point of view of production.

[0011] Within the scope of this aim, an object of the

present invention is to provide an auxiliary device for opening a circuit breaker associated therewith if the supply voltage is lower than a threshold in which the coupling with the circuit breaker does not affect the kinematic mechanisms of said circuit breaker, accordingly preserving its design characteristics, particularly in terms of contact opening speed in case of triggering due to a fault.

[0012] Another object of the present invention is to provide an auxiliary device for opening a circuit breaker associated therewith if the supply voltage is lower than a threshold in which there is a local visual indication of the open state of the circuit breaker caused by a said supply voltage being lower than a threshold.

[0013] Another object of the present invention is to provide an auxiliary device for opening a circuit breaker associated therewith if the supply voltage is lower than a threshold in which it is possible to reset the auxiliary device without direct intervention on the circuit breaker.

[0014] Another object of the present invention is to provide an auxiliary device for opening a circuit breaker associated therewith if the supply voltage is lower than a threshold which is highly reliable, relatively easy to provide and at competitive costs.

[0015] This aim, these objects and others which will become apparent hereinafter are achieved by an auxiliary device according to claim 1.

[0016] Document DE 87 03 360 U discloses a device according to the preamble of claim 1.

[0017] Further characteristics and advantages of the present invention will become apparent from the following detailed description of preferred but not exclusive embodiments of the auxiliary device according to the invention, illustrated only by way of non-limitative example in the accompanying drawings, wherein:

Figure 1 is a schematic side view of the auxiliary device according to the invention, in a position which corresponds to the position in which the associated circuit breaker is closed;

Figure 2 is a schematic side view of the auxiliary device in a position which corresponds to the position in which the associated circuit breaker is open due to direct intervention of an operator on said circuit breaker;

Figure 3 is a schematic side view of the auxiliary device in a position which corresponds to the position in which the associated circuit breaker is open due to the supply voltage being lower than a threshold;

Figure 4 is a perspective view of a reset and indication lever used in the device according to the invention;

Figure 5 is a perspective view of an engagement lever used in the device according to the invention;

Figure 6 is a perspective view of an actuation lever used in the device according to the invention.

[0018] With reference to the above figures, the device according to the invention comprises an insulating en-

closure 1 inside which there is an electromagnetic element which comprises a fixed magnet 21 whereon a coil 12 is wound and a moving magnet 22 which is pivoted in a point 100 and with which a return spring 28 is associated.

[0019] In normal operating conditions, i.e., when the associated circuit breaker is closed, the coil 12, whose terminals are connected to connection terminals 16, is supplied with electric power by means of a suitable power supply circuit. In particular, the circuit provides a supply voltage which is a function of the voltage of the line in which the device and the circuit breaker associated therewith are inserted. Figures 1 and 2 illustrate a single terminal 16, but the device in actual fact comprises a second connection terminal 16 which is superimposed on the first one.

[0020] This arrangement generates a magnetic field whose intensity allows to contrast the force applied by the return spring 28 on the moving magnet 22 and to keep the latter coupled electromagnetically to the fixed magnet 21 in the position shown in Figure 1.

[0021] In particular, the return force applied by the spring 28 can be adjusted appropriately by means of an adjustment screw 31 which acts directly on said spring 28. This allows to make the device easily suitable to the applicable standards and/or to specific application requirements.

[0022] If the line supply voltage drops below a preset threshold, the intensity of the magnetic field generated by the coil 12 is no longer sufficient to contrast the force applied by the spring 28, which pulls the moving magnet 22 and moves it into the position shown in Figure 3.

[0023] Advantageously, the movement of the moving magnet 22 actuates a suitable kinematic mechanism which opens the circuit breaker in a way described in detail hereinafter.

[0024] The device according to the invention comprises means for coupling to the circuit breaker which comprise a tripping lever 5, a coupling lever 6 and a transmission lever 10 whose function and connections are described hereinafter.

[0025] Actuation means actuated by the moving magnet comprise an actuation lever 9.

[0026] Further, there are means for the local visual indication of the open state of the circuit breaker due to the supply voltage being lower than a threshold; said means comprise a reset and indication lever 7 and an engagement lever 11.

[0027] In particular, the transmission lever 10 is pivoted in a point 101 of the enclosure 1 with which a return spring 23 is associated; the engagement lever 11 is furthermore arranged on the same pivoting point 101, whereas the reset and indication lever 7 is pivoted in a point 103. The transmission lever 10 is detachably connected, by means of a U-shaped element 32, to a kinematic chain, comprising an actuation lever 4, and to the tripping lever 5, both of which are pivoted to a point 102 of the enclosure 1; an actuation spring 26 whose function

will be described in greater detail hereinafter acts on the lever 4.

[0028] As shown in Figure 6, the actuation lever 4 has a pivot 30 which can interact with the surface of a slot 31 of the lever 7 and a groove 33 in which the U-shaped element 32 can slide.

[0029] The tripping lever 5 comprises a pivot 14 for coupling to the tripping mechanism of the circuit breaker and has the particularity of having a toothed sector 2 whose function will be described hereinafter.

[0030] As shown in Figure 4, the reset and indication lever 7 has, in addition to the slot 31, a first raised portion 34, on which a first end of a spring 24 acts, and a second raised portion 35, which interacts against a shaped wall 36 of the engagement lever 11. Said engagement lever 11, shown in detail in Figure 5, furthermore has a pivot 50 on which the second end of the spring 24 acts. In practice, in the position shown in Figure 1, the spring 24 pushes on one side against the raised portion 34, forcing the lever 7 to turn clockwise, and against the pivot 50 at the other side, forcing the lever 11 to turn counterclockwise. Accordingly, the levers 7 and 11 move against each other, facilitating contact between the second raised portion 35 and the shaped wall 36 and remaining engaged in the inactive position shown in Figure 1.

[0031] The device according to the invention comprises the actuation lever 9 which is operatively actuated by the moving magnet; further, the lever 9 is pivoted to a point 100 of the enclosure 1 and is connected to a return spring 28. The lever 9 is composed of two parts: a first part is shaped so as to form a seat 42 for geometric coupling to the moving magnet 22 and a second part protrudes from the first one, two slots 37 and 38 being formed thereon; in particular, the slot 38 has a substantially straight shaped portion 39 for the purpose described hereinafter.

[0032] A wing 40 is further provided on the lever 9 and has a protrusion which is substantially perpendicular to the median plane of the lever 9 and is suitable to interact with the pivot 50 of the lever 11 and with the second raised portion 35.

[0033] Advantageously, the device according to the invention comprises an additional coupling lever 6, pivoted to the point 103, which has a pivot 15 for optional coupling to the kinematic mechanism of the associated circuit breaker, and a toothed sector 3 which is operatively coupled to the toothed sector 2 of the tripping lever 5. In practice, once the kinematic mechanism of the device is actuated, the two toothed sectors 2 and 3 mutually mesh, rotating with respect to each other in opposite directions.

[0034] This constructive solution allows to provide a coupling of the auxiliary device to the circuit breaker which is fully independent of the arrangement of the contacts inside it. If the position of the poles in the circuit breaker changes, the coupling between the auxiliary device and the circuit breaker can in fact be provided either on the pivot 14 or on the pivot 15. Furthermore, the change in the direction of rotation of the mechanism of

the circuit breaker according to the arrangement of the poles is rendered irrelevant in terms of the functionality of the coupling between the circuit breaker and the device by the presence of the two contrarotating toothed sectors 2 and 3.

[0035] The fact should be noted that with this solution the movement of the kinematic system inside the device does not affect at all the corresponding movement in the circuit breaker, since the pivot 15 can move without hindrance inside the slot 38; accordingly, if the circuit breaker trips due to a fault, the performance of the circuit breaker in terms of opening speed are not altered in any way.

[0036] A further innovative aspect of the actuation device according to the invention is provided by the fact that the lever 7 has a shaped protrusion 60 which, when the circuit breaker opens because the supply voltage is below a preset threshold, protrudes from a corresponding opening 61 formed in the enclosure 1 and therefore allows local visual indication of the tripping of the associated circuit breaker due to the supply voltage being lower than a given threshold. Furthermore, once the protrusion 60 has protruded from the enclosure, it directly provides a button on which an operator can, for any requirement, act directly to reset the auxiliary device without having to act on the associated circuit breaker, which accordingly remains open. The lever 7 therefore simultaneously provides local indication of an open circuit breaker and resetting of said auxiliary device. In further embodiments, not illustrated by figures, said protrusion might be associated with other levers of the kinematic mechanism of the device.

[0037] The operation of the device according to the invention is now described starting from the operating condition shown in Figure 1, which corresponds to a position in which the associated circuit breaker is closed.

[0038] When the circuit breaker is opened due to manual intervention of an operator who acts directly on the actuation knob, the mechanism of the circuit breaker transmits the motion to the transmission lever 10, which turns in the direction indicated by the arrow 105, pulling the U-shaped element 32 and reaching, at the end of its motion, the position shown in Figure 2.

[0039] The lever 4, under the action of the U-shaped element 32, rotates about its own pivoting axis 102, in the direction indicated by the arrow 106, and reaches the position shown in Figure 2.

[0040] At the same time, the levers 5 and 6 also rotate in mutually opposite directions, facilitating the meshing of the two toothed sectors 2 and 3.

[0041] The remaining part of the mechanism is substantially not affected by the movement, since the coil 12 continues to be supplied correctly.

[0042] When the mains supply voltage drops below a preset value, the supply voltage of the coil 12 also decreases correspondingly; accordingly, when the supply voltage of the coil 12 drops below a preset threshold value, the return force of the spring 28 is no longer effectively contrasted by the magnetic field generated by the coil 12

and causes the separation of the moving magnet 22 from the fixed magnet 21. By means of this rotation, the shaped portion 39 of the slot 38 pushes against the pivot 15 of the lever 6, forcing it to rotate in the direction indicated by the arrow 107. The toothed sector 3 meshes with the toothed sector 2 of the lever 5, causing the movement of the pivot 14 in the direction indicated by the arrow 108; in this manner, the circuit breaker receives motion either directly by means of the pivot 15 or indirectly from the lever 5 by means of the pivot 14 and the meshing of the two toothed sectors 2 and 3; furthermore, by virtue of this rotation the tripping lever 5 disengages the U-shaped element 32, which becomes able to slide freely in the groove 33 of the lever 4.

[0043] Advantageously, the actuation lever 4, no longer locked by the U-shaped element 32, rotates under the action of the thrust of the spring 26 in the direction indicated by the arrow 106 and simultaneously facilitates a faster rotation of the lever 5. This simultaneous rotation is achieved by means of a spring, not shown, which is interposed between the levers 4 and 5 and couples their movement; said spring is conveniently inserted in a seat 80 of the lever 4.

[0044] Therefore, in this situation the potential energy accumulated earlier by the spring 26 is utilized; once said energy has been released, it provides the force required to ensure the prompt movement of the mechanism and the consequent correct intervention of the circuit breaker.

[0045] Furthermore, during rotation the wing 40 of the lever 9 interacts with the pivot 50, pushing it toward the inside of the device and disengaging the shaped wall 36 from the engagement with the second raised portion 35. In this manner, the lever 7, pushed by the action of the spring 24 on the raised portion 34, rotates about the pivoting axis 103 and the shaped protrusion 60 protrudes from the enclosure 1 through an opening 61, providing a local visual indication that the circuit breaker has tripped because the voltage was lower than the preset threshold. At the end of the actuation, the transmission lever 10, following the movement of the associated circuit breaker, reaches the position shown in Figure 3, in which the U-shaped element 32 re-engages the levers 4 and 5.

[0046] In this condition, an operator can therefore reset the auxiliary device simply by acting on the protrusion 60; by pushing the protrusion 60, the second raised portion 35 in fact pushes against the wing 40 of the lever 9 until it reaches a position which is suitable for re-engagement with the shaped wall 36; this re-engagement is facilitated by the thrust applied by the spring 24, which acts on a raised portion 70 of said lever 11. The thrust applied on the wing 40 of the lever 9 furthermore facilitates the movement of the moving magnet 22 toward the fixed one 21 and therefore the reduction of the existing gap. This provides the advantage of being able to optimize the dimensions of the electromagnetic part (moving magnet 22, fixed magnet 21 and coil 12), consequently providing savings in terms of materials, dimensions and costs.

[0047] In such conditions, if the line supply voltage is

still below the preset threshold, the device trips again as described above and prevents the closure of the circuit breaker and the restore of the power supply of the load that it protects.

[0048] The device can also be reset by acting on the control knob of the circuit breaker. In this case, the movement is transmitted from the circuit breaker to the transmission lever 10 which pushes the lever 4 by means of the U-shaped element 32; the pivot 30, during the movement of the lever 4, acts against the surface of the slot 31 of the lever 7 and pulls it downward, causing it to rotate. By means of this rotation, the second raised portion 35 couples to the shaped wall 36 and pushes downward the protrusion 40, as described earlier. In this case also, if the supply voltage is still below the threshold value, the device causes the circuit breaker to reopen.

[0049] In practice it has been observed that the auxiliary actuation device according to the invention fully achieves the intended aim, since it allows to provide a coupling with the circuit breaker independently of the mechanical structure of the circuit breaker and of the arrangement of the contacts inside it without affecting its performance in any way; furthermore, by means of the adoption of the particular constructive refinements described above, it is possible to locally and directly identify the opening of the circuit breaker, with consequent reset of said device.

[0050] The fact should also be noted that all the innovative functions and the inventive aspects of the device can be achieved by using commonly commercially available elements and materials with extremely modest costs.

[0051] The auxiliary device thus conceived is susceptible of numerous modifications and variations, all of which are within the scope of the inventive concept, as defined in the claims.

Claims

1. An auxiliary device for opening a circuit breaker associated therewith if the supply voltage is lower than a threshold, comprising an insulating enclosure which contains a fixed magnet (21) on which a coil (12) is wound, a moving magnet (22) and connecting terminals, comprising :

- actuation means (9) which are operatively connected to and actuated by the moving magnet;
- kinematic chain operatively connected to said actuation means ;
- means (7,11) for coupling to the circuit breaker which are operatively connected to said kinematic actuation means;
- means for the local visual indication of the open state of the circuit breaker due to the supply voltage being lower than a threshold, **characterized in that**

said means for coupling to the circuit breaker comprise two levers, respectively a tripping lever (5) and a coupling lever (6), which are operatively connected to each other, each lever comprising a pivot for coupling to the circuit breaker, and **in that** the coupling and tripping levers are mutually operatively connected by means of two toothed sectors which are associated with said levers and mutually mesh, rotating with respect to each other in mutually opposite directions.

2. The auxiliary device according to claim 1, **characterized in that** said means for coupling to the circuit breaker comprise a transmission lever which is operatively connected to the circuit breaker and with which a return spring is associated.
3. The auxiliary device according to claim 1, **characterized in that** said actuation means actuated by the moving magnet comprise an actuation lever with which a return spring is associated, said actuation lever having a seat for geometric coupling to the moving magnet, and a slot provided with a substantially straight portion which can interact with the pivot of the coupling lever.
4. The auxiliary device according to claim 3, **characterized in that** it comprises an adjustment screw which is suitable to adjust the force applied by the return spring to the actuation lever.
5. The auxiliary device according to claim 1, **characterized in that** said kinematic actuation means comprise an actuation lever provided with a groove in which a U-shaped element slides, said element being suitable to detachably connect said actuation lever and the tripping lever to the transmission lever.
6. The auxiliary device according to claim 5, **characterized in that** a first spring and a second spring are associated with said actuation lever, said first spring being suitable to supply an amount of energy required to open the circuit breaker, said second spring being inserted in a seat of the actuation lever and being suitable to operatively couple the tripping lever and said actuation lever.
7. The auxiliary device according to claim 1, **characterized in that** said means for the local visual indication of the open state of the circuit breaker due to said supply voltage being lower than a threshold comprise a reset and indication lever and an engagement lever, respectively provided with a pawl and with a shaped wall which can be geometrically coupled to each other, said pawl being able to interact with a wing formed on the surface of the actuation lever of said actuation means.

8. The auxiliary device according to claim 7, **characterized in that** the reset and indication lever has a protrusion which can protrude from an opening of the enclosure following the opening of the circuit breaker caused by the supply voltage being lower than a threshold.
9. The auxiliary device according to claim 7, **characterized in that** said reset and indication lever has a raised portion, on which a first end of a spring acts, and a slot which is suitable to interact with a pivot formed on the surface of the actuation lever.
10. The auxiliary device according to claim 9, **characterized in that** the engagement lever has a pivot and a seat which are suitable to interact with the second end of said spring, said wing furthermore acting on the pivot of said engagement lever.

Patentansprüche

1. Eine Hilfsvorrichtung zur Öffnung eines ihr zugeordneten Leistungsschalters falls die Versorgungsspannung niedriger ist als ein Schwellenwert, aufweisend ein isolierendes Gehäuse, welches einen festen Magneten (21) enthält, auf welchem eine Spule (12) aufgewickelt ist, einen beweglichen Magneten (22) und Verbindungsklemmen, aufweisend:
 - Betätigungsmittel (9), welche betreibbar verbunden sind mit und betätigt werden durch den beweglichen Magneten;
 - eine kinematische Kette, betreibbar verbunden mit den Betätigungsmitteln;
 - Mittel (7, 11) zur Kopplung an den Leistungsschalter, welche betreibbar mit den kinematischen Betätigungsmitteln verbunden sind;
 - Mittel zur lokalen visuellen Anzeige des Offen Zustandes des Leistungsschalters, weil die Versorgungsspannung geringer ist als ein Schwellenwert, **dadurch gekennzeichnet, dass** die Mittel zur Kopplung an den Leistungsschalter zwei Hebel aufweisen, jeweils einen Auslösehebel (5) und einen Kopplungshebel (6), welche betreibbar miteinander verbunden sind, wobei jeder Hebel ein Drehgelenk zur Kopplung mit dem Leistungsschalter aufweist, und **dadurch, dass** die Kopplungs- und Auslösehebel miteinander betreibbar verbunden sind mittels zwei gezahnten Abschnitten, welche den Hebeln zugeordnet sind und sich miteinander verzahnen, wobei sie sich im Bezug aufeinander in zueinander entgegengesetzte Richtungen drehen.
2. Die Hilfsvorrichtung gemäß Anspruch 1, **dadurch gekennzeichnet, dass** die Mittel zur Kopplung an

den Leistungsschalter einen Übertragungshebel aufweisen, welcher betreibbar mit dem Leistungsschalter verbunden ist und dem eine Rückholfeder zugeordnet ist.

3. Die Hilfsvorrichtung gemäß Anspruch 1, **dadurch gekennzeichnet, dass** die Betätigungsmittel, die durch den Magneten betätigt werden, einen Betätigungshebel aufweisen, dem eine Rückholfeder zugeordnet ist, wobei der Betätigungshebel einen Sitz zur geometrischen Koppelung an den beweglichen Magneten hat, und einen Schlitz, der mit einem im Wesentlichen geraden Teil ausgestattet ist, der mit dem Drehgelenk des Kopplungshebels wechselwirken kann.
4. Die Hilfsvorrichtung gemäß Anspruch 3, **dadurch gekennzeichnet, dass** sie eine Justageschraube aufweist, welche geeignet ist, die Kraft zu justieren, die durch die Rückholfeder auf den Betätigungshebel ausgeübt wird.
5. Die Hilfsvorrichtung gemäß Anspruch 1, **dadurch gekennzeichnet, dass** das kinematische Betätigungsmittel einen Betätigungshebel aufweist, der mit einer Rille ausgestattet ist, in welcher ein U-förmiges Element gleitet, wobei das Element geeignet ist, lösbar den Betätigungshebel und den Auslösehebel mit dem Übertragungshebel zu koppeln.
6. Die Hilfsvorrichtung gemäß Anspruch 5, **dadurch gekennzeichnet, dass** eine erste Feder und eine zweite Feder dem Betätigungshebel zugeordnet sind, wobei die erste Feder geeignet ist, eine Menge von Energie bereitzustellen, die benötigt wird, um den Leistungsschalter zu öffnen, wobei die zweite Feder in einen Sitz des Betätigungshebels eingefügt ist und dazu geeignet ist, betreibbar den Auslösehebel mit dem Betätigungshebel zu koppeln.
7. Die Hilfsvorrichtung gemäß Anspruch 1, **dadurch gekennzeichnet, dass** die Mittel zur lokalen visuellen Anzeige des Offenzustands des Leistungsschalters, weil die Versorgungsspannung niedriger ist als ein Schwellenwert, einen Rücksetz- und Anzeighebel und einen Erfassungshebel aufweisen, welche jeweils mit einer Klinke ausgestattet sind und mit einer geformten Wand, welche geometrisch miteinander gekoppelt werden können, wobei die Klinke dazu in der Lage ist, mit einem Flügel wechselzuwirken, der auf der Oberfläche des Betätigungshebels des Betätigungsmittels gebildet wird.
8. Die Hilfsvorrichtung gemäß Anspruch 7, **dadurch gekennzeichnet, dass** der Rücksetz- und Anzeighebel einen Vorsprung hat, welcher aus einer Öffnung des Gehäuses vorspringen kann als Folge der Öffnung des Leistungsschalters, die **dadurch** be-

wirkt wird, dass die Versorgungsspannung niedriger ist als ein Schwellenwert.

9. Die Hilfsvorrichtung gemäß Anspruch 7, **dadurch gekennzeichnet, dass** der Rücksetz- und Anzeighebel einen ansteigenden Teil hat, auf welchen ein erstes Ende einer Feder einwirkt, und einen Schlitz, welcher geeignet ist, mit einem Drehgelenk wechselzuwirken, das auf der Oberfläche des Betätigungshebels gebildet wird.
10. Die Hilfsvorrichtung gemäß Anspruch 9, **dadurch gekennzeichnet, dass** der Erfassungshebel ein Drehgelenk hat und einen Sitz, welche geeignet sind, mit dem zweiten Ende der Feder zusammenzuwirken, wobei der Flügel ferner auf das Drehgelenk des Erfassungshebels wirkt.

Revendications

1. Dispositif auxiliaire pour ouvrir un disjoncteur qui lui est associé si la tension d'alimentation est inférieure à un seuil, comprenant une enveloppe de protection électrique isolante qui contient un aimant stationnaire (21) sur lequel une bobine (12) est enroulée, un aimant mobile (22) et des terminaux de connexion, comprenant :

- des moyens d'actionnement (9) qui sont connectés de manière fonctionnelle à et qui sont actionnés par l'aimant mobile ;
- une chaîne cinématique connectée de manière fonctionnelle auxdits moyens d'actionnement ;
- des moyens (7, 11) pour le couplage au disjoncteur qui sont connectés de manière fonctionnelle audit moyen d'actionnement cinématique ;
- des moyens pour l'indication visuelle locale de l'état ouvert du disjoncteur dû au fait que la tension d'alimentation est inférieure à un seuil, **caractérisé en ce que** lesdits moyens pour le couplage au disjoncteur comprennent deux leviers, respectivement un levier de disjonction (5) et un levier de couplage (6) qui sont connectés de manière fonctionnelle l'un à l'autre, chaque levier comprenant un pivot pour le couplage au disjoncteur, et **en ce que** les leviers de couplage et de disjonction sont connectés mutuellement de manière fonctionnelle au moyen de deux secteurs dentés qui sont associés auxdits leviers et s'engrènent mutuellement, effectuant des rotations l'un par rapport à l'autre dans des directions mutuellement opposées.

2. Dispositif auxiliaire selon la revendication 1, **caractérisé en ce que** lesdits moyens pour le couplage

- au disjoncteur comprennent un levier de transmission qui est connecté de manière fonctionnelle au disjoncteur et auquel un ressort de rappel est associé.
3. Dispositif auxiliaire selon la revendication 1, **caractérisé en ce que** lesdits moyens d'actionnement actionnés par l'aimant mobile comprennent un levier d'actionnement auquel un ressort de rappel est associé, ledit levier d'actionnement ayant un support pour un couplage géométrique à l'aimant mobile, et une fente dotée d'une partie sensiblement linéaire qui peut interagir avec le pivot du levier de couplage. 5
 4. Dispositif auxiliaire selon la revendication 3, **caractérisé en ce qu'il** comprend une vis de réglage qui est appropriée pour ajuster la force appliquée par le ressort de rappel au levier d'actionnement. 10
 5. Dispositif auxiliaire selon la revendication 1, **caractérisé en ce que** lesdits moyens d'actionnement cinématique comprennent un levier d'actionnement doté d'une rainure dans laquelle un élément en forme de U glisse, ledit élément étant approprié pour connecter de manière détachable ledit levier d'actionnement et le levier de disjonction au levier de transmission. 15
 6. Dispositif auxiliaire selon la revendication 5, **caractérisé en ce qu'un** premier ressort et un second ressort sont associés audit levier d'actionnement, ledit premier ressort étant approprié pour alimenter une quantité d'énergie nécessaire pour ouvrir le disjoncteur, ledit second ressort étant inséré dans un support du levier d'actionnement et étant approprié pour coupler de manière fonctionnelle le levier de disjonction et ledit levier d'actionnement. 20
 7. Dispositif auxiliaire selon la revendication 1, **caractérisé en ce que** lesdits moyens pour l'indication visuelle locale de l'état ouvert du disjoncteur à cause de ladite tension d'alimentation qui est inférieure à un seuil comprennent un levier de réarmement d'indication et un levier d'accouplement, dotés respectivement d'un loquet et d'une paroi façonnée qui peuvent être géométriquement couplés l'un à l'autre, ledit loquet étant capable d'interagir avec un bras formé sur la surface du levier d'actionnement desdits moyens d'actionnement. 25
 8. Dispositif auxiliaire selon la revendication 7, **caractérisé en ce que** le levier de réarmement et d'indication a une protubérance qui peut faire saillie depuis une ouverture de l'enveloppe de protection électrique à la suite de l'ouverture du disjoncteur provoquée par le fait que la tension d'alimentation est inférieure à un seuil. 30
 9. Dispositif auxiliaire selon la revendication 7, **caractérisé en ce que** ledit levier de réarmement et d'indication a une partie surélevée, sur laquelle une première extrémité d'un ressort agit, et une fente qui est appropriée pour interagir avec un pivot formé sur la surface du levier d'actionnement. 35
 10. Dispositif auxiliaire selon la revendication 9, **caractérisé en ce que** le levier d'actionnement a un pivot et un support qui sont appropriés pour interagir avec la seconde extrémité dudit ressort, ledit bras agissant en outre sur le pivot dudit levier d'accouplement. 40

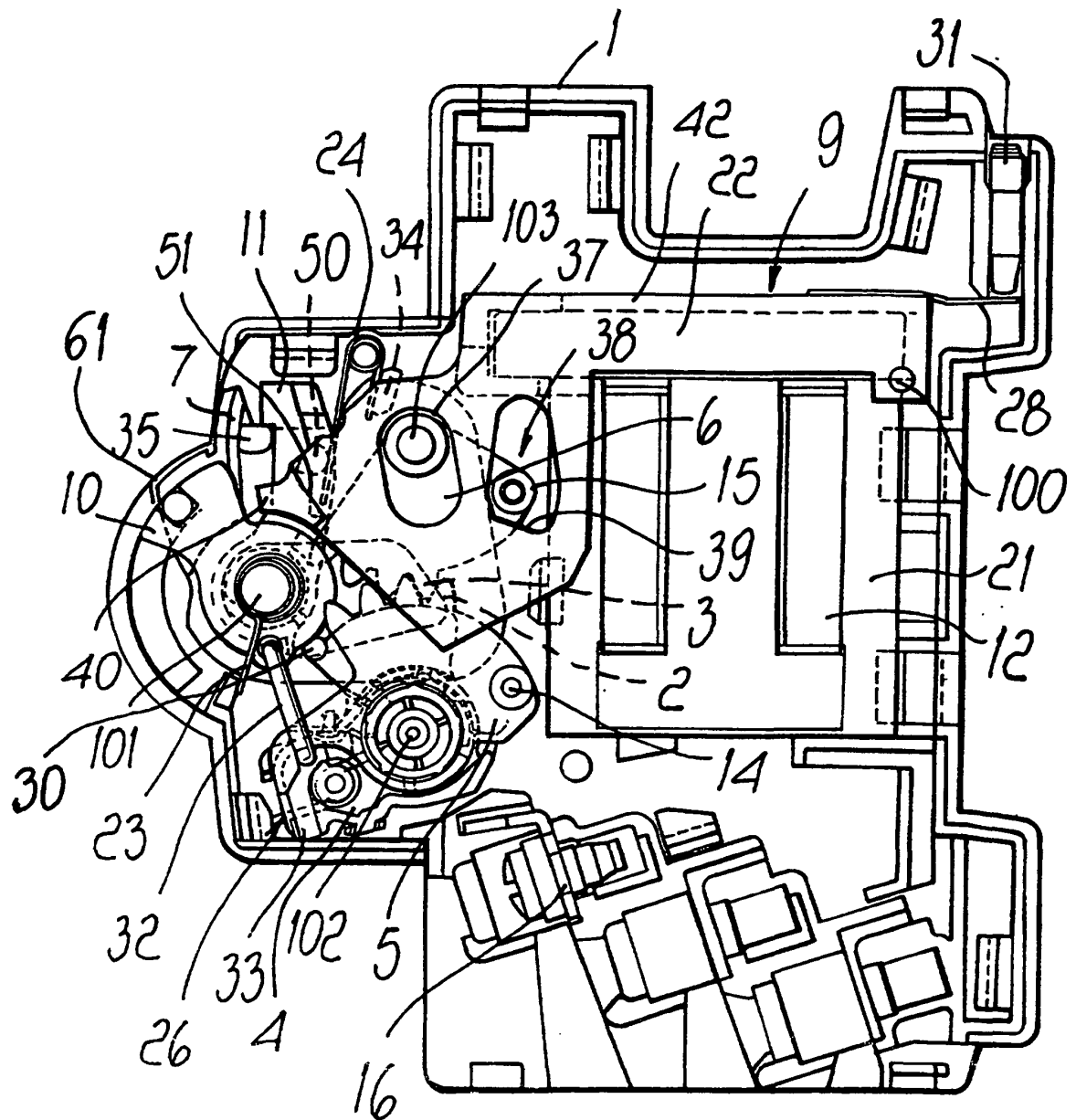

Fig. 1

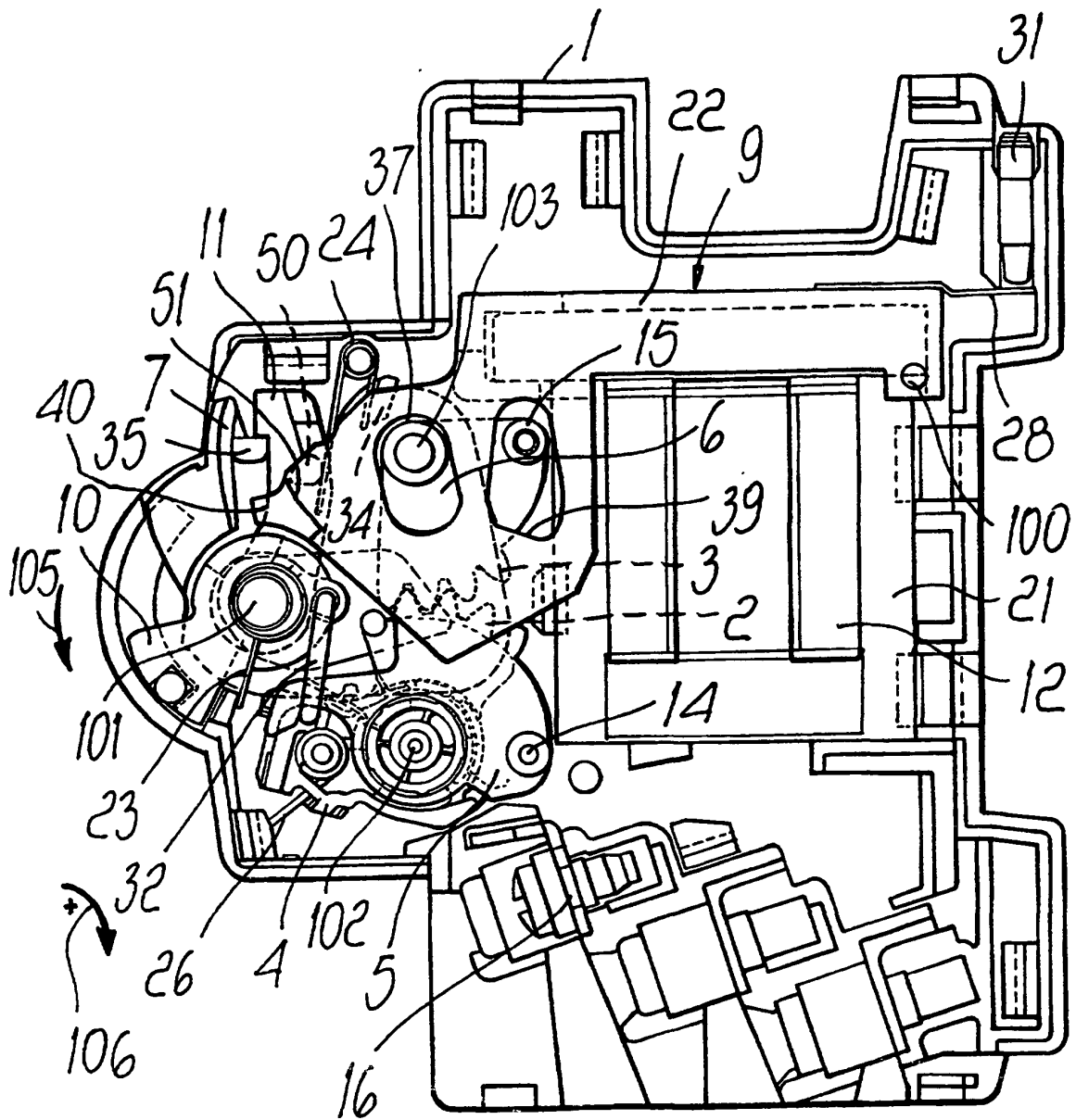

Fig. 2

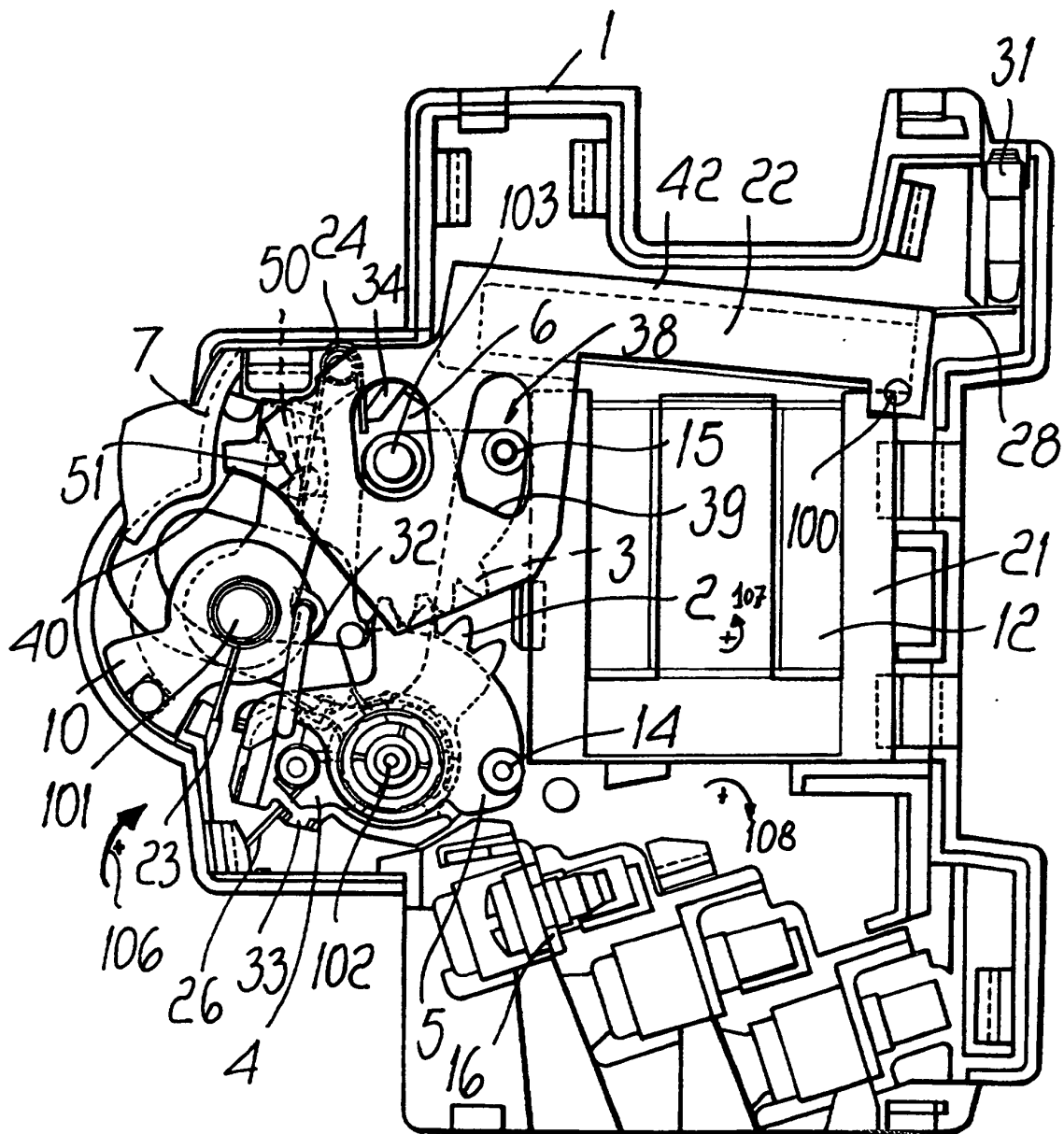

Fig. 3

