



(12) **EUROPEAN PATENT APPLICATION**

(88) Date of publication A3:  
**11.10.2000 Bulletin 2000/41**

(51) Int Cl.7: **F04D 29/66**, F04D 29/22,  
F04D 29/24

(43) Date of publication A2:  
**02.08.2000 Bulletin 2000/31**

(21) Application number: **99118429.2**

(22) Date of filing: **17.09.1999**

(84) Designated Contracting States:  
**AT BE CH CY DE DK ES FI FR GB GR IE IT LI LU**  
**MC NL PT SE**  
Designated Extension States:  
**AL LT LV MK RO SI**

(72) Inventors:  
• **Ninomiya, Tatushi, c/o Fujikoki COporation**  
**Tokyo (JP)**  
• **Imai, Masayuki, c/o Fujikoki COporation**  
**Tokyo (JP)**

(30) Priority: **27.01.1999 JP 1809699**

(74) Representative:  
**TER MEER STEINMEISTER & PARTNER GbR**  
**Artur-Ladebeck-Strasse 51**  
**33617 Bielefeld (DE)**

(71) Applicant: **Fujikoki Corporation**  
**Tokyo (JP)**

(54) **Drain pump**

(57) A pump body 30 of a drain pump comprises an intake opening 42 protruded downward and a discharge opening 46 extending to the side. A vane 50 inside the pump body 30 is rotated by a motor. The vane 50 is formed so that the outer peripheral portion of large ra-

dius vanes 450 is surrounded by a cylindrical wall member 470. The height of the cylindrical wall member 470 against the height of the large radius vanes 450 to the upper rim portion 453 is set to be in a predetermined range, which effectively reduces the noise being generated.

**Fig. 9**

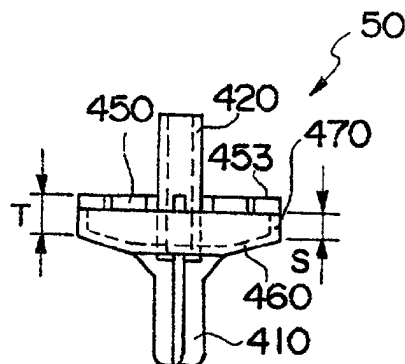



European Patent  
Office

# EUROPEAN SEARCH REPORT

Application Number  
EP 99 11 8429

DOCUMENTS CONSIDERED TO BE RELEVANT			
Category	Citation of document with indication, where appropriate, of relevant passages	Relevant to claim	CLASSIFICATION OF THE APPLICATION (Int.Cl.7)
A	EP 0 760 428 A (FUJIKOKI CORP) 5 March 1997 (1997-03-05) * the whole document * -----	1-4	F04D29/66 F04D29/22 F04D29/24
			TECHNICAL FIELDS SEARCHED (Int.Cl.7)
			F04D
The present search report has been drawn up for all claims			
Place of search <b>THE HAGUE</b>		Date of completion of the search <b>17 August 2000</b>	Examiner <b>Zidi, K</b>
<p>CATEGORY OF CITED DOCUMENTS</p> <p>X : particularly relevant if taken alone Y : particularly relevant if combined with another document of the same category A : technological background O : non-written disclosure P : intermediate document</p> <p>T : theory or principle underlying the invention E : earlier patent document, but published on, or after the filing date D : document cited in the application L : document cited for other reasons</p> <p>&amp; : member of the same patent family, corresponding document</p>			

EPO FORM 1503 03.82 (P04C01)

**ANNEX TO THE EUROPEAN SEARCH REPORT  
ON EUROPEAN PATENT APPLICATION NO.**

EP 99 11 8429

This annex lists the patent family members relating to the patent documents cited in the above-mentioned European search report. The members are as contained in the European Patent Office EDP file on

The European Patent Office is in no way liable for these particulars which are merely given for the purpose of information.

17-08-2000

Patent document cited in search report	Publication date	Patent family member(s)	Publication date
EP 0760428 A	05-03-1997	JP 9068185 A	11-03-1997
		CN 1144305 A	05-03-1997
		US 5605439 A	25-02-1997
-----			

EPO FORM P0459

EPO For more details about this annex : see Official Journal of the European Patent Office, No. 12/82