



Europäisches Patentamt
European Patent Office
Office européen des brevets



(11)

EP 1 024 559 A3

(12)

EUROPEAN PATENT APPLICATION

(88) Date of publication A3:
08.08.2001 Bulletin 2001/32

(51) Int Cl.7: **H01R 13/629**

(43) Date of publication A2:
02.08.2000 Bulletin 2000/31

(21) Application number: **99114090.6**

(22) Date of filing: **20.07.1999**

(84) Designated Contracting States:
**AT BE CH CY DE DK ES FI FR GB GR IE IT LI LU
MC NL PT SE**
Designated Extension States:
AL LT LV MK RO SI

(71) Applicant: **VEAM S.r.L.**
20020 Arese, Milano (IT)

(72) Inventor: **Luzzoli, Giorgio**
20021 Bollate, Milano (IT)

(30) Priority: **26.01.1999 US 117288 P**
26.01.1999 US 99681
12.07.1999 US 350988

(74) Representative: **MÜLLER & HOFFMANN**
Patentanwälte
Innere Wiener Strasse 17
81667 München (DE)

(54) Handle operated power connector

(57) An electrical power connector is disclosed having a plug and receptacle. The plug includes a coupling ring having a single handle extending radially therefrom. The coupling ring is freely rotatable within limits on the plug when the plug is not coupled to the receptacle. The receptacle includes one or more bayonet ramps to which the coupling ring can be coupled. Advantageous-

ly, the plug can be coupled to the receptacle with 120° rotation or less by rotating the coupling ring 120° or less. The plug and receptacle each include a colored locking indicator to indicate to the person coupling the plug to the receptacle that the receptacle and plug are properly aligned to each other when coupled. Also an audible indication of locking is provided when the electrical plug and receptacle are fully coupled.

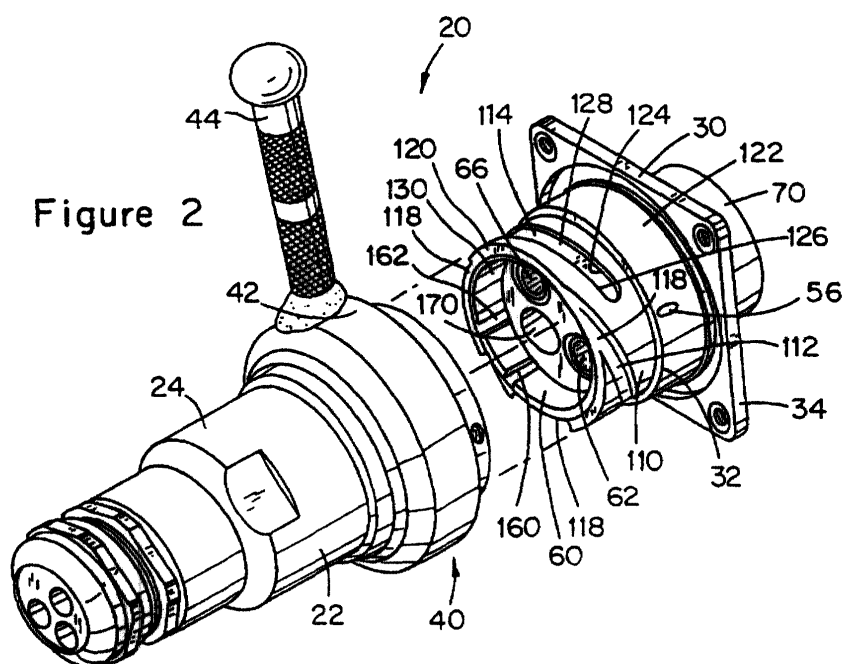

EP 1 024 559 A3



European Patent
Office

EUROPEAN SEARCH REPORT

Application Number
EP 99 11 4090

DOCUMENTS CONSIDERED TO BE RELEVANT					
Category	Citation of document with indication, where appropriate, of relevant passages	Relevant to claim	CLASSIFICATION OF THE APPLICATION (Int.Cl.7)		
P, X	EP 0 921 605 A (PALAZZOLI S P A) 9 June 1999 (1999-06-09) * page 2 * ---	1-3,5-8, 11, 13-15, 17-20, 23,24,26	H01R13/629		
X	US 4 743 207 A (CLARK THOMAS A) 10 May 1988 (1988-05-10)	1-3,5-8, 11, 13-15, 17-20, 23,24,26			
Y	* column 2, line 54 - column 6, line 7 * ---	4,9,10, 12,16, 21,22,25			
Y	US 5 558 533 A (HASHIZAWA SHIGEMI ET AL) 24 September 1996 (1996-09-24) * figure 15 * ---	4,9,12, 16,21,25			
Y	US 5 368 496 A (RANALLETTA JOSEPH V ET AL) 29 November 1994 (1994-11-29) * column 3, line 63 - column 7, line 47 * -----	10,22	<table border="1"> <thead> <tr> <th>TECHNICAL FIELDS SEARCHED (Int.Cl.7)</th> </tr> </thead> <tbody> <tr> <td>H01R</td> </tr> </tbody> </table>	TECHNICAL FIELDS SEARCHED (Int.Cl.7)	H01R
TECHNICAL FIELDS SEARCHED (Int.Cl.7)					
H01R					
The present search report has been drawn up for all claims					
Place of search THE HAGUE		Date of completion of the search 12 June 2001	Examiner Bertin, M		
<table border="0"> <tr> <td style="vertical-align: top;"> <p>CATEGORY OF CITED DOCUMENTS</p> <p>X : particularly relevant if taken alone</p> <p>Y : particularly relevant if combined with another document of the same category</p> <p>A : technological background</p> <p>O : non-written disclosure</p> <p>P : intermediate document</p> </td> <td style="vertical-align: top;"> <p>T : theory or principle underlying the invention</p> <p>E : earlier patent document, but published on, or after the filing date</p> <p>D : document cited in the application</p> <p>L : document cited for other reasons</p> <p>.....</p> <p>& : member of the same patent family, corresponding document</p> </td> </tr> </table>				<p>CATEGORY OF CITED DOCUMENTS</p> <p>X : particularly relevant if taken alone</p> <p>Y : particularly relevant if combined with another document of the same category</p> <p>A : technological background</p> <p>O : non-written disclosure</p> <p>P : intermediate document</p>	<p>T : theory or principle underlying the invention</p> <p>E : earlier patent document, but published on, or after the filing date</p> <p>D : document cited in the application</p> <p>L : document cited for other reasons</p> <p>.....</p> <p>& : member of the same patent family, corresponding document</p>
<p>CATEGORY OF CITED DOCUMENTS</p> <p>X : particularly relevant if taken alone</p> <p>Y : particularly relevant if combined with another document of the same category</p> <p>A : technological background</p> <p>O : non-written disclosure</p> <p>P : intermediate document</p>	<p>T : theory or principle underlying the invention</p> <p>E : earlier patent document, but published on, or after the filing date</p> <p>D : document cited in the application</p> <p>L : document cited for other reasons</p> <p>.....</p> <p>& : member of the same patent family, corresponding document</p>				

EPO FORM 1503 03/82 (P04C01)

**ANNEX TO THE EUROPEAN SEARCH REPORT
ON EUROPEAN PATENT APPLICATION NO.**

EP 99 11 4090

This annex lists the patent family members relating to the patent documents cited in the above-mentioned European search report. The members are as contained in the European Patent Office EDP file on
The European Patent Office is in no way liable for these particulars which are merely given for the purpose of information.

12-06-2001

Patent document cited in search report	Publication date	Patent family member(s)	Publication date
EP 0921605 A	09-06-1999	IT BS970117 U	03-06-1999
		BR 7802175 U	18-01-2000
		CN 1219781 A	16-06-1999
		DE 921605 T	17-02-2000
		PL 330061 A	07-06-1999
		SG 75145 A	19-09-2000
		TR 9802508 A	21-10-1999
		US 6039594 A	21-03-2000
		ZA 9811031 A	07-06-1999
US 4743207 A	10-05-1988	NONE	
US 5558533 A	24-09-1996	JP 3042816 B	22-05-2000
		JP 6236780 A	23-08-1994
		CA 2111810 A,C	19-06-1994
		DE 4343210 A	07-07-1994
		GB 2274556 A,B	27-07-1994
		US 5674086 A	07-10-1997
		US 5573417 A	12-11-1996
US 5368496 A	29-11-1994	NONE	