



(12) **EUROPEAN PATENT APPLICATION**

(88) Date of publication A3:
13.06.2001 Bulletin 2001/24

(51) Int Cl.7: **E05C 17/20, B60J 5/04**

(43) Date of publication A2:
06.09.2000 Bulletin 2000/36

(21) Application number: **99830577.5**

(22) Date of filing: **14.09.1999**

(84) Designated Contracting States:
AT BE CH CY DE DK ES FI FR GB GR IE IT LI LU
MC NL PT SE
 Designated Extension States:
AL LT LV MK RO SI

(72) Inventor: **Audisio, Vittorio, c/o Gammastamp Spa**
13041 Bianzé (Vercelli) (IT)

(74) Representative: **Marchitelli, Mauro et al**
Buzzi, Notaro & Antonielli d'Oulx Srl,
Corso Fiume 6
10133 Torino (IT)

(30) Priority: **04.03.1999 IT TO990165**

(71) Applicant: **Gammastamp S.p.A.**
10121 Torino (IT)

(54) **A disengageable door stop for vehicles**

(57) A door stop for a pivoting door (12) of a vehicle, comprising:

- a first and a second support (14, 20) intended to be fixed one to a vehicle body pillar (18) and the other to the door (12), and
- a retaining arm (24) articulated to the first support (14) about an axis (28) parallel to the articulation axis of the door (12).

The retaining arm (24) carries at its free end at least one roller (52) and the second support (20) comprising a stop surface (56) and a rolling surface (54) carried by respective elements (38, 33) articulated to each other about an axis (41) parallel to the axis of rotation of said roller (52). Elastic means (50) are provided for holding said elements (38, 33) in a relative position which prevents disengagement of said roller (52) from the second support (20).

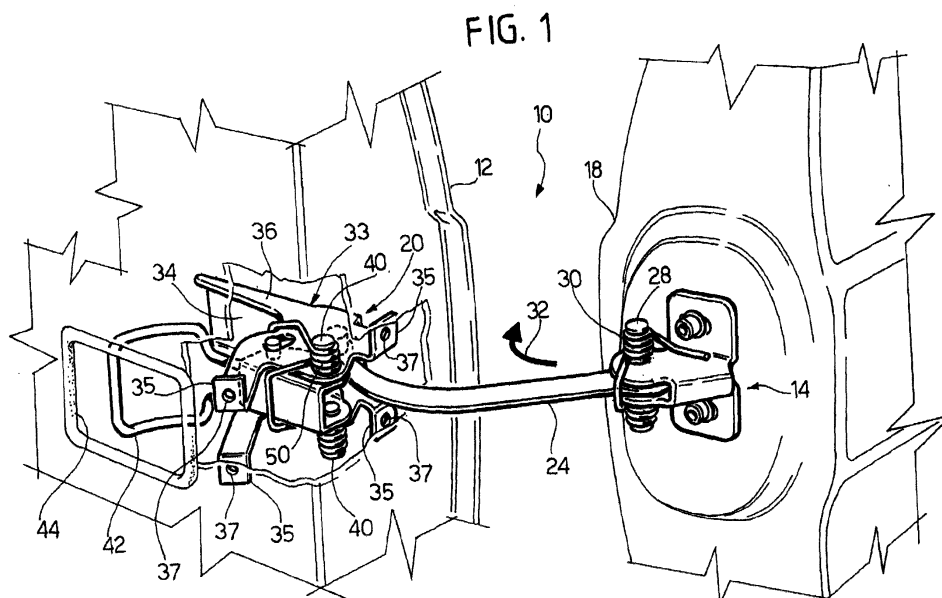



European Patent
Office

EUROPEAN SEARCH REPORT

Application Number
EP 99 83 0577

DOCUMENTS CONSIDERED TO BE RELEVANT			
Category	Citation of document with indication, where appropriate, of relevant passages	Relevant to claim	CLASSIFICATION OF THE APPLICATION (Int.Cl.7)
D,Y	FR 2 721 649 A (M.G.I. GOUTIER) 29 December 1995 (1995-12-29) * the whole document *	1	E05C17/20 B60J5/04
Y	DE 24 12 990 A (ED. SCHARWÄCHTER KG) 2 October 1975 (1975-10-02) * the whole document *	1	
A	FR 2 351 237 A (ED.SCHARWÄCHTER G.M.B.H. & CO., KG) 9 December 1977 (1977-12-09) * the whole document *	1	
A	EP 0 216 689 A (REGIE NATIONALE DES USINES RENAULT) 1 April 1987 (1987-04-01) * the whole document *	1	
A	EP 0 399 145 A (ED. SCHARWÄCHTER GMBH & CO. KG.) 28 November 1990 (1990-11-28) * the whole document *	1	
A	EP 0 808 981 A (FIAT AUTO S.P.A.) 26 November 1997 (1997-11-26) * the whole document *	1	TECHNICAL FIELDS SEARCHED (Int.Cl.7) E05C
The present search report has been drawn up for all claims			
Place of search THE HAGUE		Date of completion of the search 19 April 2001	Examiner Westin, K
CATEGORY OF CITED DOCUMENTS X : particularly relevant if taken alone Y : particularly relevant if combined with another document of the same category A : technological background O : non-written disclosure P : intermediate document		T : theory or principle underlying the invention E : earlier patent document, but published on, or after the filing date D : document cited in the application L : document cited for other reasons & : member of the same patent family, corresponding document	

EPO FORM 1503 03.82 (P4/C01)

**ANNEX TO THE EUROPEAN SEARCH REPORT
ON EUROPEAN PATENT APPLICATION NO.**

EP 99 83 0577

This annex lists the patent family members relating to the patent documents cited in the above-mentioned European search report.
The members are as contained in the European Patent Office EDP file on
The European Patent Office is in no way liable for these particulars which are merely given for the purpose of information.

19-04-2001

Patent document cited in search report		Publication date	Patent family member(s)	Publication date
FR 2721649	A	29-12-1995	NONE	
DE 2412990	A	02-10-1975	GB 1507853 A SE 7501548 A	19-04-1978 19-09-1975
FR 2351237	A	09-12-1977	DE 2620916 A GB 1563538 A	24-11-1977 26-03-1980
EP 216689	A	01-04-1987	FR 2587401 A DE 3662154 D	20-03-1987 30-03-1989
EP 399145	A	28-11-1990	DE 3917079 A DE 59001155 D ES 2039975 T HU 54769 A,B JP 2921584 B JP 3008989 A SU 1774924 A US 5039144 A	29-11-1990 13-05-1993 01-10-1993 28-03-1991 19-07-1999 16-01-1991 07-11-1992 13-08-1991
EP 808981	A	26-11-1997	IT T0960442 A	24-11-1997