



Europäisches Patentamt  
European Patent Office  
Office européen des brevets



(11) **EP 1 033 791 A3**

(12) **EUROPEAN PATENT APPLICATION**

(88) Date of publication A3:  
**07.02.2001 Bulletin 2001/06**

(51) Int. Cl.<sup>7</sup>: **H01R 33/05**, H01R 33/09,  
F21M 7/00

(43) Date of publication A2:  
**06.09.2000 Bulletin 2000/36**

(21) Application number: **00104376.9**

(22) Date of filing: **02.03.2000**

(84) Designated Contracting States:  
**AT BE CH CY DE DK ES FI FR GB GR IE IT LI LU  
MC NL PT SE**  
Designated Extension States:  
**AL LT LV MK RO SI**

(30) Priority: **02.03.1999 US 260253**

(71) Applicant: **OSRAM SYLVANIA INC.**  
**Danvers, MA 01923 (US)**

(72) Inventors:  
• **Linnell, Thomas D.**  
**York, Pennsylvania 17404 (US)**

• **Gruno, Laura Anne**  
**Willowstreet, PA 17584 (US)**  
• **Hun, Chong Yi**  
**Mechanicsburg, Pennsylvania 17055 (US)**  
• **Humphrey, David T.**  
**York, Pennsylvania 17402 (US)**

(74) Representative:  
**Grünecker, Kinkeldey,**  
**Stockmair & Schwanhäusser**  
**Anwaltssozietät**  
**Maximilianstrasse 58**  
**80538 München (DE)**

(54) **Angled lamp socket**

(57) An angled lamp socket is provided that includes a body and a housing. The body contains therein opposing lamp retaining clips and a plurality of lamp contact members. The housing contains therein a plurality of terminal members. Respective lamp contact members are connected electrically to respective terminal members within a portion of the housing. When a lamp is inserted into the socket, the horizontal axis of the lamp will extend at an angle in relation to the termi-

nal members. In a preferred embodiment, such angle is 90° thereby providing a right angle lamp socket. Each electrical connection may be a weld, or a spring biased engagement, between the lamp contact members and respective terminal members. The electrical connection is such that there is no need for any special opening, and cover thereof, to gain access to the inside of the lamp socket.

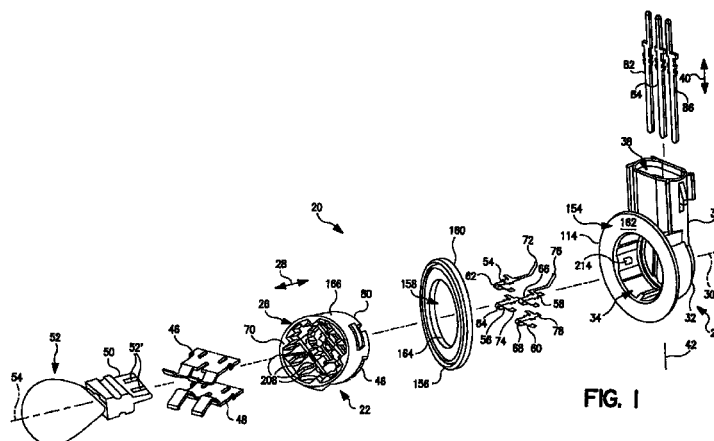

**FIG. 1**

**EP 1 033 791 A3**



European Patent  
Office

# EUROPEAN SEARCH REPORT

Application Number  
EP 00 10 4376

DOCUMENTS CONSIDERED TO BE RELEVANT			
Category	Citation of document with indication, where appropriate, of relevant passages	Relevant to claim	CLASSIFICATION OF THE APPLICATION (Int.Cl.7)
X	US 5 121 304 A (BERGIN JOHN A ET AL) 9 June 1992 (1992-06-09) * column 2, line 35 - line 38 *	1,3-17	H01R33/05 H01R33/09 F21M7/00
Y	* column 4, line 10 - line 15 * * column 4, line 28 - line 32 * * column 4, line 43 - line 46; figures 1-4 *	18,19	
X	EP 0 817 328 A (SUMITOMO WIRING SYSTEMS) 7 January 1998 (1998-01-07)	1-7	
Y	* claim 1; figures 1,6,10 *	18,19	
X	US 4 687 965 A (VAN SEGGELEN GODEFRIDUS G ET AL) 18 August 1987 (1987-08-18) * abstract; figures 2,3 * * page 4, line 51 - line 57 *	1,2,4-7	
A	EP 0 668 638 A (SUMITOMO WIRING SYSTEMS) 23 August 1995 (1995-08-23) * claim 1; figures 1-3 * * column 6, line 27 - line 49 *	1	TECHNICAL FIELDS SEARCHED (Int.Cl.7)
A	EP 0 642 196 A (SUMITOMO WIRING SYSTEMS) 8 March 1995 (1995-03-08) * abstract; figures 4,6,10 * * column 6, line 15 - line 33 *	1	H01R F21M
D,A	US 5 411 407 A (THOMAS RONALD E) 2 May 1995 (1995-05-02) * column 2, line 60 - column 3, line 2; figures 5,7,9 *	1,9	
The present search report has been drawn up for all claims			
Place of search <b>THE HAGUE</b>		Date of completion of the search <b>21 December 2000</b>	Examiner <b>Jiménez, J</b>
CATEGORY OF CITED DOCUMENTS X : particularly relevant if taken alone Y : particularly relevant if combined with another document of the same category A : technological background O : non-written disclosure P : intermediate document		T : theory or principle underlying the invention E : earlier patent document, but published on, or after the filing date D : document cited in the application L : document cited for other reasons & : member of the same patent family, corresponding document	

EPO FORM 1503 03.82 (P04C01)

**ANNEX TO THE EUROPEAN SEARCH REPORT  
ON EUROPEAN PATENT APPLICATION NO.**

EP 00 10 4376

This annex lists the patent family members relating to the patent documents cited in the above-mentioned European search report. The members are as contained in the European Patent Office EDP file on  
The European Patent Office is in no way liable for these particulars which are merely given for the purpose of information.

21-12-2000

Patent document cited in search report	Publication date	Patent family member(s)	Publication date
US 5121304 A	09-06-1992	NONE	
EP 0817328 A	07-01-1998	JP 10022020 A	23-01-1998
		US 5876251 A	02-03-1999
US 4687965 A	18-08-1987	CA 1253563 A	02-05-1989
		DE 3664019 D	20-07-1989
		EP 0193997 A	10-09-1986
		JP 5077144 B	26-10-1993
		JP 61208746 A	17-09-1986
EP 0668638 A	23-08-1995	JP 7230866 A	29-08-1995
		DE 69503536 D	27-08-1998
		DE 69503536 T	22-04-1999
		US 5637020 A	10-06-1997
EP 0642196 A	08-03-1995	JP 7078662 A	20-03-1995
		DE 69411338 D	06-08-1998
		DE 69411338 T	28-01-1999
		US 5507670 A	16-04-1996
US 5411407 A	02-05-1995	NONE	