

(19)



Europäisches Patentamt

European Patent Office

Office européen des brevets



(11)

**EP 1 034 769 A1**

(12)

## EUROPEAN PATENT APPLICATION

(43) Date of publication:

**13.09.2000 Bulletin 2000/37**

(51) Int Cl.7: **A61G 17/00**

(21) Application number: **99104648.3**

(22) Date of filing: **09.03.1999**

(84) Designated Contracting States:

**AT BE CH CY DE DK ES FI FR GB GR IE IT LI LU  
MC NL PT SE**

Designated Extension States:

**AL LT LV MK RO SI**

(72) Inventors:

- **Hsu, Hsien-Chin**  
**Pa-Te, Taoyuan Hsien (TW)**
- **Chen, Tin-Sheng**  
**Taoyuan, Taoyuan Hsien (TW)**

(71) Applicants:

- **Hsu, Hsien-Chin**  
**Pa-Te, Taoyuan Hsien (TW)**
- **Chen, Tin-Sheng**  
**Taoyuan, Taoyuan Hsien (TW)**

(74) Representative: **Winkler, Andreas, Dr.**

**FORRESTER & BOEHMERT**  
**Franz-Joseph-Strasse 38**  
**80801 München (DE)**

(54) **Casket**

(57) A casket has a base, a pair of first side plates detachably seated on opposite sides of the base, a pair of second side plates detachable connected with the first side plates and the base, a pair of bars detachably

mounted onto the respective second side plate and a cover detachably connected with the pair of bars. With the arrangement, the cover is able to pivot with respect to the pair of bars and the entire casket is able to be disassembled for transportation or storage.

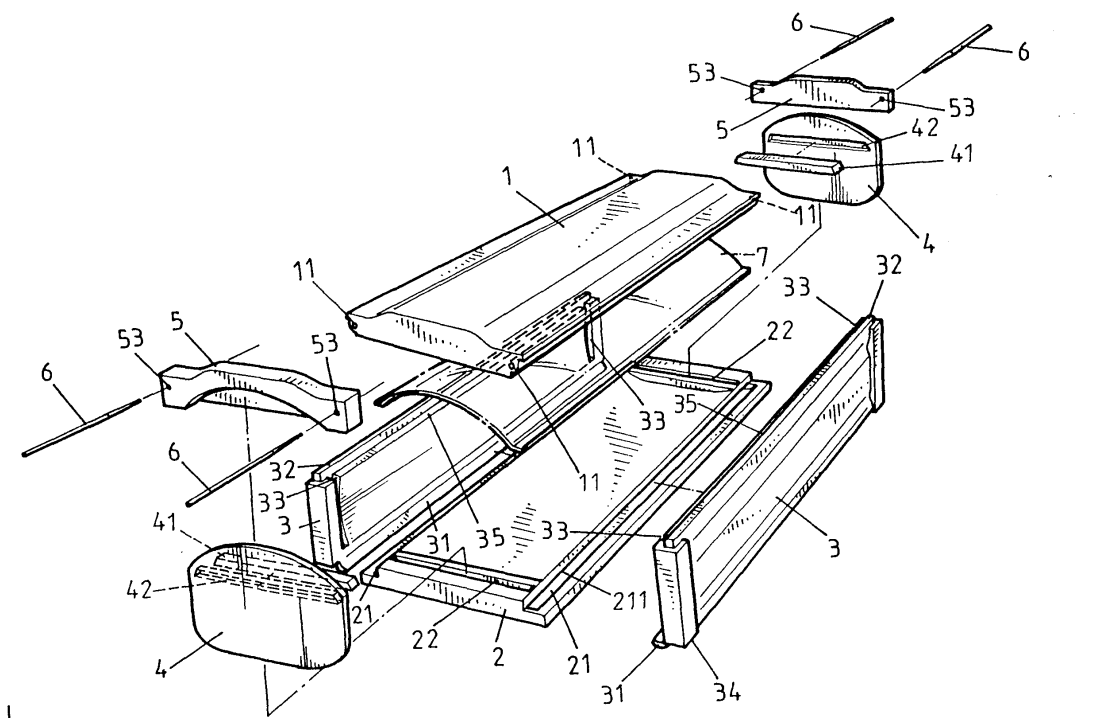

**FIG. 1**

**EP 1 034 769 A1**

## Description

### BACKGROUND OF THE INVENTION

#### 1. Field of the Invention

[0001] The present invention relates to a casket, and more particularly to a casket which is able to be assembled and disassembled easily and the arrangement thereof enables an operator to transport it with ease.

#### 2. Description of Related Art

[0002] As known in the art, caskets often are made of wood and decorated with different kinds of metal plates so as to increase the appearance thereof. Furthermore, due to the weight of a conventional casket is so heavy that manufacture and transportation thereof often requires special attention to proceed with all the necessary procedure. After the casket is buried underground, the wood will be degraded by nature. Yet, the metal plates mounted outside the casket can not be degraded easily, which causes environmental pollution.

[0003] It is, therefore, necessary to provide an improved casket to which an operator is able to handle easily. Furthermore, a pair of side bars mounted therein enables a cover to pivot when necessary, such that people are able to pay their last respect to the dead by the pivotal movement of the cover.

[0004] It is an objective of the present invention to provide an improved casket to mitigate and/or obviate the aforementioned problems.

[0005] Hereinafter, the detailed description of the preferred embodiment of the invention with reference to the accompanying drawings will be given to show the structure and function thereof. However, all the description and reference drawings are used as a descriptive purpose only, but not in a limit sense.

### SUMMARY OF THE INVENTION

[0006] The main object of the present invention is to provide a casket, which is easy to be stored, manufactured, assembled and transported.

[0007] According to one aspect of the invention, the casket of the invention has a T-shaped cover defined therein two pair of blind holes respectively on opposite sides thereof, a pair of first side plates each formed along a length thereof a cross plate so as to support the cover when engaged therewith, a pair of second side plate each defined along a length thereof a recess for receiving opposite sides of the cover when engaged therewith, a pair of cross bars each seated between the pair of second side plates and defined therein a pair of second blind holes corresponding to the blind holes of the cover so that pins are able to be inserted respectively into the second blind holes of the cross bars and the blind holes of the cover to enable the cover to be pivotal

with respect to the cross bars and a base defined on opposite sides thereof a first recess so as to receive a peripheral edge of the respective first side plate. It is therefore noted that when the casket constructed in accordance with the invention is assembled, the cover is able to pivot when a pair of opposite pins are withdrawn from the corresponding blind holes of the cross bars and the cover.

[0008] Other objects, advantages and novel features of the invention will become more apparent from the following detailed description when taken in conjunction with the accompanying drawings.

### BRIEF DESCRIPTION OF THE DRAWINGS

#### [0009]

Fig. 1 is an exploded perspective view of a casket in accordance with the present invention;

Fig. 2 is a perspective view showing a cross bar of the invention;

Fig. 3 is a perspective view showing the assembled casket of the invention;

Fig. 4 is a perspective view showing a cover of the invention is pivotal with respect to the pair of cross bars;

Fig. 5 is a perspective view of the assembled casket with the pins inserted into the corresponding blind holes of the cross bars and the cover;

Fig. 6 is a partially cross-sectional view showing the engagement of the side plate with the base;

Fig. 7 is a perspective view showing the casket of the invention is being disassembled and arranged in order;

Figs. 8 and 9 are embodiments showing the casket of the invention has decorative plates mounted on the outer periphery thereof.

### DETAILED DESCRIPTION OF THE PREFERRED EMBODIMENT

[0010] Referring to Figs. 1 and 2, a casket constructed in accordance with the invention is shown. The casket of the invention has a cover (10) defined in opposite sides thereof a pair of first blind holes (11), a base (2) having the size and the shape corresponding to that of the cover (1) and defined along a length thereof a pair of opposite recesses (21) each further having a concave (211) defined in a periphery defining the recess (21) and a pair of opposite slots (22), a pair of first side plates (3) respectively and detachably engaged between the cover (1) and the base (2) and each having a pair of arcuate blocks (31) respectively and integrally formed on a bottom face thereof so as to be seated in the concave (211) of the base (2) when the respective first side plate (3) being secured in the recess (21), a ridge (32) formed along a length thereof, a cutout (33) defined beside the ridge (32) and corresponding to the opposite sides of

the cover (1), a corner (34) formed beside the arcuate block (31) and having a shape and configuration corresponding to that of the recess (21) of the base (2) and a first cross bar (35) formed in an inner periphery thereof and orientated in a direction the same as that of the cut-out (33), a pair of second side plate (4) each being detachably seated in the slot (22) of the base (2) and having a second cross bar (41) formed on an inner periphery thereof and detachably inserted into a corresponding recess (42) defined in an inner face of the side plate (4), a pair of bars (5) each having a gap (51) for receiving a portion of an upper portion of the second side plate (4), a pair of opposite troughs (52) for engaging with the respective ridge (32) of the first side plate (3) and a pair of opposite through holes (53) respectively corresponding to the blind holes (11) of the cover (1) and two pair of pins (6) respectively and detachably inserted into the corresponding through holes (53) of the bars (5) and the blind holes (11) of the cover (1).

**[0011]** When in assembly, referring to Figs. 3, 4, 5 and 6, the arcuate block (31) of the first side plate (3) is received in the concave (211) of the base (2), such that the pair of first side plates (3) are respectively positioned on opposite sides of the base (2). While the first side plate (3) are positioned on opposite sides of the base (2), the two cutouts (33) encounter with each other define a track (not numbered) so that the pair of second side plates (4) are able to be inserted into the corresponding cutouts (33) of the first side plates (3). Thereafter, the pair of bars (5) are able to be respectively and detachably mounted on the pair of first side plates (3) and the pair of second side plates (4) by means of that an upper portion of each of the pair of the second side plates (4) is inserted into the gap (51) and the opposite ridges (32) of the pair of opposite first side plates (3) are inserted into the troughs (52) of the bars (5). Furthermore, the cover (1) can be pivotally engaged with the pair of bars (5). That is, after aligning the through holes (53) of the bar (5) with the blind holes (ii) of the cover (1), the pins (6) are able to be inserted into the aligned through holes (53) and the blind holes (11) so as to secure the cover (1) to the pair of bars (5), as shown in Figs. 3 and 5. If the cover (1) is required to pivot with respect to the bars (5), a pair of opposed pins (6) are drawn from the aligned through holes (53) and blind holes (11), such that the cover (1), as shown in Figs. 4 and 6, is able to pivot with respect to the bars (5). When the above mentioned procedure is finished, the first cross bar (35) and the second cross bar (41) of the first side plate (3) and the second side plate (4) respectively form a rectangular support, therefore, a transparent cover (7) is able to be seated on top of the support, so as to enable the people to pay their last respect to the dead lying in the space defined in the pair of first side plates (3), the pair of second side plates (4) and the base (2).

**[0012]** Referring to Fig. 7, when the casket of the invention is to be stored in a compact space or requires to be transferred from one place to another, the operator

is able to disassemble the casket and arrange the components in a special order. It is notable from the accompanying drawing that the first side plates (3) are lying on the base (2) such that the respective arcuate blocks (31) cover the recess (21) of the base (2). Then, the pair of second side plates (4) are placed on opposite sides on the lying pair of first side plates (3). Accordingly, the pair of bars (5) and the pins (6) are located between the opposed second side plates (4) in parallel. Finally, the cover (1) is placed on top of the second side plates (4), the pair of bars (5) and the pins (6).

**[0013]** To increase the appearance of the casket of the invention, the operator is able to mount decorative plates onto an outer periphery of the casket as shown in Figs. 8 and 9.

**[0014]** It is therefore notable that the invention has the following advantages:

1. easy assembly
2. multiple function
3. easy to disassembly
4. compact when in storage

**[0015]** Even though numerous characteristics and advantages of the present invention have been set forth in the foregoing description, together with details of the structure and function of the invention, the disclosure is illustrative only, and changes may be made in detail, especially in matters of shape, size, and arrangement of parts within the principles of the invention to the full extent indicated by the broad general meaning of the terms in which the appended claims are expressed.

## Claims

### 1. A casket comprising:

a cover (10) defined in opposite sides thereof a pair of first blind holes (11);

a base (2) having the size and the shape corresponding to that of the cover (1) and defined along a length thereof a pair of opposite recesses (21) each further having a concave (211) defined in a periphery defining the recess (21) and a pair of opposite slots (22);

a pair of first side plates (3) respectively mounted onto the recess (21) of the base (2) and detachably engaged between the cover (1) and the base (2) and each having a pair of arcuate blocks (31) respectively and integrally formed on a bottom face thereof so as to be seated in the concave (211) of the base (2), a ridge (32) formed along a length thereof, a cutout (33) defined beside the ridge (32) and corresponding to the opposite sides of the cover (1), a corner

(34) formed beside the arcuate block (31) and having a shape and configuration corresponding to that of the concave (211) of the base (2) and a first cross bar (35) formed in an inner periphery thereof and orientated in a direction the same as that of the cutout (33); 5

a pair of second side plate (4) each being detachably seated in the slot (22) of the base (2) and having a second cross bar (41) detachably inserted into a recess (42) defined in an inner periphery thereof and together form a support with the first cross bar (35); 10

a pair of bars (5) each having a gap (51) for receiving a portion of an upper portion of the second side plate (4), a pair of opposite troughs (52) for engaging with the respective ridge (32) of the first side plate (3) and a pair of opposite through holes (53) respectively corresponding to the blind holes (11) of the cover (1); and 15 20

two pair of pins (6) respectively and detachably inserted into the corresponding through holes (53) of the bars (5) and the blind holes (11) of the cover (1). 25

30

35

40

45

50

55

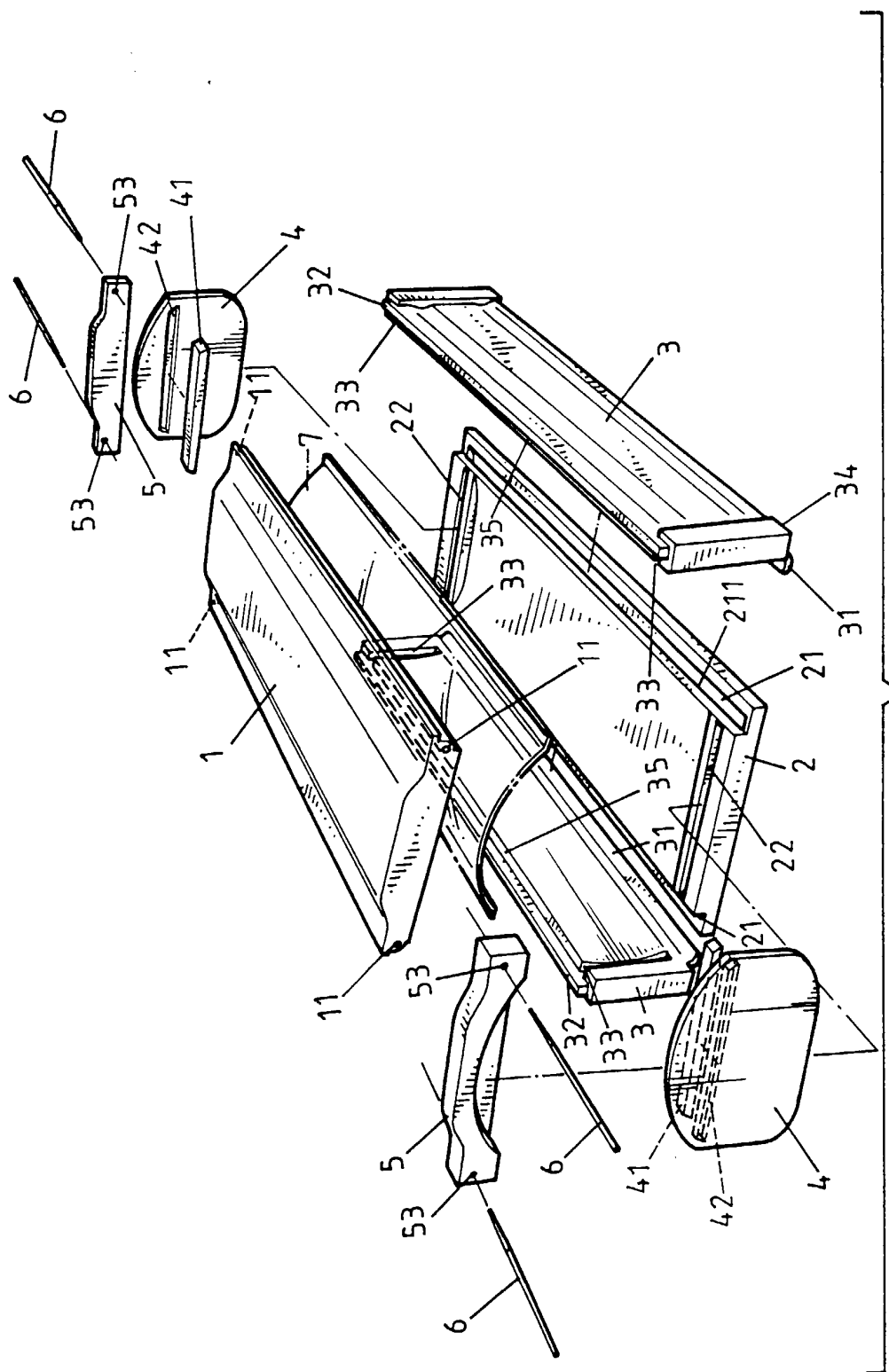

FIG.1

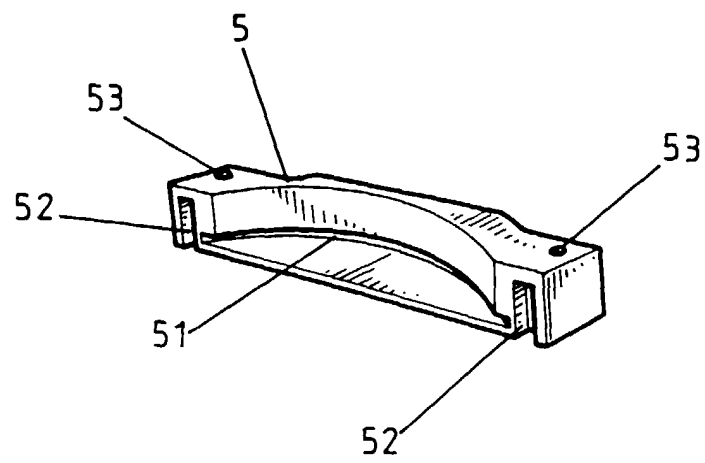

FIG.2

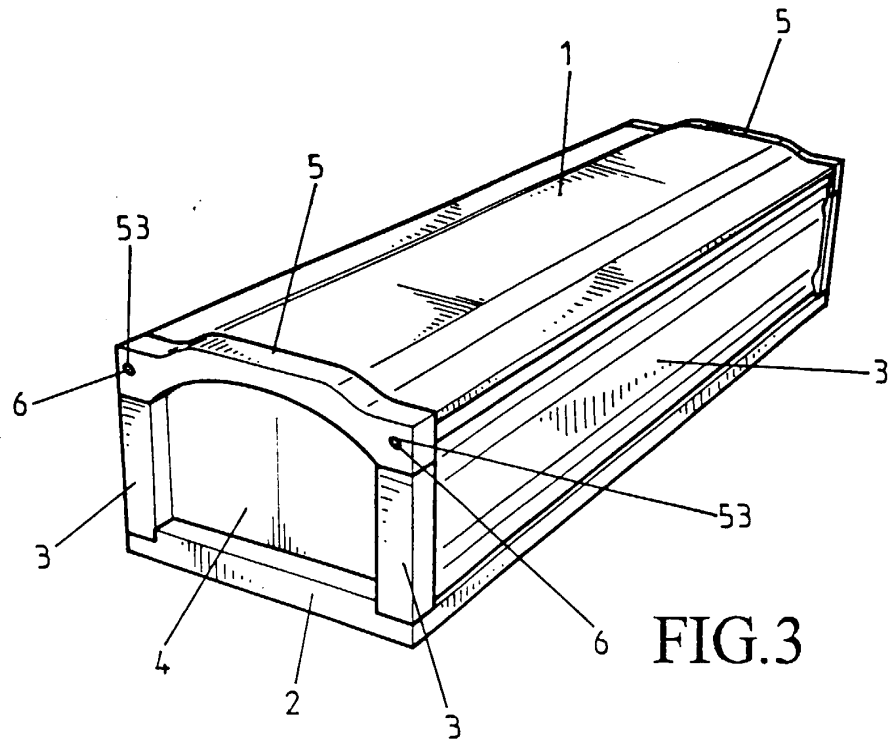

FIG.3

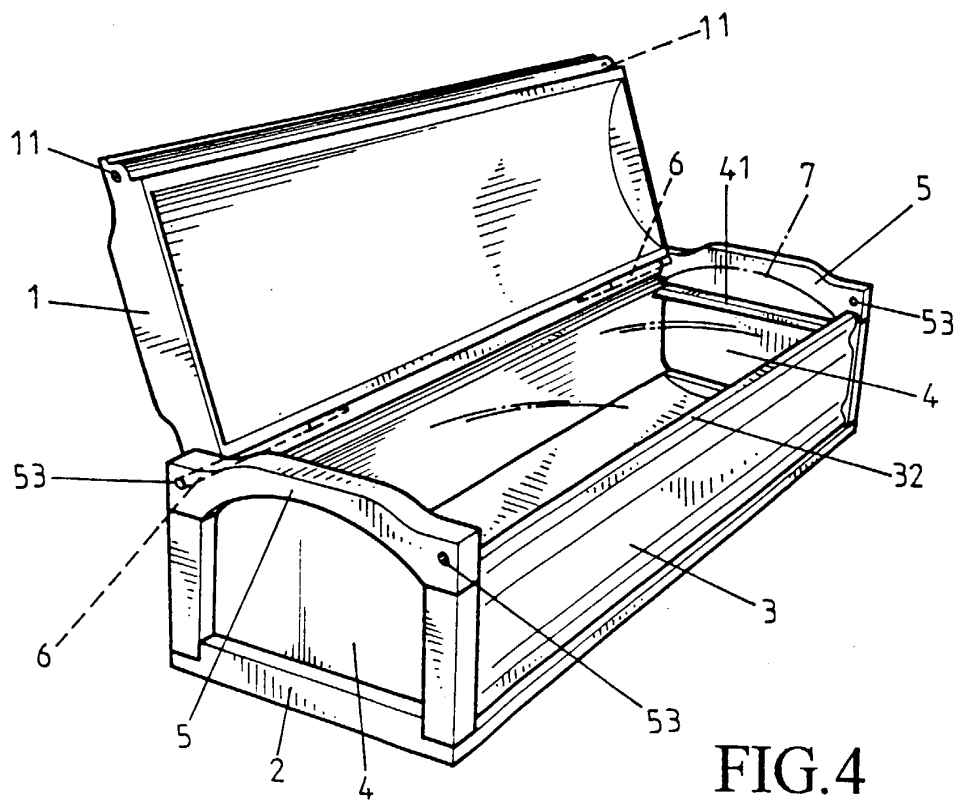

FIG.4

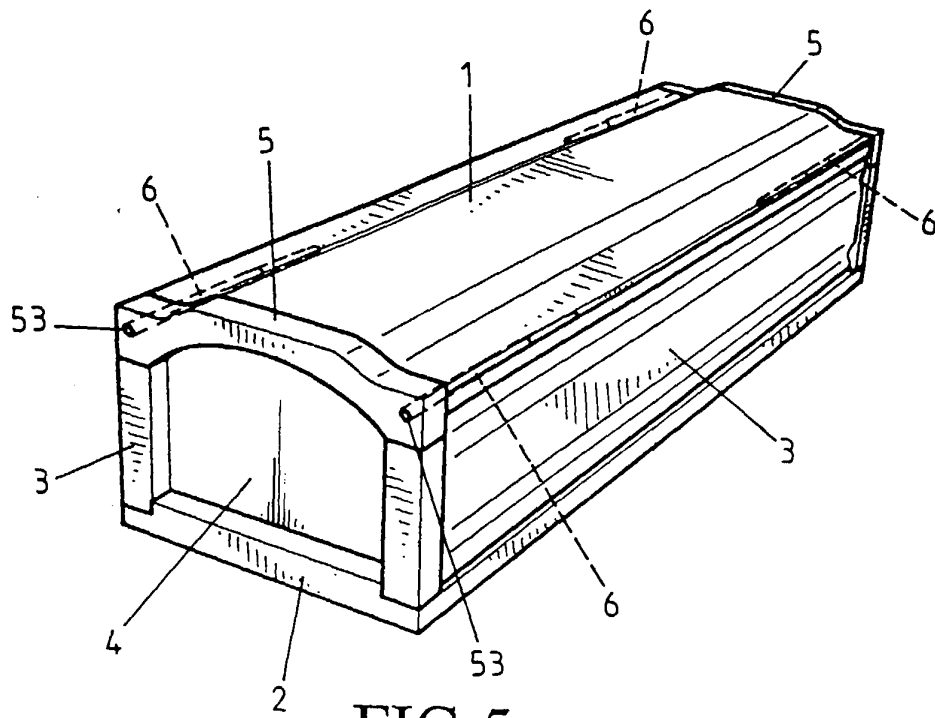

FIG. 5

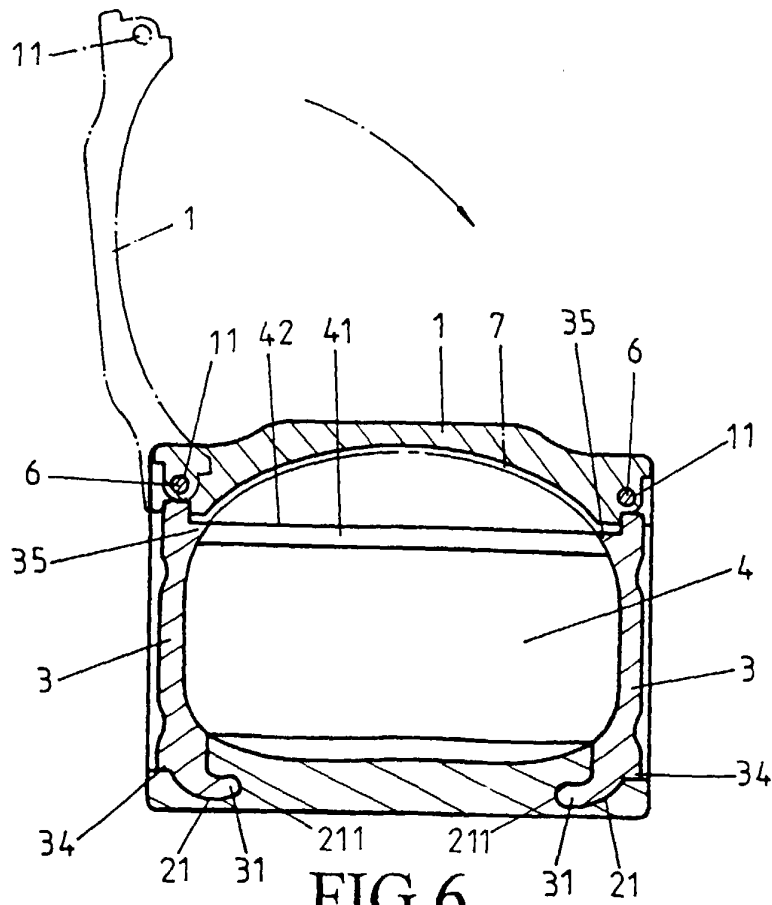

FIG. 6



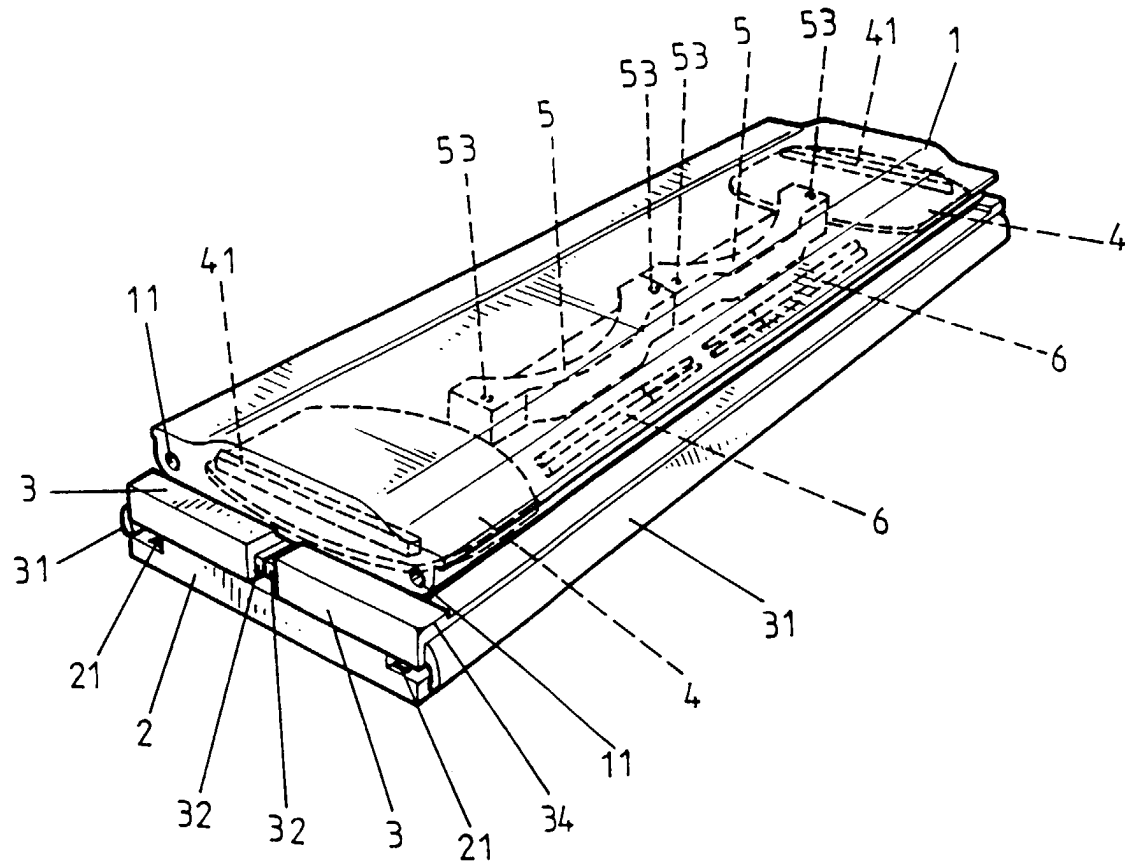

FIG.7

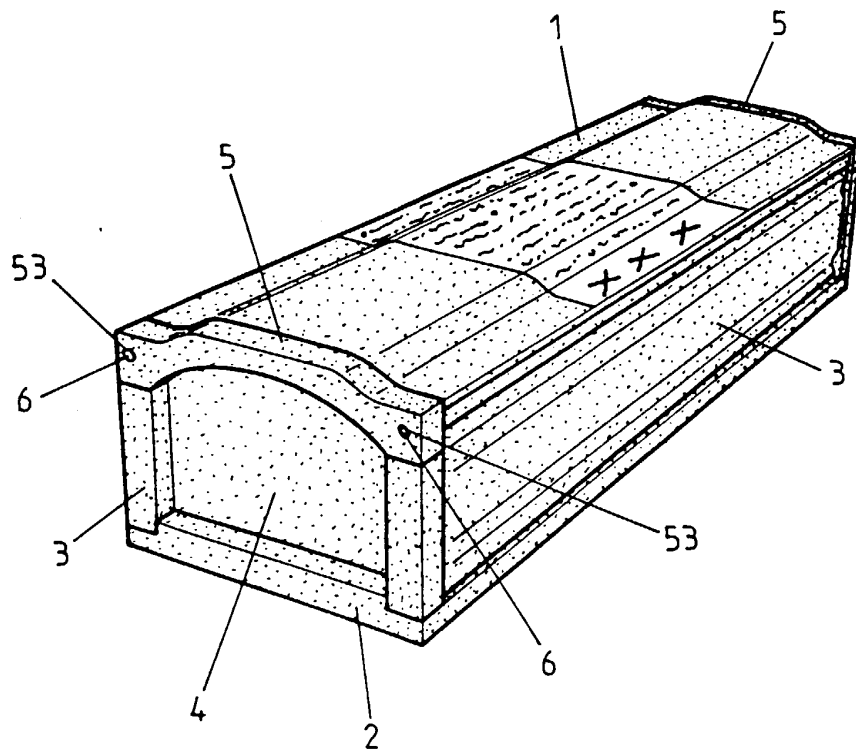

FIG. 8

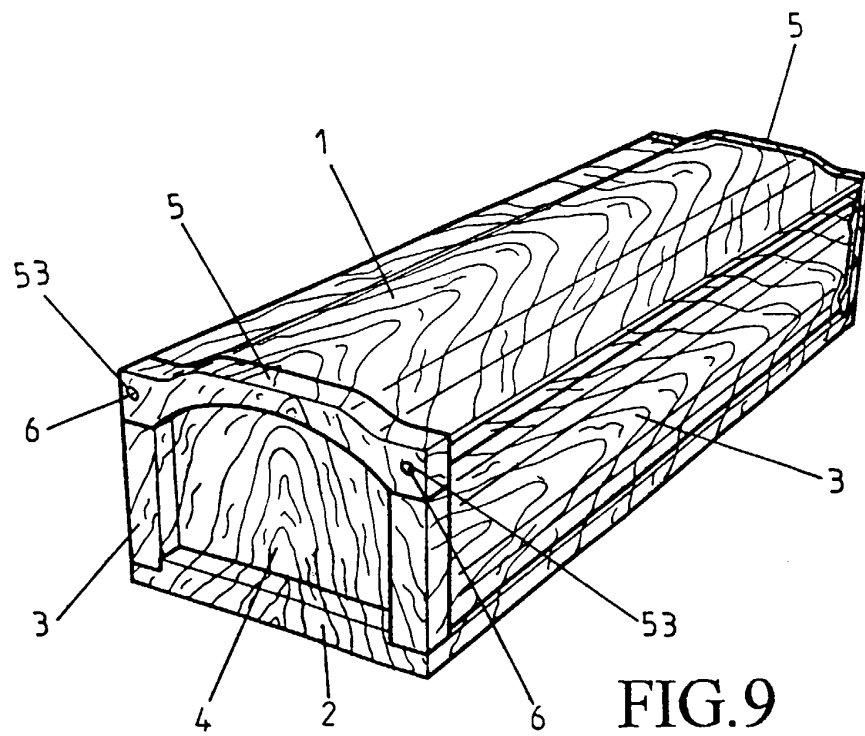

FIG. 9



European Patent  
Office

# EUROPEAN SEARCH REPORT

Application Number  
EP 99 10 4648

DOCUMENTS CONSIDERED TO BE RELEVANT			
Category	Citation of document with indication, where appropriate, of relevant passages	Relevant to claim	CLASSIFICATION OF THE APPLICATION
A	GB 696 180 A (VOS) * page 1, line 53 - line 64; figures * ---	1	A61G17/00
A	DE 911 424 C (MEYER) * page 2, line 92 - line 96; figure 7 * ---	1	
A	FR 2 649 606 A (COTS MORA RAMON) 18 January 1991 (1991-01-18) * the whole document * ---	1	
A	CH 391 957 A (RUPPER) ---		
A	CH 442 614 A (SCHNEIDER) -----		
			TECHNICAL FIELDS SEARCHED
			A61G
The present search report has been drawn up for all claims			
Place of search		Date of completion of the search	Examiner
THE HAGUE		4 August 1999	Godot, T
<p>CATEGORY OF CITED DOCUMENTS</p> <p>X : particularly relevant if taken alone  Y : particularly relevant if combined with another document of the same category  A : technological background  O : non-written disclosure  P : intermediate document</p> <p>T : theory or principle underlying the invention  E : earlier patent document, but published on, or after the filing date  D : document cited in the application  L : document cited for other reasons  .....  &amp; : member of the same patent family, corresponding document</p>			

EPO FORM 1503 03 82 (P04C01)

**ANNEX TO THE EUROPEAN SEARCH REPORT  
ON EUROPEAN PATENT APPLICATION NO.**

EP 99 10 4648

This annex lists the patent family members relating to the patent documents cited in the above-mentioned European search report.  
The members are as contained in the European Patent Office EDP file on  
The European Patent Office is in no way liable for these particulars which are merely given for the purpose of information.

04-08-1999

Patent document cited in search report	Publication date	Patent family member(s)	Publication date
GB 696180 A		NONE	
DE 911424 C		NONE	
FR 2649606 A	18-01-1991	ES 2063718 A	01-01-1995
CH 391957 A		NONE	
CH 442614 A		NONE	

EPO FORM P0459

For more details about this annex : see Official Journal of the European Patent Office, No. 12/82