



Europäisches Patentamt
European Patent Office
Office européen des brevets



(11) **EP 1 048 423 A3**

(12) **EUROPEAN PATENT APPLICATION**

(88) Date of publication A3:
26.09.2001 Bulletin 2001/39

(51) Int Cl.7: **B27M 1/08**, B27F 1/06,
B27M 3/04, E04F 15/10

(43) Date of publication A2:
02.11.2000 Bulletin 2000/44

(21) Application number: **00108072.0**

(22) Date of filing: **25.04.2000**

(84) Designated Contracting States:
**AT BE CH CY DE DK ES FI FR GB GR IE IT LI LU
MC NL PT SE**
Designated Extension States:
AL LT LV MK RO SI

(72) Inventor: **Franchin, Pier Luigi**
31100 Treviso (IT)

(74) Representative: **Bonini, Ercole**
c/o STUDIO ING. E. BONINI SRL
Corso Fogazzaro 8
36100 Vicenza (IT)

(30) Priority: **29.04.1999 IT VI990081**

(71) Applicant: **A. COSTA SPA**
36035 Marano Vicentino (VI) (IT)

(54) **A method for profiling laths for parquet and squaring machine suited to realize such a method**

(57) A method (L) for profiling laths for parquet aligned on a tow chain (9) enclosed in the case (19) of the base (2) of a squaring machine (1) provided with a plurality of operating heads (3, 4, 5, 6, 7). The method comprises the following operations: engravings the face (L') of each lath (L) towards said chain (9) a couple of longitudinal engravings (S'; S''); millings on both lateral ribs (B', B'') of each lath (L); shaping the lateral ribs (B', B'') for the whole length making on one of said ribs (B') a male profile (M) and on the opposite rib (B'') a female profile (F). The distance (D) between said engravings (S', S'') is lower than the width (24) of said case (19), each of said engravings being obtained by a rotating tool (3'; 3''; 4'; 4'') belonging to one of said operating heads (3a, 3b, 4a, 4b) and having the rotating plane (30', 30'', 40', 40'') sloping in respect with the faces of the lath (L).

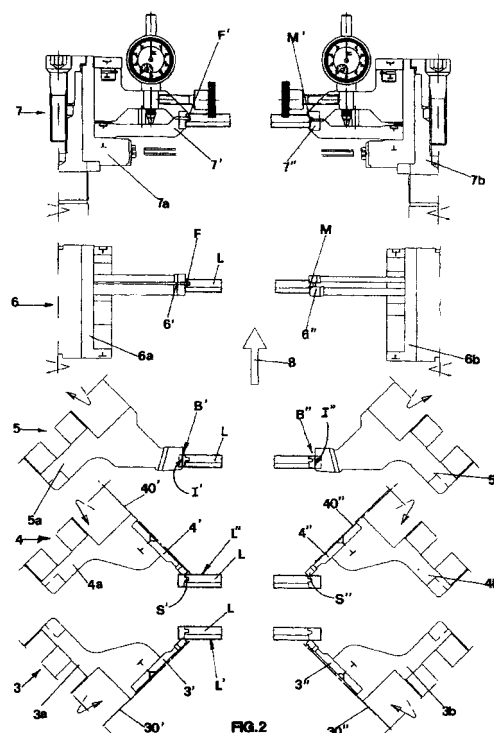

EP 1 048 423 A3



European Patent
Office

EUROPEAN SEARCH REPORT

Application Number
EP 00 10 8072

DOCUMENTS CONSIDERED TO BE RELEVANT			
Category	Citation of document with indication, where appropriate, of relevant passages	Relevant to claim	CLASSIFICATION OF THE APPLICATION (Int.Cl.7)
X	CH 249 680 A (STALDER ADOLF) 15 July 1947 (1947-07-15) * the whole document *	1-7	B27M1/08 B27F1/06 B27M3/04 E04F15/10
A	FR 686 874 A (PANHARD ET LAVASSOR) 3 September 1930 (1930-09-03) * page 2, line 21 - line 40 * * page 2, line 63 - line 68; figures 4-6 *	1,7	
			TECHNICAL FIELDS SEARCHED (Int.Cl.7)
			B27M B27F E04F
The present search report has been drawn up for all claims			
Place of search THE HAGUE		Date of completion of the search 17 July 2001	Examiner Huggins, J
<p>CATEGORY OF CITED DOCUMENTS</p> <p>X : particularly relevant if taken alone Y : particularly relevant if combined with another document of the same category A : technological background O : non-written disclosure P : intermediate document</p> <p>T : theory or principle underlying the invention E : earlier patent document, but published on, or after the filing date D : document cited in the application L : document cited for other reasons & : member of the same patent family, corresponding document</p>			

EPO FORM 1503 03 92 (P04C01)

**ANNEX TO THE EUROPEAN SEARCH REPORT
ON EUROPEAN PATENT APPLICATION NO.**

EP 00 10 8072

This annex lists the patent family members relating to the patent documents cited in the above-mentioned European search report. The members are as contained in the European Patent Office EDP file on
The European Patent Office is in no way liable for these particulars which are merely given for the purpose of information.

17-07-2001

Patent document cited in search report	Publication date	Patent family member(s)	Publication date
CH 249680 A	15-07-1947	NONE	
FR 686874 A	03-09-1930	NONE	

EPO FORM P0459

For more details about this annex : see Official Journal of the European Patent Office, No. 12/82