

(19)



Europäisches Patentamt

European Patent Office

Office européen des brevets



(11)

EP 1 057 985 A1

(12)

EUROPEAN PATENT APPLICATION

(43) Date of publication:

06.12.2000 Bulletin 2000/49(51) Int Cl.7: **F02B 63/04, F02G 5/02**(21) Application number: **99201730.1**(22) Date of filing: **31.05.1999**

(84) Designated Contracting States:

**AT BE CH CY DE DK ES FI FR GB GR IE IT LI LU
MC NL PT SE**

Designated Extension States:

AL LT LV MK RO SI(71) Applicant: **Nortron ApS****6800 Varde (DK)**(72) Inventor: **Nordentoft, Torsten****6800 Varde (DK)**(74) Representative: **Elmeros, Claus****Patentgruppen ApS,****Arosgaarden,****Aabouvarden 23, 5.****8000 Aarhus C (DK)**(54) **Compact power generation apparatus and method of generating energy**

(57) The present invention relates to a compact power generation apparatus for the generation of energy for powering various appliances, such as domestic appliances, comprising a housing accommodating an air cooled internal combustion engine, generator driven by the engine for the generation of electrical power, an exhaust system, an inlet communicating with an outlet and flow generating means for circulating a cooling air flow through and around the generator, the engine and

the exhaust, wherein heat exchanging means are provided for extracting heat from the exhaust system and from the circulating air flow and passing said extracted heat on to a utility medium, such as air or water for utility purposes. Moreover, the invention relates to a method of generating energy, a method of automated power management of a compact power generation apparatus, and a power management system for carrying out this method.

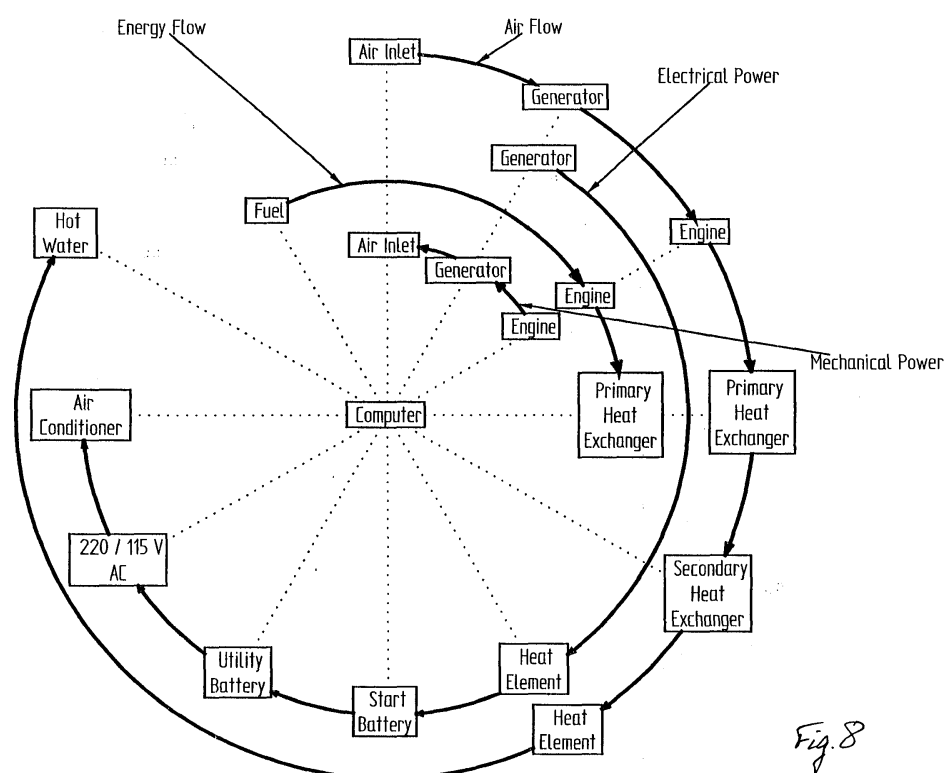

Fig. 8

EP 1 057 985 A1

Description

[0001] The present invention relates to a compact power generation apparatus according to the preamble of claim 1. The invention further relates to a method of generating energy, a method of automated power management of a compact power generation apparatus, and a power management system for carrying out this method.

[0002] Small generators and accessories such as small heaters and battery chargers are products which are used in a wide field of applications. Such type of small generator can be used for powering a heater and other electrical appliances in e.g. trucks, leisure boats, mobile homes, caravans, for military purposes, in crises zones and other areas where normal electrical power and heat sources are not available.

[0003] The generator is driven by an internal combustion engine for the generation of electrical power. This power can be used for powering various electrical devices, such as electrical heaters, lights, pumps, etc. and air conditioning installations.

[0004] The combustion engine in the generator can be air cooled, such as e.g. known from GB-A-2 213 201, US-A-4,835,405, US-A-4,608,946 or DE-A1-35 11 123. A constant flow of air is generated around the engine and the generator in order to remove the surplus heat, preventing the engine and the generator from overheating. The flow passages of the cooling air are designed in such a way that the noise from the engine is reduced. Also a silencer such in the exhaust is installed, and a protective, soundproof cover is fitted around the unit, in order to reduce the noise emission from the generator unit. Most devices are controlled by regulating the revolutions per minute of the engine and thus the frequency of the output. A small fuel tank is installed allowing for a few hours of operation. An exhaust silencer is fitted for noise reduction purposes.

[0005] For the provision of heat, heaters are known that consist of a hot chamber in which the fuel is consumed and a fan provides air for the combustion. A small fuel pump which is controlled by basic control electronics control the amount of fuel. The associated control panel is typically a timing device, which will allow a timed start and stop.

[0006] Battery chargers normally consist of a transformer which is designed such that when a certain charging voltage has been reached, the current will be close to zero and thus providing a simple charging mechanism. Unfortunately, the point where a battery is considered fully charged varies considerably with the temperature and rarely the batteries are charged properly causing a substantial wear on the batteries and a low life time.

[0007] In boats, trucks, mobile homes etc. the increasing power consumption due to the increase in the amount of equipment such as micro wave ovens, heaters, television, etc. require large battery capacity and

large battery chargers in order to provide adequate battery charging when power is available.

[0008] In trucks for example, the need for battery charging, air conditioning and heating, when the main engine is not running, is real. The heating can be solved by using a small diesel powered heater which consumes considerable DC power when in use and thus increases the need for battery charging even more. Air conditioning is only possible to have while the main engine is running and truck drivers must tolerate ambient temperatures when resting.

[0009] From e.g. US-A-5,433,175 an engine generator is known where a water cooled diesel engine for driving the generator. The use of water as coolant provides an efficient cooling in a compact system, just as the water cooling system in addition provides a noise reducing effect. Other water cooled diesel solutions are also known in particular for maritime purposes, that exhibits an excellent noise reduction and thus an extremely silent and compact generator.

[0010] However, these water cooled generators generally have a low efficiency. Moreover, a water cooling system is quite heavy as water connections, flow channels and air coolers must be present. This makes the water cooled generators both heavy and somewhat bulky and thus less suitable for purposes where frequent transportation is needed.

[0011] The low efficiency is a rather generic problem by an engine as well as by a generator. In the conversion from one energy source to another, energy is lost. In the engine where the fuel is combusted, in the transmission between the engine and the generator and in the conversion of mechanical energy into electrical power in the generator. Insufficient cooling and poor air supply and circulation into and around the engine are also factors contributing to a poor overall performance of a power generation apparatus. However, the reduction of the noise emission of the small generator usually causes some amount of decrease in efficiency of the power output, although many solutions attempts to minimise this efficiency decrease.

[0012] The efficiency is also decreased in the subsequently connected electrical appliances, and current small diesel powered generators only convert 20-30% of the total available power into electrical power. The remaining energy in the form of heat is wasted.

[0013] The object of the present invention is to provide a solution to these above identified problems and other problems associated with the prior art solutions and to provide a compact power generation apparatus. It is a further object of the invention to provide a method of generating energy and managing the power generation in a compact power generation apparatus.

[0014] This object is achieved by a compact power generation apparatus of the initially mentioned kind, wherein heat exchanging means are provided for extracting heat from the exhaust system and from the circulating air flow and passing said extracted heat on to

a utility medium, such as air or water for utility purposes.

[0015] By the present invention a compact power generation apparatus is provided that can produce several types of energy outputs for the consumption in e.g. cabins of trucks, boats and recreation vehicles. By producing both electrical and heat energy for the consumption, the electrical energy need not be converted further in order to produce heat. This means that the efficiency in the production of heat is improved compared to the generator-sets known in the art. The heat energy that previously was considered a waste produce, can now be recovered and used for e.g. heating purposes, such as hot water or hot air. By cooling the exhaust air, the air volume is reduced and thus the noise level is reduced.

[0016] By making use of the available energy, including the normally wasted heat, the efficiency of a compact power generation apparatus according to the invention can be increased immensely.

[0017] In the preferred embodiment of a compact power generation apparatus according to the invention, the flow generating means involves means for generating an air flow through the generator, the engine and/or the heat exchanging means. This ensures a sufficient amount of air supply for the engine to run smoothly and a good cooling effect.

[0018] In the preferred embodiment the housing is provided with an inner and an outer chamber, said chambers being connected by a spacing divided into channels, said inner chamber accommodating the engine, generator and heat exchanging means. The channels between the inner and outer chamber can moreover be covered in sound absorbing material. Hereby a good cooling air circulation is provided that also provides a noise reduction of the power generation apparatus.

[0019] The inner chamber is in a preferred embodiment diverted into a number of channels, in which the cooling air can circulate by the assistance of a first and second fan that are provided in the inner chamber, in such a way that the inner chamber exhibits a cool section between the two fans and a hot section after the second fan. Hereby an efficient cooling is provided by the circulating air. By providing a slight over pressure in the cold section where the air intake is located, a super charging effect can be provided for the engine.

[0020] In the preferred embodiment, the first fan is a fly wheel mounted on the shaft of the generator forcing air through and around the generator. The second fan is preferably mounted by the air intake of the engine, preferably as a part of the fly wheel of the engine, and the first and second fan are so dimensioned that an relative higher pressure than the ambient pressure is present in the cold section. This solution provides an satisfactory air circulation in a simple manner.

[0021] The heat exchanging means in a power generation apparatus according to the invention comprises in the preferred embodiment of the invention, a first heat exchanger and second heat exchanger, the first heat ex-

changer extracting the heat from the exhaust system and heating the circulating cooling air, and the second heat exchanger separating the heat from the hot circulating air, and fresh air. The first heat exchanger could preferably be an exhaust silencer, possibly in a design where a substantial flow resistance in the exhaust is present in such a way that the design is suitable for extracting the heat from the exhaust. By the two heat exchangers the heat can safely be extracted from both the exhaust and the hot utility air, i.e. both the air that flows through and around the engine and the generator. By collecting the heat in the hot utility air and extracting it therefrom in the second heat exchanger that is an air to air and/or water heat exchanger. The second heat exchanger can also be provided with means for water heating and comprises an auxiliary electrical heat element and a fan. This means that the power generation apparatus according to this embodiment of the invention can also provide hot air or hot water, since the second heat exchanger can be powered by electricity.

[0022] In the preferred embodiment the power generation apparatus includes battery charging means. The battery or batteries can be charged when the engine is running. This charging can be controlled automatically according to the load on the engine and the present demand for power at the power outputs of the power generation apparatuses, and the actual need for charging.

[0023] The internal combustion engine is in the preferred embodiment a diesel engine, but it is realised that other combustion engines, such as a petrol- or gas-driven engine or a gas turbine could be used alternatively.

[0024] In a second aspect of the invention the invention comprises a method of generating energy in a compact power generation apparatus, said method comprising the steps of combusting a fuel, such as diesel oil, petrol, gas or the like, from a fuel source in an internal combustion engine, converting the potential energy of the fuel into mechanical power is generated together with the generation of heat, converting said mechanical power into electrical power in a generator, and into an air flow through an air inlet and through and around the generator and the engine, absorbing the heat generated by the combustion in the engine and the generator in at least a part of the air flow, and extracting the heat in heat exchanging means and passing said heat on to a utility medium, such as air or water for utility purposes.

[0025] A method according to this aspect of the invention, enables the extraction of several sources of energy from a compact power generation apparatus in a consumable form. this means that the overall efficiency is increased, and that a compact power generation apparatus making use of this method becomes self-contained, as no external units must be connected to the generator in order to secure the supply of energy needed on the site.

[0026] In the preferred embodiment of the invention the at least one battery, such as a utility and/or a start battery is charged by the electrical power generated by

the generator.

[0027] The electrical power generated by the generator is in a preferred embodiment converted into a utility AC voltage, such as 220/115 V AC, so that the power generation apparatus can substitute a normal power connected to the net of a household appliance, such as a coffee machine, a micro wave oven, etc. Preferably two further electric power outputs are present, providing 12/24 VDC 60/30 Amp for utility battery charging, and 12/24 VDC 10/5 Amp for start battery charging.

[0028] According to a method according to the invention, air conditioning can also be carried out by electrically powered air conditioning means. This means that the temperature in a cabin or the like where the power generation apparatus is placed, can be controlled. A thermostat could also be connected to the control system of the power generation apparatus, making it possible to control the room temperature by altering between the use of an air conditioner and the air to air heat exchanging means. The heat exchange is done in two stages, such as described above: a first heat exchange is carried out extracting heat from the exhaust system and absorbing said heat in the air flow, and a second heat exchange is carried out extracting heat from the air flow and passing the heat on to the utility medium.

[0029] In a further aspect of the present invention a power management system and a method of automated power management of a compact power generation apparatus, such as a power generation apparatus and a method according to the previous described aspects. The method of automated power management comprises the steps of sensing the load on the engine, registering the demand for electrical and mechanical power, and feeding these measurements to a power management means involving computer means connected to regulation means, and regulating the power generation and distributing said available power according to the registered need for electrical power and mechanical power, respectively.

[0030] Hereby the power generation apparatus can be operated automatically facilitating the operation of the power generation apparatus.

[0031] According to a preferred embodiment of said method, the registration of the power demand includes registering the capacity of the at least one battery, and that available power is regulated according to the demand for electrical and mechanical power.

[0032] The power management can automatically start and stop the engine according to present demands.

[0033] The invention further comprises a power management system for carrying out the method according to the third aspect of the present invention, where said system comprises sensor means for measuring the performance and/or characteristics of one or more energy conversion elements of the power generation apparatus, registration means for determining the presently required output of electrical and mechanical power from

the power generation apparatus, and computer means for controlling one or more regulation means of the energy conversion means for adapting the kinds of generated power of the power generation apparatus according to the actual demands.

[0034] According to a preferred embodiment, the present power load on the generator is sensed, and that the power management according to the available power is determined according to a program containing a predetermined set of priorities. The power distribution can hereby be governed by a software in the computer. This software can be designed according to the area of operation, such as the climate, etc. that the miniature power generation apparatus is intended for.

[0035] The computer means preferably comprises a user interface for monitoring the power management and for entering user specified operation characteristics in the power management. Hereby it is possible to monitor the condition of the system, e.g. if a component is worn.

[0036] The power management system involves both electrical and heat power management, sensing the temperatures of the heat exchanging means and the air inlet of the power generation apparatus.

[0037] The invention is in the following described in more detail with reference to a specific embodiment of the invention and with reference to the accompanying drawings on which

fig. 1 is an exploded view of a power generation apparatus according to a preferred embodiment of the invention,
fig. 2 is a side view of the inner chamber of the power generation apparatus,
fig. 3 is an end view thereof,
fig. 4 is a perspective view of the inner chamber of the power generation apparatus,
fig. 5 is the same viewed from the other end,
fig. 6 is a schematic view of the second heat exchanger,
fig. 7 is a schematic diagram of the power management system according to the invention,
fig. 8 is a schematic illustration of the energy flow in a power generation apparatus according to a preferred embodiment of the invention, and
fig. 9 is a block diagram of the central control computer of the power management system according to a preferred embodiment of the invention.

[0038] With reference to figures 1 to 5 a miniature automated power generation is shown. The apparatus comprises an inner chamber and an outer chamber. The inner chamber contains an internal combustion engine 12, a generator 17, an auxiliary fuel tank 13 and a first heat exchanger 5, 15. This first heat exchanger 5, 15 is a special exhaust silencer cooling the exhaust air from the engine 12 by the extracting the heat from the ex-

haust and passing it onto a circulating air flow in the inner chamber. The cooling reduces the air volume of the exhaust air and thus the noise level.

[0039] The inner chamber is built on a base platform comprising a base plate 10 of metal and an oil sump 11. Onto said base plate 10 the vibration and noise generating components are mounted. The weight of the base plate 10 is such that it acts as a counter weight to the vibrating parts. The base plate 10 under the engine is hollow and contains part of the oil sump 11. this feature allows long engine operation between oil change and provides continuous lubrication during tilt up to and in excess of 30 degrees, both in pitch and roll. This base plate 10 is mounted on a frame 1 which in turn is based on a vibration reducing mat 2. This mat is placed inside the outer chamber base plate 4 and thus provides vibration isolation between the inner and outer chamber.

[0040] The noise and vibration generating components are all arranged in the inner chamber, including the air intake and the drive transmission belt (not shown) between the engine 12 and the generator 17 that are arranged next to and parallel to each other. To the rear end of the generator shaft is mounted the primary fan 16. The primary fan air intake 18 is through a channel which is formed in the inner chamber wall 14 and the outer chamber wall 3 (not shown in figs 2-5 for illustrative purposes). This channel is coated with a noise reducing foam or similar coating, so that a noise isolation between the inner chamber and the outside is provided.

[0041] The air from the primary fan 16 is forced through and around the generator 17, past the belt drive and up to the second fan 9 mounted on the engine 12. The space between the two fans 9, 16 is the cold section of the inner chamber and in which an over pressure in relation to the outside atmospheric pressure is present due to the design characteristics of the fans 9, 16. The air intake of the engine 12 is located in this area and the engine is thereby provided with a super charging effect improving the performance of the engine 12. The generator 17 has an internal fan which provides internal ventilation. The second fan 9 is also the fly wheel to which an electric starter motor is attached. The over pressure in the cold section helps the second fan to force the air through the engine 12. The heated air from the engine 12 is then forced through the primary heat exchanger or heat recovery unit 5. The exhaust from the engine 12 is also forced through the primary heat exchanger 5 whereby the heat from the exhaust is recovered. the hot air after the primary heat exchanger 5 is passed through a channel which is formed between the inner chamber 7 and the outer chamber 3. This channel is coated with a noise reducing foam and thus provide noise isolation between the inner chamber and the outside.

[0042] Externally mounted on the outer chamber 3 is the secondary heat exchanger 6. The second heat exchanger 6 is an air to air and air to water exchanger, see fig. 6. It comprises a hot air inlet 19 receiving the hot air

from the first heat exchanger 5, an air outlet 22 for the air output for the air from the first heat exchanger 5, an air outlet 23 for heated fresh air, a water inlet 24 for cold water and a water outlet 25 for hot water. Moreover, the second heat exchanger 6 also comprises an electric fan 21 and an electric heat element 20. The electric fan provides fresh air flow through the second heat exchanger 6. This air can be used for heating. The electric heat element is used by the computer 15 of the power management system to provide a load on the engine and thus increase heat generation when no other load or insufficient load compared with the demand is present.

[0043] A small internal fuel tank 13 such as a tank containing 200 ml fuel is mounted on the side of the engine 12. This is to prevent air in the fuel system when connecting an disconnecting the power plant (or MAPS: Miniature Automated Power System) from fixed installations. It also provides emergency start and limited operation capability in case of total power failure.

[0044] The central control computer 15 is located together with other electronics in a none vibration enclosure which is attached to the outer chamber 3. The computer provides automated start and stop of the MAPS and distributes the total available power according to a set of rules in the software. Fig. 7 shows schematically the various power output from the energy source 12 that are managed by the control computer 15. These power output are: hot air 23 and hot water 25, AC power output 27, preferably 220 V AC 2200 W per demand, an air conditioner 26, temperature compensated utility battery charging 28 and temperature compensated start battery charging 29. It also provides service management and failure identification. The load on the A/C power output is monitored and if a load is present, the computer initiates a start sequence. The fuel pump of the engine is activated, a servo motor drives a stop lever to an operate position and the starter motor is engaged. The A/C power output from the generator 17 is monitored. When the generator reaches 40 % below normal RPM it starts generating current and when this is sensed by the computer, the starter motor is disengaged.

[0045] If nothing is sensed after a pre-determined period of time, the starter motor is also disengaged. After a certain time period, preferably defined in the software e.g. one minute, another start is attempted. this will continue to either a start is successful or a certain number of attempts have been made, said number preferably being defined in the management software, e.g. five attempts. If unsuccessful, a service lamp on the control panel will light and a failure code indicating the type of failure will be displayed on the display.

[0046] A number of causes can initiate a start sequence: a) A/C power load, b) low voltage on either battery charging circuits, c) manual start request, d) heat request, e) air conditioning request. The battery charging circuits are divided into two separate systems, a 12 Volt/60 Amp or 24 Volt/30 amp, and a 12 Volt/10 amp or 24 volt/5 amp circuit.

[0047] Each circuit has separated sensing means located at each set of batteries, that will sense the temperature and voltage. Using this information the computer will initiate a start sequence when the batteries are considered discharged and provide automated battery charging according to a dynamic charging profile. This provides optimum charging and reduces the charging time.

[0048] The load management is done by measuring the total load on the generator. If the load increases beyond the allowable maximum, loads will be disconnected according to a set of rules in the software, where the air conditioning has lowest priority and the battery charging has the highest.

[0049] If heat is requested and no load or insufficient load is present, the computer will provide load to the engine by using the heat element 21 in the second heat exchanger 6. This load is dynamically controlled and determined by the amount of heat requested and the load present by other requirements, such as battery charging.

[0050] When there is no heat or air conditioning requirement, load on the A/C power or battery charging circuits, the engine will shut down unless a power management becomes valid within a pre-determined time period, e.g. determined in the MAPS software, e.g. three minutes.

[0051] In figure 8, the energy flow by a MAPS according to the invention and the division into different types of energy is illustrated. A portable miniature, silent, automated power plant according to the preferred embodiment of the invention provides from 100 % energy, 70 % utility heat, 10 % waste heat and 20 % mechanical movement. The mechanical movement is used to drive the generator.

[0052] As displayed in the graphic circuit "Energy Flow" fuel is combusted in the engine that hereby produces heat in the exhaust system. The engine further drives the generator, as shown in the "mechanical Power" graphic circuit. The generator drives a fan of the air intake, initiating the "Air Flow" energy circuit. The generator also produces electrical power, as indicated by the "Electrical Power" graphic display.

[0053] The "Air Flow" provides cooling to the generator and air for the engine. The air flows through the primary heat exchanger where the surplus heat from the exhaust is collected in the air flow, that then continues through the secondary heat exchanger and over the electrically driven heat element, that can apply further heat according to the demand for hot water or hot air.

[0054] The heat element is driven by the electric power generated in the generator, as shown by the "Electric Power" flow. The electric power is also distributed to the start battery, the utility battery, the AC power output and to the air conditioner.

[0055] All the energy consuming and energy generating components are managed by the central control computer. In fig. 9 a block diagram of the preferred de-

sign of the central computer is shown. The computer is provided with a display for monitoring the status of the power management, conditions and possible failures of individual components. Associated with the display a control panel is present for manual input of control data.

Claims

1. A compact power generation apparatus for the generation of energy for powering various appliances, such as domestic appliances, comprising

a housing accommodating

an air cooled internal combustion engine,

a generator driven by the engine for the generation of electrical power, an exhaust system,

an inlet communicating with an outlet and flow generating means for circulating a cooling air flow through and around the generator, the engine and the exhaust,

characterised in that

heat exchanging means are provided for extracting heat from the exhaust system and from the circulating air flow and passing said extracted heat on to a utility medium, such as air or water for utility purposes.

2. A compact power generation apparatus according to claim 1, wherein the flow generating means involves means for generating an air flow through the generator, the engine and/or the heat exchanging means.

3. A compact power generation apparatus according to claim 1 or 2, wherein the housing is provided with an inner and an outer chamber, said chambers being connected by a spacing divided into channels, said inner chamber accommodating the engine, generator and heat exchanging means.

4. A compact power generation apparatus according to claim 3, wherein said channels between the inner and outer chamber are covered in sound absorbing material.

5. A compact power generation apparatus according to any of the claims 3 or 4, wherein the inner chamber is diverted into a number of channels, in which the cooling air can circulate by the assistance of a first and second fan that are provided in the inner chamber, in such a way that the inner chamber exhibits a cool section between the two fans and a hot section after the second fan.

6. A compact power generation apparatus according to claim 5, wherein first fan is a fly wheel mounted on the shaft of the generator forcing air through and around the generator.
7. A compact power generation apparatus according to claim 5 or 6, wherein the second fan is mounted by the air intake of the engine, preferably as a part of the fly wheel of the engine.
8. A compact power generation apparatus according to the claim 7, wherein the first and second fan are so dimensioned that an relative higher pressure than the ambient pressure is present in the cold section.
9. A compact power generation apparatus according to any of the previous claims, wherein the heat exchanging means comprises a first heat exchanger and second heat exchanger,
- the first heat exchanger extracting the heat from the exhaust system and heating the circulating cooling air, and
- the second heat exchanger separating the heat from the hot circulating air, and fresh air.
10. A compact power generation apparatus according to claim 9, wherein the first heat exchanger is an exhaust silencer.
11. A compact power generation apparatus according to claim 9 or 10, wherein the second heat exchanger is provided with means for water heating and comprises an auxiliary electrical heat element and a fan.
12. A compact power generation apparatus according to any of the previous claims, wherein the power generation apparatus includes battery charging means.
13. A compact power generation apparatus according to any of the previous claims, wherein the internal combustion engine is a diesel engine.
14. A method of generating energy in a compact power generation apparatus according to any of the claims 1-13, comprising the steps of
- combusting a fuel, such as diesel oil, petrol, gas or the like, from a fuel source in an internal combustion engine, converting the potential energy of the fuel into mechanical power is generated together with the generation of heat,
- converting said mechanical power into electrical power in a generator, and into an air flow
- through an air inlet and through and around the generator and the engine,
- absorbing the heat generated by the combustion in the engine and the generator in at least a part of the air flow, and
- extracting the heat in heat exchanging means and passing said heat on to a utility medium, such as hot air or hot water for utility purposes.
15. A method according to claim 14, where at least one battery, such as a utility and/or a start battery is charged by the electrical power generated by the generator.
16. A method according to claims 14 or 15, where the air flow can be heated by a electric heat element.
17. A method according to any of the claims 14 to 16, where the electrical power generated by the generator is converted into a utility AC voltage, such as 220/115 V AC.
18. A method according to any of the claims 14 to 17, where air conditioning is carried out by electrically powered air conditioning means.
19. A method according to any of the claims 14 to 18, where a first heat exchange is carried out extracting heat from the exhaust system and absorbing said heat in the air flow, and a second heat exchange is carried out extracting heat from the air flow and passing the heat on to the utility medium.
20. A method of automated power management of a compact power generation apparatus, such as a power generation apparatus according to any of the claims 1-13 for carrying out a method according to any of the claims 14 to 18, carrying out the following steps:
- sensing the load on the engine,
- registering the demand for electrical and mechanical power, and
- feeding these measurements to a power management means involving computer means connected to regulation means,
- regulating the power generation and distributing said available power according to the registered need for electrical power and mechanical power, respectively.
21. A method according to claim 20, where the registration of the power demand includes registering the

capacity of the at one battery, and that available power is regulated according to the demand for electrical and mechanical power.

- 22.** A method according to claim 21, where the power management automatically and start and stop the engine according to present demands. 5
- 23.** A power management system for carrying out a method of automated power management of a compact power generation apparatus according to any of the claims 20 to 22, such as a method of generating energy according to any of the claims 14 to 19, said power management system comprising 10
- sensor means for measuring the performance and/or characteristics of one or more energy conversion elements of the power generation apparatus, 15
- registration means for determining the presently required output of electrical and mechanical power from the power generation apparatus, and 20
- computer means for controlling one or more regulation means of the energy conversion means for adapting the kinds of generated power of the power generation apparatus according to the actual demands. 25 30
- 24.** A power management system according to claim 23, wherein the present power load on the generator is sensed, and that the power management according to the available power is determined according to a program containing a predetermined set of priorities. 35
- 25.** A power management system according to claim 24, wherein the computer means comprises a user interface for monitoring the power management and for entering user specified operation characteristics in the power management. 40
- 26.** A power management system according to claim 23 to 25, wherein the power management system involves both electrical and heat power management, sensing the temperatures of the heat exchanging means and the air inlet of the power generation apparatus. 45 50

55

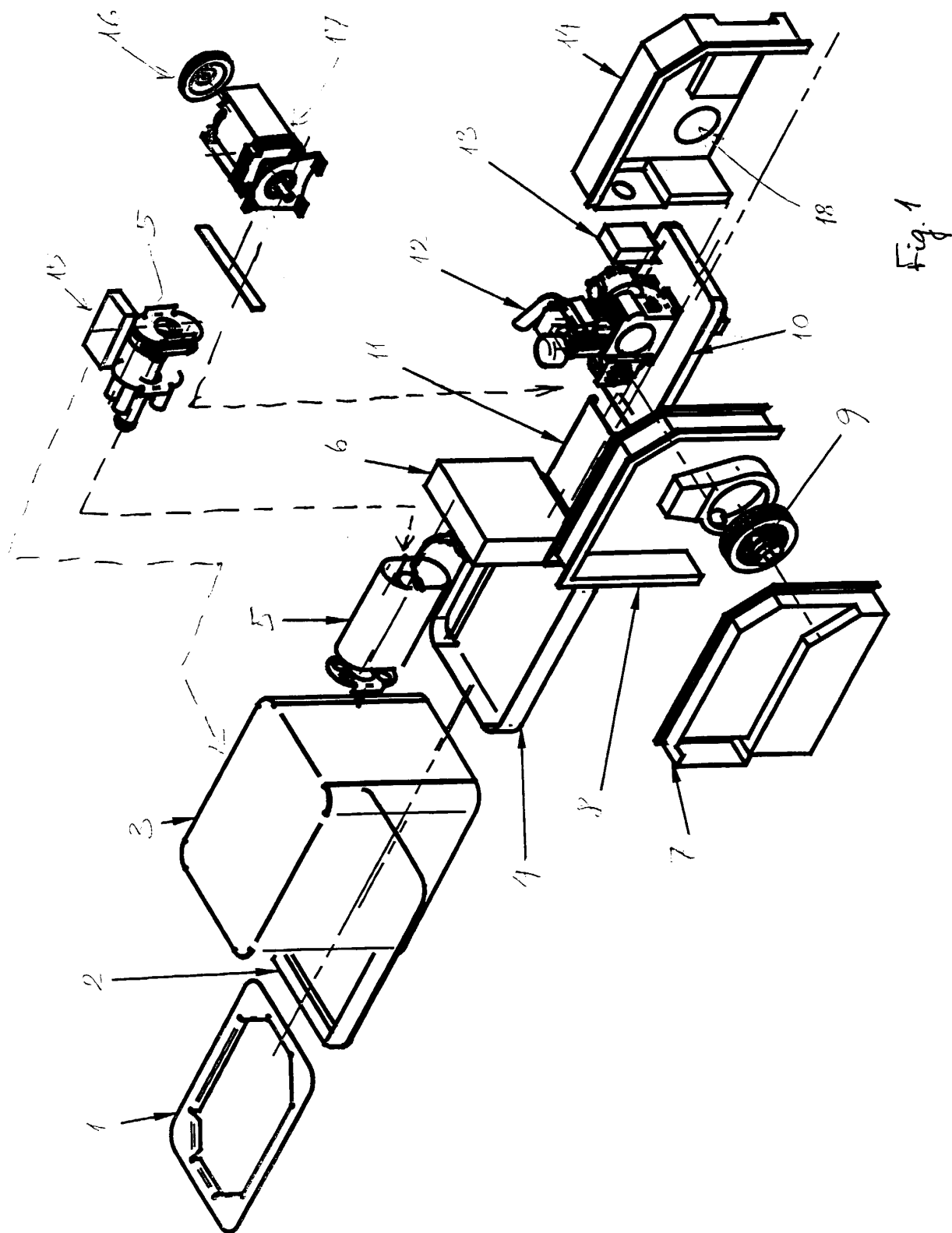

Fig. 1

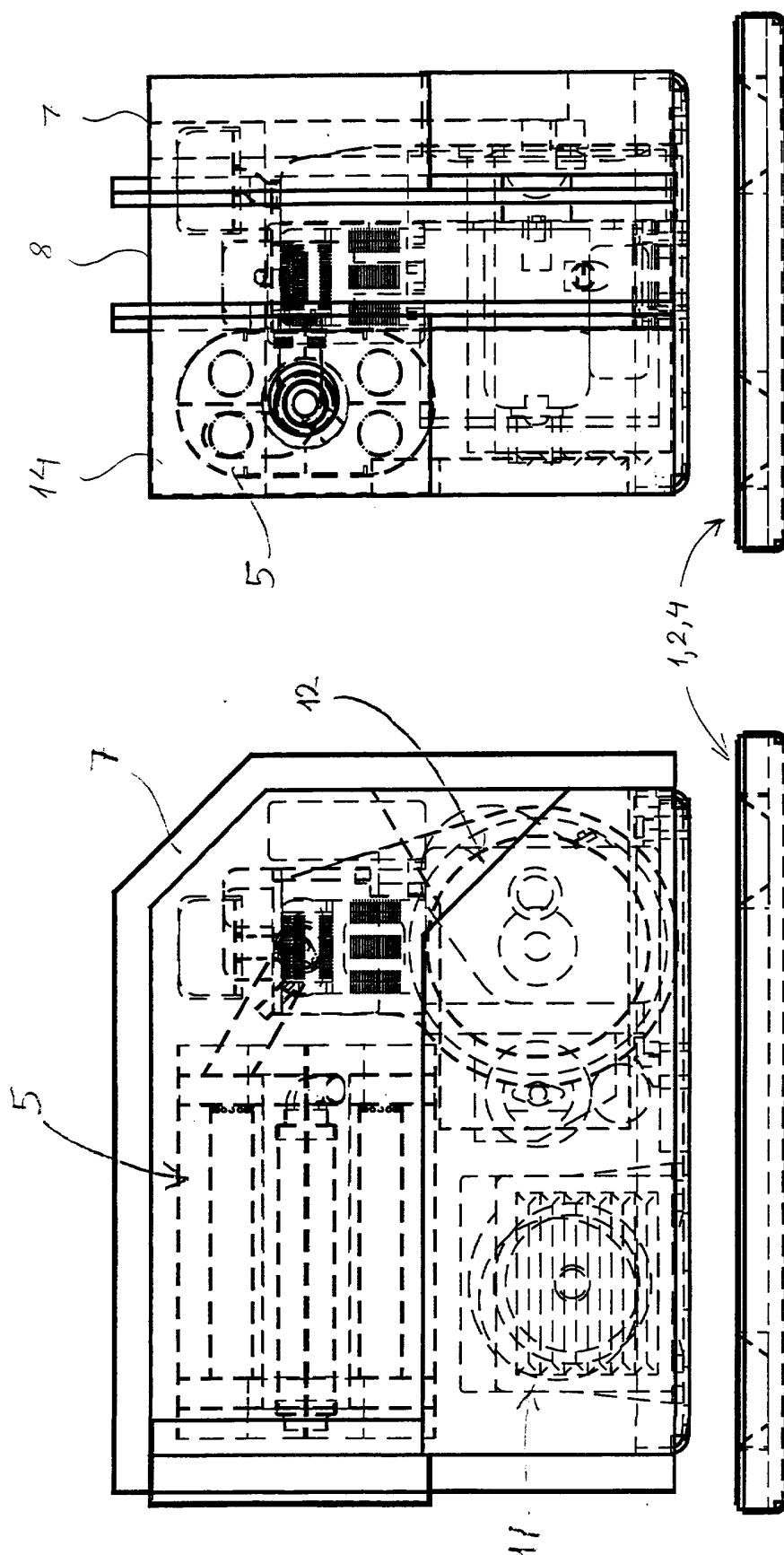

Fig. 3

Fig. 2

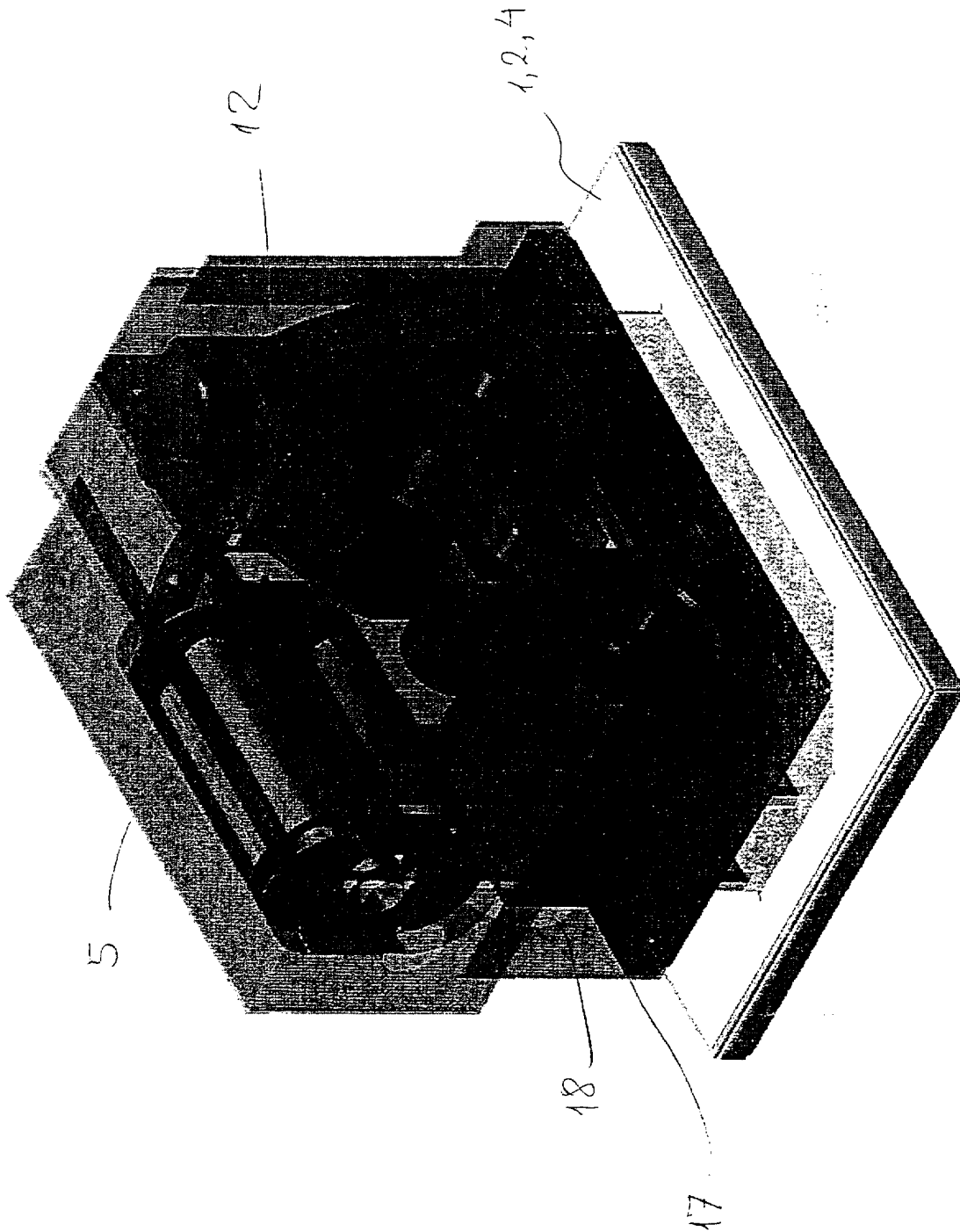
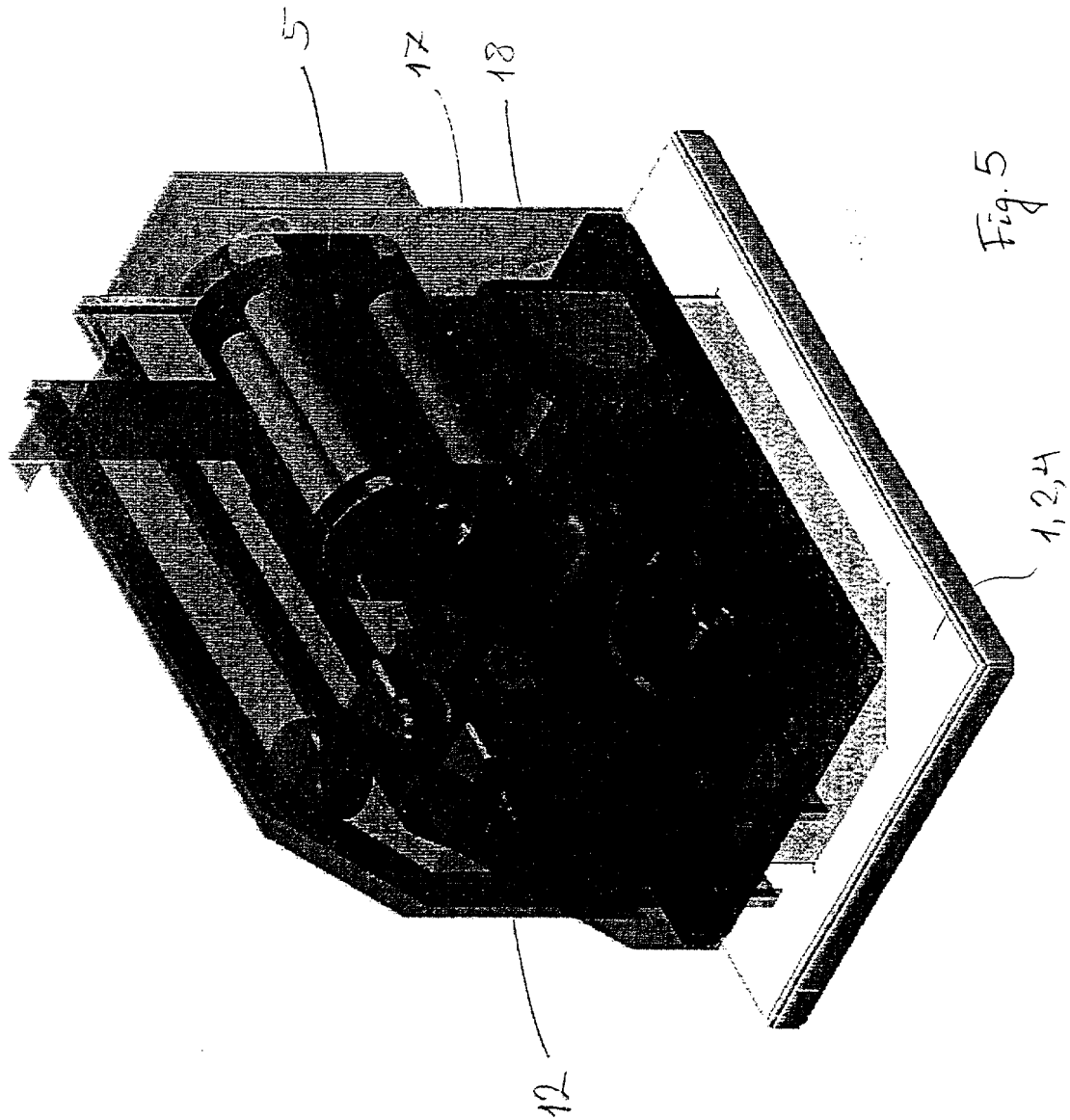
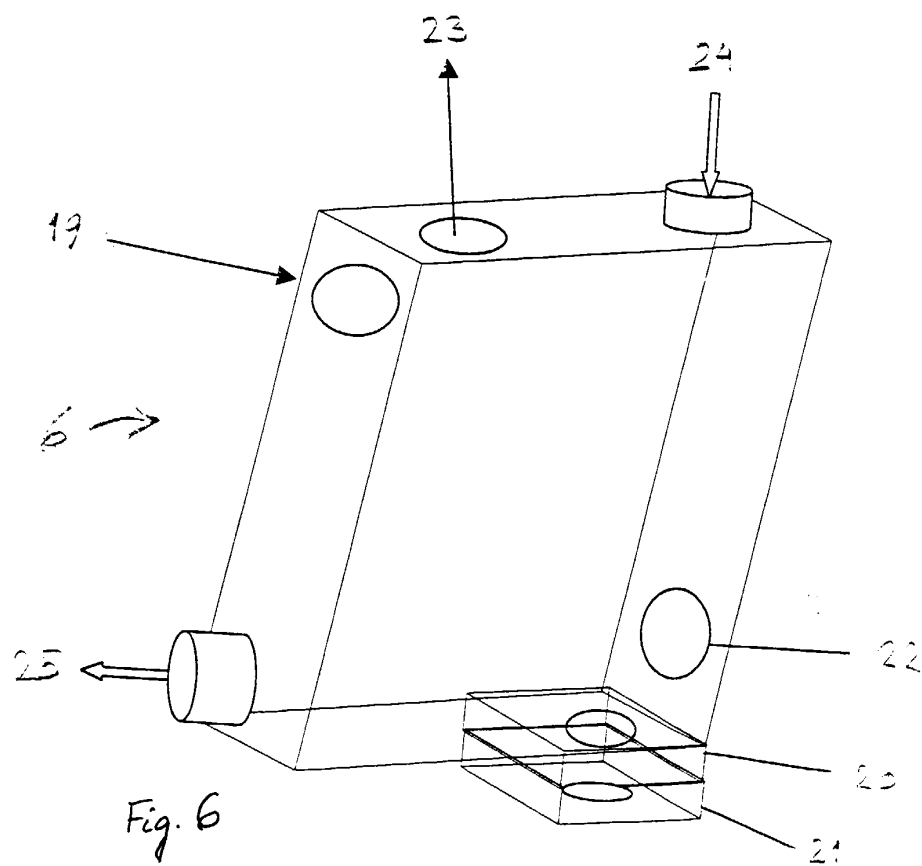
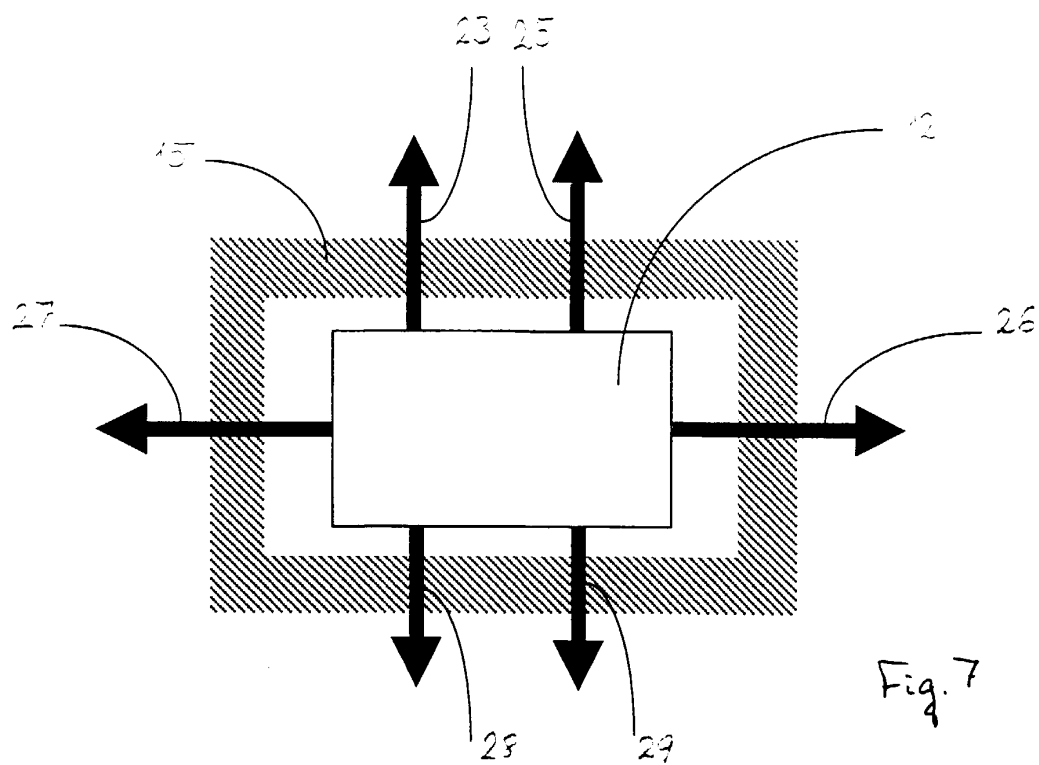

Fig. 4





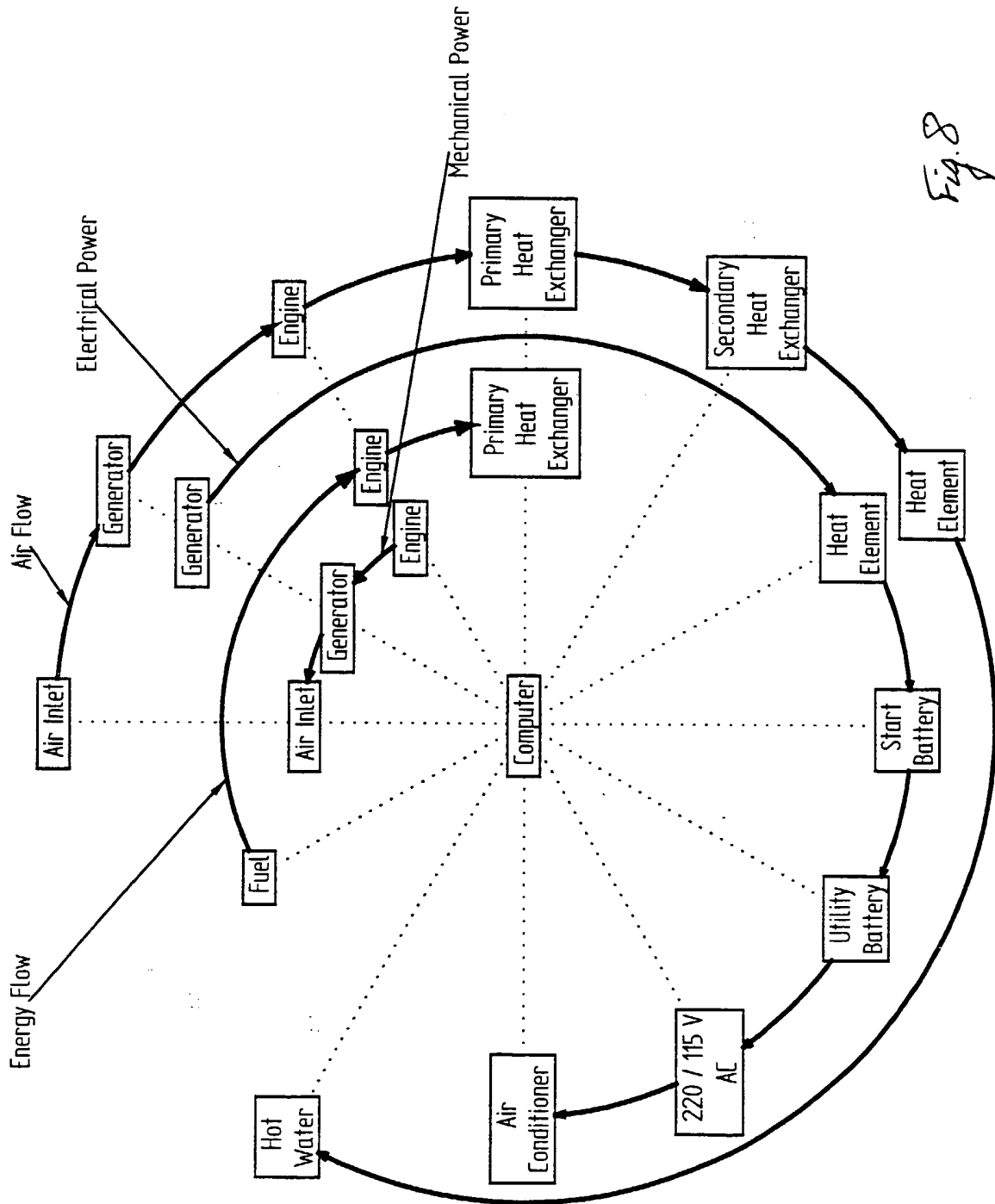

Fig. 8

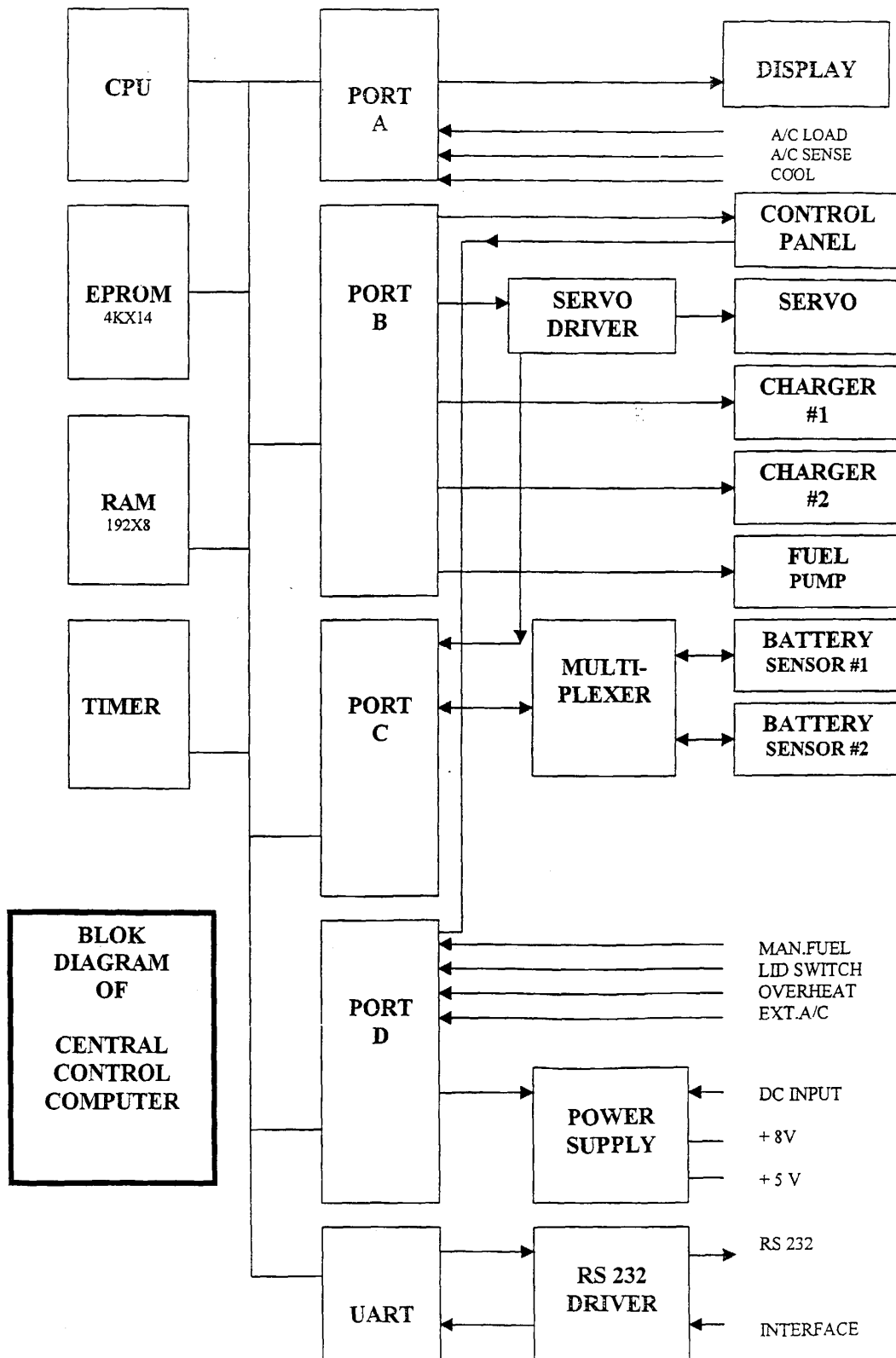

Fig. 9



European Patent
Office

EUROPEAN SEARCH REPORT

Application Number
EP 99 20 1730

DOCUMENTS CONSIDERED TO BE RELEVANT			
Category	Citation of document with indication, where appropriate, of relevant passages	Relevant to claim	CLASSIFICATION OF THE APPLICATION (Int.Cl.7)
X	US 5 014 660 A (WESTERBEKE JR JOHN H) 14 May 1991 (1991-05-14) * figure 1 * * abstract * * column 2, line 39 - line 59 * * column 3, line 1 - line 26 *	1,2,14	F02B63/04 F02G5/02
A	---	20	
X	DE 298 12 982 U (SCHAKO METALLWARENFABRIK) 29 October 1998 (1998-10-29) * figures 1-3 * * abstract * * claims 1-18 *	1,2,14, 20	
A	---		
A	US 5 617 504 A (SCIACCA THOMAS ET AL) 1 April 1997 (1997-04-01) * figure 1 * * abstract * * column 3, line 15 - column 4, line 67 *	1-5,14, 20,23	
A	PATENT ABSTRACTS OF JAPAN vol. 016, no. 083 (M-1216), 28 February 1992 (1992-02-28) & JP 03 267555 A (YANMAR DIESEL ENGINE CO LTD), 28 November 1991 (1991-11-28) * abstract *	1,2,14, 20	TECHNICAL FIELDS SEARCHED (Int.Cl.7) F02B F02G
A	---		
A	EP 0 268 726 A (LINDEN CRAIG L) 1 June 1988 (1988-06-01) * figure 1 * * abstract * * claims 1-14 *	1,2,14, 20,23	
A	---		
A	US 5 890 460 A (BALL RONALD C ET AL) 6 April 1999 (1999-04-06) * figures 1-3 * * abstract * * claims 1-12 *	1-9	
The present search report has been drawn up for all claims			
Place of search THE HAGUE		Date of completion of the search 28 October 1999	Examiner Wassenaar, G
<p>CATEGORY OF CITED DOCUMENTS</p> <p>X : particularly relevant if taken alone Y : particularly relevant if combined with another document of the same category A : technological background O : non-written disclosure P : intermediate document</p> <p>T : theory or principle underlying the invention E : earlier patent document, but published on, or after the filing date D : document cited in the application L : document cited for other reasons</p> <p>& : member of the same patent family, corresponding document</p>			

EPO FORM 1503 03/82 (P04C01)

**ANNEX TO THE EUROPEAN SEARCH REPORT
ON EUROPEAN PATENT APPLICATION NO.**

EP 99 20 1730

This annex lists the patent family members relating to the patent documents cited in the above-mentioned European search report. The members are as contained in the European Patent Office EDP file on
The European Patent Office is in no way liable for these particulars which are merely given for the purpose of information.

28-10-1999

Patent document cited in search report	Publication date	Patent family member(s)	Publication date
US 5014660 A	14-05-1991	US 5125378 A	30-06-1992
DE 29812982 U	29-10-1998	DE 19829192 A	16-09-1999
		EP 0940637 A	08-09-1999
US 5617504 A	01-04-1997	NONE	
JP 03267555 A	28-11-1991	NONE	
EP 0268726 A	01-06-1988	CA 1325145 A	14-12-1993
		US 4736111 A	05-04-1988
		AU 596338 B	26-04-1990
		AU 8326687 A	16-06-1988
		DE 3785830 A	17-06-1993
		DE 3785830 T	14-10-1993
		DK 169085 B	08-08-1994
		EP 0250402 A	07-01-1988
		JP 63131854 A	03-06-1988
		WO 8703933 A	02-07-1987
		WO 8803989 A	02-06-1988
		US 4924818 A	15-05-1990
		US 4657290 A	14-04-1988
		AT 89366 T	15-05-1993
		CN 1010240 B	31-10-1990
		NZ 222350 A	29-05-1989
US 5890460 A	06-04-1999	US 5694889 A	09-12-1997
		US 5515816 A	14-05-1997