



(12) **EUROPEAN PATENT APPLICATION**

(88) Date of publication A3:
23.01.2002 Bulletin 2002/04

(51) Int Cl.7: **H01H 73/26, H01H 71/52**

(43) Date of publication A2:
13.12.2000 Bulletin 2000/50

(21) Application number: **00107771.8**

(22) Date of filing: **11.04.2000**

(84) Designated Contracting States:
AT BE CH CY DE DK ES FI FR GB GR IE IT LI LU
MC NL PT SE
 Designated Extension States:
AL LT LV MK RO SI

(30) Priority: **08.06.1999 US 328107**
02.09.1999 US 388771

(71) Applicant: **Sorenson, Richard W., c/o**
Carlingswitch, Inc.
Stuart, FL 34994 (US)

(72) Inventor: **Sorenson, Richard W., c/o**
Carlingswitch, Inc.
Stuart, FL 34994 (US)

(74) Representative: **Schaumburg, Thoenes & Thurn**
Postfach 86 07 48
81634 München (DE)

(54) **Thermal circuit breaker switch**

(57) The thermal circuit breaker and switch has fixed and movable contacts, and non-conductive contact and trip actuators. The movable contact is provided on the free end of a lever arm that normally biases the movable contact toward its open position. The contact actuator transfers movement from a rocker or operator to the movable contact arm when no overload condition exists. The trip actuator is L shaped and rotates in a socket when engaged by a thermally sensitive bi-metallic element so as to allow one end of the contact actuator to float freely, allowing the movable contact arm's bias to open the circuit. The bi-metallic element is so positioned as to engage and rotate the trip actuator only when the bi-metallic element is deformed due to an overheat condition that occurs with an overcurrent. A compression spring acts between the upstanding legs of the trip actuator and the underside of the rocker thus biasing the rocker to the 'off' position and biasing the trip actuator to the 'reset' position. The rocker employs hooks or posts to engage and position the contact actuator to the reset position after being tripped or manually switched off.

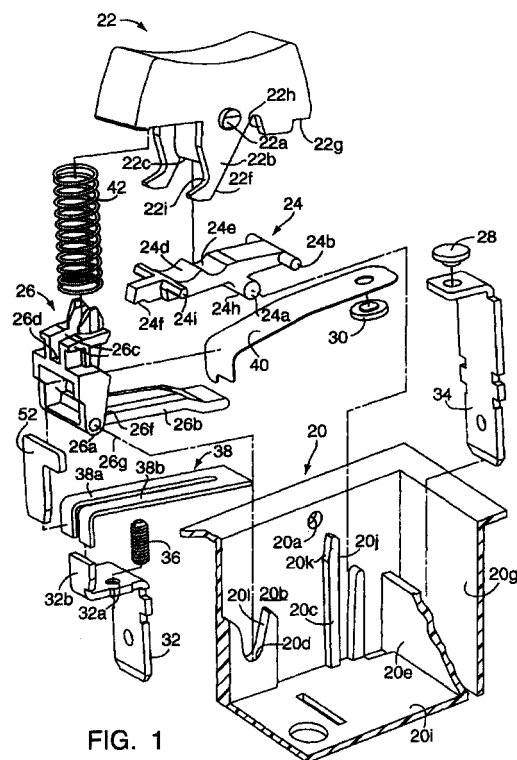

FIG. 1



European Patent
Office

EUROPEAN SEARCH REPORT

Application Number
EP 00 10 7771

DOCUMENTS CONSIDERED TO BE RELEVANT			
Category	Citation of document with indication, where appropriate, of relevant passages	Relevant to claim	CLASSIFICATION OF THE APPLICATION (Int.Cl.7)
Y	FR 2 390 824 A (ELLENBERGER & POENSGEN) 8 December 1978 (1978-12-08) * page 7, line 4 - page 8, line 26 * ----	1-4, 8, 11, 12, 14-18	H01H73/26 H01H71/52
Y	DE 838 920 C (CORNELIUS WEISE) 3 April 1952 (1952-04-03) * page 2, line 37 - line 70 * ----	1-3, 11, 12, 14-18	
Y	EP 0 513 423 A (SIEMENS AG) 19 November 1992 (1992-11-19) * column 1, line 30 - line 41 * ----	4-6	
Y	FR 2 550 005 A (BASSANI SPA) 1 February 1985 (1985-02-01) * page 5, line 30 - page 6, line 2 * ----	8-10	
Y	EP 0 079 271 A (MERLIN GERIN) 18 May 1983 (1983-05-18) * page 7, line 32 - page 8, line 10 * -----	5, 6, 9, 10	
			TECHNICAL FIELDS SEARCHED (Int.Cl.7)
			H01H
The present search report has been drawn up for all claims			
Place of search		Date of completion of the search	Examiner
THE HAGUE		30 November 2001	Libberecht, L
CATEGORY OF CITED DOCUMENTS X : particularly relevant if taken alone Y : particularly relevant if combined with another document of the same category A : technological background O : non-written disclosure P : intermediate document T : theory or principle underlying the invention E : earlier patent document, but published on, or after the filing date D : document cited in the application L : document cited for other reasons & : member of the same patent family, corresponding document			

EPO FORM 1503 03/02 (P04C01)

**ANNEX TO THE EUROPEAN SEARCH REPORT
ON EUROPEAN PATENT APPLICATION NO.**

EP 00 10 7771

This annex lists the patent family members relating to the patent documents cited in the above-mentioned European search report. The members are as contained in the European Patent Office EDP file on
The European Patent Office is in no way liable for these particulars which are merely given for the purpose of information.

30-11-2001

Patent document cited in search report		Publication date	Patent family member(s)	Publication date
FR 2390824	A	08-12-1978	DE 2721162 A1	16-11-1978
			DE 7714923 U1	01-09-1977
			CH 631573 A5	13-08-1982
			FR 2390824 A1	08-12-1978
			GB 1592139 A	01-07-1981
			IT 1094574 B	02-08-1985
			JP 1254747 C	12-03-1985
			JP 53139185 A	05-12-1978
			JP 59031817 B	04-08-1984
			US 4167720 A	11-09-1979
DE 838920	C	NONE		
EP 0513423	A	19-11-1992	EP 0513423 A1	19-11-1992
			AT 133003 T	15-01-1996
			DE 59107254 D1	22-02-1996
			ES 2081387 T3	01-03-1996
			GR 3018645 T3	30-04-1996
			PT 100484 A ,B	31-05-1994
			TR 26683 A	15-03-1995
			US 5214405 A	25-05-1993
FR 2550005	A	01-02-1985	BE 900169 A1	16-11-1984
			BR 8403607 A	02-07-1985
			ES 280470 U	01-09-1985
			FR 2550005 A1	01-02-1985
			GR 82067 A1	13-12-1984
			MX 155803 A	02-05-1988
			NL 8402098 A	18-02-1985
EP 0079271	A	18-05-1983	FR 2516305 A1	13-05-1983
			DE 3268879 D1	13-03-1986
			EP 0079271 A1	18-05-1983
			ES 517099 D0	01-08-1983
			ES 8308150 A1	01-11-1983
			PT 75713 A ,B	01-11-1982

EPO FORM P0459

For more details about this annex : see Official Journal of the European Patent Office, No. 12/82