



Europäisches Patentamt
European Patent Office
Office européen des brevets



(11) **EP 1 072 358 A3**

(12) **EUROPEAN PATENT APPLICATION**

(88) Date of publication A3:
05.11.2003 Bulletin 2003/45

(51) Int Cl.7: **B24B 9/10, B24B 51/00,
B24B 49/00**

(43) Date of publication A2:
31.01.2001 Bulletin 2001/05

(21) Application number: **00830478.4**

(22) Date of filing: **07.07.2000**

(84) Designated Contracting States:
**AT BE CH CY DE DK ES FI FR GB GR IE IT LI LU
MC NL PT SE**
Designated Extension States:
AL LT LV MK RO SI

(72) Inventors:
• **Selci, Giancarlo
61100 Pesaro (IT)**
• **Grottaroli, Lucio
61100 Pesaro (IT)**

(30) Priority: **23.07.1999 IT TO990656**

(74) Representative: **Notaro, Giancarlo et al
c/o Buzzi, Notaro & Antonielli d'Oulx
Via Maria Vittoria 18
10123 Torino (IT)**

(71) Applicants:
• **BIESSE S.p.A.
61100 Pesaro (IT)**
• **Gieffe S.r.L.
61025 Montelabbate (Pesaro) (IT)**

(54) **Apparatus for machining the edge of glass plates**

(57) Described herein is an apparatus for machining the edges of glass plates (L), where the plate (L) is supported in a plane that is substantially vertical or anyway strongly inclined with respect to the horizontal, and is made to rotate in this plane. The plate is carried by a supporting assembly (4), which is in turn mounted on a slide (8) that is mobile on the fixed supporting structure of the apparatus in a horizontal direction of motion towards and away from a machining head (13) equipped with a grinding wheel (14) orientable in space. The movements of the mobile parts of the apparatus are governed by a numerical control system (24) in which the profile of the plate of glass to be machined is preliminarily acquired.

Fig. 1

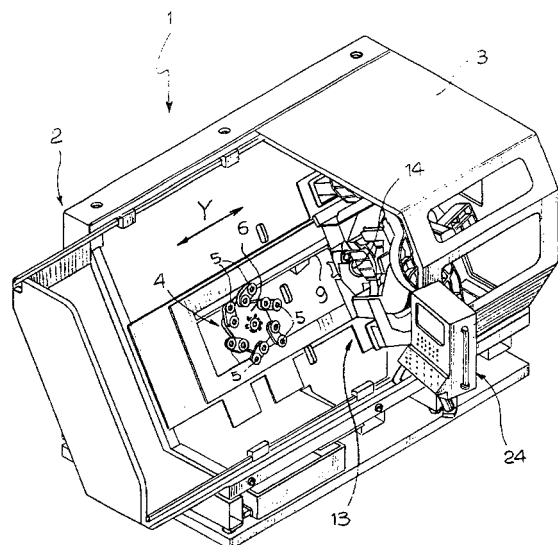

EP 1 072 358 A3



European Patent
Office

EUROPEAN SEARCH REPORT

Application Number
EP 00 83 0478

DOCUMENTS CONSIDERED TO BE RELEVANT			
Category	Citation of document with indication, where appropriate, of relevant passages	Relevant to claim	CLASSIFICATION OF THE APPLICATION (Int.Cl.7)
A	GB 235 953 A (BERNARD GWYNNE TWYFORD HAWKES) 26 June 1925 (1925-06-26) * page 3, line 47-69 * ---	1-12	B24B9/10 B24B51/00 B24B49/00
A	US 5 409 417 A (BANDO SHIGERU) 25 April 1995 (1995-04-25) * claim 1 * ---	1-12	
A	US 5 325 635 A (IKOLA KIMMO J ET AL) 5 July 1994 (1994-07-05) * claim 1 * -----	1-12	
			TECHNICAL FIELDS SEARCHED (Int.Cl.7)
			B24B
The present search report has been drawn up for all claims			
Place of search		Date of completion of the search	Examiner
THE HAGUE		11 September 2003	De Gussem, J
<p>CATEGORY OF CITED DOCUMENTS</p> <p>X : particularly relevant if taken alone Y : particularly relevant if combined with another document of the same category A : technological background O : non-written disclosure P : intermediate document</p> <p>T : theory or principle underlying the invention E : earlier patent document, but published on, or after the filing date D : document cited in the application L : document cited for other reasons & : member of the same patent family, corresponding document</p>			

EPO FORM 1503 03.82 (P04C01)

ANNEX TO THE EUROPEAN SEARCH REPORT
ON EUROPEAN PATENT APPLICATION NO.

EP 00 83 0478

This annex lists the patent family members relating to the patent documents cited in the above-mentioned European search report. The members are as contained in the European Patent Office EDP file on
The European Patent Office is in no way liable for these particulars which are merely given for the purpose of information.

11-09-2003

Patent document cited in search report		Publication date	Patent family member(s)	Publication date
GB 235953	A	26-06-1925	NONE	
US 5409417	A	25-04-1995	JP 2859389 B2	17-02-1999
			JP 4069150 A	04-03-1992
			DE 69127959 D1	20-11-1997
			DE 69127959 T2	12-02-1998
			EP 0491051 A1	24-06-1992
			WO 9200831 A1	23-01-1992
US 5325635	A	05-07-1994	FI 905760 A	30-04-1992
			DE 69114514 D1	14-12-1995
			DE 69114514 T2	04-04-1996
			EP 0558533 A1	08-09-1993
			JP 6504236 T	19-05-1994
			ES 2082235 T3	16-03-1996
			WO 9209404 A1	11-06-1992