



Europäisches Patentamt  
European Patent Office  
Office européen des brevets



(11) **EP 1 072 371 A3**

(12) **EUROPEAN PATENT APPLICATION**

(88) Date of publication A3:  
**10.04.2002 Bulletin 2002/15**

(51) Int Cl.7: **B28D 1/22**

(43) Date of publication A2:  
**31.01.2001 Bulletin 2001/05**

(21) Application number: **00113198.6**

(22) Date of filing: **03.07.2000**

(84) Designated Contracting States:  
**AT BE CH CY DE DK ES FI FR GB GR IE IT LI LU  
MC NL PT SE**  
Designated Extension States:  
**AL LT LV MK RO SI**

(72) Inventor: **Tondini, Claudio**  
**48010 Cotignola (Prov. of Ravenna) (IT)**

(74) Representative: **Modiano, Guido, Dr.-Ing. et al**  
**Modiano & Associati SpA**  
**Via Meravigli, 16**  
**20123 Milano (IT)**

(30) Priority: **13.07.1999 IT BO990091**

(71) Applicant: **SKC di Tondini Claudio**  
**I-48010 Cotignola, Ravenna (IT)**

(54) **Board with sliding lever arm for manually scoring and cutting tiles**

(57) A board (T) with sliding lever arm for manually scoring and cutting tiles, having a base (1) constituted by a flat element in which a bending process forms at the centerline and in an upward region a raised rib (2) and, laterally thereto, two lower stiffening ribs (3a, 3b),

and a guide constituted by a pair of co-planar tubular profiled elements (9a, 9b), each of which has a cross-section substantially shaped like two semicircles connected by two substantially vertical straight parallel portions.

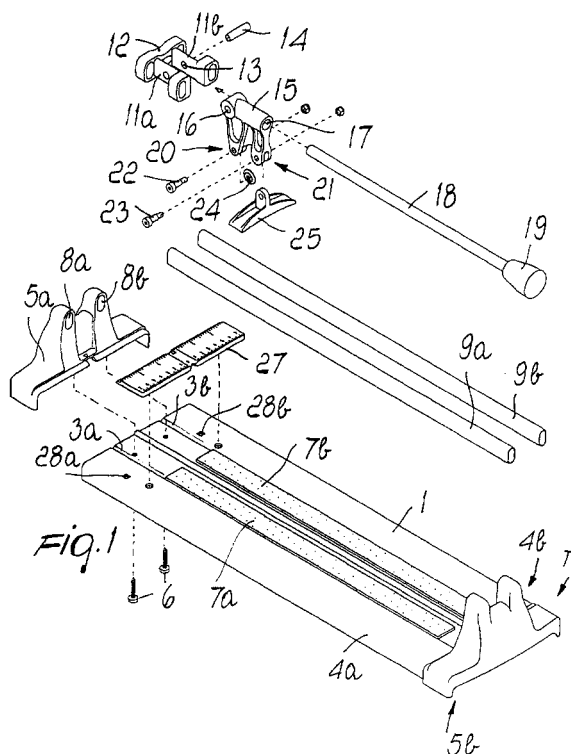

EP 1 072 371 A3



European Patent  
Office

# EUROPEAN SEARCH REPORT

Application Number  
EP 00 11 3198

DOCUMENTS CONSIDERED TO BE RELEVANT			
Category	Citation of document with indication, where appropriate, of relevant passages	Relevant to claim	CLASSIFICATION OF THE APPLICATION (Int.Cl.7)
X	DE 298 10 757 U (LIU YI HUA) 27 August 1998 (1998-08-27)	1,2,4,5	B28D1/22
Y	* page 1, line 25 - line 27 * * page 2, line 15 - line 33 * * figure 1 *	3	
Y	EP 0 428 070 A (KAUFMANN GMBH & CO KG) 22 May 1991 (1991-05-22) * column 2, line 45 - line 48 * * figures 1-3 *	3	
A	DE 298 13 970 U (LIU YI HUA) 5 November 1998 (1998-11-05) * page 4, line 14 - line 17 * * figures 1,3 *	1	
A	DE 44 07 937 A (LIU WN HEI) 14 September 1995 (1995-09-14) * column 2, line 28 - line 35 * * figure 1 *	1	
A	DE 197 50 480 A (SANKEI BUTUSAN KK) 28 May 1998 (1998-05-28) * column 1, line 62 - line 66 * * column 6, line 35 - line 36 *	1	
A	"Nahtlose Stahlrohre (Statische Werte und Gewichte)" 1957, MANNESMANN VERKAUFGEMEINSCHAFT, DÜSSELDORF XP002188672 * page 3; page 74 - page 92 *	1	
A	GB 2 189 188 A (HILTON DAVID WHITMORE) 21 October 1987 (1987-10-21) * page 1, line 31 - line 35 * * figures 1,2,6 *	3	
The present search report has been drawn up for all claims			
Place of search <b>THE HAGUE</b>		Date of completion of the search <b>31 January 2002</b>	Examiner <b>Moet, H</b>
<p>CATEGORY OF CITED DOCUMENTS</p> <p>X : particularly relevant if taken alone Y : particularly relevant if combined with another document of the same category A : technological background O : non-written disclosure P : intermediate document</p> <p>T : theory or principle underlying the invention E : earlier patent document, but published on, or after the filing date D : document cited in the application L : document cited for other reasons &amp; : member of the same patent family, corresponding document</p>			

EPO FORM 1503 03/82 (P04C01)



European Patent  
Office

# EUROPEAN SEARCH REPORT

Application Number  
EP 00 11 3198

DOCUMENTS CONSIDERED TO BE RELEVANT			
Category	Citation of document with indication, where appropriate, of relevant passages	Relevant to claim	CLASSIFICATION OF THE APPLICATION (Int.Cl.7)
A	EP 0 614 738 A (MONTOLIT BREVETTI) 14 September 1994 (1994-09-14) ---		
A	EP 0 592 345 A (BOADA GERMANS SA) 13 April 1994 (1994-04-13) ---		
A	DE 30 15 385 A (JOECKER EDUARD) 29 October 1981 (1981-10-29) -----		
			TECHNICAL FIELDS SEARCHED (Int.Cl.7)
The present search report has been drawn up for all claims			
Place of search <b>THE HAGUE</b>		Date of completion of the search <b>31 January 2002</b>	Examiner <b>Moet, H</b>
CATEGORY OF CITED DOCUMENTS X : particularly relevant if taken alone Y : particularly relevant if combined with another document of the same category A : technological background O : non-written disclosure P : intermediate document T : theory or principle underlying the invention E : earlier patent document, but published on, or after the filing date D : document cited in the application L : document cited for other reasons & : member of the same patent family, corresponding document			

EPO FORM 1503 03.82 (p04c01)

**ANNEX TO THE EUROPEAN SEARCH REPORT  
ON EUROPEAN PATENT APPLICATION NO.**

EP 00 11 3198

This annex lists the patent family members relating to the patent documents cited in the above-mentioned European search report. The members are as contained in the European Patent Office EDP file on  
The European Patent Office is in no way liable for these particulars which are merely given for the purpose of information.

31-01-2002

Patent document cited in search report		Publication date	Patent family member(s)	Publication date
DE 29810757	U	27-08-1998	FR 2780332 A3 DE 29810757 U1	31-12-1999 27-08-1998
EP 0428070	A	22-05-1991	AT 86539 T DE 59001010 D1 EP 0428070 A1 ES 2040021 T3	15-03-1993 15-04-1993 22-05-1991 01-10-1993
DE 29813970	U	05-11-1998	US 6012441 A DE 29813970 U1	11-01-2000 05-11-1998
DE 4407937	A	14-09-1995	DE 4407937 A1	14-09-1995
DE 19750480	A	28-05-1998	JP 10156826 A AU 4537097 A BR 9705873 A CN 1183343 A DE 19750480 A1 ES 2142736 A1 FR 2756208 A1 IT T0970968 A1	16-06-1998 28-05-1998 23-03-1999 03-06-1998 28-05-1998 16-04-2000 29-05-1998 26-05-1998
GB 2189188	A	21-10-1987	NONE	
EP 0614738	A	14-09-1994	DE 9403195 U1 IT 1265981 B1 AT 149112 T DE 69308287 D1 DE 69308287 T2 EP 0614738 A1 ES 2101155 T3	21-04-1994 16-12-1996 15-03-1997 03-04-1997 25-09-1997 14-09-1994 01-07-1997
EP 0592345	A	13-04-1994	ES 2101611 A1 ES 2064248 A2 AT 173971 T DE 69322359 D1 DE 69322359 T2 DK 592345 T3 EP 0592345 A2 ES 2101612 A1 GR 3029368 T3	01-07-1997 16-01-1995 15-12-1998 14-01-1999 02-06-1999 16-08-1999 13-04-1994 01-07-1997 28-05-1999
DE 3015385	A	29-10-1981	DE 3015385 A1	29-10-1981

EPO FORM P0459

For more details about this annex : see Official Journal of the European Patent Office, No. 12/82