



Europäisches Patentamt  
European Patent Office  
Office européen des brevets



(11) **EP 1 081 078 A3**

(12) **EUROPEAN PATENT APPLICATION**

(88) Date of publication A3:  
**19.06.2002 Bulletin 2002/25**

(51) Int Cl.7: **B65H 29/04**

(43) Date of publication A2:  
**07.03.2001 Bulletin 2001/10**

(21) Application number: **00810105.7**

(22) Date of filing: **08.02.2000**

(84) Designated Contracting States:  
**AT BE CH CY DE DK ES FI FR GB GR IE IT LI LU  
MC NL PT SE**  
Designated Extension States:  
**AL LT LV MK RO SI**

(72) Inventors:  
• **Uera, Yoshinori**  
**Kawasaki-shi, Kanagawa-ken (JP)**  
• **Motojima, Kazuyuki**  
**Kawasaki-shi, Kanagawa-ken (JP)**

(30) Priority: **30.08.1999 JP 24393699**

(74) Representative: **Isler & Pedrazzini AG**  
**Gotthardstrasse 53**  
**Postfach 6940**  
**8023 Zürich (CH)**

(54) **Printed matter transport device**

(57) In a printed matter transport device wherein a printed matter is gripped by a gripping mechanism of a chain and made to travel along a guide rail, to improve the durability of the guide rail and chain, to prevent misalignment, falling out and damage when an external force acts on the printed matter, to improve durability of a connecting part of a chain link (2) (base) and the gripping mechanism, to reduce manufacturing costs, and to enable the printed matter to be firmly gripped. A chain with grips comprising first rollers (23) respectively arranged on two sides in the center of the longitudinal direction of the bases (21), a second roller (24) on one side perpendicular to the common center line of the first rollers (23) and a grip mechanism (20) on the opposite side, a guide rail, a chain drive means and a cam member are provided.

**FIG. 1**

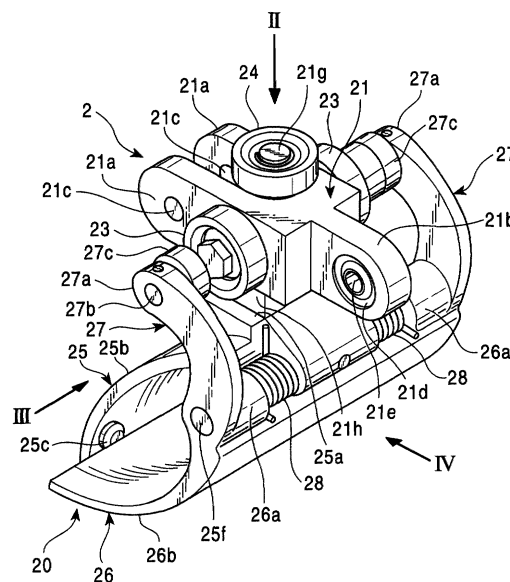

**EP 1 081 078 A3**



European Patent  
Office

# EUROPEAN SEARCH REPORT

Application Number  
EP 00 81 0105

DOCUMENTS CONSIDERED TO BE RELEVANT									
Category	Citation of document with indication, where appropriate, of relevant passages	Relevant to claim	CLASSIFICATION OF THE APPLICATION (Int.CI.7)						
A,D	US 4 638 906 A (WINIASZ MICHAEL E) 27 January 1987 (1987-01-27) * column 2, line 20 - column 4, line 52; figures *	1,2	B65H29/04						
A,D	PATENT ABSTRACTS OF JAPAN vol. 017, no. 443 (M-1463), 16 August 1993 (1993-08-16) & JP 05 097302 A (KANEDA KIKAI SEISAKUSHO:KK;OTHERS: 02), 20 April 1993 (1993-04-20) * abstract; figures *	1,2							
A	US 4 381 056 A (EBERLE JUERG) 26 April 1983 (1983-04-26) * figures *	1,2							
A	US 5 261 656 A (GUTOV SERGEI K ET AL) 16 November 1993 (1993-11-16) * the whole document *	3-5							
A,D	PATENT ABSTRACTS OF JAPAN vol. 1996, no. 11, 29 November 1996 (1996-11-29) & JP 08 188313 A (KANEDA KIKAI SEISAKUSHO:KK), 23 July 1996 (1996-07-23) * abstract; figure 10 *	6	<table border="1"> <thead> <tr> <th colspan="2">TECHNICAL FIELDS SEARCHED (Int.CI.7)</th> </tr> </thead> <tbody> <tr> <td>B65H</td> <td></td> </tr> <tr> <td>B65G</td> <td></td> </tr> </tbody> </table>	TECHNICAL FIELDS SEARCHED (Int.CI.7)		B65H		B65G	
TECHNICAL FIELDS SEARCHED (Int.CI.7)									
B65H									
B65G									
The present search report has been drawn up for all claims									
Place of search <b>THE HAGUE</b>		Date of completion of the search <b>17 April 2002</b>	Examiner <b>Lemmen, R</b>						
<table border="0"> <tr> <td style="vertical-align: top;"> <b>CATEGORY OF CITED DOCUMENTS</b>   X : particularly relevant if taken alone  Y : particularly relevant if combined with another document of the same category  A : technological background  O : non-written disclosure  P : intermediate document </td> <td style="vertical-align: top;"> T : theory or principle underlying the invention  E : earlier patent document, but published on, or after the filing date  D : document cited in the application  L : document cited for other reasons   &amp; : member of the same patent family, corresponding document </td> </tr> </table>				<b>CATEGORY OF CITED DOCUMENTS</b>  X : particularly relevant if taken alone Y : particularly relevant if combined with another document of the same category A : technological background O : non-written disclosure P : intermediate document	T : theory or principle underlying the invention E : earlier patent document, but published on, or after the filing date D : document cited in the application L : document cited for other reasons  & : member of the same patent family, corresponding document				
<b>CATEGORY OF CITED DOCUMENTS</b>  X : particularly relevant if taken alone Y : particularly relevant if combined with another document of the same category A : technological background O : non-written disclosure P : intermediate document	T : theory or principle underlying the invention E : earlier patent document, but published on, or after the filing date D : document cited in the application L : document cited for other reasons  & : member of the same patent family, corresponding document								

EPO FORM 1503 03/82 (P04C01)

**ANNEX TO THE EUROPEAN SEARCH REPORT  
ON EUROPEAN PATENT APPLICATION NO.**

EP 00 81 0105

This annex lists the patent family members relating to the patent documents cited in the above-mentioned European search report. The members are as contained in the European Patent Office EDP file on  
The European Patent Office is in no way liable for these particulars which are merely given for the purpose of information.

17-04-2002

Patent document cited in search report		Publication date	Patent family member(s)	Publication date
US 4638906	A	27-01-1987	DE 3666217 D1 EP 0223999 A2	16-11-1989 03-06-1987
JP 05097302	A	20-04-1993	NONE	
US 4381056	A	26-04-1983	CH 644816 A5 AT 387002 B AT 23481 A AU 539376 B2 AU 6633181 A BE 887422 A1 BR 8100733 A CA 1148493 A1 DE 3102242 A1 FR 2475511 A1 GB 2068892 A ,B GR 73826 A1 IT 1134982 B JP 1581604 C JP 2000241 B JP 56122710 A MX 151986 A NL 8100260 A ,B, SE 435918 B SE 8008916 A ZA 8000515 A	31-08-1984 25-11-1988 15-04-1988 27-09-1984 13-08-1981 06-08-1981 18-08-1981 21-06-1983 04-02-1982 14-08-1981 19-08-1981 04-05-1984 20-08-1986 11-10-1990 05-01-1990 26-09-1981 23-05-1985 01-09-1981 29-10-1984 09-08-1981 28-01-1981
US 5261656	A	16-11-1993	RU 2053184 C1 CH 682230 A5 DE 4191772 C2 DE 4191772 T FI 921498 A JP 2534175 B2 JP 5502654 T SE 469558 B SE 9201085 A WO 9202442 A1	27-01-1996 13-08-1993 25-02-1999 10-12-1992 06-04-1992 11-09-1996 13-05-1993 26-07-1993 06-04-1992 20-02-1992
JP 08188313	A	23-07-1996	NONE	

EPO FORM P0489

For more details about this annex : see Official Journal of the European Patent Office, No. 12/82