



(11) **EP 1 090 778 A3**

(12) **EUROPEAN PATENT APPLICATION**

(88) Date of publication A3:
11.04.2007 Bulletin 2007/15

(51) Int Cl.:
B42C 1/12 (2006.01) B27F 7/38 (2006.01)

(43) Date of publication A2:
11.04.2001 Bulletin 2001/15

(21) Application number: **00121578.9**

(22) Date of filing: **02.10.2000**

(84) Designated Contracting States:
**AT BE CH CY DE DK ES FI FR GB GR IE IT LI LU
MC NL PT SE**
Designated Extension States:
AL LT LV MK RO SI

(72) Inventor: **Hirai, Katsuaki**
Ohta-ku,
Tokyo (JP)

(74) Representative: **TBK-Patent**
Bavariaring 4-6
80336 München (DE)

(30) Priority: **04.10.1999 JP 28259999**

(71) Applicant: **CANON KABUSHIKI KAISHA**
Ohta-ku, Tokyo (JP)

(54) **Sheet stapler unit and sheet processing device**

(57) A stapler unit comprises a stapler (S) provided with a stapling device for stapling a sheet stack, and a staple cartridge arrangement detachably loaded on the stapler and provided with a staple receiving device for receiving staples. A plurality of the staple cartridges (A, B, C) for receiving staples having a plurality of lengths are provided in the staple cartridge arrangement, and each of the receiving devices of the plurality of staple cartridges (A, B, C) is provided with a guide for controlling, when the staple cartridge is loaded, staples received therein so that the longitudinal centers of the staples are positioned at the same positions as those of the staples having other lengths.

FIG. 1

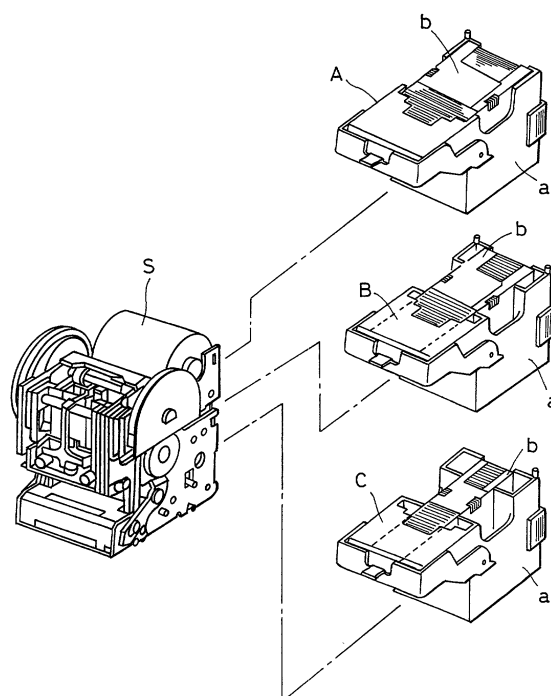

EP 1 090 778 A3



European Patent
Office

EUROPEAN SEARCH REPORT

Application Number
EP 00 12 1578

DOCUMENTS CONSIDERED TO BE RELEVANT			
Category	Citation of document with indication, where appropriate, of relevant passages	Relevant to claim	CLASSIFICATION OF THE APPLICATION (IPC)
A	EP 0 266 700 A (MAX) 11 May 1988 (1988-05-11) * column 1, lines 9-18 * * column 2, lines 1-6 * -----	1-3,9,10	INV. B42C1/12 B27F7/38
A	US 4 318 555 A (ADAMSKI) 9 March 1982 (1982-03-09) * abstract; figures 9-12 * -----	1-3,9,10	
A	US 3 622 061 A (HOYER) 23 November 1971 (1971-11-23) * column 1, lines 1-8; figure 1 * -----	1-3,9,10	
			TECHNICAL FIELDS SEARCHED (IPC)
			B25C B27F B42C
The present search report has been drawn up for all claims			
Place of search The Hague		Date of completion of the search 20 February 2007	Examiner Matzdorf, Udo
CATEGORY OF CITED DOCUMENTS X : particularly relevant if taken alone Y : particularly relevant if combined with another document of the same category A : technological background O : non-written disclosure P : intermediate document		T : theory or principle underlying the invention E : earlier patent document, but published on, or after the filing date D : document cited in the application L : document cited for other reasons & : member of the same patent family, corresponding document	

1
EPO FORM 1503 03.82 (P04C01)

**ANNEX TO THE EUROPEAN SEARCH REPORT
ON EUROPEAN PATENT APPLICATION NO.**

EP 00 12 1578

This annex lists the patent family members relating to the patent documents cited in the above-mentioned European search report.
The members are as contained in the European Patent Office EDP file on
The European Patent Office is in no way liable for these particulars which are merely given for the purpose of information.

20-02-2007

Patent document cited in search report	Publication date	Patent family member(s)	Publication date
EP 0266700	A	11-05-1988	JP 3025931 Y2 05-06-1991
			JP 63072001 U 14-05-1988
			US 4844319 A 04-07-1989
US 4318555	A	09-03-1982	NONE
US 3622061	A	23-11-1971	NONE