



(12) **EUROPEAN PATENT APPLICATION**

(88) Date of publication A3:
17.12.2003 Bulletin 2003/51

(51) Int Cl.7: **E05D 15/30, E05D 15/44**

(43) Date of publication A2:
13.06.2001 Bulletin 2001/24

(21) Application number: **00309670.8**

(22) Date of filing: **01.11.2000**

(84) Designated Contracting States:
AT BE CH CY DE DK ES FI FR GB GR IE IT LI LU
MC NL PT SE TR
 Designated Extension States:
AL LT LV MK RO SI

(30) Priority: **09.12.1999 GB 9929090**

(71) Applicant: **Avocet Hardware PLC**
Brighouse, West Yorkshire HD6 2RW (GB)

(72) Inventor: **Satram, Ramesh, c/o Wong Shi Limited,**
No. 20
Taichung (TW)

(74) Representative: **Orr, William McLean**
Urquhart-Dykes & Lord,
Tower House,
Merrion Way
Leeds LS2 8PA (GB)

(54) **Friction hinge for openable closure member**

(57) A friction hinge assembly (10) for mounting an openable closure member, such as a side hung window frame, on a fixed frame member of a fixed frame, said hinge assembly having a fixed guide track (11) which is securable to said fixed frame member and a linkage (12) which is connectable to a frame element of said openable closure member, in which the linkage comprises: a first arm (13) securable to the frame element; a short second connecting arm (16) pivoted at one end (17) to an end region of the first arm (13) and mounted pivotally at its opposite end (18) on the guide track (11); a longer third connecting arm (19) pivoted at one end (20) to the first arm (13) and pivoted at its opposite end to a slide block (not shown) mounted for slidable movement lengthwise of the guide track (11) during opening and closing movement of the closure member; and, a fourth control arm (21) mounted pivotally at one end (22) on the guide track (11) close to the pivot mounting (18) of the second arm (16) on the guide track (11), and pivoted at its opposite end (23) to the third arm (19) at a position intermediate the ends thereof so that the fourth arm (21) extends generally parallel to the first arm (13) to form an approximate parallelogram linkage therewith; and, in which: the second and fourth arms (16, 21) are pivotally connected to a mounting block (25) which is positioned on the guide track (11) at a mounting position close to one end (15) of the guide track (11) to determine a required position for the hinge axis of the closure member for usual opening and closing movements of the closure member relative to the fixed frame, said mounting block (25) being adjustable lengthwise of the guide track (11)

from said mounting position when it is required to increase the spacing of the hinge axis from the end (15) of the guide track (11) and thereby allow easier access for cleaning purposes to the outer face of the closure member, when the latter is moved to an open position.

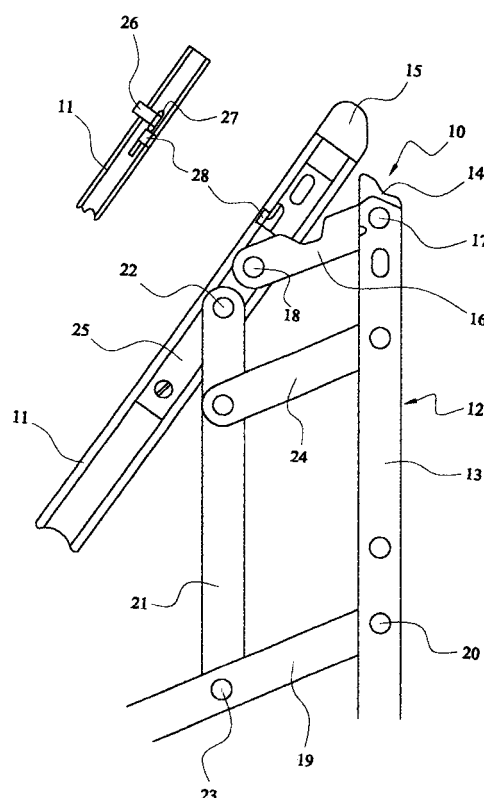



European Patent
Office

EUROPEAN SEARCH REPORT

Application Number
EP 00 30 9670

DOCUMENTS CONSIDERED TO BE RELEVANT			
Category	Citation of document with indication, where appropriate, of relevant passages	Relevant to claim	CLASSIFICATION OF THE APPLICATION (Int.Cl.7)
X	GB 2 262 308 A (SECURISTYLE LTD) 16 June 1993 (1993-06-16)	1-4,6,7	E05D15/30 E05D15/44
Y	* page 4, line 18 - page 6, line 2; figures *	5	

Y	GB 2 274 676 A (CHELOX LIMITED) 3 August 1994 (1994-08-03) * page 9, line 28 - page 10, line 18; figures *	5	

			TECHNICAL FIELDS SEARCHED (Int.Cl.7)
			E05D
The present search report has been drawn up for all claims			
Place of search		Date of completion of the search	Examiner
THE HAGUE		23 October 2003	Van Kessel, J
<p>CATEGORY OF CITED DOCUMENTS</p> <p>X : particularly relevant if taken alone Y : particularly relevant if combined with another document of the same category A : technological background O : non-written disclosure P : intermediate document</p> <p>T : theory or principle underlying the invention E : earlier patent document, but published on, or after the filing date D : document cited in the application L : document cited for other reasons & : member of the same patent family, corresponding document</p>			

EPO FORM 1503 03/82 (P04C01)

**ANNEX TO THE EUROPEAN SEARCH REPORT
ON EUROPEAN PATENT APPLICATION NO.**

EP 00 30 9670

This annex lists the patent family members relating to the patent documents cited in the above-mentioned European search report. The members are as contained in the European Patent Office EDP file on
The European Patent Office is in no way liable for these particulars which are merely given for the purpose of information.

23-10-2003

Patent document cited in search report		Publication date		Patent family member(s)	Publication date
GB 2262308	A	16-06-1993	SG	97494 G	28-10-1994
GB 2274676	A	03-08-1994	NONE		

EPO FORM P0459

For more details about this annex : see Official Journal of the European Patent Office, No. 12/82