



(12) **EUROPEAN PATENT APPLICATION**

(88) Date of publication A3:
25.09.2002 Bulletin 2002/39

(51) Int Cl.7: **E02F 3/40**, B02C 1/04,
E01C 19/05

(43) Date of publication A2:
04.10.2001 Bulletin 2001/40

(21) Application number: **01106464.9**

(22) Date of filing: **23.03.2001**

(84) Designated Contracting States:
**AT BE CH CY DE DK ES FI FR GB GR IE IT LI LU
MC NL PT SE TR**
Designated Extension States:
AL LT LV MK RO SI

(72) Inventor: **Vaccaro, Tiberio**
36025 Noventa Vicentina (Prov. Vicenza) (IT)

(74) Representative: **Modiano, Guido, Dr.-Ing. et al**
Modiano & Associati SpA
Via Meravigli, 16
20123 Milano (IT)

(30) Priority: **28.03.2000 IT PD000069**

(71) Applicant: **Eurodem S.r.l.**
36025 Noventa Vicentina (IT)

(54) **Bucket for crushing and screening rubble or stones**

(57) A bucket (10), particularly for crushing and screening rubble or similar stony material, comprising a box-like structure (11) which can be articulated to movement arms of self-propelled vehicles and is open at a first side (12), which is arranged frontally with respect to the advancement direction when picking up the rubble, and at a second side (13), being aligned with the first side, for the exit of the crushed and screened rubble. A crushing and screening unit (14) is supported inside the box-like (11) structure and comprises a movable crushing plate (15) being pivoted to a region which is arranged at the first side (12) and is free to oscillate under the control of actuation/vibration means (16), the

plate forming, together with a wall (17) of the structure (11) which lies opposite thereto, a hopper whose output section can be adjusted, at the second side, so as to allow the screening of the rubble while it is being crushed, motor means (18) being provided which are suitable to drive the actuation/vibration means (16), the arms being suitable to change the box-like structure from a configuration for picking up the rubble, in which the first side is arranged frontally with respect to the advancement direction, to a crushing/screening configuration, in which the first and second sides (12,13) are arranged vertically, the second side (13) being arranged below so as to allow the rubble being crushed to fall by gravity, and vice versa.

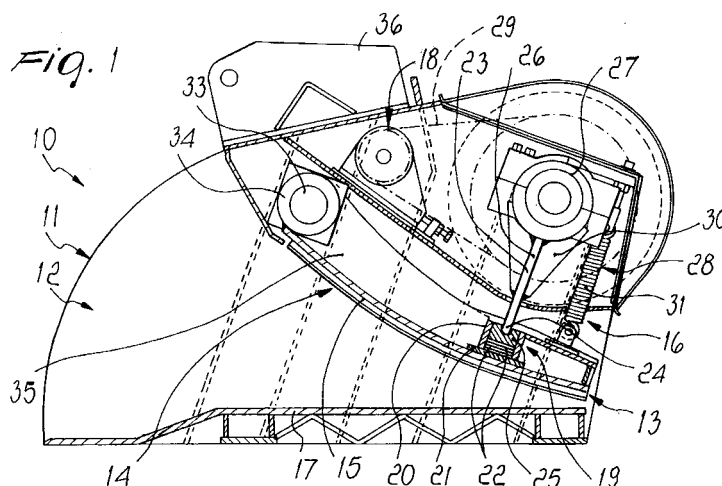



European Patent
Office

EUROPEAN SEARCH REPORT

Application Number
EP 01 10 6464

DOCUMENTS CONSIDERED TO BE RELEVANT			
Category	Citation of document with indication, where appropriate, of relevant passages	Relevant to claim	CLASSIFICATION OF THE APPLICATION (Int.Cl.7)
X	WO 98 45043 A (GERVAIS JOSEPH LUCIEN FERNAND ; GRAHAM MINING LTD (CA)) 15 October 1998 (1998-10-15) * page 3, line 4 - page 4, line 7; figures 1,2,5 * * page 6, line 22 - line 32 *	1-3,6,7, 9-12	E02F3/40 B02C1/04 E01C19/05
X	US 3 959 897 A (MAY WILLIAM P) 1 June 1976 (1976-06-01) * column 3, line 28 - line 54; figures 2,3 *	1,3,6,7, 10,11	
A	GB 438 674 A (KRUPP FRIED GRUSONWERK AG) 21 November 1935 (1935-11-21) * figure 1 *	4,5	
A	PATENT ABSTRACTS OF JAPAN vol. 1999, no. 08, 30 June 1999 (1999-06-30) -& JP 11 061876 A (TAKANO KOGYO KK), 5 March 1999 (1999-03-05) * abstract *	8	
A	WO 89 04718 A (KUE KEN CORP) 1 June 1989 (1989-06-01) * figure 2 *	4-6,10	B02C E01C E02F
A	PATENT ABSTRACTS OF JAPAN vol. 1999, no. 05, 31 May 1999 (1999-05-31) -& JP 11 028373 A (OKADA AIYON KK), 2 February 1999 (1999-02-02) * abstract *		
The present search report has been drawn up for all claims			
Place of search MUNICH		Date of completion of the search 20 June 2002	Examiner Laurer, M
CATEGORY OF CITED DOCUMENTS X : particularly relevant if taken alone Y : particularly relevant if combined with another document of the same category A : technological background O : non-written disclosure P : intermediate document		T : theory or principle underlying the invention E : earlier patent document, but published on, or after the filing date D : document cited in the application L : document cited for other reasons & : member of the same patent family, corresponding document	

EPO FORM 1503 03.82 (P04C01)

**ANNEX TO THE EUROPEAN SEARCH REPORT
ON EUROPEAN PATENT APPLICATION NO.**

EP 01 10 6464

This annex lists the patent family members relating to the patent documents cited in the above-mentioned European search report.
The members are as contained in the European Patent Office EDP file on
The European Patent Office is in no way liable for these particulars which are merely given for the purpose of information.

20-06-2002

Patent document cited in search report		Publication date	Patent family member(s)	Publication date
WO 9845043	A	15-10-1998	AU 7019698 A	30-10-1998
			BR 9808522 A	23-05-2000
			WO 9845043 A1	15-10-1998
			CN 1258234 T	28-06-2000
			EP 0973614 A1	26-01-2000
US 3959897	A	01-06-1976	NONE	
GB 438674	A	21-11-1935	NONE	
JP 11061876	A	05-03-1999	NONE	
WO 8904718	A	01-06-1989	AU 625896 B2	16-07-1992
			AU 2804089 A	14-06-1989
			BR 8807798 A	07-08-1990
			CA 1323347 A1	19-10-1993
			GB 2232095 A , B	05-12-1990
			JP 2729847 B2	18-03-1998
			JP 3500856 T	28-02-1991
			MX 170082 B	06-08-1993
			WO 8904718 A1	01-06-1989
			US 4989797 A	05-02-1991
JP 11028373	A	02-02-1999	NONE	