



(12) **EUROPEAN PATENT APPLICATION**

(88) Date of publication A3:
14.11.2001 Bulletin 2001/46

(51) Int Cl.7: **H01R 13/22**, H01R 13/629,
H01R 13/631

(43) Date of publication A2:
31.10.2001 Bulletin 2001/44

(21) Application number: **01110495.7**

(22) Date of filing: **27.04.2001**

(84) Designated Contracting States:
**AT BE CH CY DE DK ES FI FR GB GR IE IT LI LU
MC NL PT SE TR**
Designated Extension States:
AL LT LV MK RO SI

(72) Inventor: **Funatsu, Akira**
Shinagawa-ku, Tokyo (JP)

(74) Representative: **Pätzold, Herbert, Dr.-Ing.**
Dr. Pätzold, Buhl-Müller, Tandler & Kollegen
Steubstrasse 10
82166 Gräfelfing (DE)

(30) Priority: **28.04.2000 JP 2000129354**

(71) Applicant: **HIROSE ELECTRIC CO., LTD.**
Shinagawa-ku Tokyo (JP)

(54) **Mobile device, stationary device, and electrical connector for them**

(57) A plurality of terminals (15, 16) have contact sections (15A, 16A) projecting from the terminal support (19) of a connector housing (14) to abut against the terminal (34) of a mobile device (30). A pair of mount guiding columns (17) are provided on the connector housing (14) on opposite sides of the terminal support (19) so as

to enter the mount recesses 38 of the mobile device (30). The mount guiding column (17) has such a shape and size as to allow the mobile device to rotate to an inclined position with the terminals (15, 16, 34) being in contact. A rotation guiding face (21A) is provided on the connector housing (14) for guiding the mobile device (30) to the inclined position.

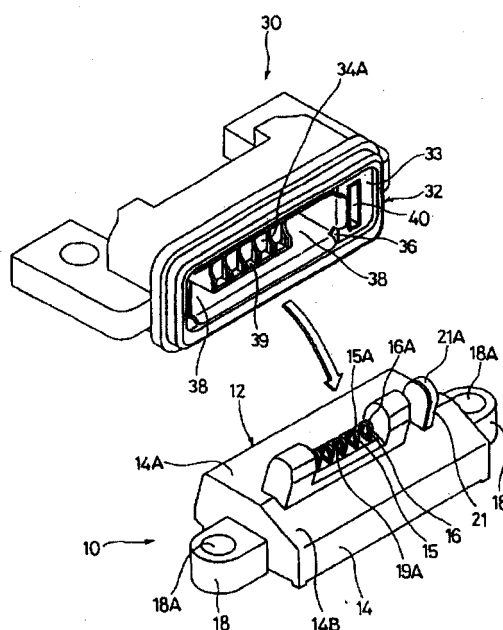

FIG. 1



European Patent
Office

EUROPEAN SEARCH REPORT

Application Number
EP 01 11 0495

DOCUMENTS CONSIDERED TO BE RELEVANT			
Category	Citation of document with indication, where appropriate, of relevant passages	Relevant to claim	CLASSIFICATION OF THE APPLICATION (Int.Cl.7)
X	US 4 778 403 A (H.IKESUGI ET AL) 18 October 1988 (1988-10-18) * column 2, line 43 - column 3, line 57; figures 1-5 *	1-3,5,6, 8-10,12	H01R13/22 H01R13/629 H01R13/631
A	FR 2 688 350 A (MARECHAL) 10 September 1993 (1993-09-10) * page 6, line 13 - line 36 * * page 7, line 17 - page 8, line 21; figures 1,3 *	1-3,5, 8-10,12	
			TECHNICAL FIELDS SEARCHED (Int.Cl.7)
			H01R
The present search report has been drawn up for all claims			
Place of search BERLIN		Date of completion of the search 21 September 2001	Examiner Alexatos, G
CATEGORY OF CITED DOCUMENTS X : particularly relevant if taken alone Y : particularly relevant if combined with another document of the same category A : technological background O : non-written disclosure P : intermediate document		T : theory or principle underlying the invention E : earlier patent document, but published on, or after the filing date D : document cited in the application L : document cited for other reasons & : member of the same patent family, corresponding document	

EPO FORM 1503 03.82 (P04C01)

**ANNEX TO THE EUROPEAN SEARCH REPORT
ON EUROPEAN PATENT APPLICATION NO.**

EP 01 11 0495

This annex lists the patent family members relating to the patent documents cited in the above-mentioned European search report.
The members are as contained in the European Patent Office EDP file on
The European Patent Office is in no way liable for these particulars which are merely given for the purpose of information.

21-09-2001

Patent document cited in search report		Publication date	Patent family member(s)	Publication date
US 4778403	A	18-10-1988	NONE	
FR 2688350	A	10-09-1993	FR 2688350 A1	10-09-1993

EPO FORM P0459

For more details about this annex : see Official Journal of the European Patent Office, No. 12/82