



(12) **EUROPEAN PATENT APPLICATION**

(43) Date of publication:
27.02.2002 Bulletin 2002/09

(51) Int Cl.7: **H01H 25/04**

(21) Application number: **01402208.1**

(22) Date of filing: **22.08.2001**

(84) Designated Contracting States:
AT BE CH CY DE DK ES FI FR GB GR IE IT LI LU
MC NL PT SE TR
 Designated Extension States:
AL LT LV MK RO SI

(72) Inventors:
 • Cui, Wei
 Tai Cheung Kiu Rd. Sha Tin NT, Hong Kong (CN)
 • Chan, Yat Fung
 Tin Shui Wai N.T., Hong Kong (CN)

(30) Priority: **23.08.2000 EP 00402340**

(74) Representative: **Bonnans, Arnaud et al**
Thomson multimedia 46, quai Alphonse Le Gallo
92648 Boulogne Billancourt Cedex (FR)

(71) Applicant: **Thomson Licensing S.A.**
92100 Boulogne-Billancourt (FR)

(54) **Switch designed for manual actuation of several switching elements**

(57) Within electronic devices in many cases there exists a need for a manual individual actuation of several switching elements for performing an adjustment of different parameters by a single switch, especially for a pleasure appearance of a front panel and for saving place on the panel.

It is an object to provide a switch for this purpose

ensuring among others low costs, small size, high reliability, convenient actuation and having good properties for being mounted on a printed circuit board.

The actuation means for several switching elements (16) includes an actuating plate (6) being pivotably mounted in a housing (1) on two perpendicular axes and a push-button (21) located within a central opening (8) of said plate (6).

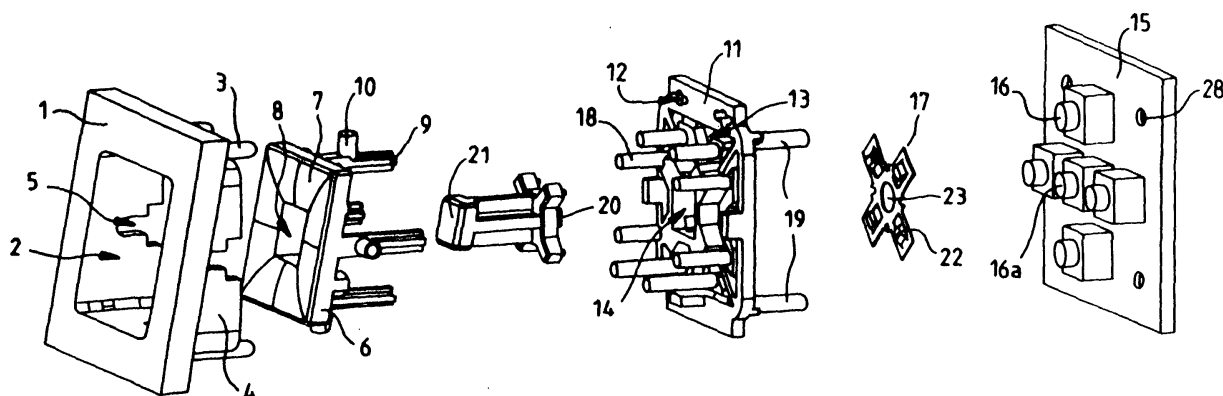

FIG.1

Description

[0001] The invention relates to a switch designed for manual actuation of several switching elements.

[0002] Within electronic equipments including a high number of controllable or adjustable elements and a corresponding high number of operating elements like push-buttons, knobs, shiftable elements etc., a need exists for actuating several functions by means of a single switch. This is the case especially for improving the optical appearance of a control panel and to reduce the space occupied by the operating elements on the surface of the control panel.

[0003] Switches with a manual actuation means allowing individual actuation of several switching elements have already been proposed, for instance in patent application EP0 587 406 and utility model DE92 10 286.

[0004] Practically there exists a number of requirements for such multifunction switches. Some of them are among others low costs, small size, high reliability and good properties for being mounted on a printed circuit board (PCB).

[0005] It is an object of the present invention to provide a multifunction switch meeting said requirements in a more extended form than switches according to prior art.

[0006] The invention proposes a switch designed for an individual actuation of one of a plurality of switching elements including a housing and manual actuation means mounted in said housing for individually actuating said several switching elements. The manual actuation means comprises an actuating plate with two pins defining a first axis and two pins defining a second axis perpendicular to the first axis. The housing comprises slots for cooperation with the pins.

[0007] This feature enables the totally reliable actuation of only one of four separate switching elements by pressing the upper part, the right part, the lower part or the left part of the surface of the plate as two switching elements cannot be pressed at a time. Said plate may include a number of slightly curved convex partial areas each area being adapted to pivot the plate in different directions. The plate may have the form of an undivided doughnut shaped button.

[0008] According to one embodiment of the invention, said plate is provided at its rear side with at least one rod extending perpendicular to the plane of said plate into the interior of the housing and abutting against movable parts of the switching elements located at the back side of said housing. Said pins may form an integral part of said rods.

[0009] According to a further embodiment of the invention the housing of the switch includes between said plate and said switching elements a guiding plate with a central opening acting as a guidance for said push-button and four openings provided for the passage of said rods. Therein the guiding plate carries at its first

surface a number of rods abutting against said housing member and at its opposite surface a number of rods abutting against said switch panel.

[0010] According to a further development of the invention said housing member forms an integral part of a cabinet of a device like a CD-player and the switch panel forms an integral part of a printed circuit board located within said cabinet.

[0011] According to a further development of the invention several push-buttons are located in several openings of the plate side by side or one above the other whereby the number of the individually actuatable switching elements can be further increased.

[0012] As the undivided plate is pivotable about two perpendicular axes in each case in two different directions so that that totally the plate can be pivoted in four different directions it can be used for example to move a cursor on a screen in four perpendicular directions, i. e. to any desired point on the screen, especially for navigation purposes. The arrangement of the plate and the central button according to the invention allows the individual manual actuating of any one of five separate switching elements or tact switches by a single switch.

[0013] The switch according to the invention offers a number of advantages. A high cost saving is achieved as five switching elements or functions can be actuated individually by one switch only instead of a conventional multidirectional switch. Additionally a space saving is achieved as the arrangement according to the invention facilitates the manufacture of more compact and light units. Especially high density mounting on a printed circuit board (PCB) is permitted and low profile and light weight are realized greatly. Furthermore appearance simplicity with web feeling and stylish high class image are achieved compared with conventional segmental style design. Switch mechanism and contact structure offer the best panel design flexibility. Less fastening means enables an easy assembling. Internal isolated momentary mechanism and contact structure make the structure more tolerant to the warping of a PCB.

[0014] The switch according to the invention provides a high number of different advantageous applications. For example it can be used for the operation and setting of data input equipments, especially pointing devices such as mouse and micro trackball, and communication equipments. Another application are devices using micro switches as operating switches in different electronic apparatus. It may be applied in car audio systems, car navigation systems, for adjusting the side mirror in an automobile, furthermore for cursor control of a graphic input device and audio devices such as equalizers. Finally it can be used for operating various adjustments for such items, especially for portable electronic equipments. Further possible fields of application may be all types of audio products, business machines, communication equipments, measuring instruments, television receivers, video recorders, in particular in compact version requiring high density mounting such as cellular

phones.

[0015] One embodiment of the invention will now be described with reference to the accompanying drawing. Within the drawing

Fig. 1 shows all elements of a switch according to the invention in an exploded view,
Fig. 2 is a perspective view of a housing member of the switch,
Fig. 3 is a perspective view of an actuating plate shown in Fig. 1,
Fig. 4 is a guiding plate provided for guiding the rods of the operating plate and the push-button and
Fig. 5 is a spring plate for actuating the switching elements.

[0016] Fig. 1 shows a housing member 1 of a switch including a rectangular opening 2, four rods 3 at the rear side and four sidewalls 4 at the rear side each provided with a slot 5. A rectangular actuating plate 6 with the dimensions of the opening 2 includes several slightly curved surface areas 7, a central opening 8, four rods 9 extending from the rear side and each provided with a pin 10 directed perpendicular to the rods 9. The actuating plate 6 is inserted into the opening 2 of the housing member 1, the four pins 10 cooperating with the slots 5. In this way the operating plate 6 can pivot within the housing member 1 in both directions about a horizontal axis defined by two opposite pins 10 and about a vertical axis defined by the other two opposite pins 10. Furthermore a push-button 21 having a foot part 20 is provided which fits into the central opening 8 of the actuating plate 6.

[0017] Next a guiding plate 11 is provided including four holes 12 at its upper and lower border aligned with the rods 3, four openings 13 aligned with the rods 9 and a central rectangular opening 14 aligned with the push-button 21. The rods 3 of the housing member 1 are inserted into the holes 12 so that the housing member 1 and the guiding plate 11 are firmly combined and from a rigid structure. Rods 18 of the guiding plate 11 abut against the housing member 1 whereas four rods 19 of the guiding plate 11 are inserted into four holes 28 of a switch panel 15 provided at the right end of the structure.

[0018] The switch panel 15 carries at its surface five switching elements 16 in the arrangement shown. Between the guiding plate 11 and the switch panel 15 a spring plate 17 is provided with four spring-like members 22 aligned with the rods 9. A hole 23 within the spring plate 17 enables the passage of the foot part 20 of the push-button 21 for actuating the central switching element 16a.

[0019] In the following the operation of said switch will be described. For actuating one of the switching elements 16 the operator pushes or presses the upper part, the right part, the lower part or the left part of the plate 6 or the push-button 21 so that the corresponding switching element 16 on the switch panel 15 is actuated

by one of the rods 9 or the foot part 20 of the push-button 21. Thus the separated switching elements 16 can be actuated by an operator individually only by said single plate 6 and the push-button 21.

[0020] The housing member 1 may be an integral part of the cabinet of a CD player whereas the switch panel 15 may be mounted on a printed circuit board mounted within said cabinet. The other elements like elements 6, 21, 11, 17 are inserted during the assembling of cabinet and printed circuit board.

[0021] Fig. 2 shows the housing member 1 from the rear side with the four sidewalls 4 each including a slot 5 and the central opening 2 for receiving the rectangular plate 6 of Fig. 1 as well as the four rods 3 being inserted into the holes 12 of the guiding plate 11 according to Fig. 1.

[0022] Fig. 3 shows the actuating plate 6 from the rear side including the four rods 9 abutting against the switching elements 16, the four pins 10 forming an integral part with the rods 9 and cooperating with the slots 5 in Fig. 1 and 2 as well as the central opening 8 for receiving the push-button 21.

[0023] Fig. 4 shows the guiding plate 11 from the right side in Fig. 1 including the four rods 19, the four openings 13 for the passage of the four rods 9 and the central opening 14 acting as a guidance for the push-button 21.

[0024] Fig. 5 shows the spring plate 17 including four spring elements 22 being interposed between the ends of the rods 9 and the corresponding four switching elements 16 of the switch panel 15 for ensuring a sudden actuation of the switching elements 16 by the rods 9.

Claims

1. Switch designed for an individual actuation of one of a plurality of switching elements (16) including a housing (1) and manual actuation means mounted in said housing (1) for individually actuating said several switching elements (16),
characterized in that

the manual actuation means comprises an actuating plate (6) with two pins (10) defining a first axis and two pins (10) defining a second axis perpendicular to the first axis and **in that**

the housing (1) comprises slots (5) for cooperation with the pins (10).

2. Switch according to claim 1,
Wherein a push-button (21) is located within a central opening (8) of said plate (6).
3. Switch according to claim 1 or 2,
wherein said plate (6) includes a number of slightly curved convex partial areas (7).

4. Switch according to any of claims 1 to 3,
wherein said plate (6) has the form of an undivided
doughnut shaped button.
5. Switch according to any of claims 1 to 4, 5
wherein said plate (6) is provided at its rear side with
at least one rod (9) extending perpendicular to the
plane of said plate (6) into the interior of the housing
of the switch and abutting against movable parts of
the switching elements (16) of a switch panel (15) 10
located at the back side of said housing.
6. Switch according to claim 5,
wherein said pins (10) form an integral part of said
rods (9). 15
7. Switch according to claim 5 or 6,
wherein the housing of the switch includes between
said plate (6) and said switching elements (16) a
guiding plate (11) with a central opening (14) acting 20
as a guidance for a push-button (21) and four open-
ings (13) provided for the passage of said rods (9).
8. Switch according to claim 7,
wherein the guiding plate (11) carries at its first sur- 25
face a number of rods (18) abutting against said
housing (1) and at its opposite surface a number of
rods (19) abutting against said switch panel (15).
9. Switch according to claim 5 to 8, 30
wherein said housing (1) forms an integral part of a
cabinet of a device and the switch panel (15) forms
an integral part of a printed circuit board located
within said device.

35

40

45

50

55

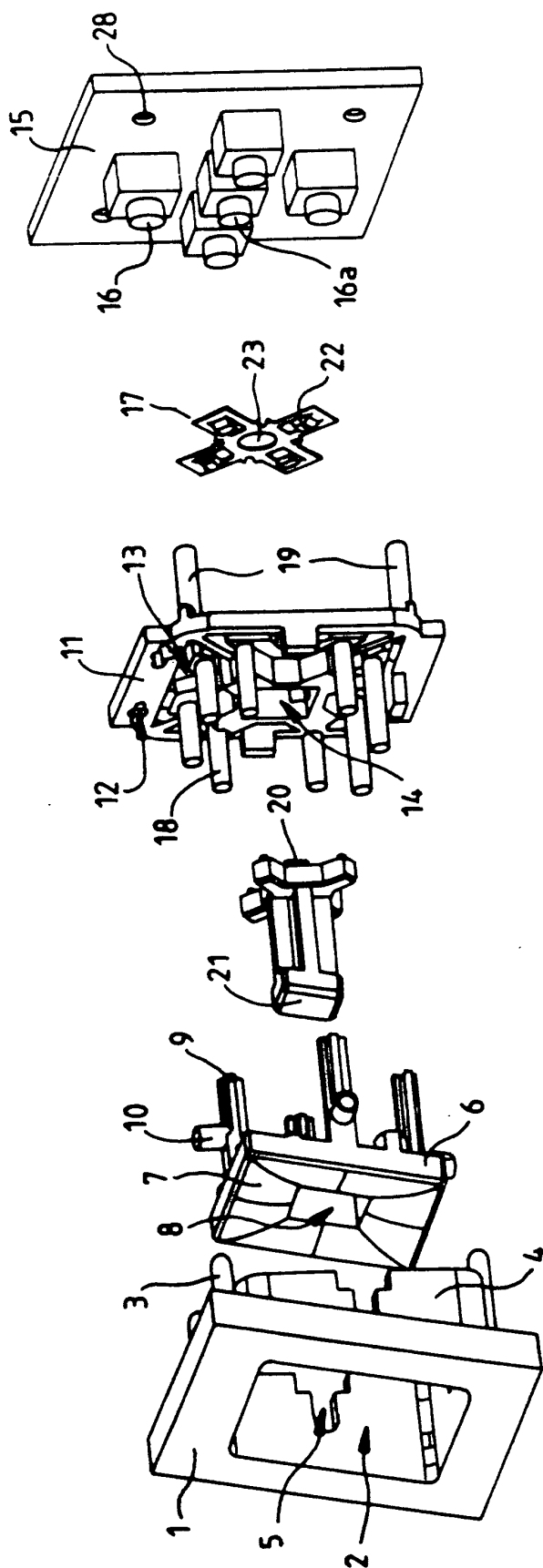

FIG.1

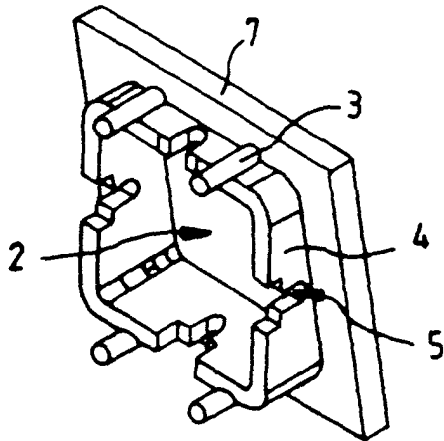

FIG. 2

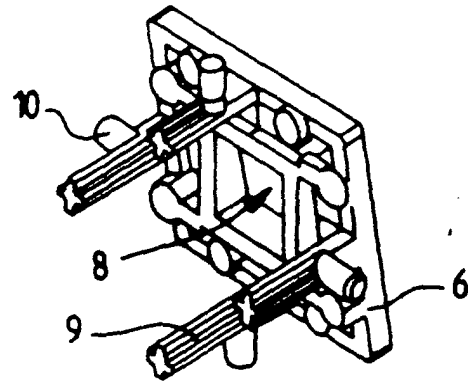

FIG. 3

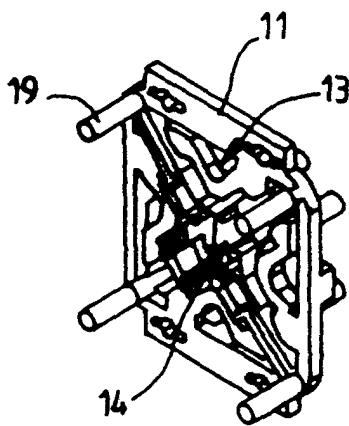

FIG. 4

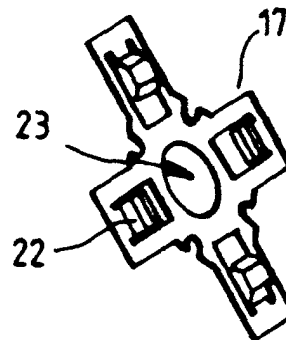

FIG. 5



European Patent
Office

EUROPEAN SEARCH REPORT

Application Number
EP 01 40 2208

DOCUMENTS CONSIDERED TO BE RELEVANT			
Category	Citation of document with indication, where appropriate, of relevant passages	Relevant to claim	CLASSIFICATION OF THE APPLICATION (Int.Cl.7)
X	US 5 525 770 A (MATSUMIYA HIROSHI ET AL) 11 June 1996 (1996-06-11)	1,5,6,9	H01H25/04
Y	* column 4, line 13 - line 25 * * column 5, line 15 - line 30 * * figures 2,2A,5 *	2-4,7	
Y	DE 92 10 286 U (BLAUPUNKT-WERKE GMBH) 24 September 1992 (1992-09-24) * the whole document *	2-4	
Y	US 5 086 313 A (MISAWA MASAYUKI) 4 February 1992 (1992-02-04) * column 5, line 5 - line 26 *	7	
X	MCCORNACK W C: "SINGLE KEYBUTTON FOUR-WAY SWITCH", IBM TECHNICAL DISCLOSURE BULLETIN, IBM CORP. NEW YORK, US, VOL. 21, NR. 8, PAGE(S) 3261 XP002095076 ISSN: 0018-8689 * the whole document *	1	
A	EP 0 587 406 A (MATSUSHITA ELECTRIC IND CO LTD) 16 March 1994 (1994-03-16) * column 9, line 33 - column 10, line 10; figures 9,10 *	2,4	TECHNICAL FIELDS SEARCHED (Int.Cl.7)
A	US 4 947 461 A (YOSHIOKA TOSHIO ET AL) 7 August 1990 (1990-08-07) * column 3, line 23 - line 44; figures 1,2 *	2	H01H
The present search report has been drawn up for all claims			
Place of search THE HAGUE		Date of completion of the search 1 October 2001	Examiner Ramírez Fueyo, M
<p>CATEGORY OF CITED DOCUMENTS</p> <p>X : particularly relevant if taken alone Y : particularly relevant if combined with another document of the same category A : technological background O : non-written disclosure P : intermediate document</p> <p>T : theory or principle underlying the invention E : earlier patent document, but published on, or after the filing date D : document cited in the application L : document cited for other reasons & : member of the same patent family, corresponding document</p>			

EPO FORM 1503 03/82 (P04C01)

**ANNEX TO THE EUROPEAN SEARCH REPORT
ON EUROPEAN PATENT APPLICATION NO.**

EP 01 40 2208

This annex lists the patent family members relating to the patent documents cited in the above-mentioned European search report. The members are as contained in the European Patent Office EDP file on
The European Patent Office is in no way liable for these particulars which are merely given for the purpose of information.

01-10-2001

Patent document cited in search report		Publication date	Patent family member(s)	Publication date
US 5525770	A	11-06-1996	US RE36349 E	26-10-1999
			CA 2101370 A1	01-02-1994
			US 5396030 A	07-03-1995
			US RE36738 E	20-06-2000
DE 9210286	U	24-09-1992	DE 9210286 U1	24-09-1992
US 5086313	A	04-02-1992	JP 1280708 A	10-11-1989
EP 0587406	A	16-03-1994	JP 6089636 A	29-03-1994
			JP 3010938 B2	21-02-2000
			JP 6139879 A	20-05-1994
			DE 69315149 D1	18-12-1997
			DE 69315149 T2	07-05-1998
			EP 0587406 A2	16-03-1994
			KR 137262 B1	15-06-1998
			KR 162913 B1	15-01-1999
			US 5430262 A	04-07-1995
US 4947461	A	07-08-1990	NONE	