



(12) **EUROPEAN PATENT APPLICATION**

(43) Date of publication:
08.05.2002 Bulletin 2002/19

(51) Int Cl.7: **A63B 33/00**

(21) Application number: **00309710.2**

(22) Date of filing: **02.11.2000**

(84) Designated Contracting States:
**AT BE CH CY DE DK ES FI FR GB GR IE IT LI LU
MC NL PT SE TR**
Designated Extension States:
AL LT LV MK RO SI

(72) Inventor: **Chiang, Herman**
Chung-ho city, Taipei Hsien (TW)

(74) Representative: **Stuttard, Garry Philip**
Urquhart-Dykes & Lord
Tower House
Merrion Way
Leeds LS2 8PA (GB)

(71) Applicant: **Chiang, Herman**
Chung-ho city, Taipei Hsien (TW)

(54) **Swimming goggle**

(57) The present invention relates to swimming goggles (1) comprising a lens frame (2), a padding member (3), a lens (4) and a head strap (60) in which the lens (4) and padding member (3) are fixed as a unitary piece in tight pressing engagement with the lens frame. At the

lateral side of the lens frame (2) is a suppressing member (5) which securely clips together with lens (4) and the padding member (3) to provide swimming goggles having the function of a mask and providing improved comfort and wider vision whilst avoiding pressure on the eyeballs.

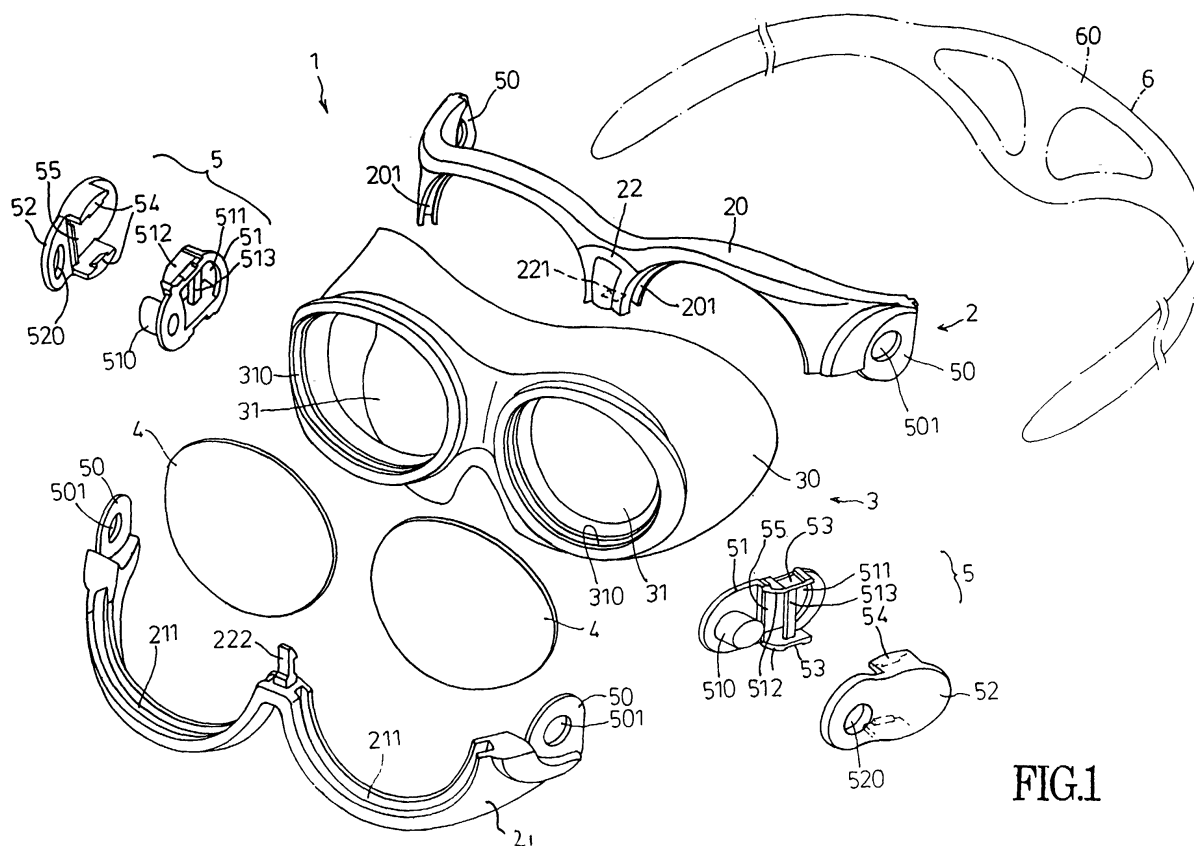

FIG.1

Description**BACKGROUND OF THE INVENTION**

5 FIELD OF THE INVENTION

[0001] The present invention relates to a swimming goggle, more particularly to a swimming goggle of a novel structure comprising a padding member to cup both eyes in the same enclosed space, which gives better comfort and wider vision to the wearer.

10 DESCRIPTION OF THE PRIOR ART

[0002] The conventional swimming goggles designated for use in swimming pools regardless of their various types usually have two lenses, each of which separately cups the left and right eye sockets. In other words, the swimming goggle of the prior art incorporates the design of cupping the eye sockets to prevent water permeation. Therefore the padding members disposed on the lens frame regardless of the foamed ones or the suckers are independently assembled to the left lens and the right lens. After such conventional swimming goggle is worn, the padding member has an adsorption around the eye sockets near the eyeballs. It is still comfortable after wearing for a short time, however the eyes will be very uncomfortable due to the pressure when wearing the goggle for some time, especially in diving. In addition, the vision of the conventional goggle is very difficult to reach wide angles due to the small area of the lens. Of course, enlarging the lens is the most direct method to improve the shortcomings of the narrow angle for the vision, but once the lens frame is enlarged, the whole structure of the swimming goggle will be changed, and the comfortableness of wearing a larger frame becomes a new issue that has to be solved.

[0003] In view of the shortcomings and inconvenience of the prior art mentioned above, which are the subjects of improvements for a long time, hence the inventor of the present invention based on years of experience accumulated from the engagement in the related industry conducted extensive research to resolve the foregoing shortcomings and invented the present invention as disclosed below.

30 SUMMARY OF THE INVENTION

[0004] Therefore, the primary objective of the present invention is to provide a swimming goggle that offers better comfort and wider vision to the wearer. The swimming goggle comprising a padding member having the mask function that cups the eye socket beyond its area when wearing, allow both eyes are cupped in the same enclosed space, and we do not have to worry about the pressure acted on the eyeballs, and it further provides an airtight waterproof effect.

[0005] The swimming goggle of the present invention mainly features that the lens and padding member of the goggle are fixed as a whole piece by the pressing of the lens frame, and such lens frame comprising a first frame and a second frame wherein the first and second frames having a bridging portion coupled to the upper and lower edges at the center of the first and second frames, and the frames has an inlaid groove for clipping the lens and the padding member. Further, a suppressing means is disposed at the lateral sides of the first and second frames, in which the suppressing means comprises an axial base having an axial hole separately disposed on the first frame and the second frame; and for coupling and latching the axial holes in order to let the head strap of the swimming goggle to pass through, and the bottom casing and the front casing being mutually assembled as a piece, such that the tight pressing between the bridging portion, the bottom casing, and the front casing securely mount the lens and the padding member into the inlaid groove of the lens frame.

[0006] Further, according to the above features, wherein the bridging portion comprises a latch groove on a first frame, and a latch post on a second frame, such that the central section of the first frame and that of the second frame can be latched together as a piece.

[0007] Further, according to the above features, wherein the bottom casing has an inclined post for hooking the axial hole of the first frame and that of the second hole as a whole piece, and the front panel in corresponsive to the inclined axial post has a latch hole to mutually latch the inclined axial post. In addition, there is a passing through area for the head strap adjacent to the inclined axial post, and such passing through area is divided into two parts for allowing the head strap of the swimming strap to revolve and pass through.

[0008] Another feature of the present invention is that the bottom casing and the front panel are pivotally coupled into the axial hole which allows a small angled rotation for meeting the need for wearing by different users.

[0009] To make it easier for our examiner to understand the objective of the invention, structure, innovative features, and performance, we use a preferred embodiment together with the attached drawings for the detailed description of the invention.

BRIEF DESCRIPTION OF THE DRAWINGS

[0010] Other objects, features, and advantages of the invention will become apparent from the following detailed description of the preferred but non-limiting embodiment. The description is made with reference to the accompanying drawings, in which:

[0011] FIG. 1 shows a three-dimensional diagram of the disassembled parts of the swimming goggle of the present invention.

[0012] FIG. 2, FIG. 3, FIG. 4, FIG. 5, and FIG. 6 show the three-dimensional diagrams of a series of step-by-step assembly process of the swimming goggle according to the present invention.

[0013] FIG. 7 is the cross-sectional diagram of the A-A section of FIG. 6.

[0014] FIG. 8 show a three-dimensional diagrams of part of after the head strap is being fixed at the bottom casing and the front casing, it could rotates according to the present invention.

DESCRIPTION OF THE PREFERRED EMBODIMENT

[0015] Please refer to Figure 1, the swimming goggle comprises a lens frame 2, a padding member 3, a lens 4, a suppressing means 5, and a head strap device 6 (see Figure 6), wherein the lens frame 2 is formed by tightly assembling a M-shaped first frame 20 and a corresponding second frame 21. The upper edge and the lower edge at the central section of both first and second frames are coupled to form a bridging portion, and such bridging portion comprises a latch groove 221 and a latch post 222 in which the latch groove 221 being disposed on the first frame 20 and the latch post 222 being extended from the second frame 21 such that the latch groove 221 and the latch post 222 can latch the middle section of the first frame 20 and that of the second frame 21 together as a piece, and the bridging portion 20 separates the lens frame 2 into the left and right portion. An inlaid portion 201, 211 is disposed each on the inner rim of the left frame and the right frame for retaining the lens 4 and the padding member 3.

[0016] The padding member 3, having a face fitting part 30 and a lens retaining part 31, of which the face fitting part is of large area and its upper edge attaches the upper portion of the eyebrow, and the lower edge attaches the lower portion of the eye socket of the wearer. The lens retaining portion 31 forms a frame opening on the padding member 3 in corresponsive to the size of the lens. The periphery of the frame opening has an indented ring 310 for covering the periphery of the lens 4 and being accommodated in the inlaid groove 201 of the lens frame.

[0017] Furthermore, a suppressing means 5 is disposed on each of the lateral sides of the lens frame 2, and the lens frame 2 comprises an axial base 50, bottom casing 51, and front panel 52, wherein the axial base 50 is disposed each on the first frame 20 and the second frame 21, and each axial base 50 has an axial hole 501 on it for coupling. The bottom casing 51 has an inclined axial post 510 on a lateral side of the panel for coupling the foregoing axial hole 501, and the passing area formed at the adjacent side of the inclined axial post 510 is for the head strap to pass through, and a hollow portion 511 being disposed in the passing through area at the bottom casing, and a platform 512 being longitudinally disposed on both lateral sides, and an isolating post 513 being disposed across the platform 512 such that the head strap can be fixed by revolving around and passing through the isolating post 513. The front panel 52 has a latch hole 520 being latched with the inclined axial post 510. In addition, the outer side of the platform 512 of the bottom casing 51 has an inlaid groove 53, and the front panel 52 has a inlaid post 54 being extended from the position corresponding to the inlaid groove 53 such that the two can be securely assembled together as a piece. Further, the front panel 52 and the bottom casing 51 has a blocking surface 55 for guiding the head strap and restricting excessive passing through of the head strap in their corresponding inner sides.

[0018] Please continue to refer to Figures 2 to 6, which illustrate the three-dimensional diagrams of a series of assembling steps. Firstly, install the lens 4 into the indented ring 310 of the lens retaining portion 31 of the padding member 3, and then install it into the inlaid groove 211 of the second frame 21 as shown in Figure 2. Latch the latch post 222 on the second frame 21 by the first frame 20 into the latch groove 221 (please refer to Figure 7), and securely couple the central portion of the rim of the frame as shown in Figure 3. Hook the axial hole 501 on the lateral side of the first frame 20 and the second frame 21 by the inclined axial post 510 in a lateral side of the bottom casing 51, and use the latch hole 520 of the front panel 52 and the inlaid post 54 to latch into the inclined axial post 510 of the bottom casing 51 and the inlaid groove 53 thereby fixing a lateral side of the swimming goggle by pressing as shown in Figure 4. Similarly, the other lateral side can be assembled in the same way to securely latch the front panel 52 and the bottom casing 51 in order to fix the other lateral side by pressing as shown in Figure 5. Finally, each of both ends of a head strap 60 of a head strap device 6 separately passes through the assembled front panel 52 and the bottom casing 51, and the head strap 60 is being blocked by the blocking surface 55 during the head strap 60 is being passed through (refer to Figure 1), and the head strap will be guided to revolve and pass through the isolating post 513 of the bottom casing 51 (refer to Figure 1) so that the head strap is fixed in position as shown in Figure 5.

[0019] Please continue to refer to Figure 8. After the head strap 60 is being fixed at the bottom casing 51 and the front casing 52, it rotates along the inclined axial post 510 as an axis in order to meet different wearer's need for the

head strap lengths.

[0020] Therefore, in summation of the above description, the present invention obviously attains the objective of the present invention. The inventor of the present invention based on years of experience in the related industry conducted extensive research to enhance the structure of the present invention herein which is hereby submitted for patent application.

[0021] While the invention has been described in what is considered the most practical and preferred embodiments, it is understood that the invention is not limited to the disclosed embodiments, but is intended to cover various modifications and similar arrangements and procedures within the spirit and scope of the broadest interpretation and equivalent arrangements, modifications, and procedures.

Numbering of the Major Elements

[0022]

15	Swimming goggle	1
	Lens frame	2
	Second frame	21
	Inlaid groove	211
	Latch post	222
20	Padding member	3
	Face fitting portion	30
	Indented ring	310
	Lens	4
	Suppressing means	5
25	Axial base	50
	Front panel	52
	Inlaid post	54
	Inclined axial post	510
	Platform	512
30	Latch hole	520
	Head strap device	6
	Head strap	60
	First frame	20
	Bridging portion	22
35	Latch groove	221
	Lens retaining portion	31
	Bottom casing	51
	Inlaid groove	53
	Blocking surface	55
40	Hollow portion	511
	Isolating post	513
	Axial hole	501

Claims

1. Swimming goggles comprising:

a lens frame having an inlaid groove on the internal rim thereof, a bridging portion at the centre thereof and a suppressing means at the lateral side thereof, wherein said suppressing means comprises: an axial base on the lens frame having an axial hole, a bottom casing, a front panel and a passing latch coupled into the axial hole whereby to allow a head strap to pass through such that the bottom casing and the front panel are a unitary assembly;

a padding member having a face fitting part and a lens retaining part;

a lens capable of being retained in the lens retaining part and accommodated in the inlaid groove of the lens frame; and

a head strap device disposed at the lateral sides of the lens frame comprising the head strap.

EP 1 203 600 A1

2. Swimming goggles as claimed in claim 1, wherein said lens frame is a first frame coupled to a second frame, each of the first and second frame having an axial base, said axial base having an axial hole.
- 5 3. Swimming goggles as claimed in claim 2, wherein said bridging portion comprises: a latching groove on the first frame and a latching post on the second frame whereby the centre of the first and the second lens frame are latched together as a unitary assembly by latching the latching post into the latching groove.
- 10 4. Swimming goggles as claimed in claim 2, wherein the bottom casing has an inclined axial post disposed on a inner face which hooks into the axial hole of each of the first and second frame and is latched by a corresponding latch hole in the front panel.
- 15 5. Swimming goggles as claimed in claim 4, wherein the bottom casing further comprises: a hollow portion adjacent to the inclined axial post, a first and a second platform inwardly disposed on the upper and lower edges respectively thereof and an isolating post across the first and second platforms around and through which the head strap revolves.
- 20 6. Swimming goggles as claimed in claim 5, wherein the bottom casing further comprises: an inlaid groove on the outer face of the first and/or second platform and wherein the front panel further comprises: an inlaid post extending from a position corresponding to said inlaid groove such that the inlaid groove is inlaid into the inlaid post as a unitary assembly.
7. Swimming goggles as claimed in any preceding claim, wherein the face fitting part of said padding member attaches to the upper portion of the eyebrow and the lower portion of the eye socket.
- 25 8. Swimming goggles as claimed in any preceding claim, wherein the inner face of said front panel and of the bottom casing have a blocking surface for guiding the head strap and for restricting excessive pass through of the head strap.

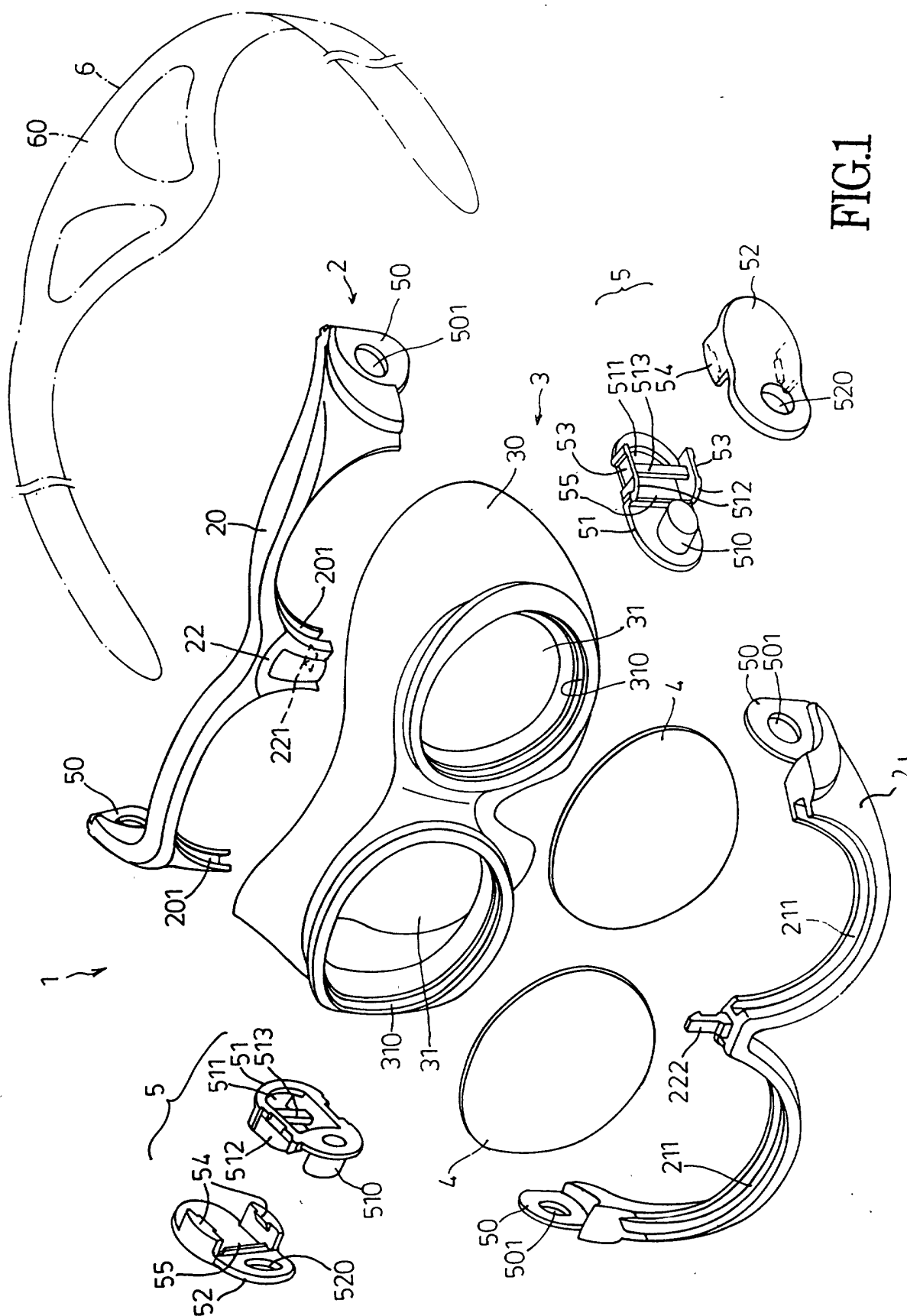

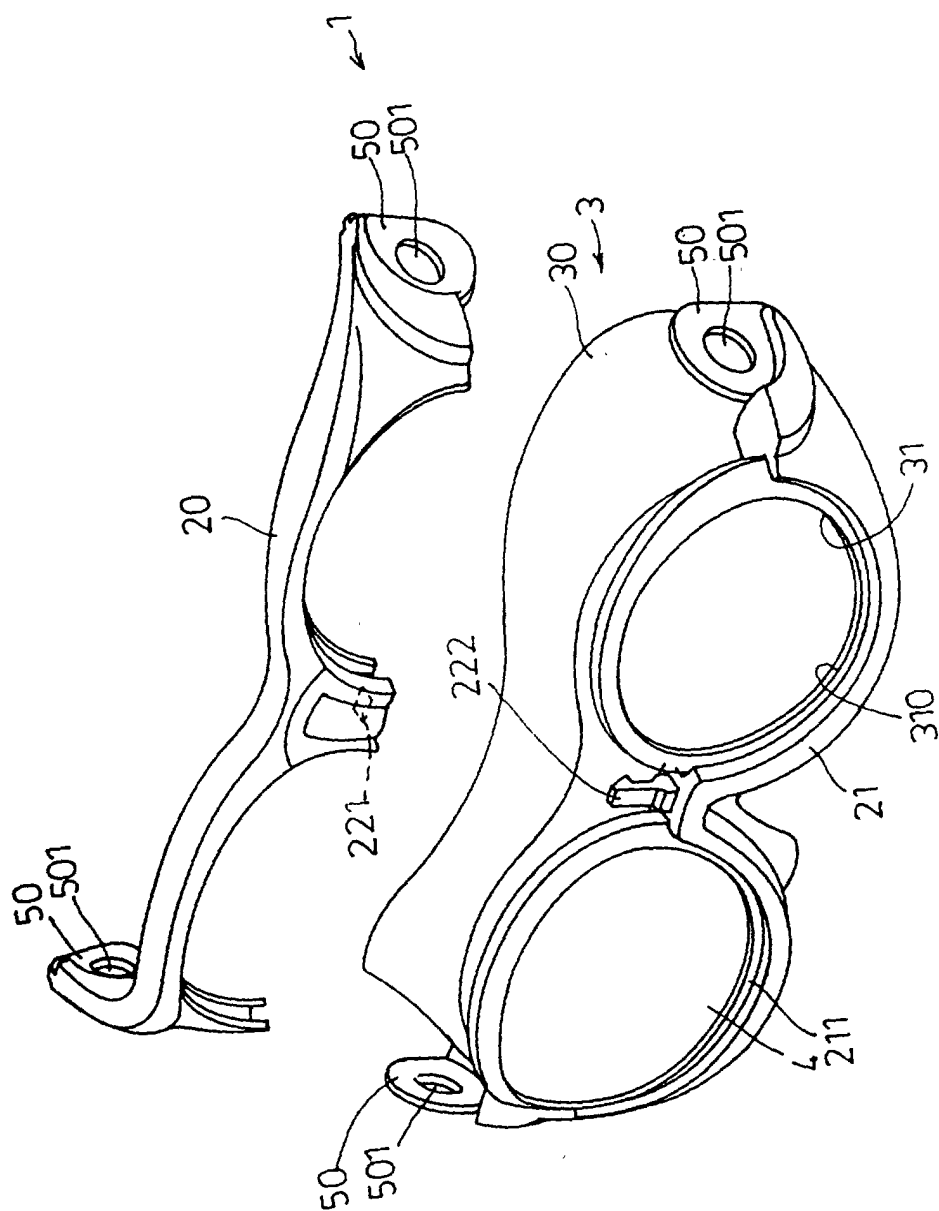

FIG. 2

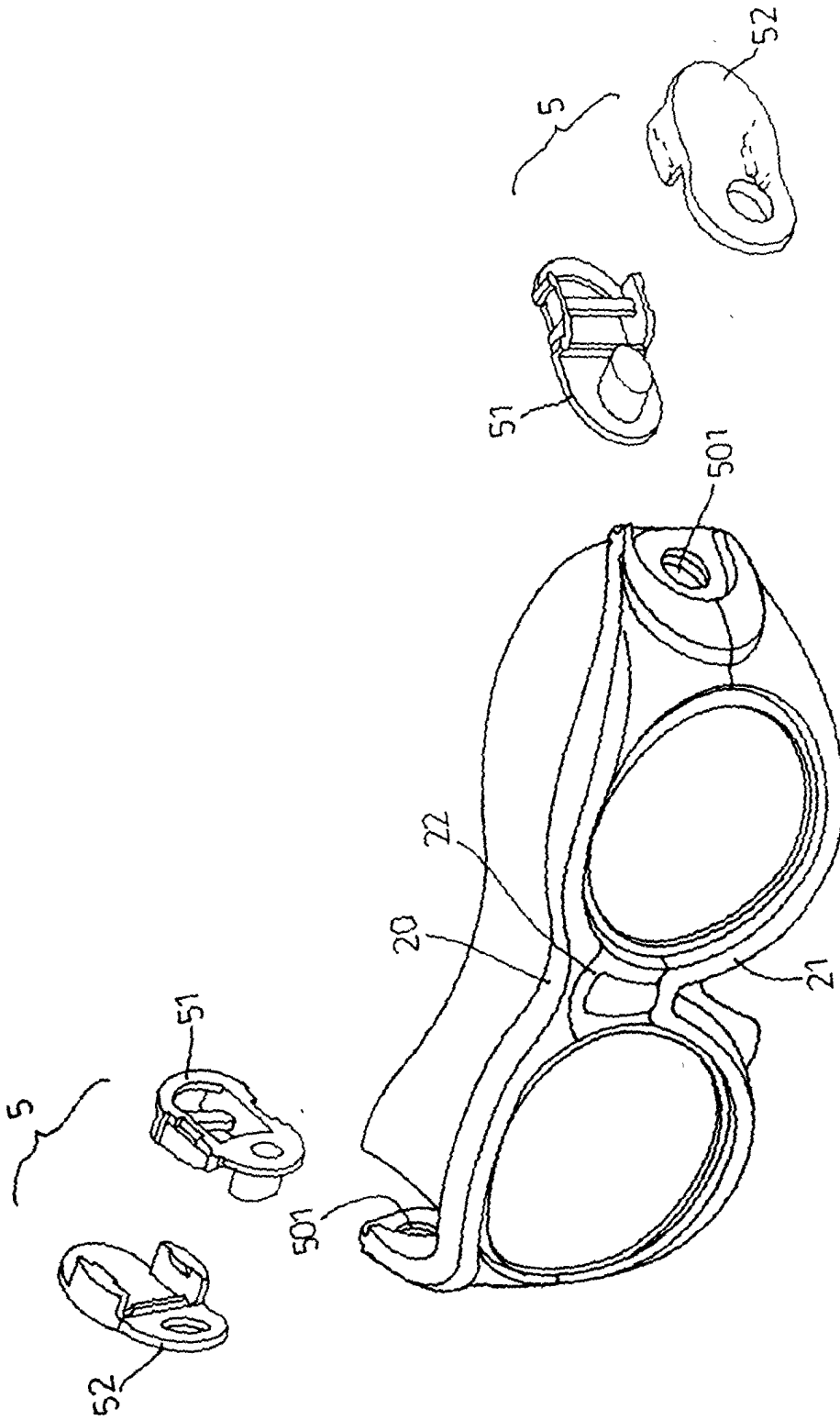

FIG.3

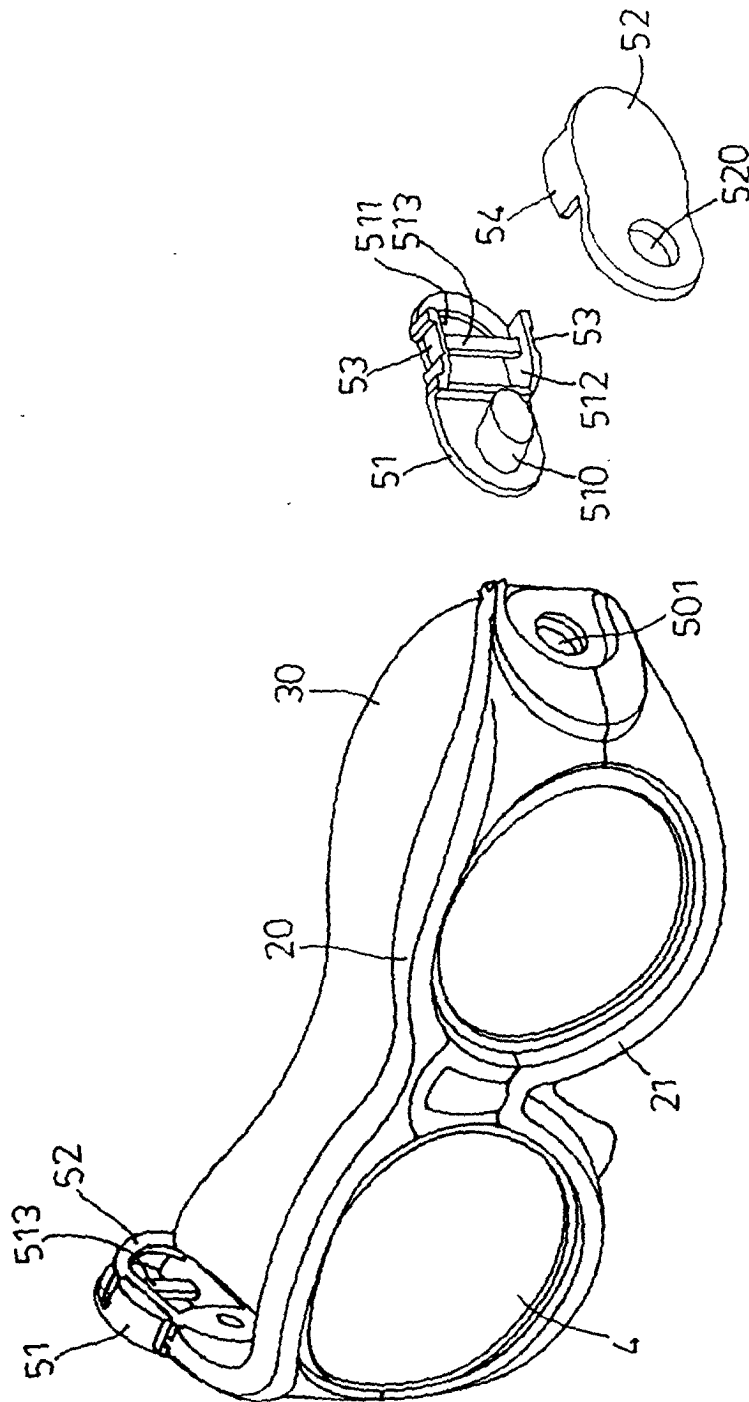

FIG.4

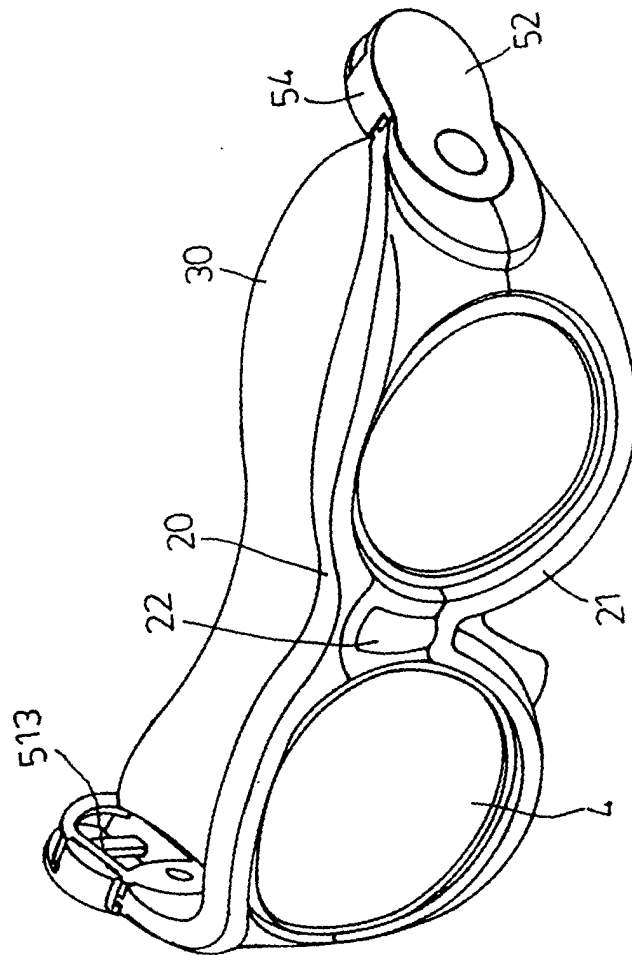

FIG. 5

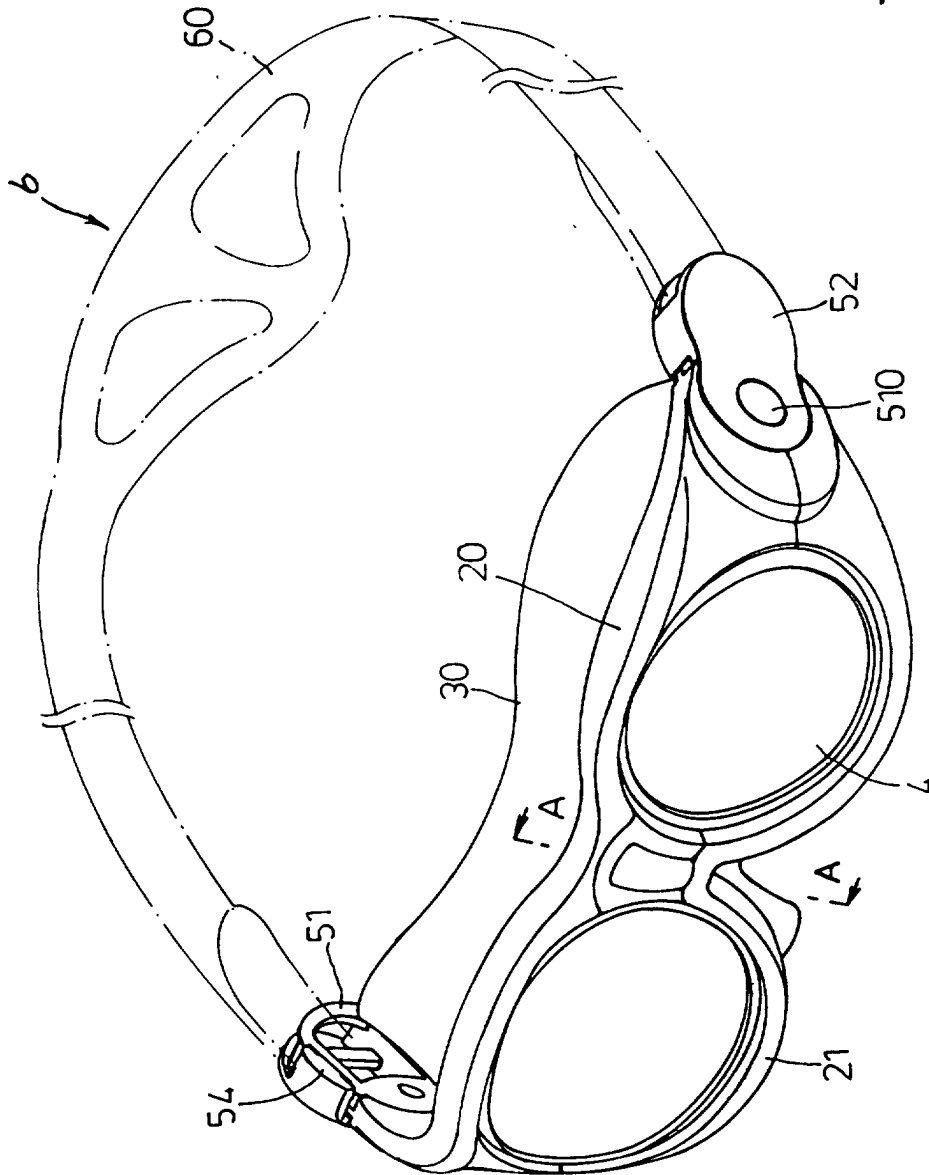

FIG. 6

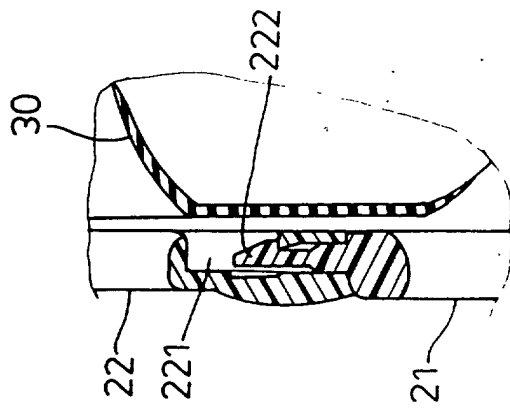

FIG. 7

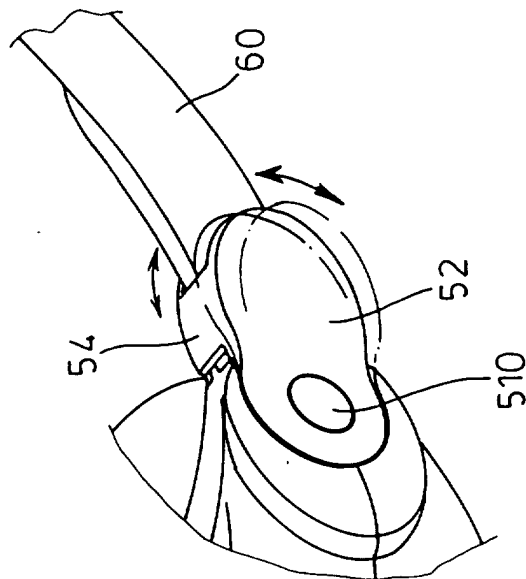

FIG. 8



European Patent
Office

EUROPEAN SEARCH REPORT

Application Number
EP 00 30 9710

DOCUMENTS CONSIDERED TO BE RELEVANT			
Category	Citation of document with indication, where appropriate, of relevant passages	Relevant to claim	CLASSIFICATION OF THE APPLICATION (Int.Cl.7)
X	US 5 638 552 A (FUJIMA TARO) 17 June 1997 (1997-06-17)	1-3,7	A63B33/00
A	* column 5, line 49 - column 6, line 29; figures 2,4-6 *	4-6,8	
X	DE 297 11 504 U (HUANG ANN) 28 August 1997 (1997-08-28)	1,2,7	
A	* page 3, line 8 - page 4, line 21; figures 1-3 *	3-6,8	
A	EP 1 008 369 A (CHIANG HERMAN) 14 June 2000 (2000-06-14)	1-3,7	
A	* column 3, line 44 - line 57; figures 1,3B, *	1-3,7	
A	EP 0 887 089 A (CHIANG HERMAN) 30 December 1998 (1998-12-30)	1-3,7	TECHNICAL FIELDS SEARCHED (Int.Cl.7) A63B B63C
A	WO 90 00380 A (POWELL MARK HARMAN) 25 January 1990 (1990-01-25)	1,2,7	
The present search report has been drawn up for all claims			
Place of search MUNICH		Date of completion of the search 29 January 2001	Examiner Curzi, D
CATEGORY OF CITED DOCUMENTS X : particularly relevant if taken alone Y : particularly relevant if combined with another document of the same category A : technological background O : non-written disclosure P : intermediate document T : theory or principle underlying the invention E : earlier patent document, but published on, or after the filing date D : document cited in the application L : document cited for other reasons & : member of the same patent family, corresponding document			

EPO FORM 1503 03 82 (P04C01)

**ANNEX TO THE EUROPEAN SEARCH REPORT
ON EUROPEAN PATENT APPLICATION NO.**

EP 00 30 9710

This annex lists the patent family members relating to the patent documents cited in the above-mentioned European search report.
The members are as contained in the European Patent Office EDP file on
The European Patent Office is in no way liable for these particulars which are merely given for the purpose of information.

29-01-2001

Patent document cited in search report	Publication date	Patent family member(s)	Publication date
US 5638552 A	17-06-1997	JP 2665166 B JP 8107948 A CN 2238670 U IT T0950799 A	22-10-1997 30-04-1996 30-10-1996 09-04-1996
DE 29711504 U	28-08-1997	NONE	
EP 1008369 A	14-06-2000	NONE	
EP 0887089 A	30-12-1998	US 6032298 A AU 2615797 A	07-03-2000 24-12-1998
WO 9000380 A	25-01-1990	EP 0401312 A	12-12-1990

EPO FORM P0459

For more details about this annex : see Official Journal of the European Patent Office, No. 12/82