

(19)



Europäisches Patentamt  
European Patent Office  
Office européen des brevets



(11)

**EP 1 203 843 A3**

(12)

## EUROPEAN PATENT APPLICATION

(88) Date of publication A3:  
**24.07.2002 Bulletin 2002/30**

(51) Int Cl.7: **E02F 3/20, E02F 9/20**

(43) Date of publication A2:  
**08.05.2002 Bulletin 2002/19**

(21) Application number: **01125999.1**

(22) Date of filing: **31.10.2001**

(84) Designated Contracting States:  
**AT BE CH CY DE DK ES FI FR GB GR IE IT LI LU  
MC NL PT SE TR**  
Designated Extension States:  
**AL LT LV MK RO SI**

(72) Inventor: **Pianta, Narciso**  
**45014 Porto Viro (IT)**

(74) Representative: **Franzolin, Luigi et al**  
**STUDIO TORTA S.r.l.,**  
**Via Viotti, 9**  
**10121 Torino (IT)**

(30) Priority: **03.11.2000 IT BO000640**

(71) Applicant: **Herrmann Eurotechnic S.r.l.**  
**45014 Porto Viro (IT)**

### (54) **Bagger shovel for making slits for reinforced concrete walls**

(57) A crane shovel (1) for building reinforced concrete cutoff walls and similar, having a self-propelled undercarriage (2) particularly suitable for moving over rough ground; a movable superstructure (3) mounted on the self-propelled undercarriage (2) to revolve about a

vertical axis of rotation (A); a boom (4) projecting from the movable superstructure (3) in a substantially horizontal direction; and a grab bucket (5), for reinforced concrete cutoff walls, suspended from the free end (4a) of the boom (4) by means of one or more supporting cables (6).

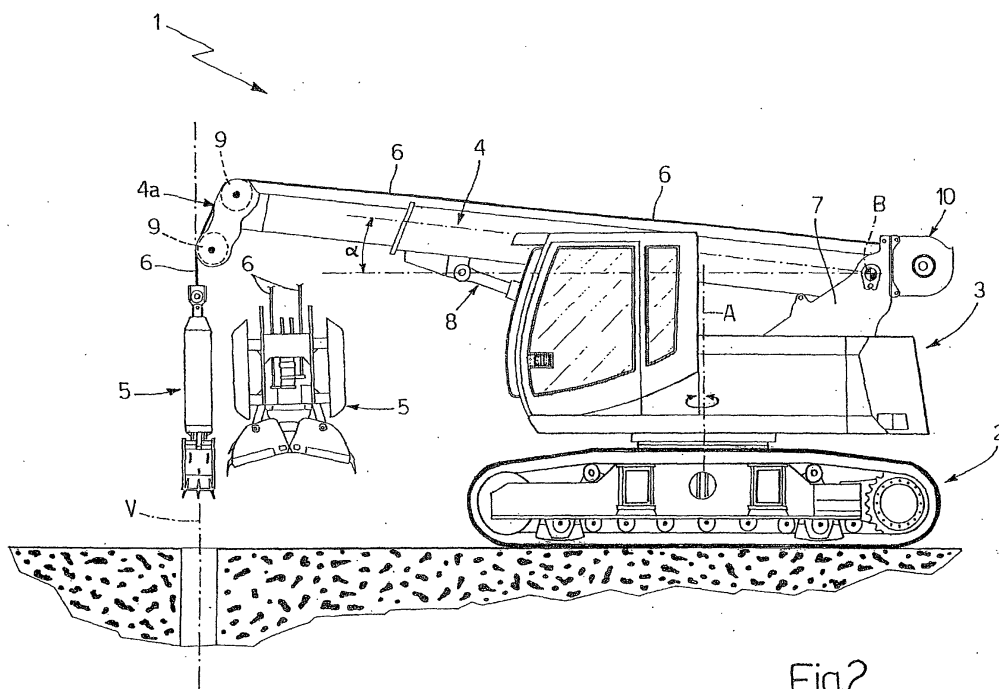

Fig.2

EP 1 203 843 A3



European Patent  
Office

## EUROPEAN SEARCH REPORT

Application Number  
EP 01 12 5999

DOCUMENTS CONSIDERED TO BE RELEVANT			
Category	Citation of document with indication, where appropriate, of relevant passages	Relevant to claim	CLASSIFICATION OF THE APPLICATION (Int.Cl.7)
A	US 5 836 089 A (LIPSKER YITSHAQ) 17 November 1998 (1998-11-17)	1-4,7	E02F3/20 E02F9/20
A	* figure 11 * * column 1, line 10 - line 17 * * column 7, line 46 - line 52 * ---	5,6	
Y	US 3 157 288 A (ERNST WIEGER) 17 November 1964 (1964-11-17)	1-4,7	
A	* figures 1,2 * * column 2, line 1 - line 45 * ---	6	
Y	DE 10 86 413 B (DEMAG-ZUG G.M.B.H.) 4 August 1960 (1960-08-04)	1-4,7	
A	* figure 1 * * column 1, line 45 - column 2, line 28 * ---	5	
Y	US 3 578 787 A (BRICKETT ALAN E ET AL) 18 May 1971 (1971-05-18)	1-4,7	
	* figure 5 * * column 1, line 38 - line 59 * * column 4, line 59 - column 5, line 15 * ---		TECHNICAL FIELDS SEARCHED (Int.Cl.7)
A	EP 0 826 835 A (SOL COMP DU) 4 March 1998 (1998-03-04)	1	E02F E02D E21B B66C
	* figure 1 * ---		
A	US 3 726 349 A (HEUSLER H ET AL) 10 April 1973 (1973-04-10)	1	
	* figures 2,3 * -----		
<del>The present search report has been drawn up for all claims</del>			
Place of search <b>THE HAGUE</b>		Date of completion of the search <b>28 January 2002</b>	Examiner <b>GUTHMULLER J.A.</b>
CATEGORY OF CITED DOCUMENTS X : particularly relevant if taken alone Y : particularly relevant if combined with another document of the same category A : technological background O : non-written disclosure P : intermediate document T : theory or principle underlying the invention E : earlier patent document, but published on, or after the filing date D : document cited in the application L : document cited for other reasons & : member of the same patent family, corresponding document			

EPO FORM 1503 03.92 (P04C01)



European Patent  
Office

Application Number

EP 01 12 5999

### CLAIMS INCURRING FEES

The present European patent application comprised at the time of filing more than ten claims.

- ☐ Only part of the claims have been paid within the prescribed time limit. The present European search report has been drawn up for the first ten claims and for those claims for which claims fees have been paid, namely claim(s):
- ☐ No claims fees have been paid within the prescribed time limit. The present European search report has been drawn up for the first ten claims.

### LACK OF UNITY OF INVENTION

The Search Division considers that the present European patent application does not comply with the requirements of unity of invention and relates to several inventions or groups of inventions, namely:

see sheet B

- ☐ All further search fees have been paid within the fixed time limit. The present European search report has been drawn up for all claims.
- ☐ As all searchable claims could be searched without effort justifying an additional fee, the Search Division did not invite payment of any additional fee.
- ☐ Only part of the further search fees have been paid within the fixed time limit. The present European search report has been drawn up for those parts of the European patent application which relate to the inventions in respect of which search fees have been paid, namely claims:
- ☒ None of the further search fees have been paid within the fixed time limit. The present European search report has been drawn up for those parts of the European patent application which relate to the invention first mentioned in the claims, namely claims:

1-7



European Patent  
Office

**LACK OF UNITY OF INVENTION  
SHEET B**

Application Number  
EP 01 12 5999

The Search Division considers that the present European patent application does not comply with the requirements of unity of invention and relates to several inventions or groups of inventions, namely:

1. Claims: 1-7

A crane shovel for building reinforced concrete cutoff walls having a boom projecting, in a substantially horizontal direction, from said superstructure.

2. Claims: 8,9

A crane shovel having a lateral running board fixed to the superstructure.

**ANNEX TO THE EUROPEAN SEARCH REPORT  
ON EUROPEAN PATENT APPLICATION NO.**

EP 01 12 5999

This annex lists the patent family members relating to the patent documents cited in the above-mentioned European search report. The members are as contained in the European Patent Office EDP file on  
The European Patent Office is in no way liable for these particulars which are merely given for the purpose of information.

28-01-2002

Patent document cited in search report		Publication date	Patent family member(s)	Publication date
US 5836089	A	17-11-1998	IL 104820 A	27-11-1995
			CA 2155312 A1	01-09-1994
			EP 0725757 A1	14-08-1996
			PL 310128 A1	27-11-1995
			RU 2124609 C1	10-01-1999
			WO 9419272 A1	01-09-1994
-----				
US 3157288	A	17-11-1964	NONE	
-----				
DE 1086413	B	04-08-1960	NONE	
-----				
US 3578787	A	18-05-1971	NONE	
-----				
EP 0826835	A	04-03-1998	FR 2752857 A1	06-03-1998
			DE 69710275 D1	21-03-2002
			EP 0826835 A1	04-03-1998
			JP 2847076 B2	13-01-1999
			JP 10159127 A	16-06-1998
-----				
US 3726349	A	10-04-1973	FR 1595214 A	08-06-1970
			GB 1216936 A	23-12-1970
-----				