



Europäisches Patentamt  
European Patent Office  
Office européen des brevets



(11) **EP 1 204 128 A3**

(12) **EUROPEAN PATENT APPLICATION**

(88) Date of publication A3:  
**05.01.2005 Bulletin 2005/01**

(51) Int Cl.7: **H01H 21/00, H01H 1/58**

(43) Date of publication A2:  
**08.05.2002 Bulletin 2002/19**

(21) Application number: **01126042.9**

(22) Date of filing: **31.10.2001**

(84) Designated Contracting States:  
**AT BE CH CY DE DK ES FI FR GB GR IE IT LI LU  
MC NL PT SE TR**  
Designated Extension States:  
**AL LT LV MK RO SI**

(71) Applicant: **ALPS ELECTRIC CO., LTD.**  
**Tokyo 145-8501 (JP)**

(72) Inventor: **Tanaka, Takaki,**  
**c/o Alps Electric Co., Ltd.**  
**Tokyo 145-8501 (JP)**

(30) Priority: **02.11.2000 JP 2000340408**  
**02.11.2000 JP 2000340409**  
**02.11.2000 JP 2000340410**

(74) Representative: **Klunker . Schmitt-Nilson . Hirsch**  
**Winzererstrasse 106**  
**80797 München (DE)**

(54) **Lever operating type switch assembly**

(57) The invention provides a switch assembly in which a movable contact point is swingably supported stably having a common contact point and an individual contact point formed in simple structure to save the material cost and having the common contact point and the individual contact point the parts of which can be used commonly. A support projection that extends to a free end side from an elastic contact position of a common contact point is formed on a support tongue of a movable contact point that is supported swingably in a container of a housing in which a common contact point and an individual contact point are disposed, and a support projection is supported on a pivot support portion formed on the housing.

**FIG. 1**

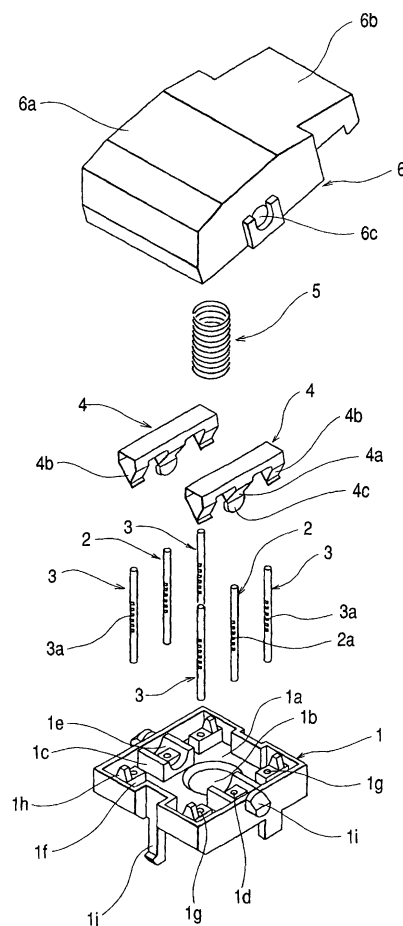



European Patent  
Office

# EUROPEAN SEARCH REPORT

Application Number  
EP 01 12 6042

DOCUMENTS CONSIDERED TO BE RELEVANT			
Category	Citation of document with indication, where appropriate, of relevant passages	Relevant to claim	CLASSIFICATION OF THE APPLICATION (Int.Cl.7)
Y	US 5 293 507 A (HAYAKAWA HIROSHI) 8 March 1994 (1994-03-08) * claim 1 *	1-4	H01H21/00 H01H1/58
Y	FR 685 294 A (L APP ELECTR DE LA SEINE SOC) 8 July 1930 (1930-07-08) * page 2, line 5 - line 8; figure 1 *	1-4	
A	US 4 740 661 A (FUNAKOSHI HISASHI ET AL) 26 April 1988 (1988-04-26) * abstract *	1	
A	US 4 371 767 A (OHASHI SHIGEO ET AL) 1 February 1983 (1983-02-01) * abstract *	5,8,9	
A	DE 15 40 189 A (MARKWORTIT GMBH) 2 January 1970 (1970-01-02) * claims 1-3 *	5,8	
A	FR 1 348 817 A (MERLIN GERIN) 10 January 1964 (1964-01-10) * page 2, left-hand column *	9	TECHNICAL FIELDS SEARCHED (Int.Cl.7) H01H
The present search report has been drawn up for all claims			
Place of search The Hague		Date of completion of the search 9 November 2004	Examiner Libberecht, L
CATEGORY OF CITED DOCUMENTS X : particularly relevant if taken alone Y : particularly relevant if combined with another document of the same category A : technological background O : non-written disclosure P : intermediate document		T : theory or principle underlying the invention E : earlier patent document, but published on, or after the filing date D : document cited in the application L : document cited for other reasons & : member of the same patent family, corresponding document	

EPO FORM 1503 03.82 (P04C01)



European Patent  
Office

Application Number

EP 01 12 6042

### CLAIMS INCURRING FEES

The present European patent application comprised at the time of filing more than ten claims.

- ☐ Only part of the claims have been paid within the prescribed time limit. The present European search report has been drawn up for the first ten claims and for those claims for which claims fees have been paid, namely claim(s):
- ☐ No claims fees have been paid within the prescribed time limit. The present European search report has been drawn up for the first ten claims.

### LACK OF UNITY OF INVENTION

The Search Division considers that the present European patent application does not comply with the requirements of unity of invention and relates to several inventions or groups of inventions, namely:

see sheet B

- ☒ All further search fees have been paid within the fixed time limit. The present European search report has been drawn up for all claims.
- ☐ As all searchable claims could be searched without effort justifying an additional fee, the Search Division did not invite payment of any additional fee.
- ☐ Only part of the further search fees have been paid within the fixed time limit. The present European search report has been drawn up for those parts of the European patent application which relate to the inventions in respect of which search fees have been paid, namely claims:
- ☐ None of the further search fees have been paid within the fixed time limit. The present European search report has been drawn up for those parts of the European patent application which relate to the invention first mentioned in the claims, namely claims:



European Patent  
Office

**LACK OF UNITY OF INVENTION  
SHEET B**

Application Number  
EP 01 12 6042

The Search Division considers that the present European patent application does not comply with the requirements of unity of invention and relates to several inventions or groups of inventions, namely:

1. claims: 1-4

Pivot structure for a movable contact of a switch.

---

2. claims: 5-8

Form of fixed contacts and the mounting thereof in a switch base.

---

3. claims: 9-12

Pin and socket contact wherein the pin has an insulating part.

---

**ANNEX TO THE EUROPEAN SEARCH REPORT  
ON EUROPEAN PATENT APPLICATION NO.**

EP 01 12 6042

This annex lists the patent family members relating to the patent documents cited in the above-mentioned European search report.  
The members are as contained in the European Patent Office EDP file on  
The European Patent Office is in no way liable for these particulars which are merely given for the purpose of information.

09-11-2004

Patent document cited in search report		Publication date	Patent family member(s)	Publication date
US 5293507	A	08-03-1994	JP 2573191 Y2	28-05-1998
			JP 4105436 U	10-09-1992
			DE 4205364 A1	03-09-1992
FR 685294	A	08-07-1930	NONE	
US 4740661	A	26-04-1988	JP 3026595 Y2	10-06-1991
			JP 61149238 U	13-09-1986
			JP 61189534 U	26-11-1986
US 4371767	A	01-02-1983	JP 56101840 U	10-08-1981
			JP 60008355 Y2	25-03-1985
DE 1540189	A	02-01-1970	DE 1540189 A1	02-01-1970
FR 1348817	A	10-01-1964	CH 389063 A	15-03-1965
			DE 1178494 B	24-09-1964