

(19)



Europäisches Patentamt  
European Patent Office  
Office européen des brevets



(11)

**EP 1 205 711 A3**

(12)

## EUROPEAN PATENT APPLICATION

(88) Date of publication A3:  
**04.12.2002 Bulletin 2002/49**

(51) Int Cl.7: **F23L 17/00**

(43) Date of publication A2:  
**15.05.2002 Bulletin 2002/20**

(21) Application number: **01126928.9**

(22) Date of filing: **13.11.2001**

(84) Designated Contracting States:  
**AT BE CH CY DE DK ES FI FR GB GR IE IT LI LU  
MC NL PT SE TR**  
Designated Extension States:  
**AL LT LV MK RO SI**

(72) Inventor: **Dal Zotto, Vanni**  
**36030 Montecchio Precalcino (Vicenza) (IT)**

(74) Representative: **Bettello, Pietro, Dott. Ing. et al**  
**Studio Tecnico**  
**Ingg. Luigi e Pietro Bettello**  
**Via Col d'Echele, 25**  
**36100 Vicenza (IT)**

(30) Priority: **10.11.2000 IT VI000246**

(71) Applicant: **Italvas S.p.A.**  
**36030 Montecchio Precalcino (Vicenza) (IT)**

(54) **Device for an emergency forced draught, to mount on heaters and similar apparatus**

(57) Concerns a device for an emergency forced draught, to mount on combustion heaters or other similar apparatuses, when it is necessary to evacuate combustion fumes in emergency conditions, such as a sudden lack of electrical energy, for which reason it is necessary to ensure, for a certain period of time, a normal operation of the apparatus itself. Such a device is char-

acterised in that it is mounted onto the extractor inserted in the piping for the combustion exhaust fumes so that, in the case of a sudden lack in electrical energy, said extractor, being still operating, makes the air circulate in the fire-box, allowing the fuel inside to burn until it has run out and allowing the fumes to be evacuated in a normal manner through the chimney.

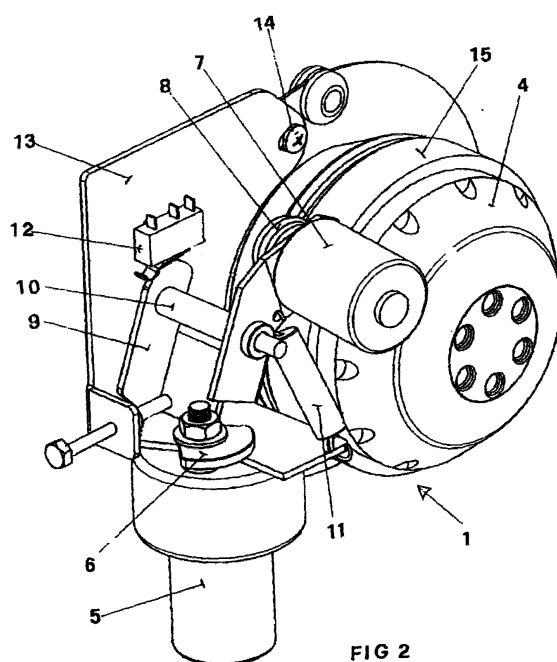

FIG 2

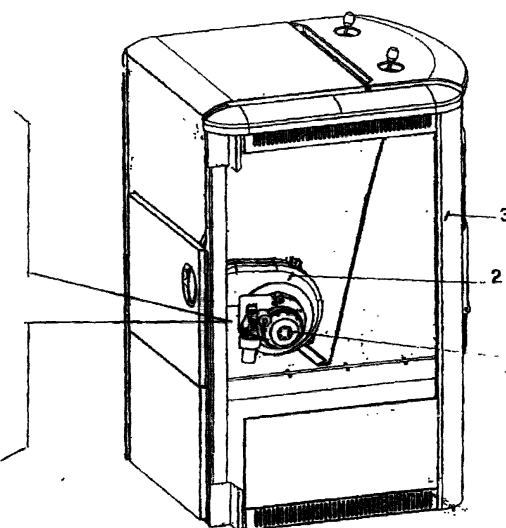

FIG 1

EP 1 205 711 A3



European Patent  
Office

# EUROPEAN SEARCH REPORT

Application Number  
EP 01 12 6928

DOCUMENTS CONSIDERED TO BE RELEVANT			
Category	Citation of document with indication, where appropriate, of relevant passages	Relevant to claim	CLASSIFICATION OF THE APPLICATION (In.CI.7)
X	US 4 424 792 A (SHIMEK RONALD J ET AL) 10 January 1984 (1984-01-10)	1,5	F23L17/00
A	* column 2, line 64 - column 6, line 39; figures 1-6 *	2,3,6	
A	FR 1 344 529 A (NEUZEITLICHE VERBRENNUNGS UND) 29 November 1963 (1963-11-29) * the whole document *	1	
A	US 5 950 573 A (OVERBEY JR FRED A ET AL) 14 September 1999 (1999-09-14) * the whole document *		
A	GB 201 901 A (RATEAU SOC) 26 June 1924 (1924-06-26)		
The present search report has been drawn up for all claims			TECHNICAL FIELDS SEARCHED (In.CI.7)
			F23L F24H
Place of search		Date of completion of the search	Examiner
MUNICH		30 September 2002	Theis, G
CATEGORY OF CITED DOCUMENTS			
X : particularly relevant if taken alone Y : particularly relevant if combined with another document of the same category A : technological background O : non-written disclosure P : intermediate document		T : theory or principle underlying the invention E : earlier patent document, but published on, or after the filing date D : document cited in the application L : document cited for other reasons & : member of the same patent family, corresponding document	

EPO FORM 1503 03 82 (P04001)

**ANNEX TO THE EUROPEAN SEARCH REPORT  
ON EUROPEAN PATENT APPLICATION NO.**

EP 01 12 6928

This annex lists the patent family members relating to the patent documents cited in the above-mentioned European search report. The members are as contained in the European Patent Office EDP file on  
The European Patent Office is in no way liable for these particulars which are merely given for the purpose of information.

30-09-2002

Patent document cited in search report		Publication date	Patent family member(s)	Publication date
US 4424792	A	10-01-1984	NONE	
FR 1344529	A	29-11-1963	NONE	
US 5950573	A	14-09-1999	AU 3504199 A CN 1255610 A EP 0994303 A1	20-04-2000 07-06-2000 19-04-2000
GB 201901	A	26-06-1924	NONE	

EPO FORM P459

For more details about this annex : see Official Journal of the European Patent Office, No. 12/82